

# Perimeter Edge Metal

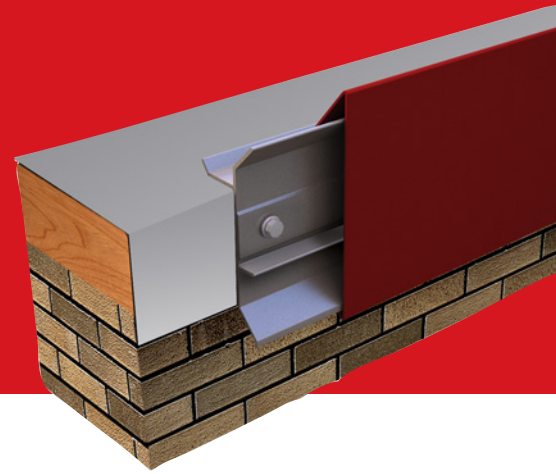
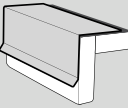

## Description:

EverGuard® Pro Fascia and EverGuard® Pro Extended Fascia compose a snap-on system that protects against tough weather conditions. The unique design of the extruded aluminum bar with pre-punched holes securely terminates single-ply membranes and provides superior protection versus formed shop-fabricated bars. It can also increase productivity with its ease of installation.

## Features and Benefits:

- EverGuard® Pro Fascia sizes range from 4" – 8 ½" (102 mm – 216 mm) face heights to accommodate multiple nailers and wall requirements.
- EverGuard® Pro Extended Fascia sizes range from 8 ½" – 13" (216 mm - 330 mm) face heights.
- EverGuard® Pro Fascia covers can be manufactured in 22 ga., 24 ga., or .040" aluminum.

- EverGuard® Pro Extended Fascia covers can be manufactured in 22 ga. galvanized steel or .050" and .063" aluminum.
- Factory-fabricated miters, scuppers, and drainage accessories provide a clean aesthetic and can help save time by eliminating the need for field fabrication.
- Express, standard, and premium colors and finishes are available and include a 30-year limited Kynar 500® finish warranty on coil-coated standard colors. For warranty details, please visit [gaf.com](http://gaf.com).
- Custom colors are also available. A 10-year limited warranty is included for post-painted Kynar®-coated aluminum applications unless otherwise stated. A 20-year limited warranty may be available upon request for certain colors.\*

\* Restrictions apply; consult your GAF Territory Manager for more information.

## Codes and Compliance:

- Tested in accordance with ANSI/SPRI/FM 4435/ES-1 Standard to comply with the International Building Code.
- FM-approved for wind uplift protection. Refer to [RoofNav.com](http://RoofNav.com) for actual assemblies.



## 10 Express Colors<sup>1</sup>

Express Colors are available for quick shipping to meet your job requirements.<sup>2</sup>



For standard and premium colors, go to the GAF color chart, available at [gaf.com/perimeteredgemetal](http://gaf.com/perimeteredgemetal). Custom colors are also available.

<sup>1</sup> Express Colors available in shorter lead times for 24 ga., .040", and .050" only. Standard lead times, which may be longer, apply for 22 ga. and .063".

<sup>2</sup> It is difficult to reproduce the color clarity of these products. Before selecting your color, please contact your local GAF territory manager to request a paint chip for accurate color representation.

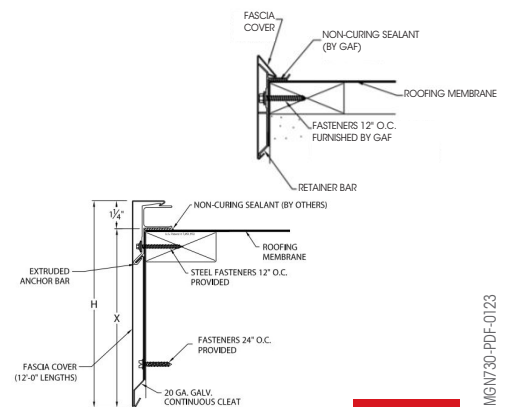

## Product Specifications

	EverGuard® Pro Fascia	EverGuard® Pro Extended Fascia
<b>STANDARD SIZES</b>	4 in. (102 mm) 5.5 in. (127 mm) 7 in. (177.8 mm) 8.5 in. (216 mm)	8.5 in. (216 mm) 10 in. (254 mm) 11.5 in. (292 mm) 13 in. (330 mm)
<b>LENGTH</b>	12 ft. (6.10 m)	
<b>MATERIALS</b>	22 ga. galvanized steel 24 ga. galvanized steel (Pro Fascia only) .040" aluminum (Pro Fascia) .050" and .063" aluminum (Pro Extended Fascia)	
<b>FINISHES</b>	Mill aluminum Pre-finished Kynar 500® (See standard color chart) Premium pre-finished Kynar 500® (See standard color chart) Post-finished Kynar 500® Pre-finished anodized aluminum — clear, bronze, or black Post-finished anodized aluminum Custom post-coated Kynar 500® finishes are available	
<b>PRE-PUNCHED HOLES</b>	12 in. (305 mm) o.c.	



Visit [gaf.com/PerimeterEdgeMetal](http://gaf.com/PerimeterEdgeMetal)

We protect what matters most™

