

**20-YEAR MAX
WARRANTY**

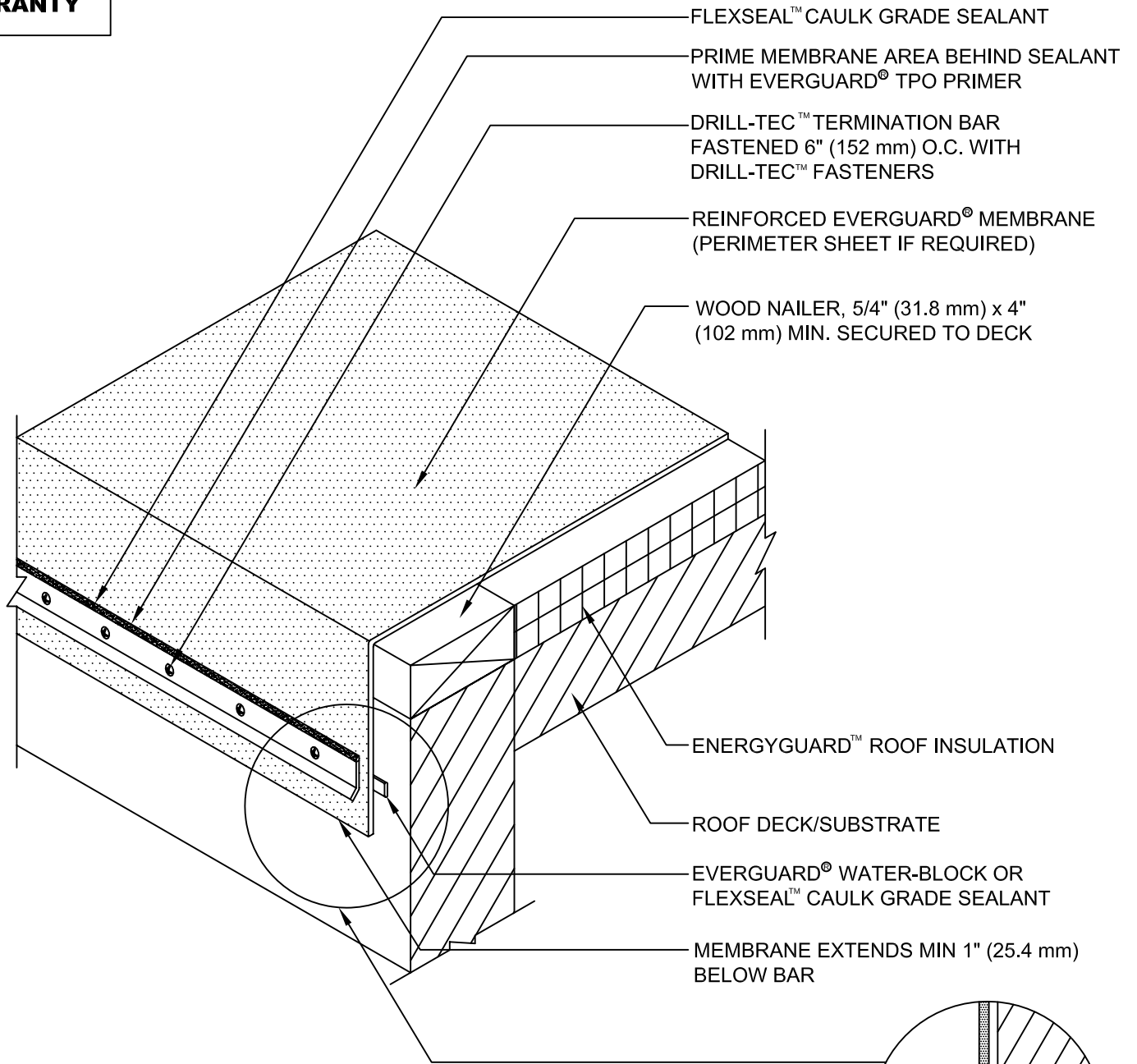

NOTE:

1. TERMINATION BAR MUST BE FASTENED 6" (152 mm) O.C. FOR THIS DETAIL.
2. FOR INSULATION THICKNESS GREATER THAN 8" (203 mm), A HARD BOARD IS REQUIRED ON MECHANICALLY FASTENED SYSTEMS ONLY.
3. APPLY EVERGUARD® TPO CUT EDGE SEALANT TO ALL CUT REINFORCED TPO EDGES (REFER TO EVERGUARD® DETAIL 115).

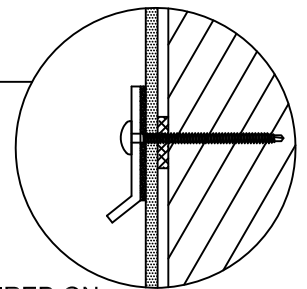

GAF
www.gaf.com
1 Campus Drive,
Parsippany, NJ 07054

EverGuard
SINGLE-PLY ROOFING SYSTEMS
ROOF EDGE SERIES

DRAWING #
208

SCALE
N.T.S.

**TERMINATION BAR ROOF EDGE
DETAIL**

THIS DETAIL APPLIES TO:
Adhered Systems
Self-Adhered Systems
TriPosite Systems
Mechanically Attached Systems

REVISION DATE
6-20-16