

**FOR JOBS UP TO 50 SQUARES ONLY**

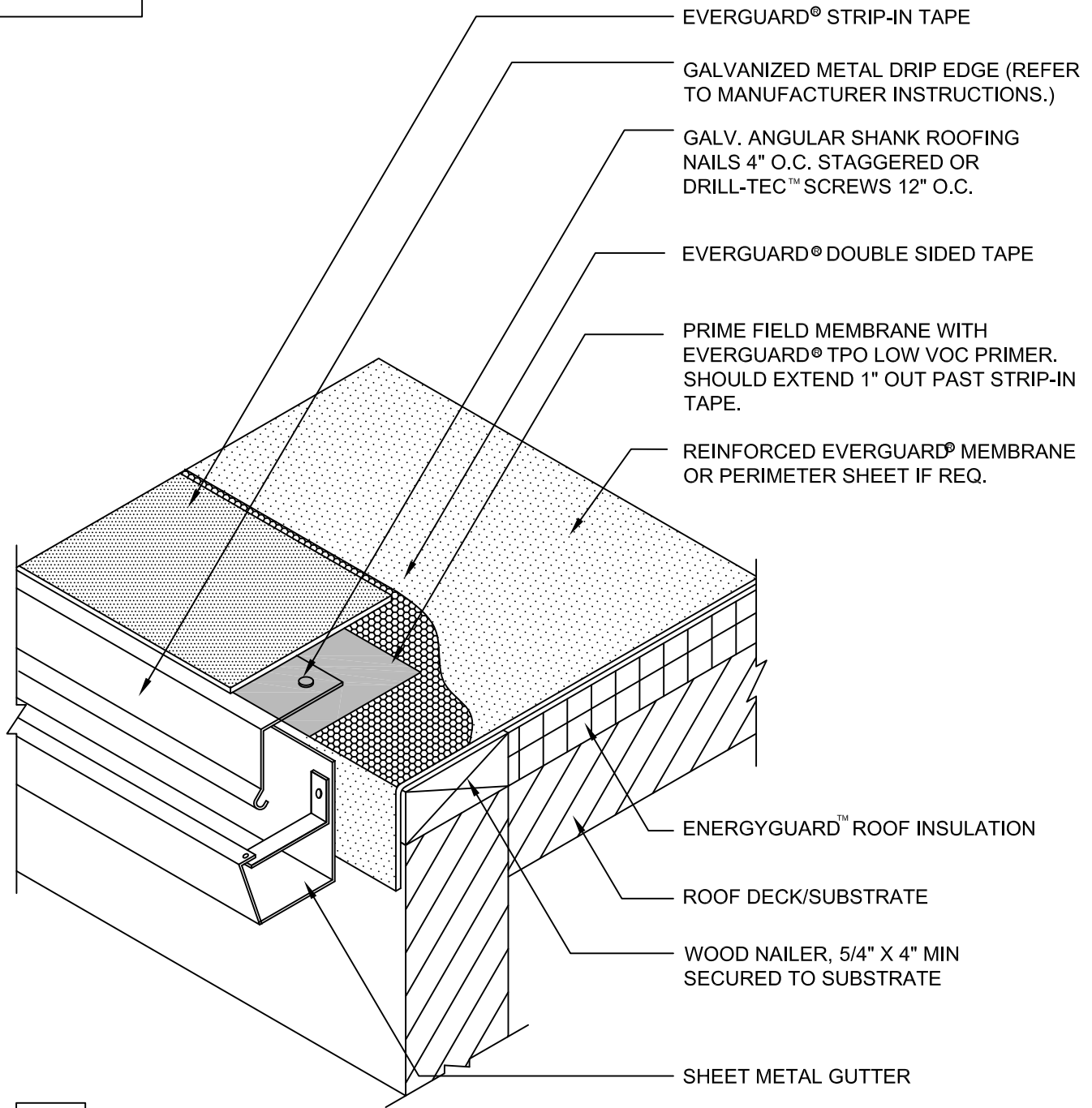

**NOTE:**

1. BE SURE TO CLEAN METAL AND MEMBRANE WITH EVERGUARD® TPO SEAM CLEANER BEFORE PRIMING.
2. APPLY TOPCOAT® FLEXSEAL™ CAULK GRADE TO ALL EVERGUARD® STRIP-IN TAPE EDGES.
3. MEMBRANE MUST BE PRIMED AND DRY PRIOR TO APPLYING EVERGUARD® DOUBLE SIDED TAPE.



**EverGuard**  
SINGLE-PLY ROOFING SYSTEMS  
ROOF EDGE SERIES

DRAWING #

**711**

**GUTTER EDGE DETAIL**

THIS DETAIL APPLIES TO:

**Taped Seam Systems**

www.gaf.com  
1 Campus Drive,  
Parsippany, NJ 07054

SCALE  
N.T.S.

REVISION DATE  
5-1-15