

**FOR JOBS UP TO 50
SQUARES ONLY**

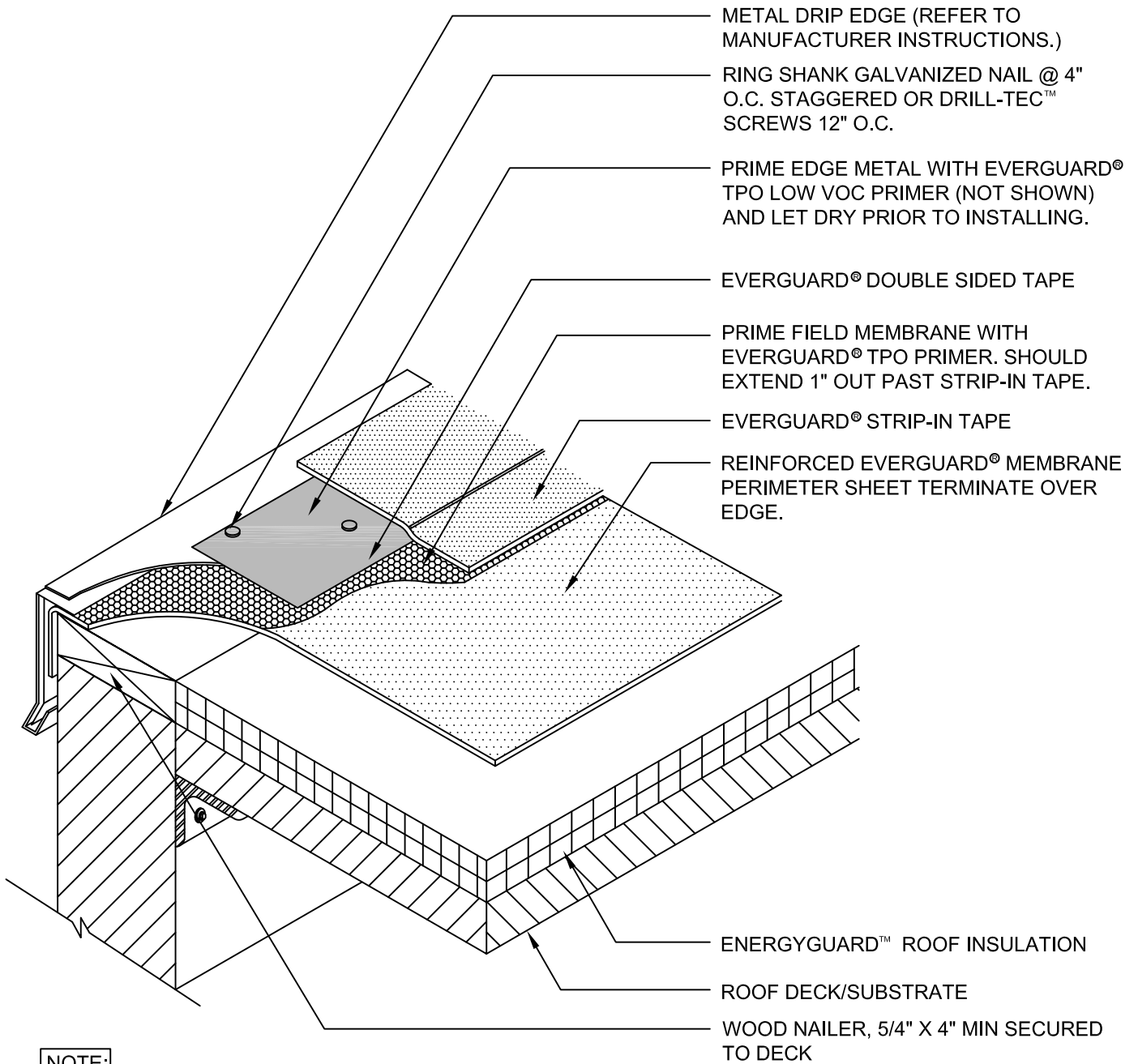

NOTE:

1. THIS DETAIL IS NOT TO BE USED ON SLOPES GREATER THAN 1/12.
2. APPLY TOPCOAT® FLEXSEAL™ CAULK GRADE TO ALL EVERGUARD® STRIP-IN TAPE EDGES.
3. MEMBRANE AND METAL MUST BE PRIMED AND DRY PRIOR TO APPLYING EVERGUARD® DOUBLE SIDED TAPE.



www.gaf.com
1 Campus Drive,
Parsippany, NJ 07054

EverGuard
SINGLE-PLY ROOFING SYSTEMS
ROOF EDGE SERIES

DRAWING #

713

SCALE
N.T.S.

**ROOF EDGE WITH
STRIP-IN TAPE DETAIL**

THIS DETAIL APPLIES TO:

**Taped Seam
Systems**

REVISION DATE
5-1-15