

**FLASHING KEY**

- 24" - 54" (610 mm - 1.37 m)  
REQUIRES BONDING ADHESIVE
- UP TO 24" (610 mm) DRY HUNG

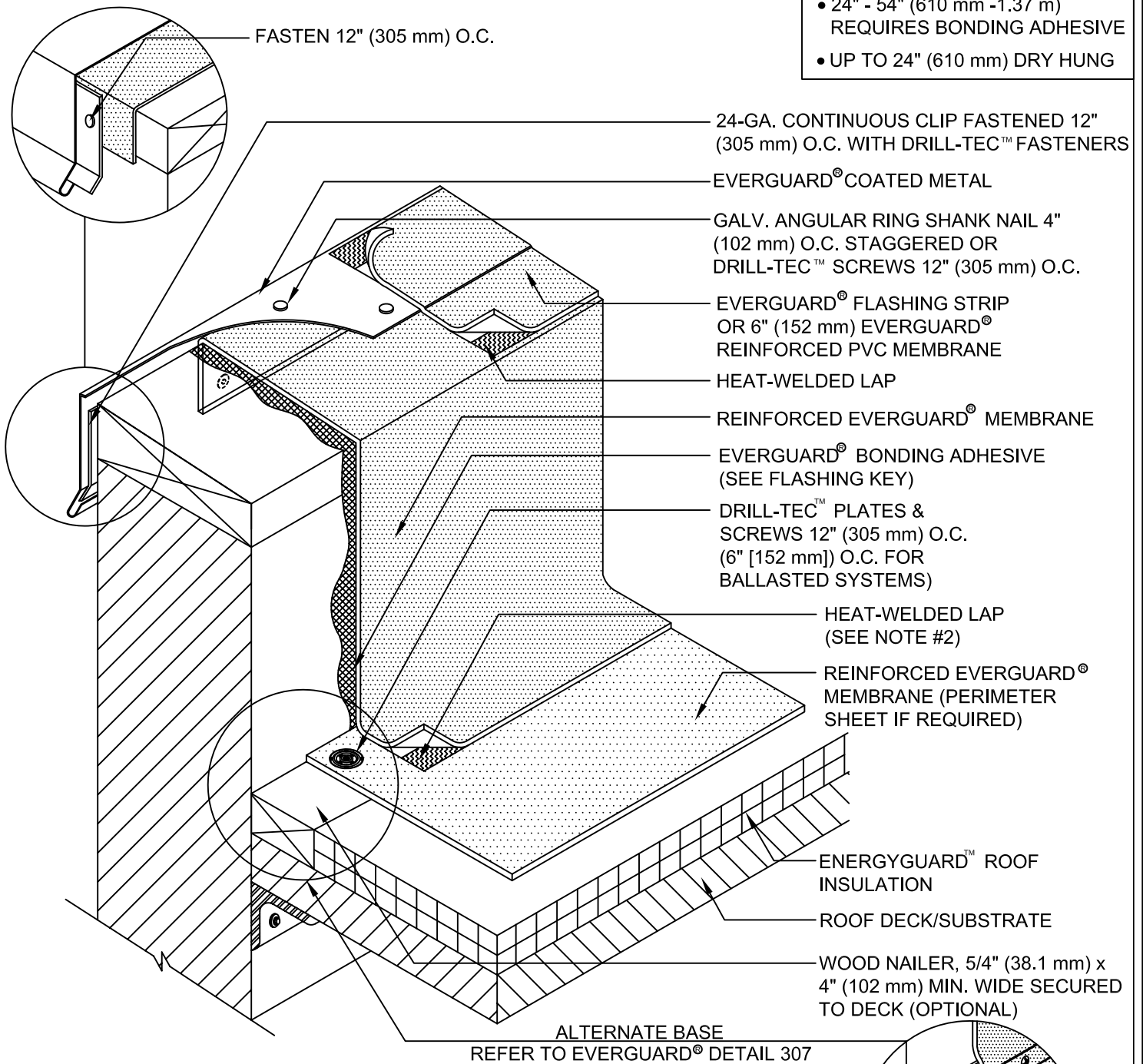

ALTERNATE BASE  
REFER TO EVERGUARD® DETAIL 307

**NOTE:**

1. FOR INSULATION THICKNESS GREATER THAN 8" (203 mm), A HARD BOARD IS REQUIRED ON MECHANICALLY FASTENED SYSTEMS ONLY.
2. IF EVERGUARD®FREEDOM™ MEMBRANE IS USED, BONDING ADHESIVE IS NOT NEEDED AND WALL MUST BE PRIMED
3. APPLY EVERGUARD® TPO CUT EDGE SEALANT TO ALL CUT REINFORCED TPO EDGES (REFER TO EVERGUARD® DETAIL 115).

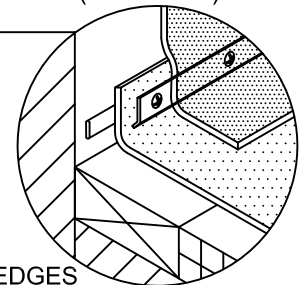

**EverGuard**  
SINGLE-PLY ROOFING SYSTEMS  
PARAPET WALL &  
CURB SERIES

DRAWING #  
**304**  
SCALE  
N.T.S.

**WALL FLASHING WITH COATED  
METAL EDGE DETAIL**

THIS DETAIL APPLIES TO:  
**ALL SYSTEMS**  
REVISION DATE  
6-20-16