

NOTE:

1. DETAIL TO BE USED IN CONJUNCTION WITH STANDARD GUIDE SPECIFICATION CONTAINING REQUIREMENTS FOR NAILERS, INSULATION ETC.
2. FOR INSULATION THICKNESS GREATER THAN 8" (203 mm), A HARD BOARD IS REQUIRED ON MECHANICALLY FASTENED SYSTEMS ONLY.
3. APPLY EVERGUARD® TPO CUT EDGE SEALANT TO ALL CUT REINFORCED TPO EDGES (REFER TO EVERGUARD® DETAIL 115).

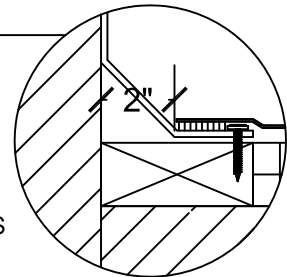

www.gaf.com
1 Campus Drive,
Parlisppany, NJ 07054

EverGuard
SINGLE-PLY ROOFING SYSTEMS
PARAPET WALL &
CURB SERIES

DRAWING #
310
SCALE
N.T.S.

**COATED METAL WALL FLASHING
JOINT DETAIL**

THIS DETAIL APPLIES TO:
Adhered Systems
Ballasted Systems
Mechanically Attached Systems
TriPosite Systems

REVISION DATE
5-1-16