

**15-YEAR MAX  
WARRANTY**

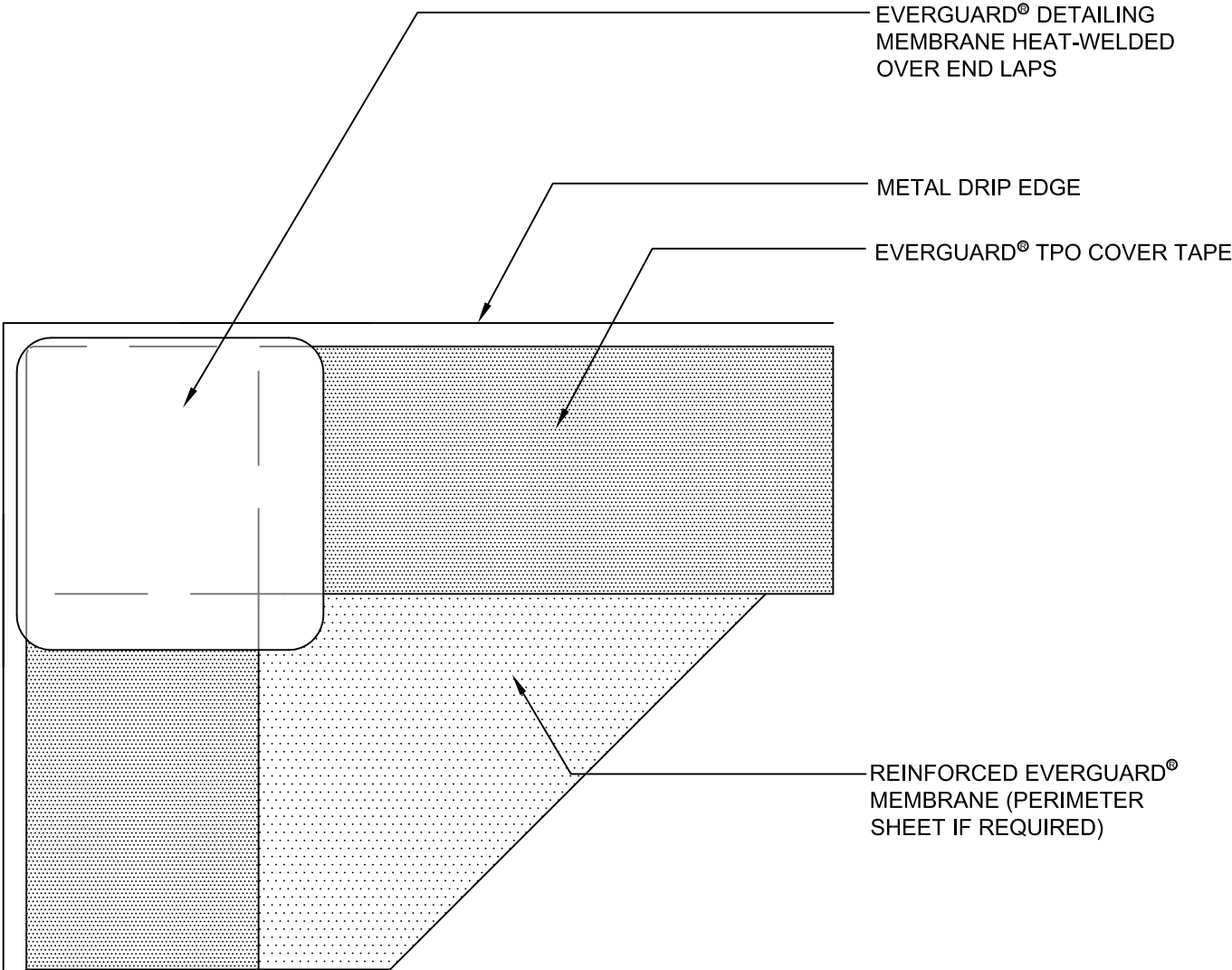

**NOTE:**

1. CLEAN METAL AND MEMBRANE WITH EVERGUARD® TPO SEAM CLEANER AND ALLOW TO DRY BEFORE PRIMING.
2. PRIME MEMBRANE AND METAL EDGE BEFORE INSTALLING EVERGUARD TPO COVER TAPE
3. APPLY EVERGUARD® TPO CUT EDGE SEALANT TO ALL CUT REINFORCED TPO EDGES (REFER TO EVERGUARD® DETAIL 115).



www.gaf.com  
1 Campus Drive,  
Parsippany, NJ 07054

**EverGuard**  
SINGLE-PLY ROOFING SYSTEMS  
ROOF EDGE SERIES

DRAWING #

**216**

SCALE  
N.T.S.

**TPO COVER TAPE AT METAL DRIP  
EDGE CORNER DETAIL**

**THIS DETAIL APPLIES TO:**  
Adhered Systems  
Mechanically Attached Systems  
Self-Adhered Systems  
TriPosite Systems

REVISION DATE  
**6-20-16**