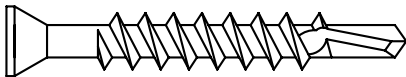
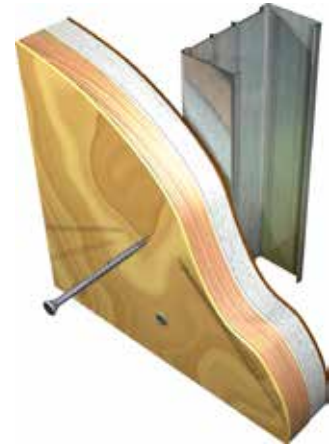

Heavy Gauge Metal (20ga or thicker)**Product #242****Trim Head DRIVALL® Self Drilling** (1 OF 2)**Attaches wood trim over single or double layer gypsum board to 20-12 ga. steel.****Finish - Black/Gray Phosphate**Trim
Head

Drill Point

#1 Square
Drive**APPLICATIONS**

- ▶ Wood trim over single and double layer gypsum board to 20-12 gauge steel studs and track

PRODUCT FEATURES

- ▶ Self tapping drill point is designed for penetration into 20-12 gauge steel
- ▶ #1 Phillips recess or #1 square drive
- ▶ Trim head leaves a finished surface

SPECIFICATIONS

- ▶ Gauge – #7 and #8
- ▶ Lengths – 1-5/8" to 3"
- ▶ Head Type – Trim
- ▶ Recess Type - #1 Square
- ▶ Thread Type – Single Lead
- ▶ Finish – Gray Phosphate, Clear Zinc
- ▶ GRABBER® screws are manufactured in an ISO 9001 and ISO 14001 certified and approved factory.

INSTALLATION GUIDELINES

- ▶ Use a standard screwgun with a depth-sensitive nose piece. Suggested screwgun specification for optimal performance – 4 amps minimum and RPM range of 0 to 2,500.
- ▶ The Trim head is fully seated when the head is flush with the work surface.
- ▶ Overdriving may result in failure of the fastener or stripout of the work surface.
- ▶ The fastener must penetrate beyond the metal a minimum of three thread pitches.

Heavy Gauge Metal (20ga or thicker)

Product #242

Trim Head DRIVALL® Self Drilling (2 OF 2)

PRODUCT SIZES AND ORDERING INFORMATION

| Catalog No. | Gauge/Length | Length Metric | Quantity Per Carton | Weight Per Carton |
|-------------|--------------|---------------|---------------------|-------------------|
| 17SD | #7x1-5/8" | 41 mm | 5 M | 28.00(lbs) |
| 18SD | #7x2-1/4" | 57 mm | 4 M | 29.00(lbs) |
| 17SD76 | #8x3" | 76 mm | 2 M | 22.00(lbs) |

PRODUCT DIMENSIONS (MILLIMETERS)

| Gauge | B Head Dia | Recess Depth | W Gauging Width | d Shank Dia | d1 Minor Dia | d2 Major Dia | TPI |
|-------|------------|--------------|-----------------|-------------|--------------|--------------|-----|
| #7 | 5.30 | 1.50 | #1 | 3.03 | 2.45 | 3.75 | 19 |
| | 5.80 | 2.08 | | 3.07 | 2.65 | 3.95 | |
| #8 | 5.30 | 1.50 | #1 | 3.28 | 2.85 | 4.05 | 18 |
| | 5.80 | 2.08 | | 3.32 | 3.05 | 4.25 | |

PULL-OUT TEST DATA

| Screw Gauge | Metal Gauge | Tension (lbs.) | Shear (lbs.) |
|-------------|-------------|----------------|--------------|
| #7 | 14 | 708 | 1479 |
| | 16 | 454 | 1148 |
| | 18 | 361 | 1140 |
| | 20 | 213 | 777 |
| #8 | 14 | 450 | 1012 |
| | 16 | 442 | 955 |
| | 18 | 340 | 1045 |
| | 20 | 265 | 680 |

**GRABBER fasteners are not categorized as structural bolts. The figures listed above are ultimate average values achieved under independent laboratory conditions, and apply to GRABBER Line fasteners only. An appropriate safety factor must be determined by a qualified professional for design purposes.

STANDARD CORROSION TEST RESULTS

| Finish | Test | Standard/Protocol | Results |
|----------------------|--------------------|-------------------|-----------------------|
| Black/Gray Phosphate | Salt Spray Results | ASTM B117 | 24 hours, no red rust |

SHEET STEEL GAUGES

| Gauge No. | Decimal Equivalent | Millimeter Equivalent |
|-----------|--------------------|-----------------------|
| 14 | 0.0713" | 1.8 mm |
| 16 | 0.0566" | 1.5 mm |
| 18 | 0.0451" | 1.2 mm |
| 20 | 0.0396" | 1 mm |

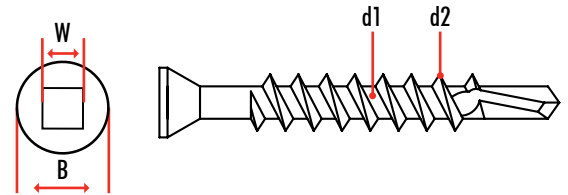

DRILLING CAPACITY

| Screw Gauge | Drill Point | Max Panel Thickness | Steel Thickness Gauge Range |
|-------------|-------------|---------------------|-----------------------------|
| 6 | 3 | 0.090-0.110 | 20-12 |
| 8 | 3 | 0.100-0.140 | 20-12 |

All GRABBER® screw products are manufactured in facilities that are ISO 9001 certified. ©2012 GRABBER Construction Products, Inc. GRABBER®, STREAKER®, DRIVALL®, LOX®, GRABBERGARD® and SCAVENGER® are registered trademarks of Grabber Construction Products, Inc.

