

## Bugle Head Drywall Screw

### Gypsum Board to Wood

**GRABBER®**  
CONSTRUCTION PRODUCTS

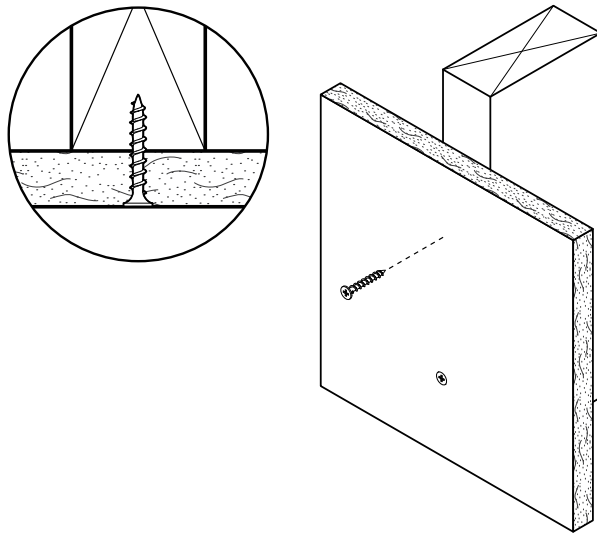

Bugle Head



Phillips

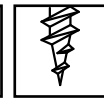

23° Grabber®  
Point

**Description** Attaches gypsum board to wood.

#### Specifications

**Size | Gauge:** #6 to #10

**Length:** 1 in. to 4 in.

**Head Type:** Bugle

**Recess Type:** #2 Phillips

**Thread Type:** Single Lead, Coarse

**Finish:** Phosphate, Clear Zinc, Yellow Zinc

**Quality Assurance:** Grabber® fasteners are manufactured in ISO 9001 and ISO 14001 certified and approved factories.

**LEED Reporting:** The post-consumer recycled steel content is 25%.

**Compliance:** The fasteners comply with ASTM C1002 performance requirements.

#### Applications

- 3/8 in., 1/2 in., and 5/8 in. single-layer gypsum board to wood studs and joists
- 1/2 in. and 5/8 in. double-layer gypsum board to wood studs and joists
- Insulation to wood
- OSB or plywood to wood
- Wood-to-wood applications

#### Installation

- Use a standard screw gun with a depth-sensitive nose piece. Suggested screw gun specification for optimal performance: sizes #6 to #10, up to 4,000 RPM.
- For gypsum board, the bugle head is fully seated when the screw is below the surface of the wallboard, in accordance with ASTM C1002.
- Overdriving may result in failure of the fastener or failure of the gypsum board.

#### Features

- A coarse thread screw for attaching drywall to interior wood studs and joists.
- Extra-sharp, single lead 23° Grabber® point, designed to penetrate quickly and easily.
- Grabber's Pro-Fit #2 Phillips is a precision recess designed for better bit engagement, resulting in less wobble or strip-out.

# Bugle Head Drywall Screw

## Gypsum Board to Wood

**GRABBER®**  
CONSTRUCTION PRODUCTS

Interior Wood

Gypsum Board, Sheathing, Insulation Board to Wood

### Standard Corrosion Test Results

Finish	Test	Standard/Protocol	Results
Phosphate	Salt Spray	ASTM B117	24 hrs., no red rust
Clear Zinc	Salt Spray	ASTM B117	12 hrs., no red rust
Yellow Zinc	Salt Spray	ASTM B117	24 hrs., no red rust

Note: Salt Spray Testing (SST) results are not intended to predict corrosion in real-world environments. The ASTM B117 standard for SST is recognized industry-wide as an effective tool for comparing different metals and different metal coatings in a tightly controlled, highly corrosive environment for specific periods of time. For more information about corrosion resistance, refer to Grabber's Coatings and Corrosion Resistance Classifications in the Technical Data section of Grabber Fastener Solutions, PG1000. Consult with a corrosion specialist or the architect or engineer of record for detailed guidance and recommendations specific to your project.

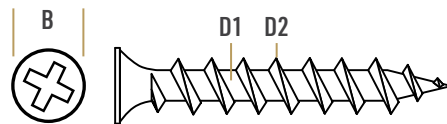

### Product Dimensions

Size	B Head Dia.	Recess	D1 Minor Dia.	D2 Major Dia.	TPI <sup>1</sup>
#6	0.325 in.	#2 Phillips	0.089 in.	0.138 in.	8
#7	0.321 in.	#2 Phillips	0.100 in.	0.151 in.	8
#8	0.321 in.	#2 Phillips	0.114 in.	0.164 in.	8
#10	0.343 in.	#2 Phillips	0.132 in.	0.190 in.	8

<sup>1</sup>TPI stands for Threads Per Inch. This is a count of the number of threads per inch measured along the length of a fastener.

### General Wood Substrate Load Data

Item No.	Shear Strength <sup>1</sup>	Tensile Strength <sup>1</sup>	Withdrawal Capacity <sup>2</sup>	Lateral Resistance <sup>2</sup>	
				1/2 in. Gypsum Panel	5/8 in. Gypsum Panel
300	176 ksi	195 ksi	398 lbf. / in. penetration	122 lbf. / fastener	189 lbf. / fastener

<sup>1</sup>Testing per AISI S904, Standard Test Methods for Determining the Tensile and Shear Strength of Screws, American Iron and Steel Institute.

<sup>2</sup>Testing per ASTM D1761, Standard Test Methods for Mechanical Fasteners in Wood and Wood-Based Materials.

### Ordering Information and Product Options

Item No.	Size	Recess	Head Diameter	TPI <sup>1</sup>	Quantity	Weight	Special Features
Phosphate							
100	6 x 1 in.	#2 Phillips	0.325 in.	8	10,000	31 lb.	
200	6 x 1 1/8 in.	#2 Phillips	0.325 in.	8	10,000	34 lb.	
300HP	6 x 1 1/4 in.	#2 Phillips	0.325 in.	8	4,000	16 lb.	
300	6 x 1 1/4 in.	#2 Phillips	0.325 in.	8	8,000	30 lb.	
40012	6 x 1 1/2 in.	#2 Phillips	0.325 in.	8	5,000	22 lb.	
400	6 x 1 5/8 in.	#2 Phillips	0.325 in.	8	5,000	23 lb.	
500	7 x 2 in.	#2 Phillips	0.325 in.	8	3,500	23 lb.	
600	7 x 2 1/4 in.	#2 Phillips	0.325 in.	8	3,000	23 lb.	
900	8 x 2 1/2 in.	#2 Phillips	0.325 in.	8	2,500	24 lb.	
1100	8 x 3 in.	#2 Phillips	0.325 in.	8	2,000	23 lb.	
1200	10 x 3 1/2 in.	#2 Phillips	0.325 in.	8	1,000	18 lb.	
1300	10 x 4 in.	#2 Phillips	0.325 in.	8	1,000	21 lb.	

# Bugle Head Drywall Screw

## Gypsum Board to Wood

**GRABBER®**  
 CONSTRUCTION PRODUCTS

### Ordering Information and Product Options (continued)

Item No.	Size	Recess	Head Diameter	TPI <sup>1</sup>	Quantity	Weight	Special Features
1300F	10 x 4 in.	#2 Phillips	0.325 in.	8	1,000	21 lb.	Fully threaded
C300	6 x 1 1/4 in.	#2 Phillips	0.325 in.	8	1,000	5 lb.	Collated
C375	7 x 1 3/4 in.	#2 Phillips	0.325 in.	8	1,000	5 lb.	
C400	6 x 1 5/8 in.	#2 Phillips	0.325 in.	8	1,000	5 lb.	
C500	7 x 2 in.	#2 Phillips	0.325 in.	8	1,000	5 lb.	
C900	8 x 2 1/2 in.	#2 Phillips	0.325 in.	8	1,000	5 lb.	
Clear Zinc							
100Z	6 x 1 in.	#2 Phillips	0.325 in.	8	10,000	31 lb.	
200Z	6 x 1 1/8 in.	#2 Phillips	0.325 in.	8	10,000	34 lb.	
300Z	6 x 1 1/4 in.	#2 Phillips	0.325 in.	8	8,000	30 lb.	
400Z	6 x 1 5/8 in.	#2 Phillips	0.325 in.	8	5,000	23 lb.	
500Z	7 x 2 in.	#2 Phillips	0.325 in.	8	3,500	23 lb.	
600Z	7 x 2 1/4 in.	#2 Phillips	0.325 in.	8	3,000	23 lb.	
900Z	8 x 2 1/2 in.	#2 Phillips	0.325 in.	8	2,500	24 lb.	
1100Z	8 x 3 in.	#2 Phillips	0.325 in.	8	2,000	23 lb.	
1200Z	10 x 3 1/2 in.	#2 Phillips	0.325 in.	8	1,000	18 lb.	
1300Z	10 x 4 in.	#2 Phillips	0.325 in.	8	1,000	21 lb.	
Yellow Zinc							
100YZ	6 x 1 in.	#2 Phillips	0.325 in.	8	10,000	31 lb.	
200YZ	6 x 1 1/8 in.	#2 Phillips	0.325 in.	8	10,000	34 lb.	
300YZ	6 x 1 1/4 in.	#2 Phillips	0.325 in.	8	8,000	30 lb.	
400YZ	6 x 1 5/8 in.	#2 Phillips	0.325 in.	8	5,000	23 lb.	
375YZ	7 x 1 3/4 in.	#2 Phillips	0.325 in.	8	5,000	29 lb.	
500YZ	7 x 2 in.	#2 Phillips	0.325 in.	8	3,500	23 lb.	
600YZ	7 x 2 1/4 in.	#2 Phillips	0.325 in.	8	3,000	23 lb.	
900YZ	8 x 2 1/2 in.	#2 Phillips	0.325 in.	8	2,500	24 lb.	
1100YZ	8 x 3 in.	#2 Phillips	0.325 in.	8	2,000	23 lb.	
1200YZ	10 x 3 1/2 in.	#2 Phillips	0.325 in.	8	1,000	18 lb.	
1300YZ	10 x 4 in.	#2 Phillips	0.325 in.	8	1,000	21 lb.	
C300YZ	6 x 1 1/4 in.	#2 Phillips	0.325 in.	8	1,000	5 lb.	Collated
C400YZ	6 x 1 5/8 in.	#2 Phillips	0.325 in.	8	1,000	5 lb.	
C900YZ	8 x 2 1/2 in.	#2 Phillips	0.325 in.	8	1,000	5 lb.	

<sup>1</sup>TPI stands for Threads Per Inch. This is a count of the number of threads per inch measured along the length of a fastener.

Note: Product availability is subject to change without prior notice and the availability of products may differ from what is printed in literature and displayed on our website. The items listed are bulk size. Most are also available in smaller packages such as 5 lb. and 1 lb. Contact your local Grabber Branch or GrabberPro for more information.

Bugle Head Drywall Screws  
 PS1003 USA-ENG/Rev. 02-25

GRABBER CONSTRUCTION PRODUCTS, INC.  
 5255 W 11000 N., STE 100  
 HIGHLAND, UT 84003

(800) 477-8876 | GrabberPro.com

**SAFETY FIRST:** Wear appropriate personal protective equipment. Read applicable SDS and literature before handling and installation.

**TECHNICAL INFORMATION:** Technical information contained herein is furnished without charge or obligation and is given and accepted at the recipient's sole risk. Because conditions of use may vary and are beyond our control, Grabber Construction Products makes no representation about, and is not responsible or liable for, the accuracy or reliability of data associated with uses of any product described herein. Grabber Construction Products reserves the right to modify this document without prior notice.

© 2025 Grabber Construction Products, Inc. | All rights reserved | Printed in U.S.A.  
 The trademarks Grabber, and Stylized G on Grabber Fasteners, are trademarks of Grabber Construction Products, Inc.

