

Trim Head Driller - Exterior

Wood Trim Over Gypsum Board to Heavy-Gauge Steel

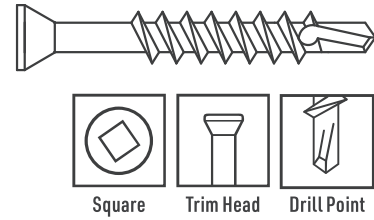
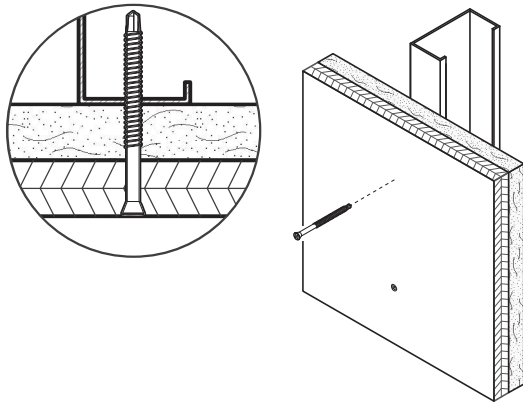

Description Attaches wood trim over single- or double-layer gypsum board to heavy-gauge steel.

Specifications

Size | Gauge: #7 and #8
Length: 1 5/8 in. to 3 in.
Head Type: Trim Head
Recess Type: #1 Square
Thread Type: Fine
Thread Length: Varies by item.
 Refer to the thread length reference section for specific dimensions.

Finish: GrabberGard®, Stainless Steel
Quality Assurance: Grabber® fasteners are manufactured in ISO 9001 and ISO 14001 certified and approved factories.
LEED Reporting: The post-consumer recycled steel content is 25%.
Compliance: The fasteners comply with ASTM C1513 performance requirements.

Applications

- Attaches wood trim over single- or double-layer gypsum board to heavy-gauge steel studs and track

Installation

- Use a standard screw gun with a depth-sensitive nose piece. Suggested screw gun specification for optimal performance: sizes #7 and #8, up to 2,500 RPM.
- Because of significantly higher torque output, care and caution should be exercised when using an impact driver; otherwise, screw failure or spin-out may occur.
- The trim head is fully seated when it is flush with or just below the work surface.
- The fastener must penetrate beyond the steel three full thread pitches.
- Overdriving may result in failure of the fastener.

Features

- Self-tapping drill point is designed for penetration into heavy-gauge steel.
- The trim head leaves a less-noticeable, finished surface.
- Consistently formed extra-sharp drill point starts and drills easily into heavy-gauge steel.
- GrabberGard® exterior-grade coating provides additional protection against corrosion in most exterior applications.
- The #1 Square is a precision recess designed for secure bit engagement in trim to wood or heavy-gauge steel applications.

Trim Head Driller - Exterior

Wood Trim Over Gypsum Board to Heavy-Gauge Steel



Standard Corrosion Test Results

| Finish | Test | Standard/Protocol | Results |
|--------------|------------|-------------------|-------------------------|
| GrabberGard® | Salt Spray | ASTM B117 | 1,000 hrs., no red rust |

Note: Salt Spray Testing (SST) results are not intended to predict corrosion in real-world environments. The ASTM B117 standard for SST is recognized industry-wide as an effective tool for comparing different metals and different metal coatings in a tightly controlled, highly corrosive environment for specific periods of time. For more information about corrosion resistance, see the Grabber Guide to Corrosion Resistance for Fasteners.

Pull-Out Test Data¹

| Screw Gauge | TPI ² | Steel Gauge | Design Thickness | Tension | Shear |
|-------------|------------------|-------------|------------------|----------|------------|
| #7 | 19 | 18 | 0.0451 in. | 87 lbs. | 234 lbs. |
| | | 16 | 0.0566 in. | 157 lbs. | 330 lbs. |
| | | 14 | 0.0713 in. | 198 lbs. | 466 lbs. |
| | | 12 | 0.1017 in. | 283 lbs. | 794 lbs. |
| | | 10 | 0.1242 in. | 345 lbs. | 1,069 lbs. |
| #8 | 18 | 18 | 0.0451 in. | 94 lbs. | 244 lbs. |
| | | 16 | 0.0566 in. | 171 lbs. | 344 lbs. |
| | | 14 | 0.0713 in. | 215 lbs. | 486 lbs. |
| | | 12 | 0.1017 in. | 307 lbs. | 827 lbs. |
| | | 10 | 0.1242 in. | 375 lbs. | 1,114 lbs. |

¹Test data values reported are allowable as determined by calculations and industry established test criteria, such as ICC-ES Acceptance Criteria and ASTM test standards. Please contact Grabber for detailed information about testing performed for specific products or if ultimate values are needed.

Sheet Steel Gauges

| Gauge No. | Design Thickness | Millimeter Equivalent |
|-----------|------------------|-----------------------|
| 25 | 0.0188 in. | 0.4775 mm |
| 20 | 0.0346 in. | 0.8788 mm |
| 18 | 0.0451 in. | 1.1455 mm |
| 16 | 0.0566 in. | 1.4376 mm |
| 14 | 0.0713 in. | 1.8110 mm |
| 12 | 0.1017 in. | 2.5832 mm |
| 10 | 0.1242 in. | 3.1547 mm |

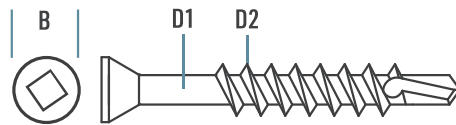

Product Dimensions

| Screw Gauge | B Head Dia. | Recess | D1 Minor Dia. | D2 Major Dia. | TPI ² |
|-------------|-------------|-----------|---------------|---------------|------------------|
| #7 | 0.219 in. | #1 Square | 0.100 in. | 0.151 in. | 19 |
| #8 | 0.219 in. | #1 Square | 0.116 in. | 0.164 in. | 18 |

²TPI stands for Threads Per Inch. This is a count of the number of threads per inch measured along the length of a fastener.

Thread Length: Dimensions vary by item. Consult the thread length reference section at the back of the catalog for item-specific details.

Trim Head Driller - Exterior

Wood Trim Over Gypsum Board to Heavy-Gauge Steel



Ordering Information and Product Options

| Item No. | Size | Recess | Head Dia. | TPI | Quantity | Weight | Special Features |
|----------------------------|---------------|-----------|-----------|-----|----------|--------|------------------|
| GrabberGard® Gray | | | | | | | |
| 17SD76RG | 8 x 3 in. | #1 Square | 0.219 in. | 18 | 2,000 | 23 lb. | |
| 410 Stainless Steel | | | | | | | |
| 17SD410 | 7 x 1 5/8 in. | #1 Square | 0.219 in. | 19 | 5,000 | 27 lb. | |

Note: Product availability is subject to change without prior notice and the availability of products may differ from what is printed in literature and displayed on our website. The items listed are bulk size. Most are also available in smaller package sizes such as 5 lb. and 1 lb. Contact your local Grabber Branch or GrabberPro for more information.

Trim Head Driller - Exterior
PS1049 USA-ENG/Rev. 2-26

Grabber Construction Products, Inc.
3125 W. Executive Pkwy., Suite 200
Lehi, UT 84048

(800) 477-8876 | GrabberPro.com

SAFETY FIRST: Wear appropriate personal protective equipment. Read applicable SDS and literature before handling and installation.

TECHNICAL INFORMATION: Technical information contained herein is furnished without charge or obligation and is given and accepted at the recipient's sole risk. Because conditions of use may vary and are beyond our control, Grabber Construction Products makes no representation about, and is not responsible or liable for, the accuracy or reliability of data associated with uses of any product described herein. Grabber Construction Products reserves the right to modify this document without prior notice.

© 2026 Grabber Construction Products, Inc. | All rights reserved | Printed in U.S.A.
The trademarks Grabber, GrabberGard, and Stylized G on Grabber Fasteners, are trademarks of Grabber Construction Products, Inc.

