

## Cupped Head Drywall Nail

Drywall to Wood

**GRABBER®**  
CONSTRUCTION PRODUCTS

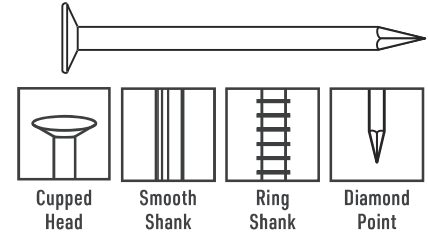
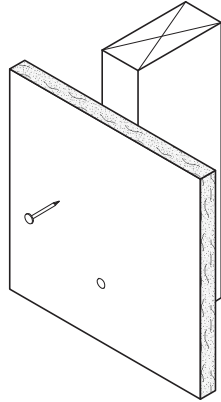
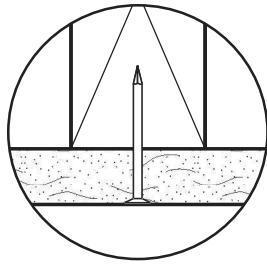

**Description** Attaches gypsum board to wood.

**Specifications**

**Size | Gauge:** 11.5 to 13  
**Length:** 1 3/16 in. to 2 3/8 in.  
**Head Type:** Cupped  
**Shank Type:** Smooth, Ring  
**Finish:** Phosphate

**Quality Assurance:** Grabber® fasteners are manufactured in ISO 9001 and ISO 14001 certified and approved factories.  
**LEED Reporting:** The post-consumer recycled steel content is 25%.  
**Compliance:** The fasteners comply with ASTM F1667 performance requirements.

**Applications**

- 3/8 in., 1/2 in., and 5/8 in. single-layer gypsum board to wood studs
- 1/2 in. and 5/8 in. double-layer gypsum board to wood

**Installation**

- The head is fully seated when it's just below the surface of the gypsum board.

**Features**

- Cupped head provides a large area to hold the gypsum board and the drywall compound securely.
- Long, diamond-shaped point is designed to easily drive into wood, and it helps prevent splitting.
- Ring shank nails have robust holding power. As the nail penetrates wood, fibers lock around the grooves in the shank, creating a durable bond.
- Smooth shank penetrates the wood easily and smoothly.

# Cupped Head Drywall Nail

## Drywall to Wood

**GRABBER**  
CONSTRUCTION PRODUCTS

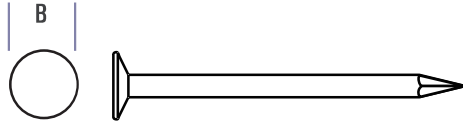

Product  
Dimensions

Nail Gauge	B Head Dia.	Wire Dia.
11.5	0.2969 in.	0.091 in.
11.5	0.3750 in.	0.099 in.
12.5	0.3438 in.	0.099 in.
13	0.2969 in.	0.091 in.
13	0.3125 in.	0.091 in.
13	0.3750 in.	0.091 in.

### Ordering Information and Product Options

Item No.	Size	Head Type	Head Dia.	Gauge	Shank Type	Quantity	Weight	Special Features
Phosphate								
DWCH1316	1 3/16 in.	Cupped	0.2969 in.	13	Smooth	19,800	50 lb.	
DWCH138	1 3/8 in.	Cupped	0.2969 in.	13	Smooth	17,000	50 lb.	
DWCH138G	1 3/8 in.	Cupped	0.3438 in.	12.5	Smooth	17,000	50 lb.	
DWCH138T	1 3/8 in.	Cupped	0.3125 in.	13	Smooth	17,000	50 lb.	
DWCH150G	1 1/2 in.	Cupped	0.3438 in.	12.5	Smooth	15,800	50 lb.	
DWCH158	1 5/8 in.	Cupped	0.2969 in.	13	Smooth	14,600	50 lb.	
DWCH158T	1 5/8 in.	Cupped	0.3750 in.	13	Smooth	14,600	50 lb.	
DWCH158G	1 5/8 in.	Cupped	0.3438 in.	12.5	Smooth	14,600	50 lb.	
DWCH178	1 7/8 in.	Cupped	0.2969 in.	13	Smooth	12,500	50 lb.	
DWCH178T	1 7/8 in.	Cupped	0.3125 in.	13	Smooth	12,500	50 lb.	
DWCH178G	1 7/8 in.	Cupped	0.3438 in.	12.5	Smooth	12,500	50 lb.	
DWCH218	2 1/8 in.	Cupped	0.3750 in.	11.5	Smooth	12,000	50 lb.	
DWCH238G	2 3/8 in.	Cupped	0.3750 in.	11.5	Smooth	10,000	50 lb.	
DWCH138RS	1 3/8 in.	Cupped	0.2969 in.	13	Ring Shank	17,000	50 lb.	

Note: Product availability is subject to change without prior notice and the availability of products may differ from what is printed in literature and displayed on our website. The items listed are bulk size. Most are also available in smaller package sizes such as 5 lb. and 1 lb. Contact your local Grabber Branch or GrabberPro for more information.

Cupped Head Drywall Nail  
PS1064 USA-ENG/Rev. 2-26

Grabber Construction Products, Inc.  
3125 W. Executive Pkwy., Suite 200  
Lehi, UT 84048

(800) 477-8876 | GrabberPro.com

**SAFETY FIRST:** Wear appropriate personal protective equipment. Read applicable SDS and literature before handling and installation.

**TECHNICAL INFORMATION:** Technical information contained herein is furnished without charge or obligation and is given and accepted at the recipient's sole risk. Because conditions of use may vary and are beyond our control, Grabber Construction Products makes no representation about, and is not responsible or liable for, the accuracy or reliability of data associated with uses of any product described herein. Grabber Construction Products reserves the right to modify this document without prior notice.

© 2026 Grabber Construction Products, Inc. | All rights reserved | Printed in U.S.A.  
The trademarks Grabber, and Stylized G on Grabber Fasteners, are trademarks of Grabber Construction Products, Inc.

