



3/4" Radius Bullnose Plastic Corner Caps

Model 135

3/4" Radius Off-Angle 3-Way Corner Cap

- Ideal for use where three corners intersect at angles of greater than 90 degrees

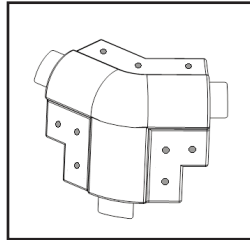

| Prod# | Stock# | Pcs/Ctn | Unit | Wt/Ctn |
|-------|--------|---------|------|--------|
| 43510 | 135 | 50 | CTN | 1 |

Model 285

3/4" Radius 2-Way Corner Cap

- Use this corner cap on windows, closets, doorways, skylights and anywhere two corners intersect at 90° angles

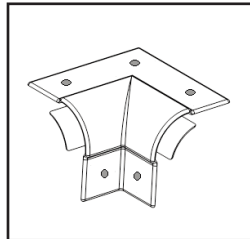

| Prod# | Stock# | Pcs/Ctn | Unit | Wt/Ctn |
|-------|--------|---------|------|--------|
| 43520 | 285 | 50 | CTN | 1 |

Model 385

3/4" Radius 3-Way Corner Cap

- Designed for use where three corners intersect at 90° angles
- Eliminates the need for time consuming mitering

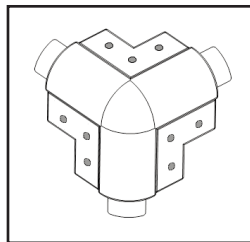

| Prod# | Stock# | Pcs/Ctn | Unit | Wt/Ctn |
|-------|--------|---------|------|--------|
| 43530 | 385 | 50 | CTN | 1 |

Model 8590

3/4" Radius Bullnose to 90° Transition Cap

- Eliminates gaps between bullnose and corner bead and baseboard of crown molding
- Installs quickly and easily
- Can be used with plastic or metal corner beads, and with baseboard or crown molding

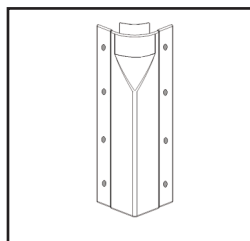

| Prod# | Stock# | Pcs/Ctn | Unit | Wt/Ctn |
|-------|--------|---------|------|--------|
| 43540 | 8590 | 50 | CTN | 2 |

3/4" Radius Bullnose Plastic Overlap Corner Caps

Model 134

3/4" Radius 3-Way Off-Angle Corner Cap

- A favorite of users of metal corner beads or tape on trims
- Designed for use wherever three corners intersect at angles of greater than 90°

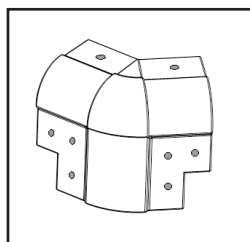

| Prod# | Stock# | Pcs/Ctn | Unit | Wt/Ctn |
|-------|--------|---------|------|--------|
| 43550 | 134 | 50 | CTN | 1 |

*Made Exclusively for Metal and Paper-Faced Beads