



3/4" Radius Bullnose Plastic Corner Caps

Model 135

3/4" Radius Off-Angle 3-Way Corner Cap

- Ideal for use where three corners intersect at angles of greater than 90 degrees

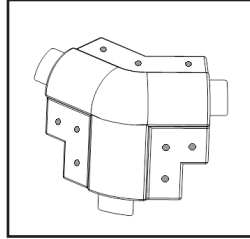

Prod#	Stock#	Pcs/Ctn	Unit	Wt/Ctn
43510	135	50	CTN	1

Model 285

3/4" Radius 2-Way Corner Cap

- Use this corner cap on windows, closets, doorways, skylights and anywhere two corners intersect at 90° angles

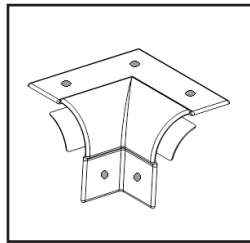

Prod#	Stock#	Pcs/Ctn	Unit	Wt/Ctn
43520	285	50	CTN	1

Model 385

3/4" Radius 3-Way Corner Cap

- Designed for use where three corners intersect at 90° angles
- Eliminates the need for time consuming mitering

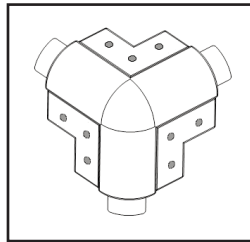

Prod#	Stock#	Pcs/Ctn	Unit	Wt/Ctn
43530	385	50	CTN	1

Model 8590

3/4" Radius Bullnose to 90° Transition Cap

- Eliminates gaps between bullnose and corner bead and baseboard of crown molding
- Installs quickly and easily
- Can be used with plastic or metal corner beads, and with baseboard or crown molding

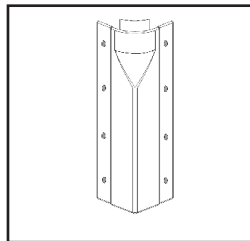

Prod#	Stock#	Pcs/Ctn	Unit	Wt/Ctn
43540	8590	50	CTN	2

3/4" Radius Bullnose Plastic Overlap Corner Caps

Model 134

3/4" Radius 3-Way Off-Angle Corner Cap

- A favorite of users of metal corner beads or tape on trims
- Designed for use wherever three corners intersect at angles of greater than 90°

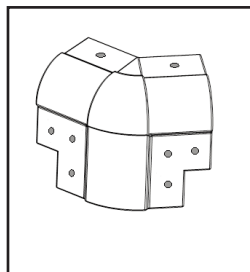

Prod#	Stock#	Pcs/Ctn	Unit	Wt/Ctn
43550	134	50	CTN	1

*Made Exclusively for Metal and Paper-Faced Beads