



3/4" Radius Bullnose Plastic Overlap Corner Caps (continued)

Model 384

3/4" Radius 3-Way Overlap Corner Cap

- This corner cap works great with metal corner beads or tape on trims
- Use anywhere three corners intersect at 90° angles

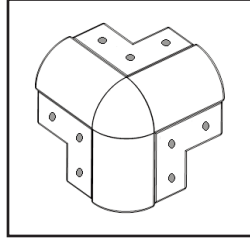

Prod#	Stock#	Pcs/Ctn	Unit	Wt/Ctn
43560	384	50	CTN	1

*Made Exclusively for Metal and Paper-Faced Beads

1-1/2" Radius Bullnose Plastic Corner Caps

Model 187

1-1/2" Radius Off-Angle 3-Way Corner Cap

- Ideal for use where three corners intersect at angles of greater than 90°

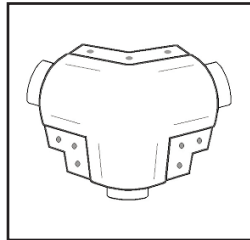

Prod#	Stock#	Pcs/Ctn	Unit	Wt/Ctn
43570	187	35	CTN	3

Model 387

1-1/2" Radius 3-Way Corner Cap

- Designed for use where three corners intersect at 90° angles
- Eliminates the need for time consuming mitering

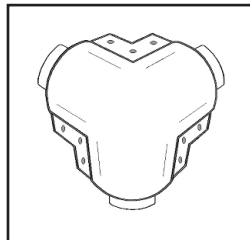

Prod#	Stock#	Pcs/Ctn	Unit	Wt/Ctn
43575	387	35	CTN	3

1/2" Radius Bullnose Plastic Corner Caps

Model 145

1/2" Radius Off-Angle 3-Way Corner Cap

- Ideal for use where three corners intersect at angles of greater than 90°

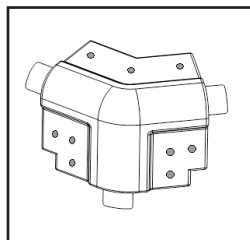

Prod#	Stock#	Pcs/Ctn	Unit	Wt/Ctn
43580	145	50	CTN	1

Model 345

1/2" Radius 3-Way Corner Cap

- Designed for use where three corners intersect at 90° angles
- Eliminates the need for time consuming mitering

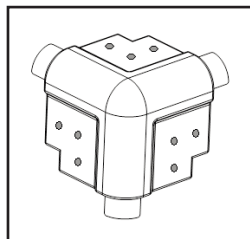

Prod#	Stock#	Pcs/Ctn	Unit	Wt/Ctn
43585	345	50	CTN	1