

Used for tying two masonry walls that require an adjustable anchoring system. #262 eye rod anchor is embedded in a CMU backup wall. The #263 pintle is placed in the veneer joint.

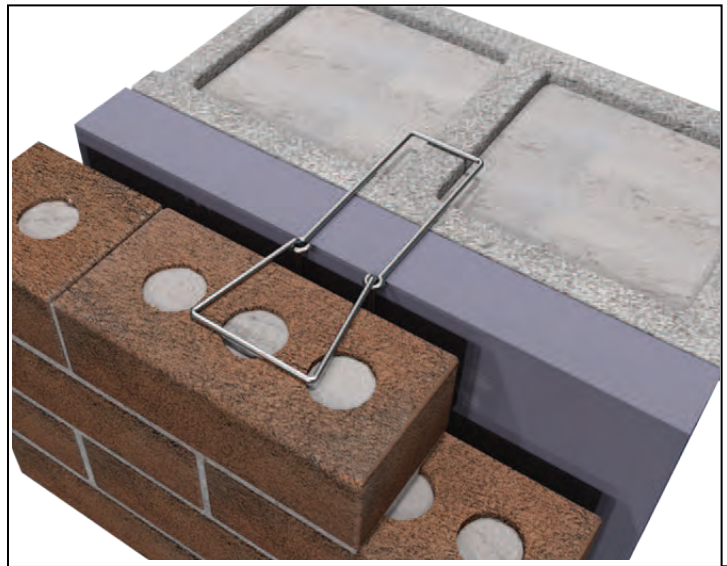
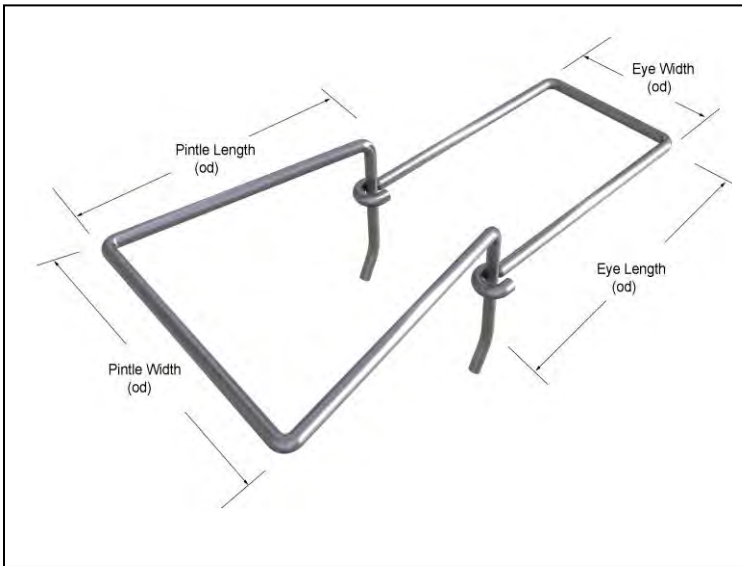

Standards:

#262 Double Eye Rod Anchor

Thickness: 3/16"
 Length: 2 3/4" 4 3/4"
 Width: 2"

#263 Double Pintle Tie

Thickness: 3/16"
 Length: 3 1/4" 4 1/4" 5 1/4"
 Width: 2-1/4"

Finish: Hot Dip Galvanized Stainless Steel

Quantity (pairs): _____

Material Specifications

Stainless Steel: Wire ties and anchors:
 ASTM A 580 AISI Type 304

Hotdip Galvanized: ASTM A 153 Class B-2:
 (1.50 oz/ ft²)(0.46kg/m²)

Plain Carbon Steel: ASTM A1008/
 A1008M Structural Steel ASTM A36/
 A36M-08

Wire: ASTM A 82/A82M Tensile Strengths
 80,000 psi Yield Point 70,000 psi