

**Submittal Sheet
 #84 Weep-Thru
 Mortar Deflector**

Weep-Thru Mortar Deflector is designed to catch mortar droppings and allow masonry cavity drainage through the weep holes. It has a three dimensional geometric patterned core and is designed to be 10 inches (25.4 cm) high in the cavity wall.

- Allows cavity drainage and protects flashing.
- Dovetail configuration allows mortar droppings to rest on two levels creating open areas for proper water drainage.
- When properly installed, will prevent clogging of weep holes.
- Will not grow mold.
- Polymer core is resistant to most known corrosive chemicals, including solvents.
- 10 inch width suspends mortar droppings above the weep holes, but below the flashing connection to the interior wall.
- Easy installation. No mechanical fasteners required.

For water drainage from cavity to the exterior see Heckmann #85 Cell Vents.

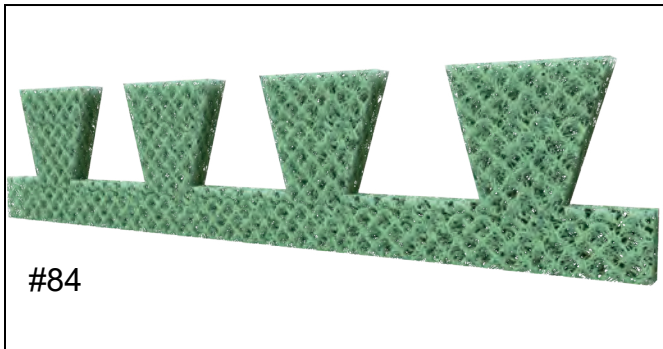

5 foot long pieces

Catalog #	Thickness	Pcs Per Box
84-5	1/2"	50
84-1	1"	20
84-2	2"	20

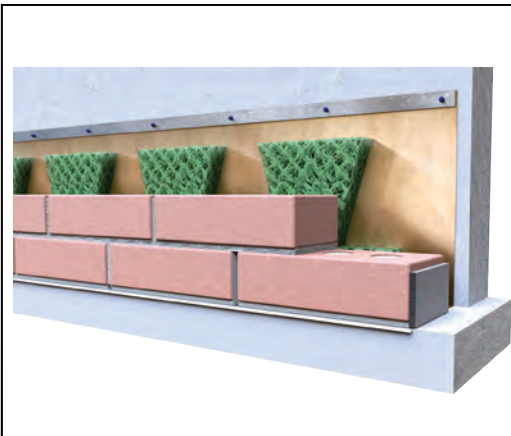

Material Specifications

Polymer core geomatrix composed of high density polyethylene strands woven into a .80" thick mesh.

Conforms to ASTM D5035.