

1" min. thickness of spf
above metal flange

Fasteners 3" to 6"
o.c., staggered

Prime metal flange before
applying Permax 3.0 to
enhance adhesion

Sheet metal edge flashing (foam
stop) approx. 4" wide flange

Continuous cleat

At locations within 12" of perimeter,
apply Permax Elastomeric Coating
at thickness 1.5 times that specified
for field of roof.

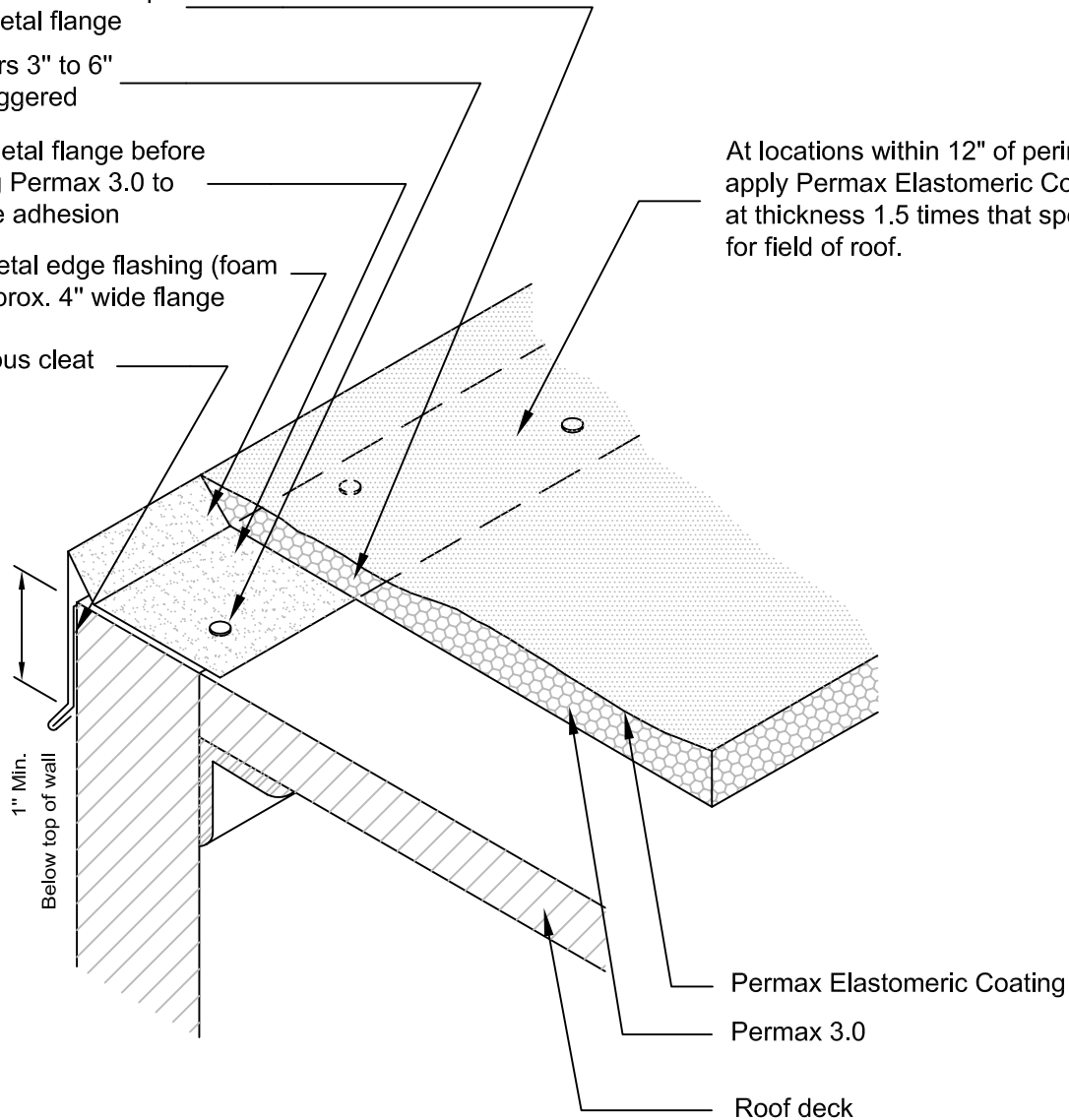

Notes:

1. Where the surface skin is trimmed or ground flush, additional base coating thickness is required.
2. This detail applicable only when the deck is supported by the outside wall.
3. Refer to sheet metal section for joinery and securement options for sheet metal.