

TECHNICAL DATA SHEET

HB BELOW-GRADE 60

Self-Adhering Heavy-Duty Below-Grade Waterproofing Membrane

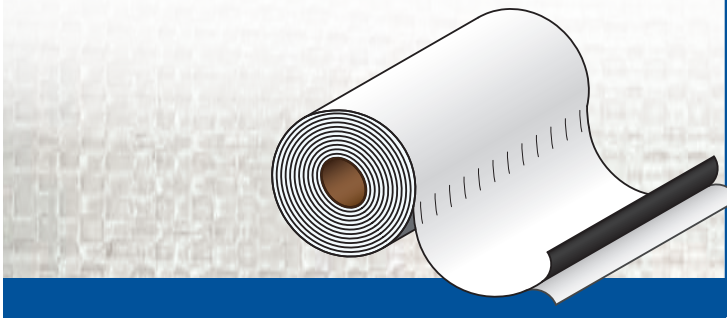

HB BELOW-GRADE 60 is a 60 mil Heavy Duty Self-Adhering Below-Grade Waterproofing Membrane, that features a woven polyethylene membrane coated on both sides with a uniquely engineered waterproofing blend. The polyethylene membrane is bonded to a self-sealing, highly adhesive, bituminous layer protected by a convenient release liner.

HB BELOW-GRADE 60 was developed for waterproofing below grade concrete foundations.

FEATURES

- Waterproof
- Self-Sealing
- Tough Coated Woven Film
- Convenient Release Liner
- Flexible
- Consistant Thickness
- Self-Adhering

INSTALLATION

Temperature & Job Site Conditions

- Apply HB BELOW-GRADE 60 only in dry weather and at air and surface temperatures of 40°F (5°C) and above.
- Apply HB BELOW-GRADE 60 *Low Temp* only in dry weather and when air and surface temperatures are between 25°F (-4°C) and 60°F (16°C).
- Apply **Primer SA** in dry weather above 40°F (5°C).
- Apply **Low Temperature Adhesive Primer** in dry weather, temperature between 25°F (-4°C) and 60°F (16°C).

Surface Preparation

Concrete must be properly dried. Surfaces should be structurally sound and free of voids, spalled areas, loose aggregate, and sharp protrusions. Remove contaminants such as grease, oil and wax from exposed surfaces. Remove dust, dirt, loose stone and debris. Repair defects such as spalled or poorly consolidated areas. Remove sharp protrusions and form match lines. On masonry surfaces, cut mortar joints flush to the face of the concrete blocks.

Priming

Apply Primer SA by brush or roller at a coverage rate of 250–350 ft²/gal (6–8.5 m²/L) and allow to dry one hour or until concrete returns to original color.

Apply Low Temperature Adhesive Primer by brush or roller at a coverage rate of 130–160 ft²/gal (3–4 m²/L). Allow primer to dry one hour or until tack-free.

Dry time may be longer in cold temperatures. Re-prime areas if contaminated by dust, or left exposed for over 24 hours. If the work area is dusty, apply membrane as soon as the primer is dry. *Do not apply any primer to HB BELOW-GRADE 60 membrane.*

Membrane Installation Instructions

General Application Instructions:

- The first section of membrane should be applied at the bottom of the wall, refer to footing details below.
- **HB BELOW-GRADE 60 can span gaps up to 1/8"**
- Apply HB BELOW-GRADE 60 membrane in lengths up to 8 ft.
- Apply in two or more sections on high walls, overlapping the lower sheet 3 inches minimum.
- Precut membrane to desired length.
- Peel back the release sheet 1 to 2 ft and adhere in place. Maintain 3 inch minimum side lap and end lap.
- Pull release sheet downward and press membrane into place and roll membrane thoroughly.
- Roll membrane seams and terminations using a hard roller.
- Seal all T-joints, patches, and terminations with HB Sealant.
- Terminate at top of wall with HB Sealant, optional Termination Bar available (*refer to Termination Recommendations section*).
- Apply Drainage Composite or Protection, when required, according to manufacturer's instructions.

Special Instructions: HB BELOW-GRADE 60 should **NOT** come into contact with any of the following materials: uncured coal tar products, EPDM, creosote, or polysulfide sealants.

HB BELOW-GRADE 60 membrane should not be used in:

- Areas permanently exposed to sunlight, weather or traffic.
- Negative side or blindside applications.

Protect HB BELOW-GRADE 60 membrane:

- From sunlight as quickly as possible after installation. (maximum UV exposure Limit 30 days)
- To avoid damage from other trades, materials, or backfill.

Safe Handling & Storage: HB BELOW-GRADE 60 should be protected from exposure to damaging weather conditions, the material should be stored in ambient temperatures between 25°-130° F and must be restored to a minimum of 60° F prior to application.

Post-Application Inspection & Repair

- Review all work and check if there are damaged areas or inadequately lapped seams.
- If repair is necessary, patch with HB BELOW-GRADE 60 membrane: patch must extend 6 inches in every direction from damaged area. Roll the patch firmly and seal edges with HB Sealant.
- Only repair when membrane is dry.
- If flood test is required, wait 24 hours after installation.



HOHMANN & BARNARD, INC.
a MiTek company

CORPORATE HEADQUARTERS
30 Rasons Court
Hauppauge, NY 11788
T: 800.645.0616 F: 631.234.0683

www.h-b.com

Foundation Wall Detail

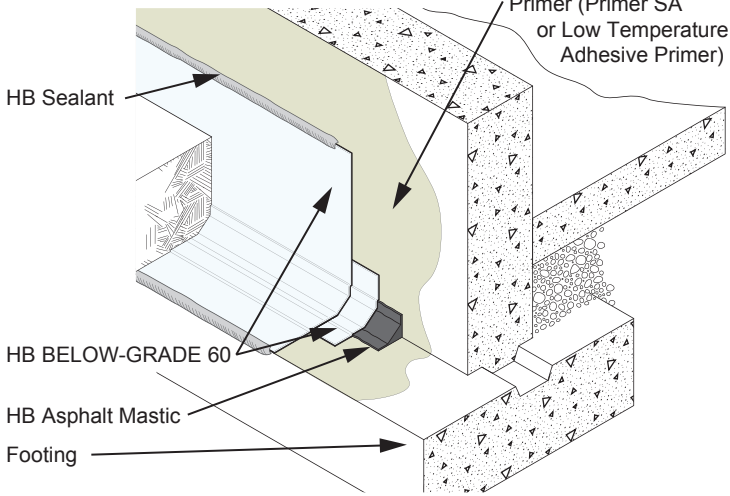

Foundation Wall Detailing

For illustrative purposes only

- Form a 1 inch fillet of HB Asphalt Mastic in the inside corner, extend the fillet 2 inches inches, with more mastic, onto the wall and footing.
- Allow mastic to cure. (It is acceptable to apply membrane directly over freshly applied mastic provided the mastic does not displace.)
- Adhere a 12 inch wide strip of HB BELOW-GRADE 60 over the center of the fillet onto the wall and footing.
- Apply HB BELOW-GRADE 60 down wall, onto horizontal surface of the footing, terminating at the outside corner of the footing.
- Apply a bead of HB Sealant on all terminations.

PRODUCT DATA

Color:	White/Black
Adhesive:	Rubberized Asphalt
Dimensions:	Roll Length: 66.67 ft. Roll Widths: 36" rolls (Custom widths available)
Product Thickness:	Overall: 60 mils (membrane:15 mils, adhesive:45 mils)
UV Exposure Limit:	30 days

TESTING/PHYSICAL PROPERTIES

PROPERTY	Test Method	Value
Tensile Strength	ASTM D412	2,227 psi
Elongation (Asphalt Adhesive)	ASTM D412C	1,316.9%
Puncture Resistance	ASTM E154	340 lbf
Water Absorption	ASTM D570	<0.5%
Resistance to Hydrostatic Head	ASTM D 5385	231 ft
Low Temperature Flexibility	CGSB 37-GP-56M	No Cracks
Moisture Vapor Permeation	ASTM E96	0.017 perm

IMPORTANT: Since each construction project is unique, the appropriate selection and use of any product contained herein must be determined by competent architects, engineers and other appropriate professionals who are familiar with the specific requirements of the project in question.

This drawing and/or data sheet is the confidential and proprietary information of Hohmann & Barnard, Inc. and is not to be reproduced, copied or disclosed, in whole or in part, without the prior written consent of H&B.



CORPORATE HEADQUARTERS
30 Rasons Court
Hauppauge, NY 11788
T: 800.645.0616 F: 631.234.0683

TERMINATION RECOMMENDATIONS

General Instructions for All Terminations:

- Press membrane firmly at all terminations with a hardwood tool or hard roller.
- Seal termination edges by applying HB Sealant, centered on the edge of the termination, with caulking gun and/or trowel.
- Apply HB Sealant 1/8 inch thick x 2 inches wide.

Termination with Optional Termination Bar:

- Recommended for terminations on CMU foundations and below grade installations.
- Use stainless steel or aluminum termination bar.
- Align bar with top of membrane and fasten 8 inches O.C. to ensure continuous compression.
- Separate adjoining bars by 1/4 in. (6 mm).
- Seal top of Termination Bar and fastener heads with HB Sealant.

MAINTENANCE

HB BELOW-GRADE 60 Self-Adhesive Membrane should not require maintenance if installed in accordance with H&B's specifications and instructions.

HB BELOW-GRADE 60 SYSTEM COMPONENTS

- Primer SA**
 - Prepares surface for maximum adhesion in temperatures above 40 °F (5 °C).
 - Available in 5 gallon pails
- Low Temperature Adhesive Primer**
 - Prepares surface for maximum adhesion in temperatures below 40 °F (5 °C).
 - Available in 5 gallon pails
- HB Asphalt Mastic**
 - For preparing surface by filling voids and creating fillets in inside corners.
 - Available in 5 gallon pails or 30 oz tubes
- HB Sealant**
 - For sealing terminations, laps, and penetrations.
 - Available in 5 gallon pails or 30 oz tubes

WARRANTY:

H&B hereby warrants, that for a period of five years from the date of delivery that HB BELOW-GRADE 60 Self-Adhesive Membrane is free from defects in material and workmanship. H&B must be notified in writing of any defects in the product within 30 days of its occurrence. H&B reserves the right to inspect such products by an H&B authorized agent. This warranty is null and void if the product was installed without required HB BELOW-GRADE 60 system components, or if the product has not been installed or maintained in conformance with the printed instructions that are in effect at the time of purchase. Further, this warranty does not cover damages caused by abuse or abnormal use of the product, Acts of God, inadequate or faulty building design, or specification and unauthorized repairs.