

FIRE PROTECTION CABINET - ARCHITECTURAL: ACADEMY FIRE-FX2™ SERIES - Aluminum

As a leader in the industry, J.L Industries offers an aluminum cabinet: The Architectural Academy Series. Available in multiple tub sizes designed to be compatible with multiple fire extinguishers. Select from a wide variety of options and accessories, this cabinet will meet all your project needs.

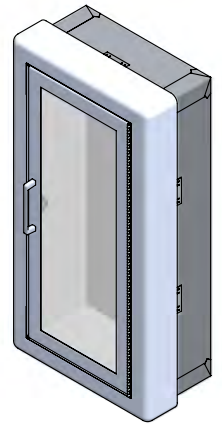
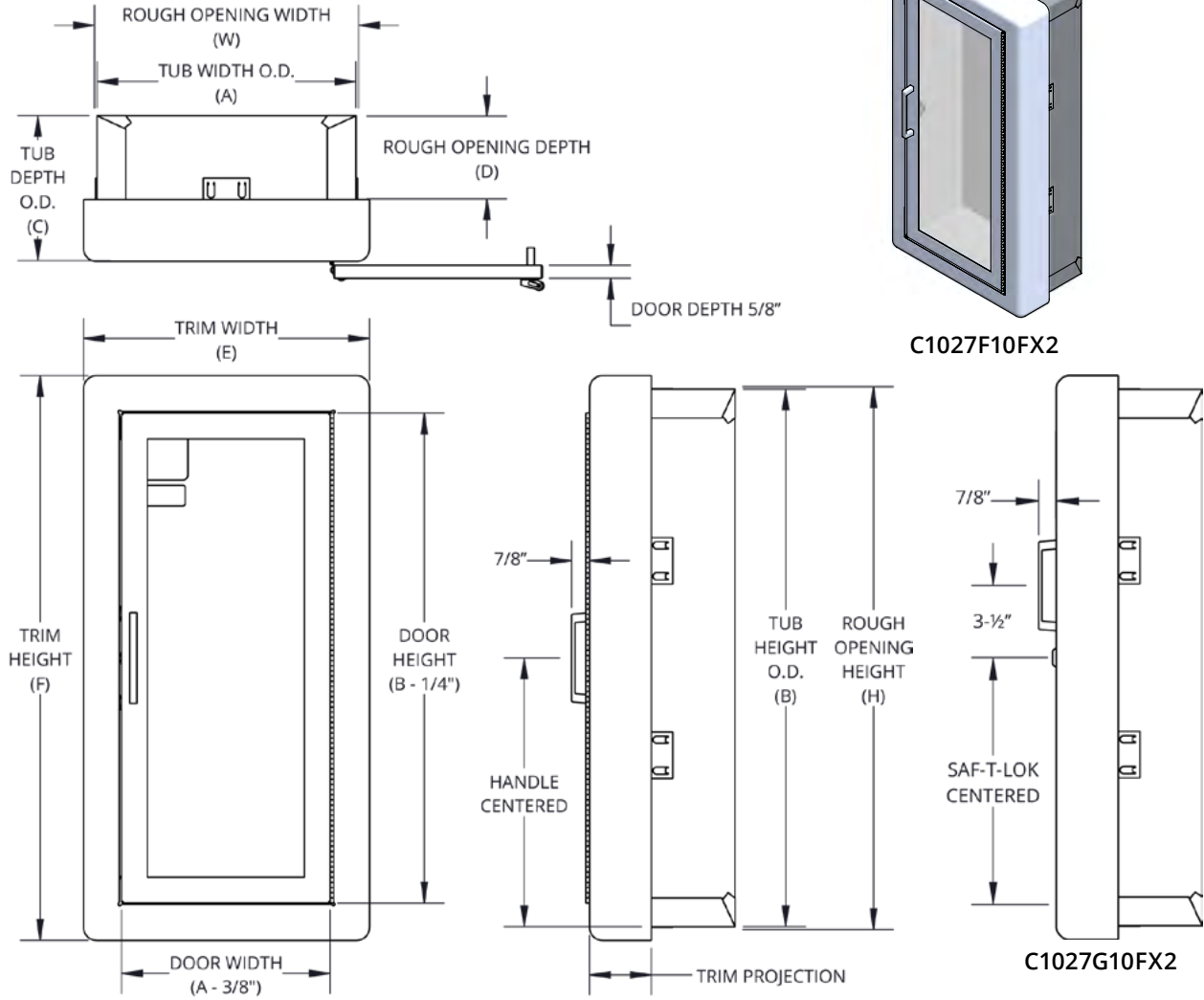

C1027F10FX2

C1027G10FX2

SPECIFICATIONS:

- Tub Material:** Based on size
 - 20 ga:** Cold Rolled Steel (CRS) white powder coat; 40 tub
 - 22 ga:** Cold Rolled Steel (CRS) white powder coat; 81, 17, 20, 30 tub
 - 24 ga:** Galvanized painted white; 10, 18 tub
 - Aluminum tub on surface mount:** 0.040" aluminum
 - Trim Material & Finish:** based on style; clear anodized
 - 0.050" aluminum:** Semi-recessed formed trim projection: 3"
 - 0.070" aluminum:** Semi-recessed rolled trim projection: 2-1/2", 4" (flush pull), and 4-1/2"
 - Surface-mount rolled trim 0.040" aluminum:** Full recessed 3/8" square flat trim, semi-recessed 1-1/4" and 1-1/2" square trim, surface-mount square trim
 - Door Material & Finish:** 0.040" aluminum; clear anodized
 - Glazing:** .090" Clear acrylic
 - Insulation:** Foil-faced mineral wool
 - Hinge:** Continuous hinge, zinc-plated steel, opens to 180°
 - Hardware:** Zinc plated pull handle with roller catch or cylinder Saf-T-Lok™
 - ADA Compliance:** Cabinet cannot protrude more than 4" and the handle cannot be mounted more than 48" above finished floor. Surface-mount and 4-1/2" trim style do not comply with ADA.
 - FIRE-RATINGS:**
 - UL classified and labeled up to 2 hours in accordance with UL 1479 (ASTM-E814) and CAN/USC-S115.
 - OPTIONS:**
 - Door:** Full, vertical duo, solid, horizontal
 - Glazing:** 1/8" clear tempered, 1/4" clear wired glass, 1/8" bronze acrylic, 1/8" gray acrylic, 1/4" clear laminated safety glass
 - Handles:** Recessed handle, magnetic catch
 - Alarms:** Commander alarm, Brigadier alarm, Strobe alarm
 - Material:** Dark bronze anodized
 - Finish:** Red, black, other powder coat colors
 - Lettering:** Silkscreen, engraving, etching
 - ADDITIONAL ACCESSORIES (sold separately)**
 - Die cuts, decals, plastic signs
- See supplemental submittals for more information on various options and accessories.

Interpretation of fire and building codes may vary. Consult with the local authority having jurisdiction (AHJ) to determine appropriate standards.

 <p>JL INDUSTRIES</p> <p>9702 Newton Avenue S, Bloomington, MN 55431</p>	<p>800-554-6077</p> <p>sales@activarcpg.com</p> <p>www.activarcpg.com</p>	Distributor:		Project:	
		Contractor:		Approved By:	
		Date:		Architect:	
		Scale: N/A	Page 1 of 4	Item#:	
© 2025 Activar Construction Products Group, Inc. THE INFORMATION CONTAINED IN THIS DRAWING IS THE SOLE PROPERTY OF ACTIVAR CONSTRUCTION PRODUCTS GROUP, INC. ANY REPRODUCTION IN PART OR AS A WHOLE WITHOUT WRITTEN PERMISSION IS PROHIBITED.					

COMPATIBLE FIRE EXTINGUISHERS	MODEL & TRIM		ADA	TUB I. D.			TRIM O. D.		WALL ROUGH OPENING*			WT
	MODEL	TRIM PROJECTION	≤4"	WIDTH (A)	HEIGHT (B)	DEPTH (C)	WIDTH (E)	HEIGHT (F)	WIDTH (W)	HEIGHT (H)	DEPTH (D)	LBS
Cosmic, Galaxy 2.5 - 6 lb (mount 6 lb to tub) Mercury 2.5 - 5 lb	C8125	3/8" flat square	✓	9"	18"	5-1/2"	12-3/8"	21-3/8"	11-5/16"	20-5/16"	6-7/16"	17
	C8126	1-1/2" square	✓								5-3/16"	
	C8127	2-1/2" rolled	✓								4"	
Cosmic, Galaxy Mercury 2.5 - 5 lb	C1720	2-1/4" square	✓	10-1/2"	24"	5"	13-7/8"	27-3/8"	12-13/16"	25-5/16"	4"	25
Cosmic/Galaxy 2.5 - 6 lb (mount 6 lb to tub) Mercury 2.5 - 5 lb	C1825	3/8" flat square	✓	10-1/2"	24"	5-1/2"	13-7/8"	27-3/8"	12-13/16"	26-5/16"	6-7/16"	22
	C1826	1-1/2" square	✓								5-3/16"	
	C1827	3" rolled	✓								3-11/16"	
	C1822	4" rolled w/ rec hndl	✓								3-1/2"	
	C1828	4-1/2" rolled									2-13/16"	
Cosmic, Galaxy 2.5 - 10 lb Mercury 2.5 - 5 lb Sentinel 5 lb	C1025	3/8" flat square	✓	10-1/2"	24"	6"	13-7/8"	27-3/8"	12-13/16"	25-5/16"	6-15/16"	23
	C1026	1-1/2" square	✓								5-11/16"	
	C1027	3" rolled	✓								4"	
	C1022	4" rolled w/ rec hndl	✓								3-5/16"	
	C1028	4-1/2" rolled									3-5/16"	
Cosmic, Galaxy (mount 20 lb to tub) Mercury 2.5 - 15 lb (mount 15.5 lb to tub) Sentinel 5 - 10 lb Grenadier, Saturn, Nebula 270	C2025	3/8" flat square	✓	12"	27"	7-3/4"	15-3/8"	30-3/8"	14-5/16"	29-5/16"	8-11/16"	29
	C2026	1-1/4" square	✓								7-11/16"	
	C2027	2-1/2" rolled	✓								7-1/16"	
	C2022	4" rolled w/ rec hndl	✓								5-3/4"	
	C2028	4-1/2" rolled									5-1/16"	
Cosmic, Galaxy (mount 20 lb to tub) Mercury 2.5 - 15 lb (mount 15.5 lb to tub) Sentinel 5 - 15 lb Grenadier, Saturn Nebula 250-272	C3025	3/8" flat square	✓	16"	32"	7-3/4"	19-3/8"	35-3/8"	18-5/16"	34-5/16"	8-11/16"	43
	C3026	1-1/4" square	✓								7-11/16"	
	C3027	2-1/2" rolled	✓								7-1/16"	
	C3022	4" rolled w/ rec hndl	✓								5-3/4"	
	C3028	4-1/2" rolled									5-1/16"	
Two each of: Cosmic, Galaxy (FE20C) (mount 20 lb to tub) Mercury 2.5 - 15.5 lb Sentinel 5 lb Grenadier Saturn	C4025	3/8" flat square	✓	20"	27"	7-3/4"	23-3/8"	30-3/8"	22-5/16"	29-5/16"	8-11/16"	44
	C4026	1-1/4" square	✓								7-11/16"	
	C4027	2-1/2" rolled	✓								7-1/16"	
	C4022	4" rolled w/ rec hndl	✓								5-3/4"	
	C4028	4-1/2" rolled									5-1/16"	

Fire-rated specific wall opening

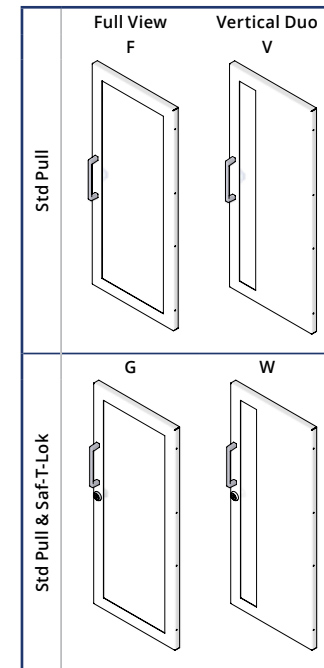
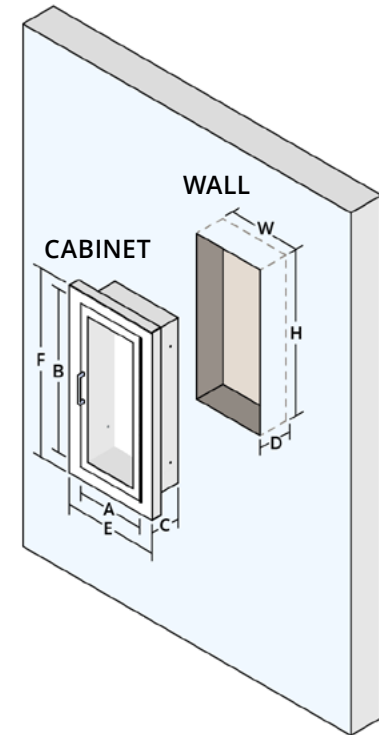

 FIRE PROTECTION CABINET - ARCHITECTURAL: ACADEMY FIRE-FX2™ SERIES - Aluminum

COMMON CABINETS

QTY	MODEL	DESCRIPTION
	C1027F10FX2	FIRE-RATED, 3" RLD TRIM, FL VIEW, CLR ACR
	C1027V10FX2	FIRE-RATED, 3" RLD TRIM, VERT, CLR ACR
	C1027G10FX2	FIRE-RATED, 3" RLD TRIM, FL VIEW W SAFTLOK, CLR ACR
	C1027W10FX2	FIRE-RATED, 3" RLD TRIM, VERT DUO W SAFTLOK, CLR ACR

GLAZING

QTY	MODEL	DESCRIPTION
	G10F17	1/8" CLR TEMPERED, 8-1/2" x 22-3/4"

For quick ship from warehouses, order separately with cabinet instead of made-to-order on cabinet.
Ex. Order C1027F10FX2 and G10F17 instead of C1027F17FX2

HANDLES

QTY	MODEL	DESCRIPTION
	PUF	FUTURA "FIRE" HANDLE, MILL
	PUFR	FUTURA "FIRE" HANDLE, RED
	PUFW	FUTURA "FIRE" HANDLE, WHITE
	PUCH	PULL HANDLE, CHROME



PUF PUFR PUFW PUCH

PLASTIC SIGNS

QTY	MODEL	DESCRIPTION
	22S	FE, 3D ANGLE, 4" x 12"
	23S	FE, 3D TENT, 4" x 18"
	24S	FE, 3D TENT, 5" x 6"
	25S	FE, FLUSH, 4" x 12"



22S 23S 24S 25S

LETTERING

QTY	MODEL	DESCRIPTION
	LDCVRFE	DIE CUT, VERT, RED, FIRE EXTINGUISHER, 3/4" x 18"
	LDCVBFE	DIE CUT, VERT, BLACK, FIRE EXTINGUISHER, 3/4" x 18"
	LDVRFE	DECAL, VERT, RED, FIRE EXTINGUISHER, 3/4" x 18"
	LDCVRFE-ESM-A	DIE CUT, VERT, RED, FIRE EXTINGUISHER (fits 81 tub), 3/4" x 14"
	LDCHRFE-2	DIE CUT, HORZ, RED, FIRE EXTINGUISHER, 2" HIGH, 4-1/2" x 21"

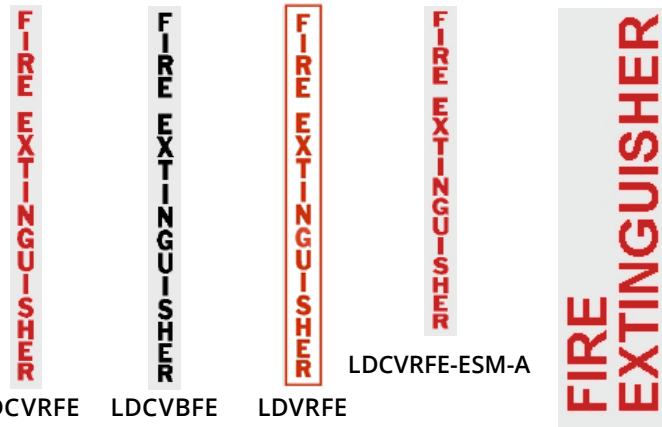

LDCVRFE LDCVBFE LDVRFE LDCVRFE-ESM-A LDCHRFE-2

ALARMS

QTY	MODEL	DESCRIPTION
	BA	BRIGADIER ALARM, MINI THEFT STOPPER WITH DOOR POSITION SENSOR
	C-KIT-CA	COMMANDER ALARM KIT, includes alarm, 9V battery, & screws



BA C-KIT-CA

Refer to supplemental submittals for information on more options and accessories.

It is the responsibility of the customer to communicate specifications and product performance requirements that are needed for their application. This document is intended to convey potential product configurations and offerings. It is not to be used to imply or represent a specification or rating of finished products shipped. Detailed, specific submittals can be created upon request. It is the responsibility of the customer to specify product accordingly to comply with local laws, codes, and ordinances.

MADE-TO-ORDER ACADEMY FIRE PROTECTION CABINET - EXAMPLE: C1025W17FX2A-ET01

QTY	PRODUCT LINE	TUB I.D. SIZE	DOOR/TRIM MATERIAL	TRIM PROJECTION	DOOR/LATCH STYLE	GLAZING/DOOR TYPE	
	C (Cabinet)	81	9" x 18" x 5-1/2"	2 Aluminum, #180 clear satin anodized	5 Fully recessed 3/8" square flat edge	F Full view	10 .09" Clear acrylic
		17	10-1/2" x 24" x 5"	9 Dark bronze anodized aluminum (pull to match)	6 Semi-recessed 1-1/4" or 1-1/2" square edge	G Full view w/ Saf-T-Lok™	13 1/4" Clear wired glass
		18	10-1/2" x 24" x 5-1/2"		0 Semi-recessed 2-1/4" square edge (1700 series only)	D Horizontal duo	15 1/8" Bronze acrylic
		10	10-1/2" x 24" x 6"	7 Semi-recessed 2-1/2" or 3" rolled edge	E Horizontal duo w/ Saf-T-Lok™	16 1/8" Gray acrylic	
		20	12" x 27" x 7-3/4"	2 Semi-recessed 4" rolled edge, recessed handle	V Vertical duo	17 1/8" Clear tempered glass	
		30	16" x 32" x 7-3/4"	8 Semi-recessed 4-1/2" rolled edge	W Vertical duo w/ Saf-T-Lok™	18 1/4" Clear safety glass	
		40	20" x 27" x 7-3/4"		B Small view window w/ Saf-T-Lok™	21 No glazing, no lock w/ pull (S21 only)	
				S Solid	22 No glazing, Saf-T-Lok™ w/ pull (L22 only)		
				L Solid w/ Saf-T-Lok™	24 No glazing, Saf-T-Lok™ and no pull (L24 only)		



FIRE-RATED	HANDLE/LATCH OPTIONS	ALARM OPTIONS
FX2 Fire-rated 2 hours	(none) Standard handle w/ roller catch	CA Commander
	A Recessed handle	BA Brigadier
	LH Lever handle (not avail. w/ cylinder lock)	SA Strobe





FINISH	LETTERING OPTIONS
W4 White door, trim, tub	SS01 Silkscreen: SS-FELVR FIRE EXTINGUISHER, vertical, red
BK4 Black door, trim, tub	SS01D* Silkscreen: SS-FELVR FIRE EXTINGUISHER, vertical, red, on door
R4 Red door, trim, tub	SS01G* Silkscreen: SS-FELVR FIRE EXTINGUISHER, vertical, red, on glazing
COLOR - OTHER (please specify) Refer to supplemental submittal	ET01 Etching: ET-FELVR FIRE EXTINGUISHER, vertical, red (for glass only)
Door	EN01 Engraving: EN-FELVR FIRE EXTINGUISHER, vertical, red (for metal only)
Trim	LETTERING - OTHER (please specify) Refer to supplemental submittal
Tub	Other

* DUO style doors (D, E, V, W) must specify location of silkscreen

Refer to supplemental submittals for information on more options and accessories.

USE SECTION BELOW TO LIST OTHER CABINETS

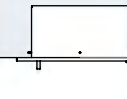
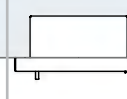
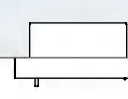
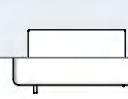
QTY	MODEL NUMBER (ex: C1027F10FX2)	NOTES:

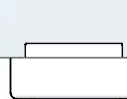
TRIM STYLE & PROJECTION					
RECESSED	SEMI-RECESSED				
5	6	0	7	2	8
					
3/8" Flat Square	1-1/4" or 1-1/2" Square	2-1/4" Square	2-1/2" or 3" Rolled	4" Rolled w/ Rec. Hndl	4-1/2" Rolled