

## FIRE PROTECTION CABINET - ARCHITECTURAL: ACADEMY SERIES - Aluminum

As a leader in the industry, J.L Industries offers an aluminum cabinet: The Architectural Academy Series. Available in multiple tub sizes designed to be compatible with multiple fire extinguishers. Select from a wide variety of options and accessories, this cabinet will meet all your project needs.

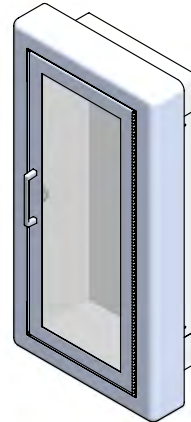

C1027F10

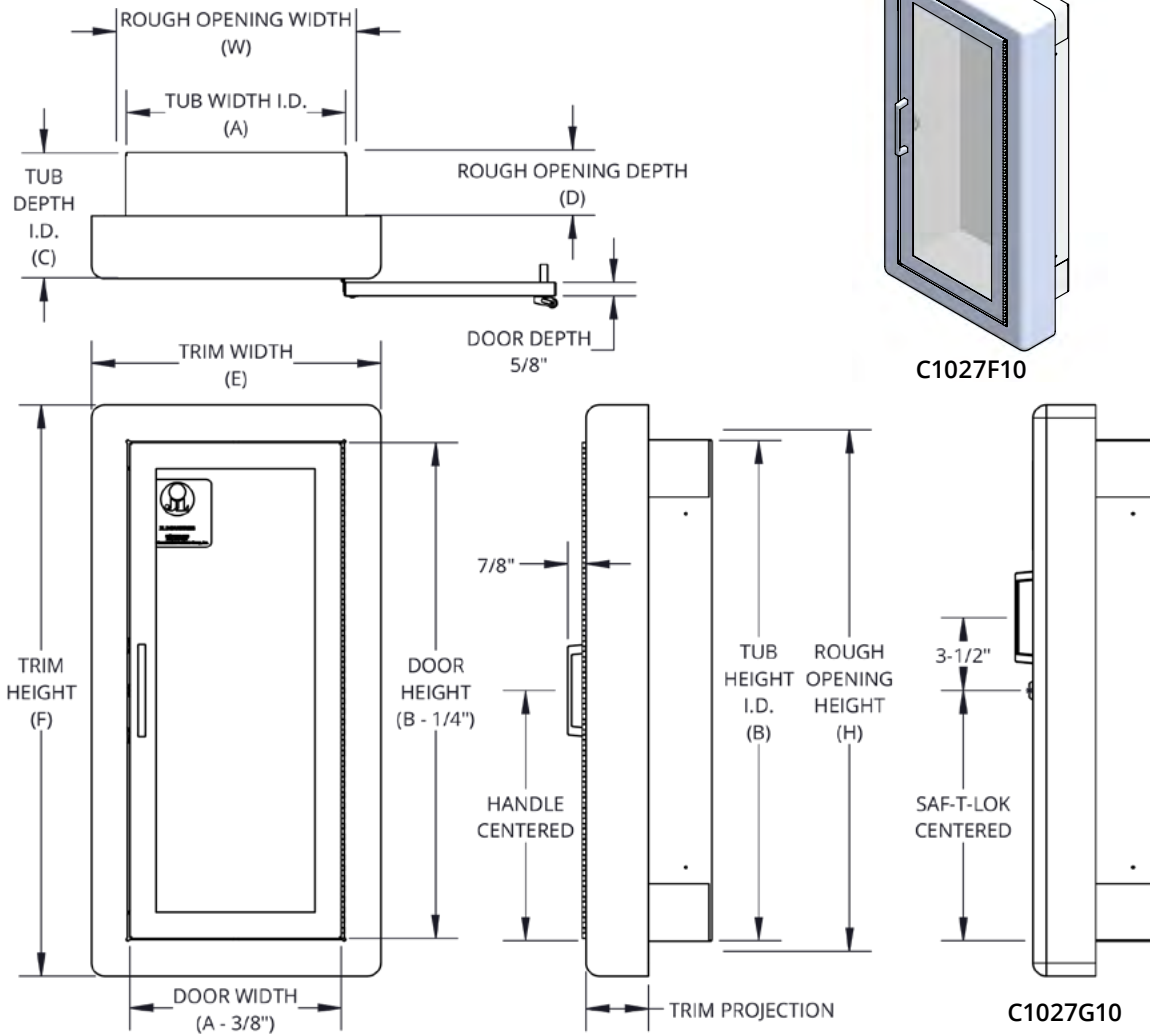
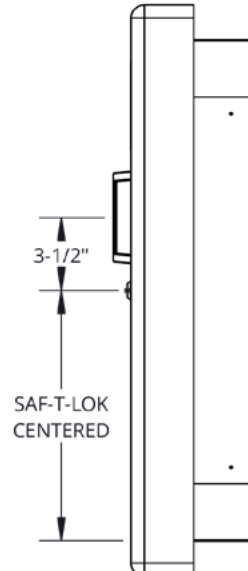

C1027G10

### SPECIFICATIONS:

**Tub Material:** Based on size

- 20 ga:** Cold Rolled Steel (CRS) white powder coat; 40 tub
- 22 ga:** Cold Rolled Steel (CRS) white powder coat; 81, 17, 20, 30 tub
- 24 ga:** Galvanized painted white; 10, 18 tub

**Aluminum tub on surface mount:** 0.040" aluminum

**Trim Material & Finish:** based on style; clear anodized  
**0.050" aluminum:** Semi-recessed formed trim projection: 3"

**0.070" aluminum:** Semi-recessed rolled trim projection: 2-1/2", 4" (flush pull), and 4-1/2"

**Surface-mount rolled trim 0.040" aluminum:** Full recessed 3/8" square flat trim, semi-recessed 1-1/4" and 1-1/2" square trim, surface-mount square trim

**Door Material & Finish:** 0.040" aluminum; clear anodized

**Glazing:** .090" Clear acrylic

**Hinge:** Continuous hinge, zinc-plated steel, opens to 180°

**Hardware:** Zinc plated pull handle with roller catch or cylinder Saf-T-Lok™

**ADA Compliance:** Cabinet cannot protrude more than 4" and the handle cannot be mounted more than 48" above finished floor. Surface-mount and 4-1/2" trim style do not comply with ADA.

### OPTIONS:

**Tub:** 0.040 Aluminum

**Door:** Full, vertical duo, solid, horizontal

**Glazing:** 1/8" clear tempered, 1/4" clear wired glass, 1/8" bronze acrylic, 1/8" gray acrylic, 1/4" clear laminated safety glass

**Handles:** Recessed handle, magnetic catch

**Alarms:** Commander alarm, Brigadier alarm, Strobe alarm

**Material:** Dark bronze anodized

**Finish:** Red, black, other powder coat colors

**Lettering:** Silkscreen, engraving, etching

### ADDITIONAL ACCESSORIES (sold separately)

Die cuts, decals, plastic signs

See supplemental submittals for more information on various options and accessories.

Interpretation of fire and building codes may vary. Consult with the local authority having jurisdiction (AHJ) to determine appropriate standards.



**JL INDUSTRIES**

9702 Newton Avenue S, Bloomington, MN 55431

800-554-6077

sales@activarcpg.com

www.activarcpg.com

Distributor:

Contractor:

Date:

Scale: N/A

Page 1 of 4

Project:

Approved By:

Architect:

Item#:

**FIRE PROTECTION CABINET - ARCHITECTURAL: ACADEMY SERIES - Aluminum**

*\*Confirm wall rough opening depth prior to ordering*

COMPATIBLE FIRE EXTINGUISHERS	MODEL & TRIM		ADA	TUB I. D.			TRIM O. D.		WALL ROUGH OPENING*			WT
	MODEL	TRIM PROJECTION	≤4"	WIDTH (A)	HEIGHT (B)	DEPTH (C)	WIDTH (E)	HEIGHT (F)	WIDTH (W)	HEIGHT (H)	DEPTH (D)	LBS
<b>Cosmic, Galaxy 2.5 - 6 lb</b> (mount 6 lb to tub) <b>Mercury 2.5 - 5 lb</b>	C8125	3/8" flat square	✓	9"	18"	5-1/2"	12-3/8"	21-3/8"	10"	19"	5-3/8"	10
	C8126	1-1/2" square	✓								4-1/8"	
	C8127	2-1/2" rolled	✓								3-3/4"	
	C8123	surface-mount square		12-3/16"	21-3/16"	6"	-	-	-	13		
<b>Cosmic, Galaxy Mercury 2.5 - 5 lb</b>	C1720	2-1/4" square	✓	10-1/2"	24"	5"	13-7/8"	27-3/8"	11-1/2"	25"	3"	15
<b>Cosmic/Galaxy 2.5 - 6 lb</b> (mount 6 lb to tub) <b>Mercury 2.5 - 5 lb</b>	C1825	3/8" flat square	✓	10-1/2"	24"	5-1/2"	13-7/8"	27-3/8"	11-1/2"	25"	5-3/8"	15
	C1826	1-1/2" square	✓								4-1/8"	
	C1827	3" rolled	✓								2-5/8"	
	C1822	4" rolled w/ rec hndl	✓								2-1/2"	
	C1828	4-1/2" rolled									1-3/4"	
C1823	surface-mount square		13-11/16"	27-3/16"	6"	-	-	-	-	18		
<b>Cosmic, Galaxy 2.5 - 10 lb</b> <b>Mercury 2.5 - 5 lb</b> <b>Sentinel 5 lb</b>	C1025	3/8" flat square	✓	10-1/2"	24"	6"	13-7/8"	27-3/8"	11-1/2"	25"	5-7/8"	15
	C1026	1-1/2" square	✓								4-5/8"	
	C1027	3" rolled	✓								3-1/8"	
	C1022	4" rolled w/ rec hndl	✓								3"	
	C1028	4-1/2" rolled									2-1/4"	
	C1023	surface-mount square									13-11/16"	
C1029	surface-mount rolled											
<b>Cosmic, Galaxy</b> (mount 20 lb to tub) <b>Mercury 2.5 - 15 lb</b> (mount 15.5 lb to tub) <b>Sentinel 5 - 10 lb</b> <b>Grenadier, Saturn, Nebula 270</b>	C2025	3/8" flat square	✓	12"	27"	7-3/4"	15-3/8"	30-3/8"	13"	28"	7-5/8"	21
	C2026	1-1/4" square	✓								6-5/8"	
	C2027	2-1/2" rolled	✓								6"	
	C2022	4" rolled w/ rec hndl	✓								4-3/4"	
	C2028	4-1/2" rolled									4"	
	C2023	surface-mount square									15-3/16"	
<b>Cosmic, Galaxy</b> (mount 20 lb to tub) <b>Mercury 2.5 - 15 lb</b> (mount 15.5 lb to tub) <b>Sentinel 5 - 15 lb</b> <b>Grenadier, Saturn Nebula 250-272</b>	C3025	3/8" flat square	✓	16"	32"	7-3/4"	19-3/8"	35-3/8"	17"	33"	7-5/8"	29
	C3026	1-1/4" square	✓								6-5/8"	
	C3027	2-1/2" rolled	✓								6"	
	C3022	4" rolled w/ rec hndl	✓								4-3/4"	
	C3028	4-1/2" rolled									4"	
	C3023	surface-mount square									19-3/16"	
<b>Two each of:</b> <b>Cosmic, Galaxy (FE20C)</b> (mount 20 lb to tub) <b>Mercury 2.5 - 15.5 lb</b> <b>Sentinel 5 lb</b> <b>Grenadier</b> <b>Saturn</b>	C4025	3/8" flat square	✓	20"	27"	7-3/4"	23-3/8"	30-3/8"	21"	28"	7-5/8"	33
	C4026	1-1/4" square	✓								6-5/8"	
	C4027	2-1/2" rolled	✓								6"	
	C4022	4" rolled w/ rec hndl	✓								4-3/4"	
	C4028	4-1/2" rolled									4"	
	C4023	surface-mount square									23-3/16"	

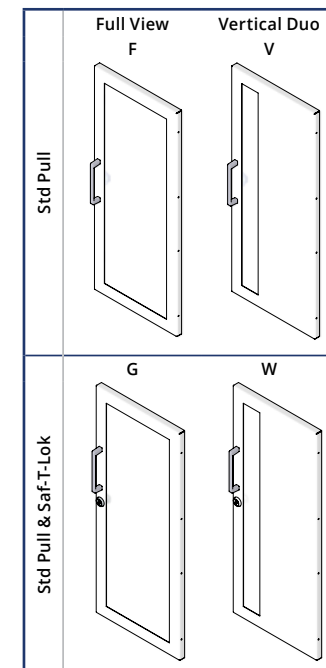
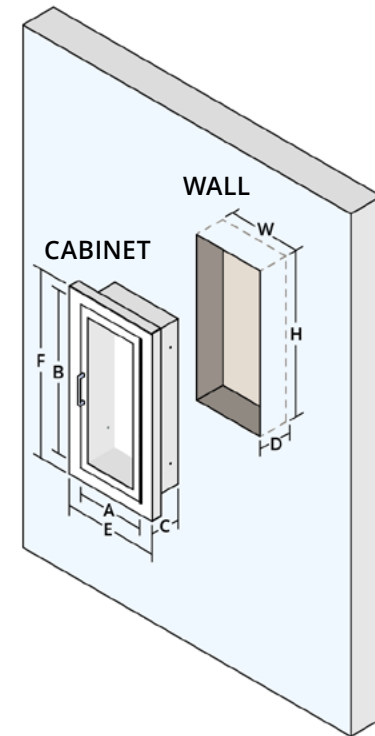

# FIRE PROTECTION CABINET - ARCHITECTURAL: ACADEMY SERIES - Aluminum

## COMMON CABINETS

QTY	MODEL	DESCRIPTION
	C1027F10	3" RLD TRIM, FL VIEW, CLR ACR
	C1027V10	3" RLD TRIM, VERT, CLR ACR
	C1027G10	3" RLD TRIM, FL VIEW W SAFTLOK, CLR ACR
	C1027W10	3" RLD TRIM, VERT DUO W SAFTLOK, CLR ACR
	C1023F10	SURF MT, FL VIEW, CLR ACR
	C1023L22	SURF MT, SLD SAFTLOK

## GLAZING

QTY	MODEL	DESCRIPTION
	G10F17	1/8" CLR TEMPERED, 8-1/2" x 22-3/4"

For quick ship from warehouses, order separately with cabinet instead of made-to-order on cabinet.  
Ex. Order C1027F10 and G10F17 instead of C1027F17

## HANDLES

QTY	MODEL	DESCRIPTION
	PUF	FUTURA "FIRE" HANDLE, MILL
	PUFR	FUTURA "FIRE" HANDLE, RED
	PUFW	FUTURA "FIRE" HANDLE, WHITE
	PUCH	PULL HANDLE, CHROME



PUF PUFR PUFW PUCH

## PLASTIC SIGNS

QTY	MODEL	DESCRIPTION
	22S	FE, 3D ANGLE, 4" x 12"
	23S	FE, 3D TENT, 4" x 18"
	24S	FE, 3D TENT, 5" x 6"
	25S	FE, FLUSH, 4" x 12"



22S 23S 24S 25S

## LETTERING

QTY	MODEL	DESCRIPTION
	LDCVRFE	DIE CUT, VERT, RED, FIRE EXTINGUISHER, 3/4" x 18"
	LDCVBFE	DIE CUT, VERT, BLACK, FIRE EXTINGUISHER, 3/4" x 18"
	LDVRFE	DECAL, VERT, RED, FIRE EXTINGUISHER, 3/4" x 18"
	LDCVRFE-ESM-A	DIE CUT, VERT, RED, FIRE EXTINGUISHER (fits 81 tub), 3/4" x 14"
	LDCHRFE-2	DIE CUT, HORZ, RED, FIRE EXTINGUISHER, 2" HIGH, 4-1/2" x 21"

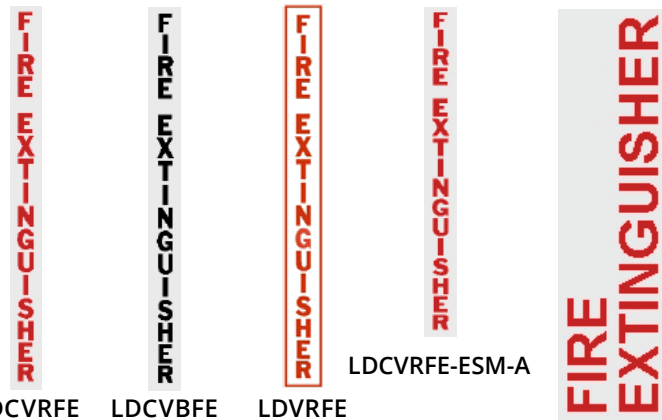

LDCVRFE LDCVBFE LDVRFE LDCVRFE-ESM-A LDCHRFE-2

## ALARMS

QTY	MODEL	DESCRIPTION
	BA	BRIGADIER ALARM, MINI THEFT STOPPER WITH DOOR POSITION SENSOR
	C-KIT-CA	COMMANDER ALARM KIT, includes alarm, 9V battery, & screws



BA C-KIT-CA

Refer to supplemental submittals for information on more options and accessories.

It is the responsibility of the customer to communicate specifications and product performance requirements that are needed for their application. This document is intended to convey potential product configurations and offerings. It is not to be used to imply or represent a specification or rating of finished products shipped. Detailed, specific submittals can be created upon request. It is the responsibility of the customer to specify product accordingly to comply with local laws, codes, and ordinances.

**FIRE PROTECTION CABINET - ARCHITECTURAL: ACADEMY SERIES - Aluminum**

**MADE-TO-ORDER ACADEMY FIRE PROTECTION CABINET - EXAMPLE: C1025W17A-ET01**

QTY	PRODUCT LINE	TUB MATERIAL (optional)	TUB I.D. SIZE	DOOR/TRIM MATERIAL	TRIM PROJECTION	DOOR/LATCH STYLE	GLAZING/DOOR TYPE					
C (Cabinet)	AL	Aluminum, clear anodized	81	9" x 18" x 5-1/2"	2	Aluminum, #180 clear satin anodized	5	Fully recessed 3/8" square flat edge	F	Full view	10	.09" Clear acrylic
			17	10-1/2" x 24" x 5"	9	Dark bronze anodized aluminum (pull to match)	6	Semi-recessed 1-1/4" or 1-1/2" square edge	G	Full view w/ Saf-T-Lok™	13	1/4" Clear wired glass
			18	10-1/2" x 24" x 5-1/2"			0	Semi-recessed 2-1/4" square edge (1700 series only)	D	Horizontal duo	15	1/8" Bronze acrylic
			10	10-1/2" x 24" x 6"			7	Semi-recessed 2-1/2" or 3" rolled edge	E	Horizontal duo w/ Saf-T-Lok™	16	1/8" Gray acrylic
			20	12" x 27" x 7-3/4"			2	Semi-recessed 4" rolled edge, recessed handle	V	Vertical duo	17	1/8" Clear tempered glass
			30	16" x 32" x 7-3/4"			8	Semi-recessed 4-1/2" rolled edge	W	Vertical duo w/ Saf-T-Lok™	18	1/4" Clear safety glass
			40	20" x 27" x 7-3/4"			3	Surface-mount square edge (Std. for surface-mounted)	B	Small view window w/ Saf-T-Lok™	21	No glazing, no lock w/ pull (S21 only)
		9	Surface-mount rolled edge	S	Solid	22	No glazing, Saf-T-Lok™ w/ pull (L22 only)					
					L	Solid w/ Saf-T-Lok™	24	No glazing, Saf-T-Lok™ and no pull (L24 only)				

**HANDLE/LATCH OPTIONS**

(none)	Standard handle w/ roller catch
A	Recessed handle
LH	Lever handle (not avail. w/ cylinder lock)
FM	Futura "FIRE" Mill
FR	Futura "FIRE" Red
FW	Futura "FIRE" White

**ALARM OPTIONS**

CA	Commander
BA	Brigadier
SA	Strobe

**FINISH**

W4	White door, trim, tub
BK4	Black door, trim, tub
R4	Red door, trim, tub
<b>COLOR - OTHER (please specify)</b> Refer to supplemental submittal	
Door	
Trim	
Tub	

**LETTERING OPTIONS**

SS01	Silkscreen: SS-FELVR FIRE EXTINGUISHER, vertical, red
SS01D*	Silkscreen: SS-FELVR FIRE EXTINGUISHER, vertical, red, on door
SS01G*	Silkscreen: SS-FELVR FIRE EXTINGUISHER, vertical, red, on glazing
ET01	Etching: ET-FELVR FIRE EXTINGUISHER, vertical, red (for glass only)
EN01	Engraving: EN-FELVR FIRE EXTINGUISHER, vertical, red (for metal only)
<b>LETTERING - OTHER (please specify)</b> Refer to supplemental submittal	
Other	

\* DUO style doors (D, E, V, W) must specify location of silkscreen

Refer to supplemental submittals for information on more options and accessories.

**USE SECTION BELOW TO LIST OTHER CABINETS**

QTY	MODEL NUMBER (ex: C1027F10A)	NOTES:

**TRIM STYLE & PROJECTION**

RECESSED						SEMI-RECESSED		SURFACE-MOUNT	
5	6	0	7	2	8	3	9		
3/8" Flat Square	1-1/4" Square	2-1/4" Square	2-1/2" or 3" Rolled	4" Rolled w/ Rec. Hndl	4-1/2" Rolled	5-1/2" to 8-1/4" Square	5-1/2" to 8-1/4" Rolled		