

FIRE PROTECTION CABINET - ARCHITECTURAL: COSMOPOLITAN FIRE-FX2™ Series - Stainless Steel

As a leader in the industry, JL Industries offers a clean and modern stainless steel cabinet: The Cosmopolitan Series. Available in multiple tub sizes designed to be compatible with multiple fire extinguishers. Select from a wide variety of options and accessories, this cabinet will meet all your project needs.

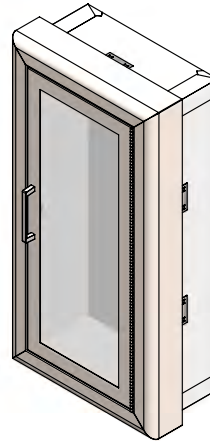

C1037F10FX2

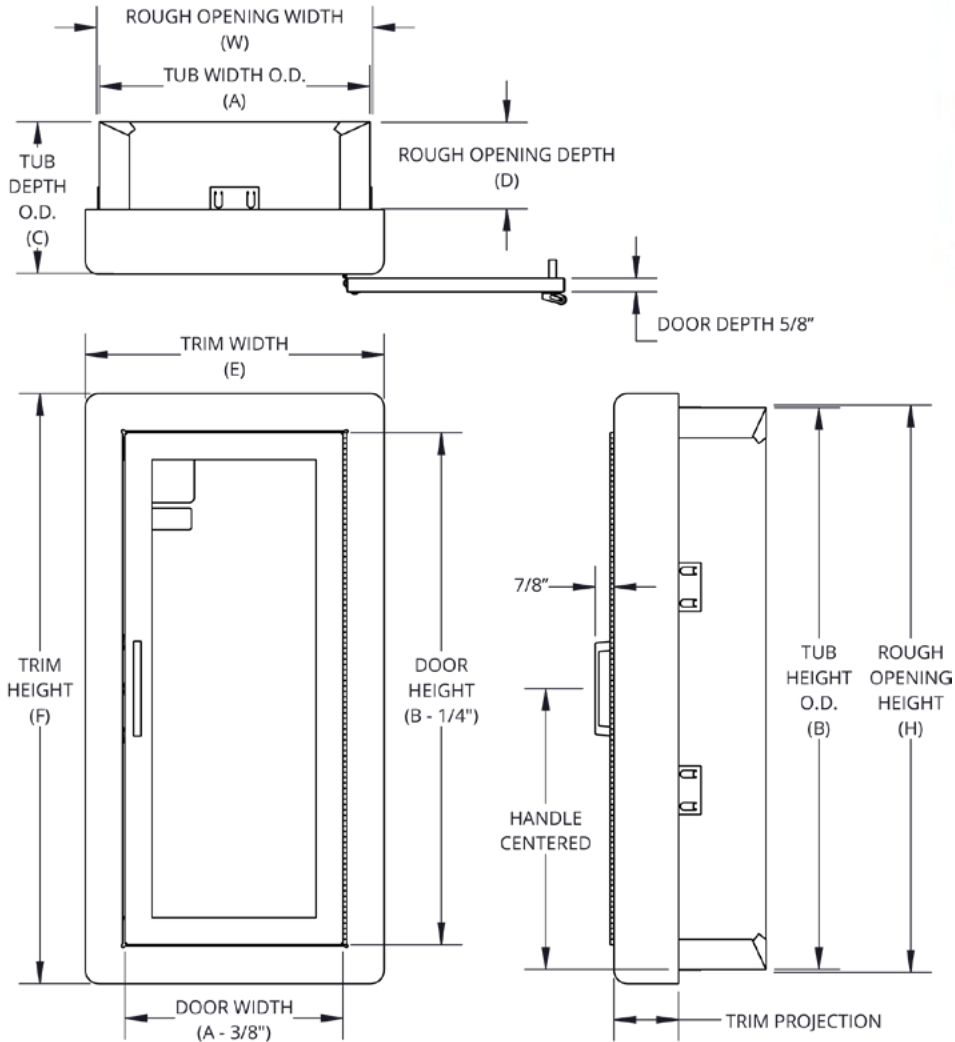
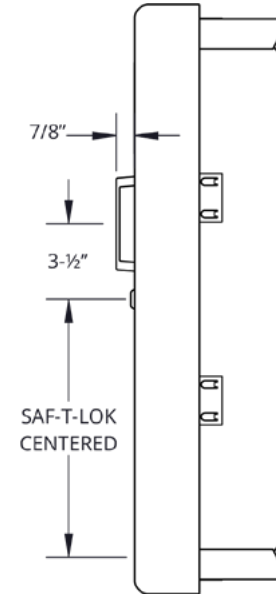

C1037G10FX2

SPECIFICATIONS:

Tub Material: Based on size

- 20 ga:** Cold Rolled Steel (CRS) white powder coat; 40 tub
- 22 ga:** Cold Rolled Steel (CRS) white powder coat; 81, 17, 20, 30 tub
- 24 ga:** Galvanized painted white; 10, 18 tub

Trim Material & Finish: based on style; white powder coat

- 18 gauge stainless steel:** Semi-recessed rolled trim with projection: 2-½", 3", 4" flush pull, and 4-½" surface-mount rolled trim
- 20 gauge stainless steel steel:** Full recessed 3/8" square flat trim, semi-recessed 1-¼", 1-½" square trim, 2-¼" square trim, semi-recessed 2-¼" square trim, surface-mount square trim

Door Material & Finish: 20 gauge 304 #4 stainless steel

Glazing: .090" Clear acrylic

Insulation: Foil-faced mineral wool

Hinge: Continuous hinge, stainless steel, opens to 180°

Hardware: Zinc plated pull handle with roller catch or cylinder Saf-T-Lok™

ADA Compliance: Cabinet cannot protrude more than 4" and the handle cannot be mounted more than 48" above finished floor. Surface-mount and 4-½" trim style do not comply with ADA.

FIRE-RATINGS:

UL classified and labeled up to 2 hours in accordance with UL 1479 (ASTM-E814) and CAN/USC-S115.

OPTIONS:

Tub: 18 gauge 304 #4 stainless steel

Door: Full, vertical duo, solid, horizontal

Glazing: 1/8" clear tempered, 1/4" clear wired glass, 1/8" bronze acrylic, 1/8" gray acrylic, 1/4" clear laminated safety glass

Handles: Recessed handle

Alarms: Commander alarm, Brigadier alarm, Strobe alarm

Material: #6 Satin stainless steel, #7 polished stainless steel, #8 mirror stainless steel

Finish: Red, black, other powder coat colors

Lettering: Silkscreen, engraving, etching

ADDITIONAL ACCESSORIES (sold separately)

Die cuts, decals, plastic signs

See supplemental submittals for more information on various options and accessories.

Interpretation of fire and building codes may vary. Consult with the local authority having jurisdiction (AHJ) to determine appropriate standards.



JL INDUSTRIES

7902 Newton Avenue S, Bloomington, MN 55431

800-554-6077

sales@activarcpg.com

www.activarcpg.com

Distributor:

Contractor:

Date:

Scale: N/A

Page 1 of 4

Project:

Approved By:

Architect:

Item#:

COMPATIBLE FIRE EXTINGUISHERS	MODEL & TRIM		ADA	TUB I. D.			TRIM O. D.		WALL ROUGH OPENING*			WT
	MODEL	TRIM PROJECTION	≤4"	WIDTH (A)	HEIGHT (B)	DEPTH (C)	WIDTH (E)	HEIGHT (F)	WIDTH (W)	HEIGHT (H)	DEPTH (D)	LBS
Cosmic, Galaxy 2.5 - 6 lb (mount 6 lb to tub) Mercury 2.5 - 5 lb	C8135	3/8" flat square	✓	9"	18"	5-1/2"	12-3/8"	21-3/8"	11-5/16"	20-5/16"	6-7/16"	17
	C8136	1-1/2" square	✓								5-3/16"	
	C8137	2-1/2" rolled	✓								4"	
Cosmic, Galaxy Mercury 2.5 - 5 lb	C1730	2-1/4" square	✓	10-1/2"	24"	5-1/2"	13-7/8"	27-3/8"	12-13/16"	25-5/16"	4"	22
Cosmic/Galaxy 2.5 - 6 lb (mount 6 lb to tub) Mercury 2.5 - 5 lb	C1835	3/8" flat square	✓	10-1/2"	24"	5-1/2"	13-7/8"	27-3/8"	12-13/16"	25-5/16"	6-7/16"	22
	C1836	1-1/2" square	✓								5-3/16"	
	C1837	3" rolled	✓								3-11/16"	
	C1832	4" rolled w/ rec hndl	✓								2-7/8"	
	C1838	4-1/2" rolled									2-3/16"	
Cosmic, Galaxy 2.5 - 10 lb Mercury 2.5 - 5 lb Sentinel 5 lb	C1035	3/8" flat square	✓	10-1/2"	24"	6"	13-7/8"	27-3/8"	12-13/16"	25-5/16"	6-15/16"	23
	C1036	1-1/2" square	✓								5-11/16"	
	C1037	3" rolled	✓								4"	
	C1032	4" rolled w/ rec hndl	✓								3-3/8"	
	C1038	4-1/2" rolled									2-11/16"	
Cosmic, Galaxy (mount 20 lb to tub) Mercury 2.5 - 15 lb (mount 15.5 lb to tub) Sentinel 5 - 10 lb Grenadier, Saturn, Nebula 270	C2035	3/8" flat square	✓	12"	27"	7-3/4"	15-3/8"	30-3/8"	14-5/16"	29-5/16"	8-11/16"	29
	C2036	1-1/4" square	✓								7-11/16"	
	C2037	2-1/2" rolled	✓								6-7/16"	
	C2032	4" rolled w/ rec hndl	✓								5-1/8"	
	C2038	4-1/2" rolled									4-7/16"	
Cosmic, Galaxy (mount 20 lb to tub) Mercury 2.5 - 15 lb (mount 15.5 lb to tub) Sentinel 5 - 15 lb Grenadier, Saturn Nebula 250-272	C3035	3/8" flat square	✓	16"	32"	7-3/4"	19-3/8"	35-3/8"	18-5/16"	34-5/16"	8-11/16"	43
	C3036	1-1/4" square	✓								7-11/16"	
	C3037	2-1/2" rolled	✓								6-7/16"	
	C3032	4" rolled w/ rec hndl	✓								5-1/8"	
	C3038	4-1/2" rolled									4-7/16"	
Two each of: Cosmic, Galaxy (FE20C) (mount 20 lb to tub) Mercury 2.5 - 15.5 lb Sentinel 5 lb Grenadier, Saturn	C4035	3/8" flat square	✓	20"	27"	7-3/4"	23-3/8"	30-3/8"	22-5/16"	29-5/16"	8-11/16"	44
	C4036	1-1/4" square	✓								7-11/16"	
	C4037	2-1/2" rolled	✓								6-7/16"	
	C4032	4" rolled w/ rec hndl	✓								5-1/8"	
	C4038	4-1/2" rolled									4-7/16"	

Fire-rated specific wall opening

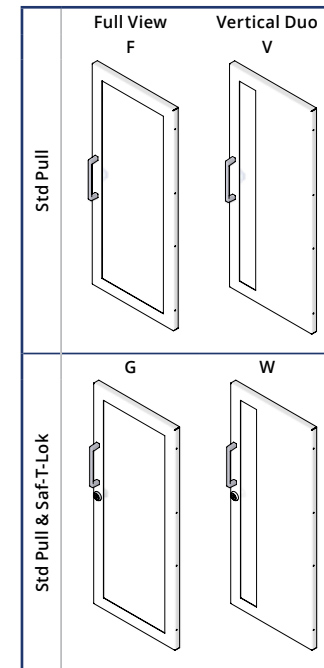
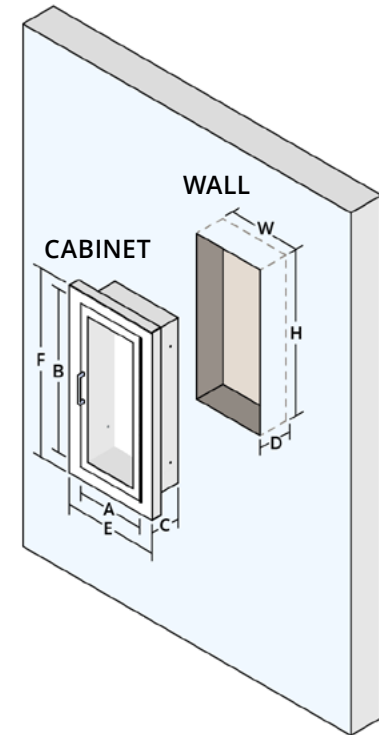

FIRE PROTECTION CABINET - ARCHITECTURAL: COSMOPOLITAN FIRE-FX2™ Series - Stainless Steel

COMMON CABINETS

QTY	MODEL	DESCRIPTION
	C1035V10FX2	FIRE-RATED, 3/8" FLAT TRIM, VERT, CLR ACR
	C1037F10FX2	FIRE-RATED, 3" RLD TRIM, FL VIEW, CLR ACR
	C1037V10FX2	FIRE-RATED, 3" RLD TRIM, VERT, CLR ACR
	C1037W10FX2	FIRE-RATED, 3" RLD TRIM, VERT DUO W SAFTLOK, CLR ACR
	C1037G10FX2	FIRE-RATED, 3" RLD TRIM, FL VIEW SAFTLOK, CLR ACR

GLAZING

QTY	MODEL	DESCRIPTION
	G10F17	1/8" CLR TEMPERED, 8-1/2" x 22-3/4"

For quick ship from warehouses, order separately with cabinet instead of made-to-order on cabinet.
Ex. Order C1037F10FX2 and G10F17 instead of C1037F17FX2

HANDLES

QTY	MODEL	DESCRIPTION
	PUF	FUTURA "FIRE" HANDLE, MILL
	PUFR	FUTURA "FIRE" HANDLE, RED
	PUFW	FUTURA "FIRE" HANDLE, WHITE
	PUCH	PULL HANDLE, CHROME



PLASTIC SIGNS

QTY	MODEL	DESCRIPTION
	22S	FE, 3D ANGLE, 4" x 12"
	23S	FE, 3D TENT, 4" x 18"
	24S	FE, 3D TENT, 5" x 6"
	25S	FE, FLUSH, 4" x 12"



LETTERING

QTY	MODEL	DESCRIPTION
	LDCVRFE	DIE CUT, VERT, RED, FIRE EXTINGUISHER, 3/4" x 18"
	LDCVBFE	DIE CUT, VERT, BLACK, FIRE EXTINGUISHER, 3/4" x 18"
	LDVRFE	DECAL, VERT, RED, FIRE EXTINGUISHER, 3/4" x 18"
	LDCVRFE-ESM-A	DIE CUT, VERT, RED, FIRE EXTINGUISHER (fits 81 tub), 3/4" x 14"
	LDCHRFE-2	DIE CUT, HORZ, RED, FIRE EXTINGUISHER, 2" HIGH, 4-1/2" x 21"

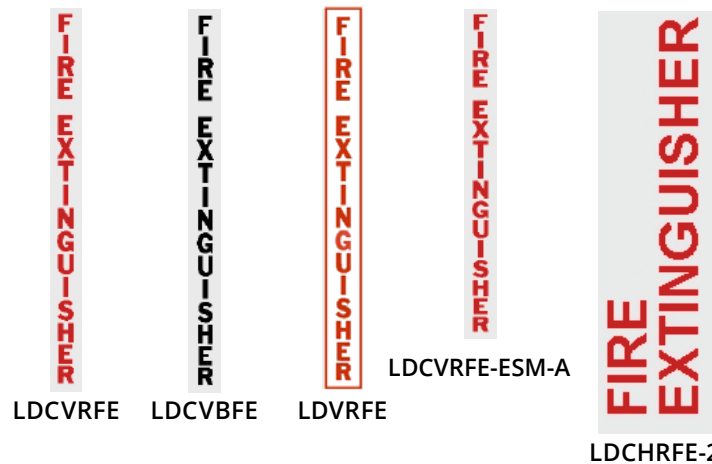

ALARMS

QTY	MODEL	DESCRIPTION
	BA	BRIGADIER ALARM, MINI THEFT STOPPER WITH DOOR POSITION SENSOR
	C-KIT-CA	COMMANDER ALARM KIT, includes alarm, 9V battery, & screws

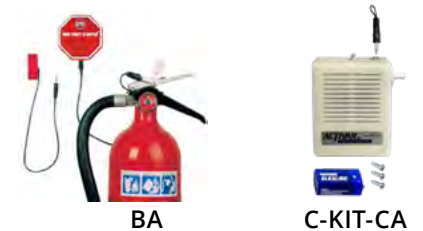

Refer to supplemental submittals for information on more options and accessories.

It is the responsibility of the customer to communicate specifications and product performance requirements that are needed for their application. This document is intended to convey potential product configurations and offerings. It is not to be used to imply or represent a specification or rating of finished products shipped. Detailed, specific submittals can be created upon request. It is the responsibility of the customer to specify product accordingly to comply with local laws, codes, and ordinances.

MADE-TO-ORDER ACADEMY FIRE PROTECTION CABINET - EXAMPLE: C1037W17A-F7ET01

QTY	PRODUCT LINE	TUB MATERIAL (optional)	TUB I.D. SIZE	DOOR/TRIM MATERIAL	TRIM PROJECTION	DOOR/LATCH STYLE	GLAZING/DOOR TYPE
C (Cabinet)	(None)	Steel (Std.)	81 9" x 18" x 5-1/2"	3 Stainless Steel, #4 satin	5 Fully recessed 3/8" square flat edge	F Full view	10 .09" Clear acrylic
		SS Stainless steel #4	17 10-1/2" x 24" x 5"		6 Semi-recessed 1-1/4" or 1-1/2" square edge	G Full view w/ Saf-T-Lok™	13 1/4" Clear wired glass
		18 10-1/2" x 24" x 5-1/2"	0 Semi-recessed 2-1/4" square edge (1700 series only)		D Horizontal duo	15 1/8" Bronze acrylic	
		10 10-1/2" x 24" x 6"	7 Semi-recessed 2-1/2" or 3" rolled edge		E Horizontal duo w/ Saf-T-Lok™	16 1/8" Gray acrylic	
		20 12" x 27" x 7-3/4"	2 Semi-recessed 4" rolled edge, recessed handle		V Vertical duo	17 1/8" Clear tempered glass	
		30 16" x 32" x 7-3/4"	8 Semi-recessed 4-1/2" rolled edge		W Vertical duo w/ Saf-T-Lok™	18 1/4" Clear safety glass	
		40 20" x 27" x 7-3/4"	3 Surface-mount square edge (Std. for surface-mounted)		B Small view window w/ Saf-T-Lok™	21 No glazing, no lock w/ pull (S21 only)	
				9 Surface-mount rolled edge	S Solid	22 No glazing, Saf-T-Lok™ w/ pull (L22 only)	
					L Solid w/ Saf-T-Lok™	24 No glazing, Saf-T-Lok™ and no pull (L24 only)	





FIRE-RATED	HANDLE/LATCH OPTIONS	ALARM OPTIONS	MATERIAL OPTIONS	FINISH	LETTERING OPTIONS
FX2 Fire-Rated 2 hrs	(none) Standard handle w/ roller catch	CA Commander	F6 #6 Satin stainless steel	W4 White door, trim, tub	SS01 Silkscreen: SS-FELVR FIRE EXTINGUISHER, vertical, red
	A Recessed handle	BA Brigadier	F7 #7 Polished stainless steel	BK4 Black door, trim, tub	SS01D* Silkscreen: SS-FELVR FIRE EXTINGUISHER, vertical, red, on door
	LH Lever handle (not avail. w/ cylinder lock)	SA Strobe	F8 #8 Mirror stainless steel Not avail on square surf mt	R4 Red door, trim, tub	SS01G* Silkscreen: SS-FELVR FIRE EXTINGUISHER, vertical, red, on glazing
	FM Futura "FIRE" Mill			COLOR - OTHER (please specify) Refer to supplemental submittal	ET01 Etching: ET-FELVR FIRE EXTINGUISHER, vertical, red (for glass only)
	FR Futura "FIRE" Red			Door	EN01 Engraving: EN-FELVR FIRE EXTINGUISHER, vertical, red (for metal only)
	FW Futura "FIRE" White			Trim	LETTERING - OTHER (please specify) Refer to supplemental submittal
				Tub	Other

* DUO style doors (D, E, V, W) must specify location of silkscreen

Refer to supplemental submittals for information on more options and accessories.

USE SECTION BELOW TO LIST OTHER CABINETS

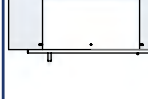
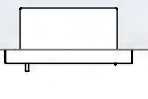
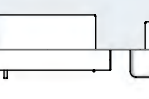
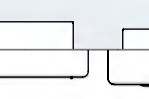
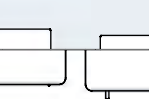
QTY	MODEL NUMBER (ex: C1037F10FX2A)	NOTES:

TRIM STYLE & PROJECTION					
RECESSED	SEMI-RECESSED				
5	6	0	7	2	8
					
3/8" Flat Square	1-1/4" or 1-1/2" Square	2-1/4" Square	2-1/2" or 3" Rolled	4" Rolled w/ Rec. Hndl	4-1/2" Rolled