

## INSTALLATION:

### XT/XTS - Exterior Cladding Installation Instructions:

1. With metal or wood studding, install a framed opening at specified location. Opening dimensions should be 3/8" larger than the frame I.D. of the panel; i.e., for a 12" x 12" panel, opening should be 12-3/8" x 12-3/8".  
WALL OPENING (C) = ORDER SIZE (A) + 3/8"
2. Frame all four sides of the access panel. On panels larger than 16" x 16", install a double stud on both sides in the same manner as at passage panels.
3. Place panel in position in opening and mark location of attachment on studding using holes in all four sides of panel frame as marking guide.
4. Remove panel and drill 5/32" holes through studs at marked points.
5. Apply Dow Corning® 995 sealant (PN 20001) or equivalent around the back perimeter of flange/frame and inside the mounting holes before inserting screws -- shown in red. Sealant not provided.
6. Place panel in position and attach with #10 flat head screws or equivalent (by others).
7. Check panel for freedom of movement. If it binds, shim as necessary to remove any racking of frame at attachment to studding.

### XT/XTS - Masonry Installation Instructions:

1. Opening should be planned to dimensions 3/8" larger than door size of panel; i.e., for a 12" x 12" panel, opening should be 12-3/8" x 12-3/8". WALL OPENING (C) = ORDER SIZE (A) + 3/8"
2. Position the panel in the wall opening provided for it and mark location of attachments on wall using holes in latch and hinge sides of panel frame as marking guides.
3. Remove panel and install expansion shields in wall at marked points.
4. Use mortar between frame of panel and block wall to provide a complete closure around frame of panel. Apply Dow Corning® 995 sealant (PN 20001) or equivalent around the back perimeter of flange/frame and inside the mounting holes before inserting screws -- shown in red. Sealant not provided.
5. Place panel in position and attach with #10 flat head screws or equivalent (by others).
6. Check panel for freedom of movement. If it binds, shim as necessary to remove any racking of frame at attachments to masonry.

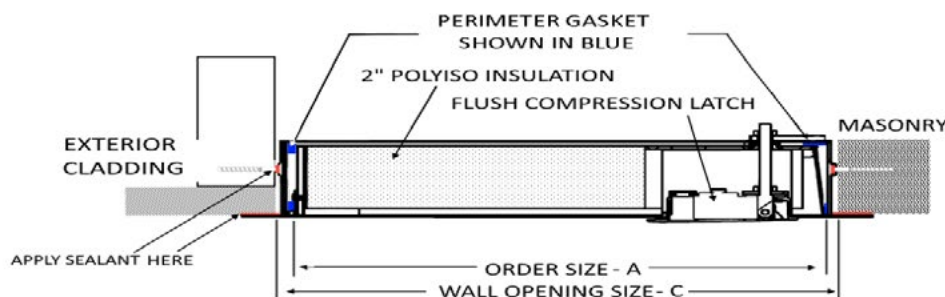

FIG. 1 XT Installation for Compression Latch and L Handle



JL INDUSTRIES

9702 Newton Ave S. Bloomington, MN 55431 | Many Locations Nationwide

800-554-6077

sales@activarcpg.com

www.activarcpg.com

Installation & Maintenance Guide

**INSTALLATION:**

**XTEA/XTES - Plaster & Stucco Installation Instructions:**

1. With metal or wood studding, install a framed opening at specified location. Opening dimensions should be 3/8" larger than the frame I.D. of the panel; i.e., for a 12" x 12" panel, opening should be 12-3/8" x 12-3/8".  
WALL OPENING (C) = ORDER SIZE (A) + 3/8"
2. Frame all four sides of the access panel. On panels larger than 16" x 16", install a double stud on both sides in the same manner as at passage panels. Panel lath trim is recessed 3/4" for plaster and stucco.
3. Place panel in position in opening and mark location of attachment on studding using holes in all four sides of panel frame as marking guide.
4. Remove panel and drill 5/32" holes through studs at marked points.
5. Apply Dow Corning® 995 sealant (PN 20001) or equivalent around the back perimeter of flange/frame and inside the mounting holes before inserting screws. Sealant not provided.
6. Place panel in position and attach with #10 flat head screws or equivalent (by others).
7. Check panel for freedom of movement. If it binds, shim as necessary to remove any racking of frame at attachment to studding.
8. Apply layers of plaster over metal lath and flange. After smoothing plaster, only a slit around the 3 door edges and painted hinge will show.

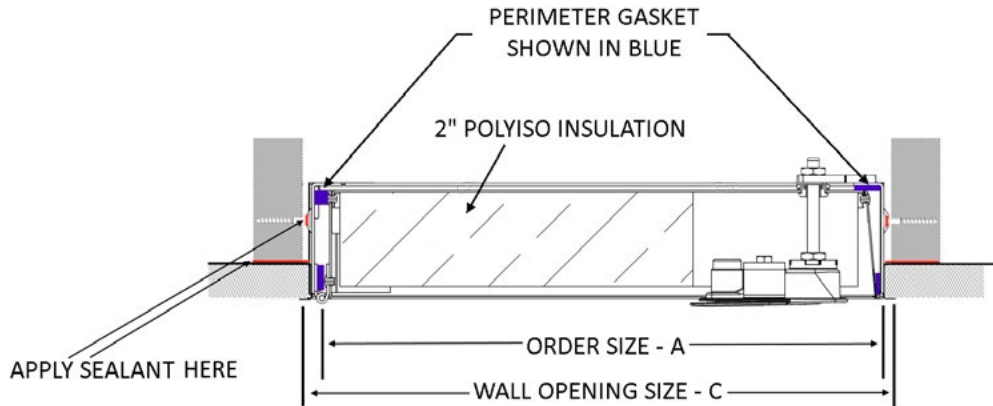

**FIG. 3 XTE Installation for Compression Latch and L Handle**



**JL INDUSTRIES**

9702 Newton Ave S. Bloomington, MN 55431 | Many Locations Nationwide

800-554-6077

sales@activarcpg.com

www.activarcpg.com

**Installation & Maintenance Guide**

## OPERATION:

**Caution: Make sure to consider weather conditions prior to using the access panel. Use caution at all times, especially when access panel is open.**

Opening with the compression latch: If the compression latch is locked, use provided key to unlock from the exterior. Lift handle from top and turn 1/2 way and pull to open door. There is no interior release with this latch.

## MAINTENANCE:

- Our Access Panels are designed to be maintenance free. However, it is recommended that the outer surface of the panel, and the hinge area, be kept clear from debris and dirt, to ensure correct operation of the hinged door.
- If latches, locks or hinges need to be lubricated, use a "3 in 1" type light oil, removing excess with a cloth.
- To clean painted surfaces, use a soft cloth and mild soap and water.
- To clean stainless steel, use a soft cloth and mild soap and water solution. After cleaning, thoroughly rinse with clear water to remove all traces of the solution and wipe dry to prevent water marks from forming. Stains which resist that treatment can usually be removed by polishing in the direction of the grain with a soft cloth and a non-abrasive stainless steel polish. Test in an unobtrusive location.



**JL INDUSTRIES**

9702 Newton Ave S. Bloomington, MN 55431 | Many Locations Nationwide

 800-554-6077

 [sales@activarcpg.com](mailto:sales@activarcpg.com)

 [www.activarcpg.com](http://www.activarcpg.com)

**Installation & Maintenance Guide**