

Mechanically Fastened and Fully Adhered Details

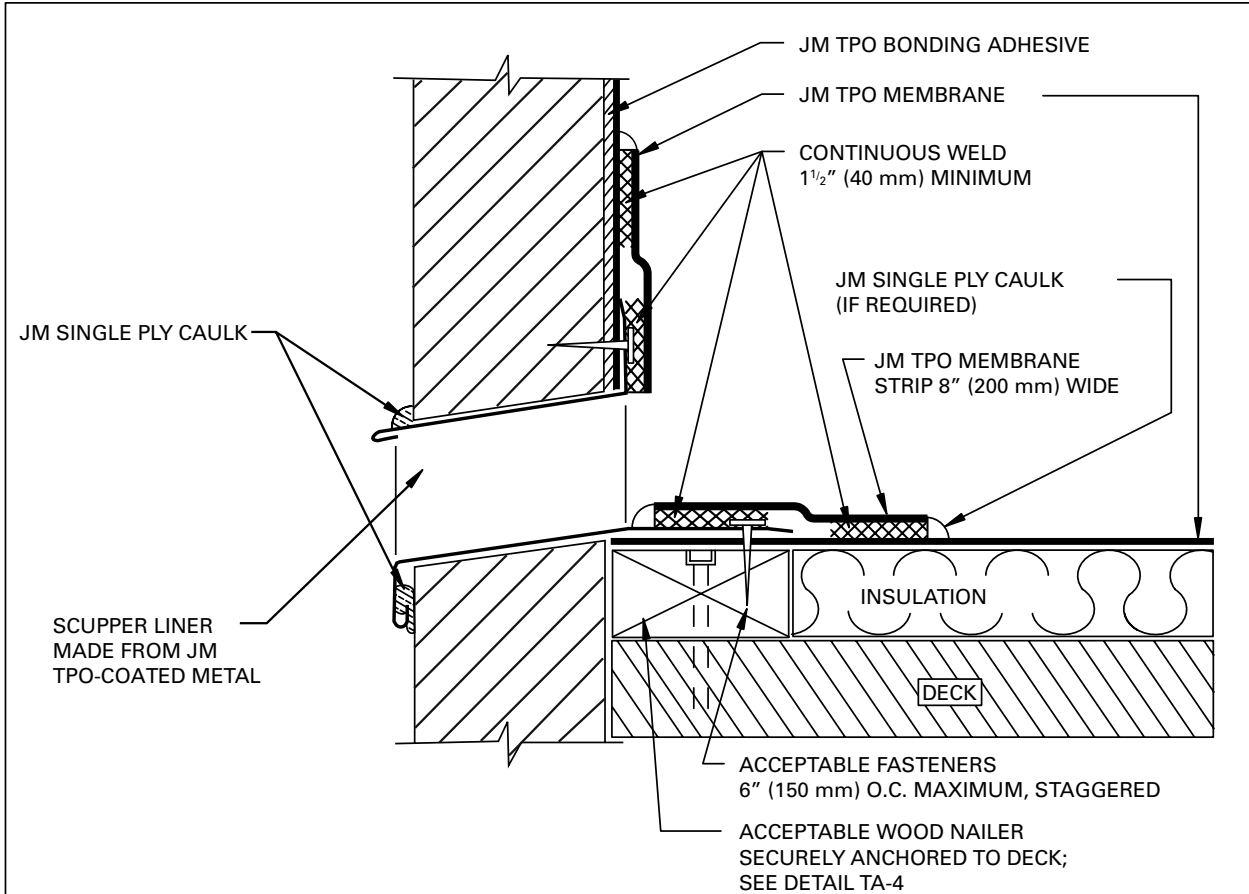

NOTES:

1. DETAILS TO BE USED IN CONJUNCTION WITH GUIDE SPECIFICATIONS CONTAINING REQUIREMENTS FOR NAILERS, INSULATION, ETC.
2. JM SINGLE PLY CAULK IS USED TO SEAL THE MEMBRANE EDGES WHERE REINFORCING FABRIC IS CUT AND EXPOSED. EDGE SEALANT IS REQUIRED ON ALL END LAPS, T-JOINTS, AND FIELD-CUT EDGES.
3. THE EXTERIOR LOWER EDGE OF THE SCUPPER CAN BE BENT OUT AT 45° TO MAKE A DRIP EDGE IF DESIRED.
4. ATTACH SCUPPER FLANGES 6" (150 mm) O.C.

DRAWING NO. TF-58	THROUGH WALL SCUPPER			 Johns Manville
	SCALE N.T.S.	ISSUE DATE 3-06	CAD TPO-6.08	