

1) Prepare existing concrete by grinding away any irregularities.

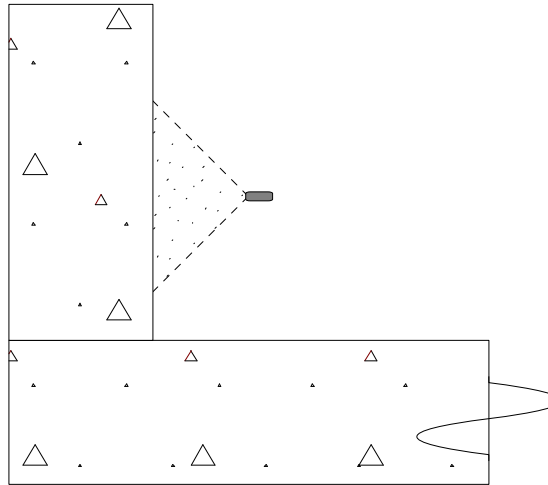

2) Thoroughly clean existing concrete using a wire brush, high pressure waterblast, or sand blast.

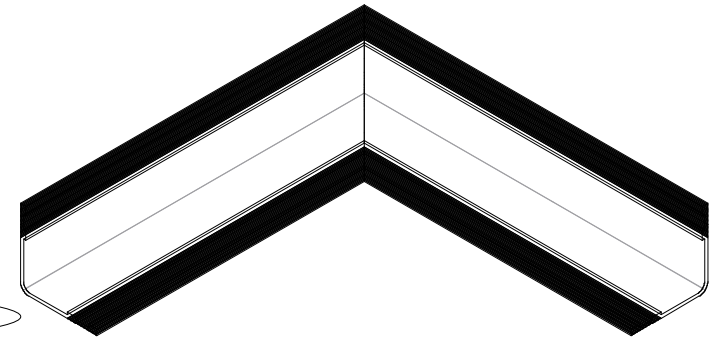

3) Heat weld waterstop profile to appropriate length and directional changes to fit concrete surface.

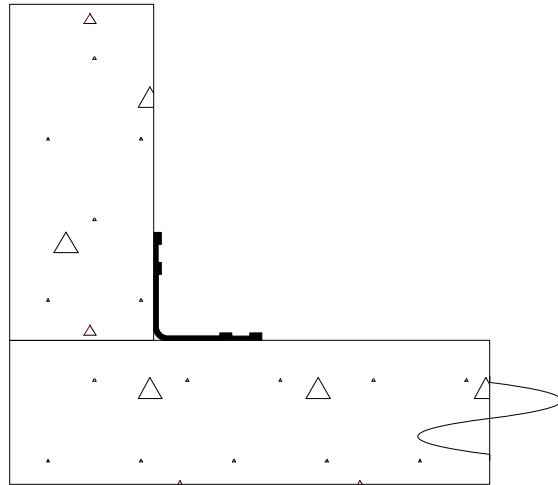

4) Check heat welded waterstop for proper location, orientation and fit.

J P Specialties, Inc. / Earth Shield® Waterstop 25811 Jefferson Avenue, Murrieta, CA 92562 951-763-7077 • www.jpsspecialties.com		
TITLE JP540L Retrofit Install		
PART NUMBER	DRAWN BY DRP	DATE 09/18
CAD FILE NAME JP540L Retrofit Install	APPROVALS	SIZE A

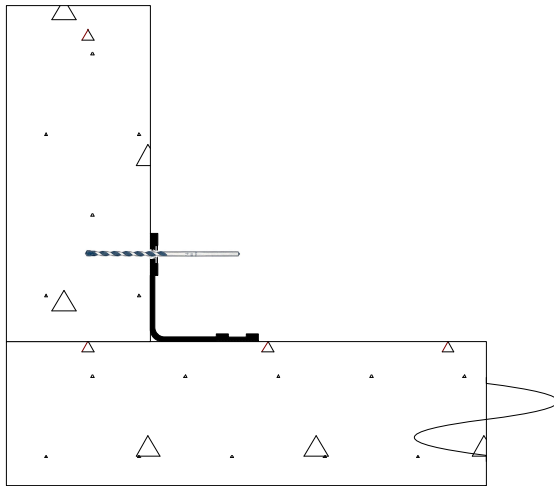

5) Using the prepunched stainless steel batten bar as a template, drill 1/4" holes 2-3/4" deep through waterstop and concrete. Clean out holes.

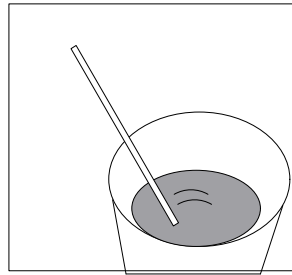

6) Mix appropriate amount of epoxy per mixing instructions on epoxy can.

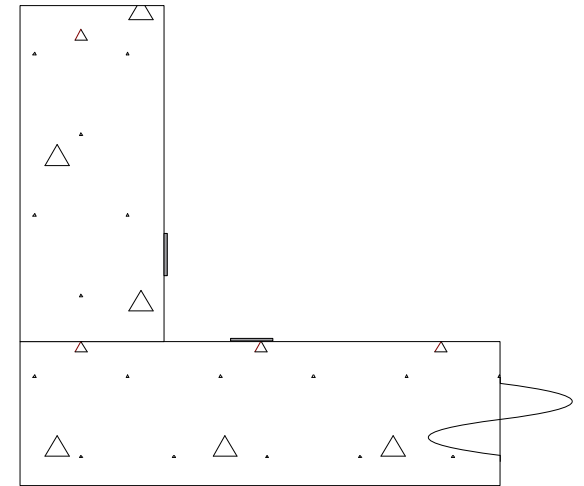

7) Place epoxy strip 1/8" deep by 1-3/4" wide on concrete surface at designated locations. (One strip of epoxy for each combed surface.)

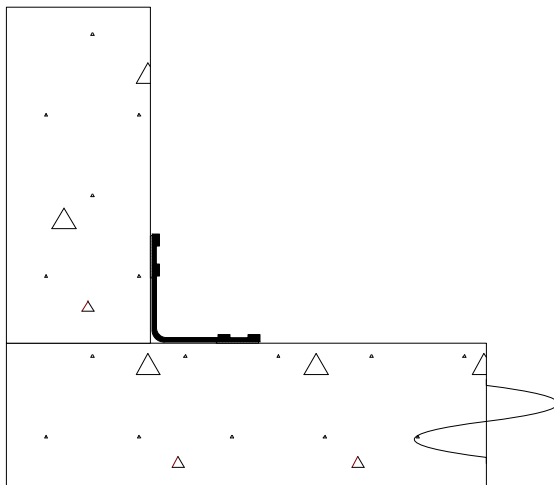

8) Embed waterstop into strips of uncured epoxy.

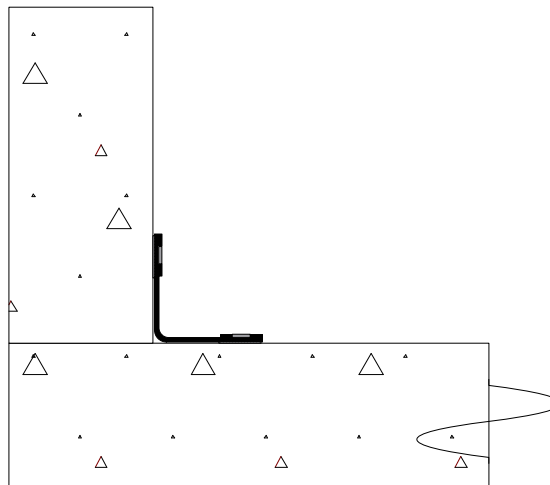

9) Place stainless steel batten bar in recesses of retrofit waterstop top and bottom.

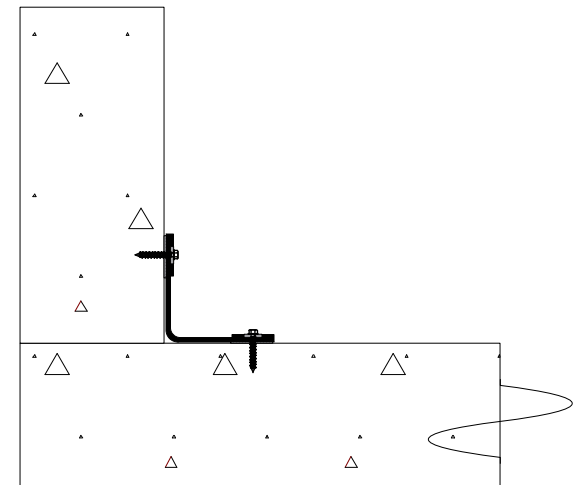

10) Install fasteners through predrilled holes in batten bar and waterstop and tighten as required.

For welding, fabrication, placement, execution, and quality assurance please follow all procedures stated in Earth Shield® Master Specification Section 03250.