



ELEVATE YOUR BUILD WITH FIRE RESISTANCE





CONTENTS

04

LP® FLAMEBLOCK®
FIRE-RATED SHEATHING
OVERVIEW

06

USES AND TECHNICAL
INFORMATION

08

PROPERTIES

09

ROOF DECK
APPLICATIONS

10

SINGLE-FAMILY WALL
ASSEMBLIES

11

TOWNHOUSE
SEPARATION WALL
ASSEMBLIES

12

TYPE I & II
CONSTRUCTION
EXTERIOR WALL
SYSTEMS

13

TYPE III
CONSTRUCTION
EXTERIOR WALL
ASSEMBLIES

16

TYPE V
CONSTRUCTION
EXTERIOR WALL
ASSEMBLIES

20

LP WEATHERLOGIC®
ASSEMBLIES

22

WOOD STUD
ASSEMBLIES

26

STEEL STUD
ASSEMBLIES



When it comes to defending your build from fire, LP® FlameBlock® Fire-Rated Sheathing combines proven flame-spread and burn-through resistance in one panel. Designed for wall and roof deck applications, each panel is coated with LP's proprietary Pyrotite® layer. Plus, it delivers exceptional strength and integrity to give you greater design flexibility on every build.

**PROVEN TO SLOW DOWN
THE SPREAD OF FLAMES.**





LP® FLAMEBLOCK® FIRE-RATED SHEATHING



Innovative Design: Made with LP's proprietary non-combustible, fiberglass-reinforced Pyrotite® coating bonded to the board on one or both sides.

Backed by LP: As with all of our products you'll be backed by LP, one of the biggest names in the industry serving customers nationwide since 1973. Choose LP FlameBlock Fire-Rated Sheathing for your next project.



MEET CODE. EXCEED EXPECTATIONS.®

LP® FlameBlock® Fire-Rated Sheathing is evaluated to meet code requirements for fire-resistant construction as a component of 1-hour and 2-hour wall assemblies and in roof deck applications.

LP FLAMEBLOCK SHEATHING APPLICATIONS

- Evaluated by ICC-ES ([ESR-1365](#), [ESL-1002](#), [PMG-1089](#))
- UL and Intertek fire-resistant rated wall assemblies tested in accordance with ASTM E119
- Evaluated to the performance requirements of IBC Section 2303.2 (Fire-retardant treated wood)
- Component of fire-resistance-rated construction (2021 IBC Section 703)
- Wall sheathing for exterior walls of Type III construction with a two-hour rating or less; 2-Sided FlameBlock Sheathing required
- Exterior walls and roof sheathing on buildings of Type I or II construction (2021 IBC section 603. 1); 2-Sided FlameBlock Sheathing required
- Roof sheathing on building of Type II, IV, V and residential construction for a distance of 4 feet on both sides of a fire wall (2021 IBC Section 706.6, exception 4.3 and 2018 IRC Section R302.2.4 exception)
- Class A interior finish material for walls and ceilings of Type V construction (2021 IBC Section 803); Pyrotite coating facing the interior of the building
- Thermal barrier of separating foam plastic insulation from the interior of a building (2021 IBC Section 2603.4); Pyrotite coating facing the interior of the building



Look beneath the Pyrotite® coating and you'll find the strength of LP® OSB.

LP® FlameBlock® Fire-Rated Sheathing features a proprietary non-combustible, fiberglass-reinforced Pyrotite® coating.

DESIGN STRENGTH AND FLEXIBILITY

LP FlameBlock panels carry load/span and shear design values equivalent to an untreated wood structural panel of the same thickness evaluated in accordance with US DOC PS 1 and PS 2. Using LP FlameBlock sheathing provides design flexibility by combining structural capacity and fire resistance in a single panel. It may eliminate a layer of gypsum to simplify and expedite the construction process.

EXPOSURE 1

Exposure 1 classification signifies that LP FlameBlock sheathing is intended to resist the effects of moisture on structural performance during active construction. The fire resistance of LP FlameBlock sheathing is not impacted by exposure to moisture during construction.

LP® FLAMEBLOCK® SHEATHING PROPERTIES

1-SIDED LP FLAMEBLOCK SHEATHING

2-SIDED LP FLAMEBLOCK SHEATHING

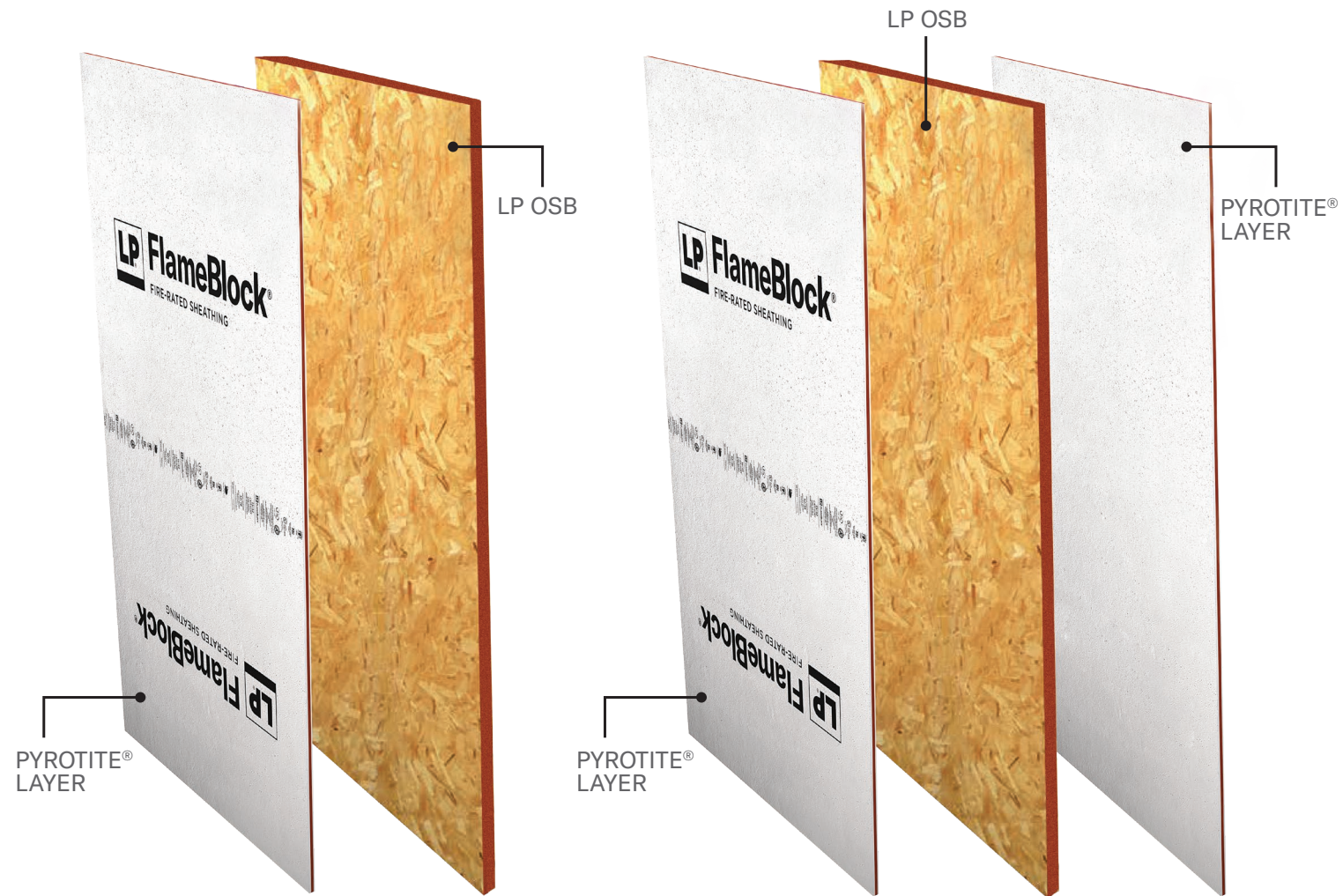

Nominal panel thickness and weights of LP FlameBlock Fire-Rated Sheathing

LP® FLAMEBLOCK® PANEL PERFORMANCE CATEGORY	NOMINAL FINISHED PANEL THICKNESS (IN.)		NOMINAL PANEL WEIGHT (PSF)	
	COATED ONE SIDE	COATED BOTH SIDES	COATED ONE SIDE	COATED BOTH SIDES
3/8	7/16	1/2	1.9	2.5
7/16	1/2	9/16	2.1	2.7
15/32	17/32	19/32	2.2	2.8
19/32	21/32	23/32	2.6	3.2
23/32	25/32	27/32	3.0	3.6

ROOF DECK APPLICATIONS

- Roof sheathing for 4 feet on both sides of a fire wall (ESR-1365 Section 4.2a)
- 2021 IRC Section 302.2.4 Exception
- 2021 IBC Section 706.6, Exception 4.3
- For construction Type III, IV, V and townhouses—1-Sided LP FlameBlock Panel with coated side facing the interior
- Roof sheathing in roof deck applications for construction Type I and II (ESR-1365 Section 4.2b)—2-Sided LP FlameBlock panels required

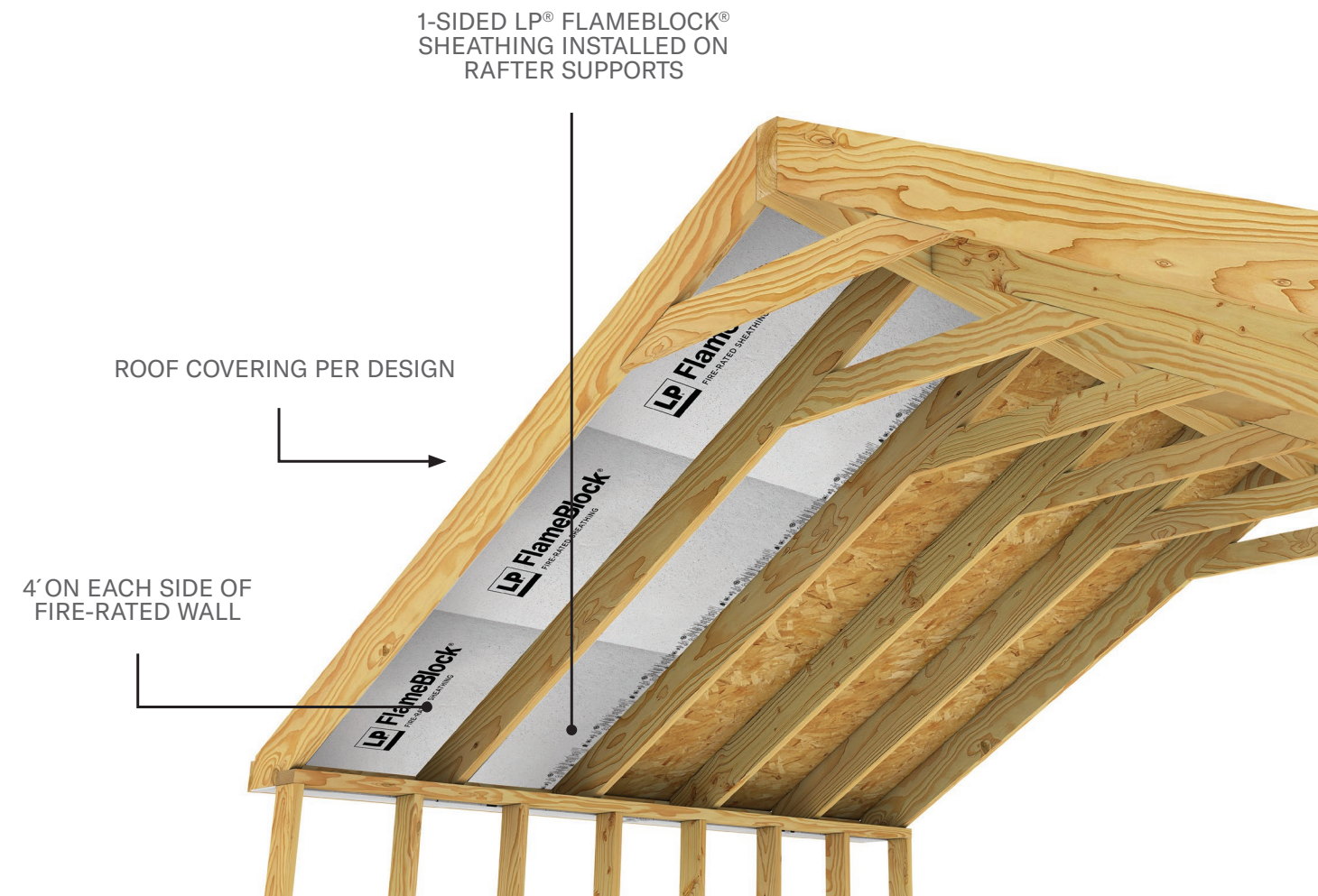

SINGLE-FAMILY

LP® FlameBlock® Fire-Rated Sheathing 1-Hour Fire Resistance Rated Wall Assemblies for single-family construction with fire separation distances (FSD) less than 5'-0" per IRC Table R302.1(1). LP FlameBlock assemblies for 1-hour fire resistance have resistance from either side and can eliminate the use of exterior gypsum. Maintains consistent wall thickness with unrated walls.

See pages 22-27 for additional assemblies. Reference assembly listings for additional information.

1-HOUR EITHER SIDE

V340 REPLACES PREVIOUS INTERTEK ASSEMBLY DESIGN NUMBER LPB/WPPS 60-01

V340

1-HOUR EITHER SIDE
LOAD RESTRICTED TO
40% STUD CAPACITY

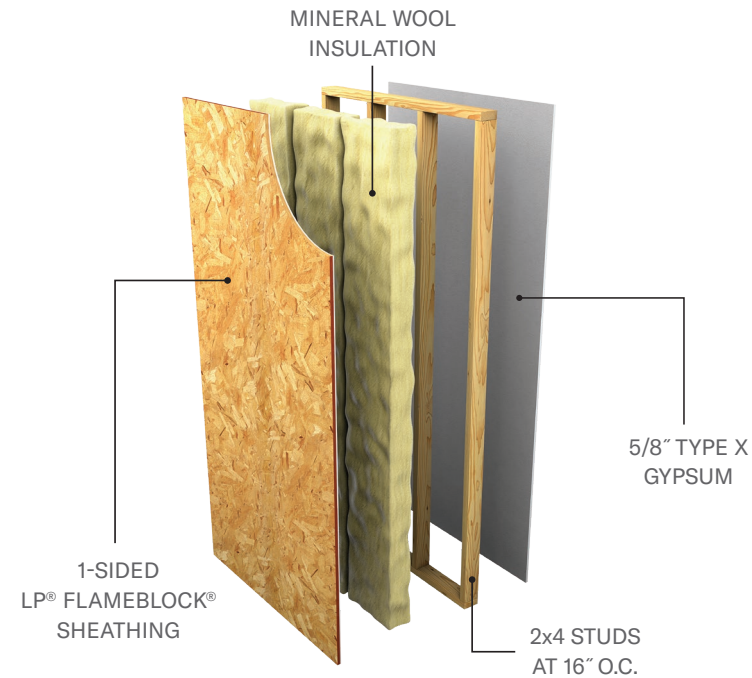

U348

1-HOUR EITHER SIDE

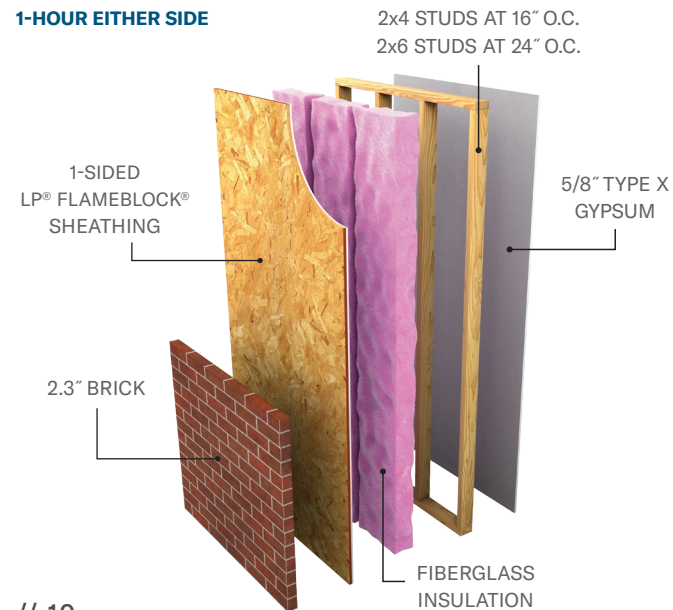

U348

1-HOUR EITHER SIDE

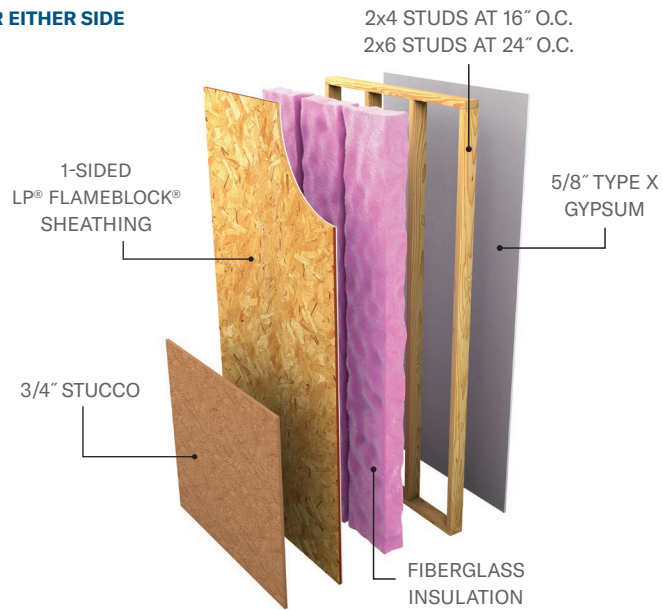

TOWNHOUSE SEPARATIONS

2-HOUR EITHER SIDE

COMMON 2-HOUR FIRE-RESISTANCE RATED WALL ASSEMBLY: IRC SECTION R302.2.2 SEE PAGES 22-27 FOR ASSEMBLIES CONTINUOUS FROM FOUNDATION TO ROOF SHEATHING

U350 A

2-HOUR EITHER SIDE

STAGGERED STUDS FOR STC=61 (TESTED), NOT REQUIRED FOR FIRE RESISTANCE

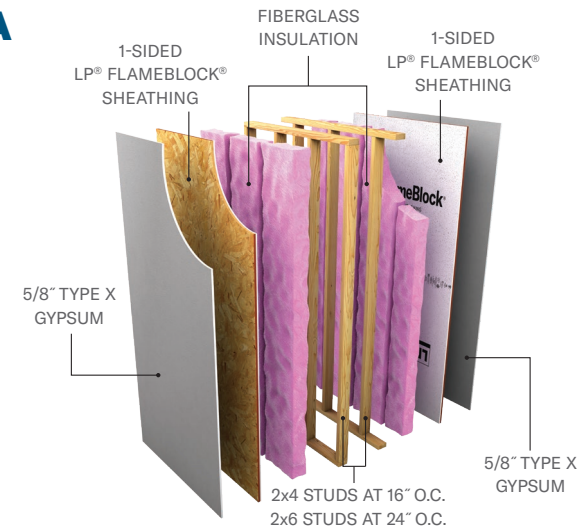

U350 B

2-HOUR EITHER SIDE

*STAGGERED STUDS AND RESILIENT CHANNEL REQUIRED FOR STC=61 (TESTED), NOT REQUIRED FOR FIRE RESISTANCE

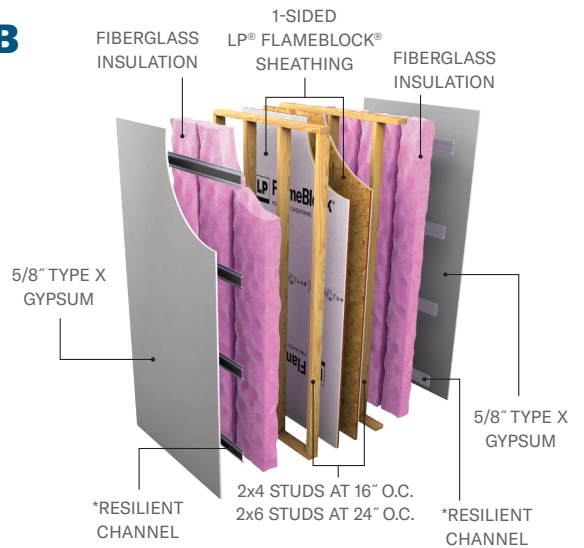

TWO 1-HOUR WALLS

TWO 1-HOUR FIRE-RESISTANCE RATED WALL ASSEMBLIES: IRC SECTION R302.2.1 DOUBLE WALLS

V340

TWO 1-HOUR WALLS
LOAD RESTRICTED TO 40%
STUD CAPACITY

*STAGGERED STUDS AND RESILIENT CHANNEL REQUIRED FOR STC=61 (TESTED), NOT REQUIRED FOR FIRE RESISTANCE

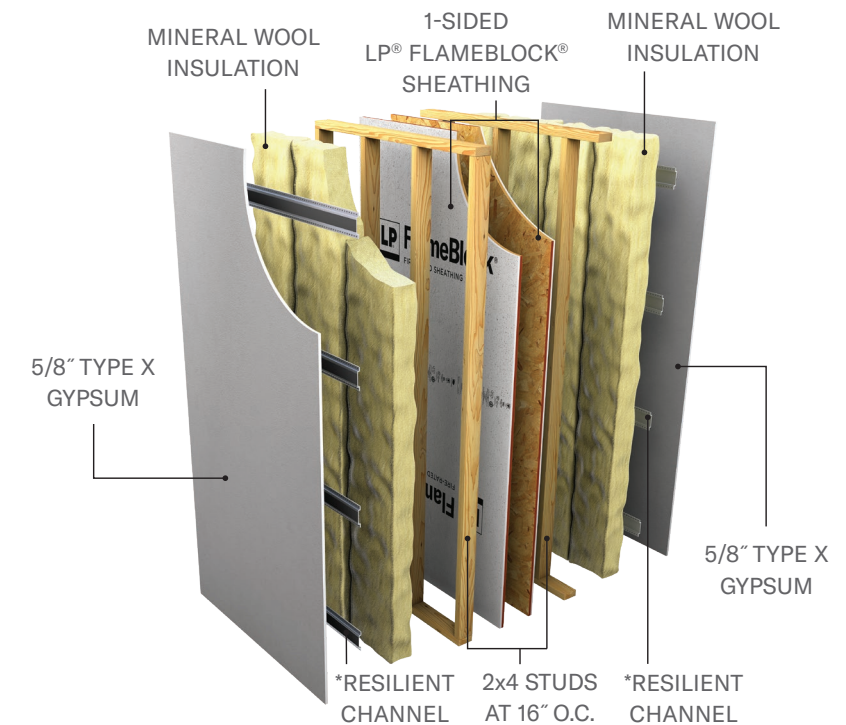

TYPE I & II CONSTRUCTION

2-sided LP® FlameBlock® sheathing is required for exterior walls and roof deck applications in buildings of Type I & II construction.

Ideal for exterior claddings attached directly to a structural panel. Many water-resistive coatings have been evaluated and demonstrated chemical compatibility with LP FlameBlock sheathing. [Please see LP Technical note.](#)

TYPE I & II NON-BEARING EXTERIOR WALL

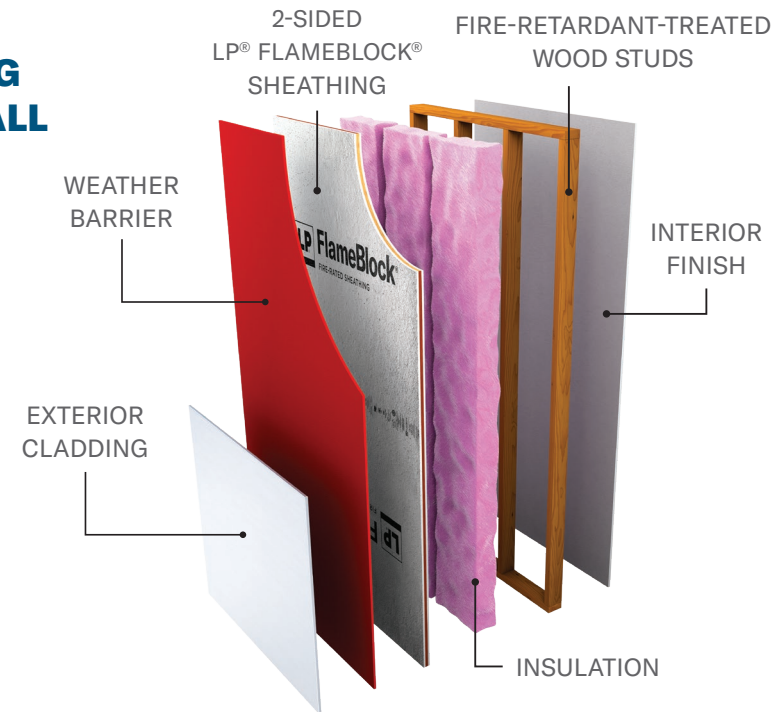

TYPE I & II NON-BEARING EXTERIOR WALL

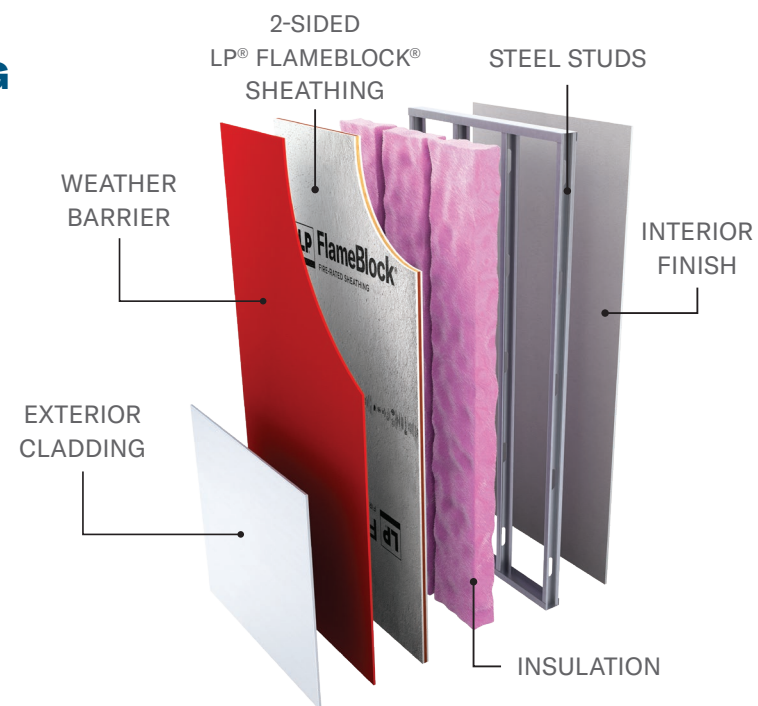

TYPE III CONSTRUCTION

2-sided LP® FlameBlock® sheathing and non-combustible or fire-retardant-treated wood (FRTW) studs are required for exterior walls in buildings of Type III construction. See pages 22-27 for other wood and metal stud assembly options not shown and assembly design listings for additional information.

2-HOUR EITHER SIDE

V337

2-HOUR EITHER SIDE
LOAD RESTRICTED TO
73% STUD CAPACITY

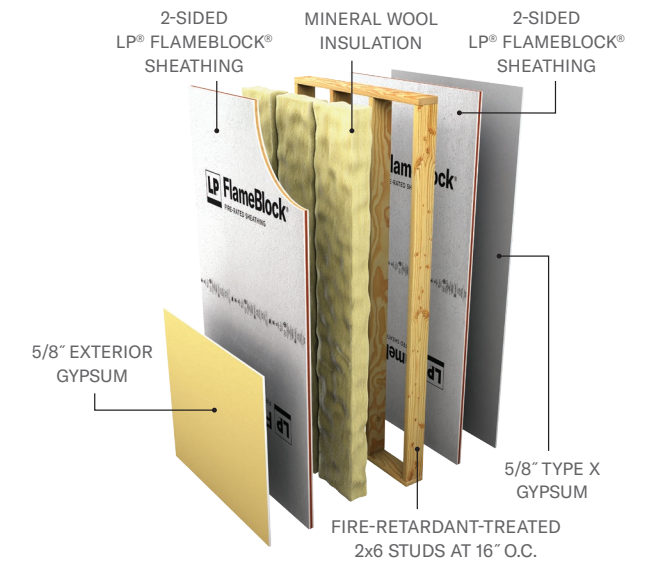
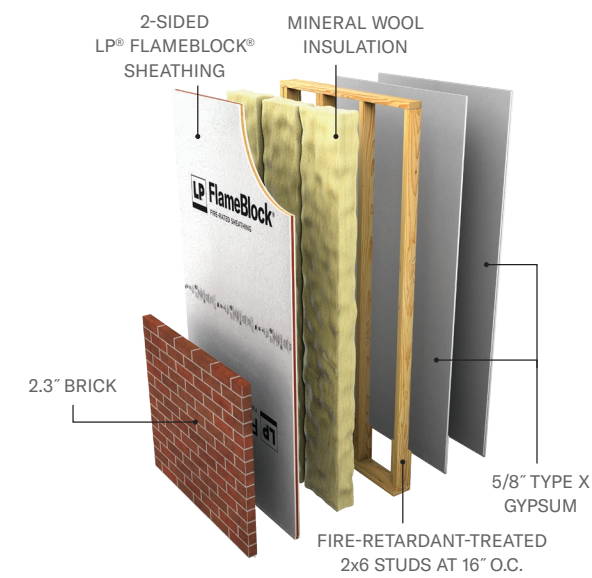
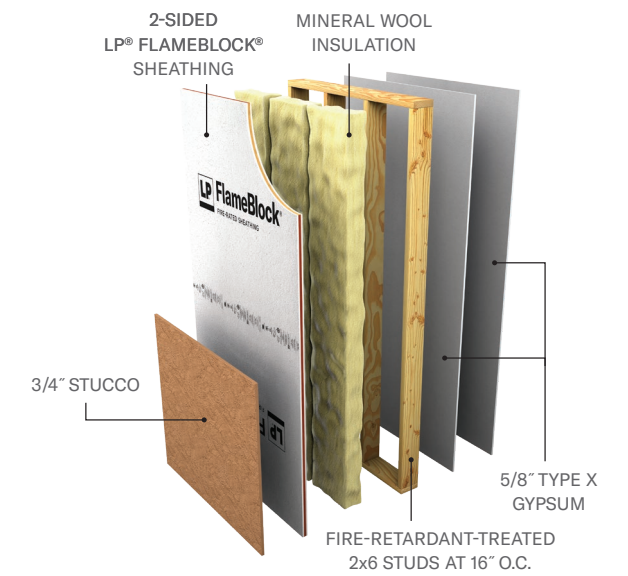
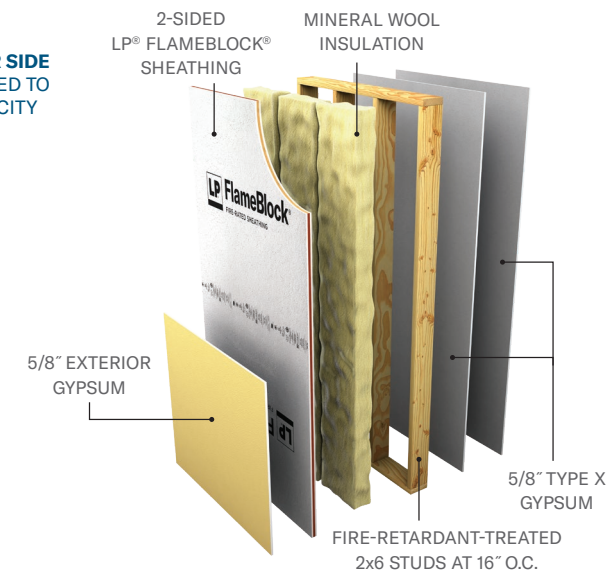

TYPE III CONSTRUCTION

2-sided LP® FlameBlock® sheathing and non-combustible or fire-retardant-treated wood (FRTW) studs are required for exterior walls in buildings of Type III construction. See pages 22-27 for other wood and metal stud assembly options not shown and assembly design listings for additional information.

2-HOUR EITHER SIDE

U349

2-HOUR EITHER SIDE

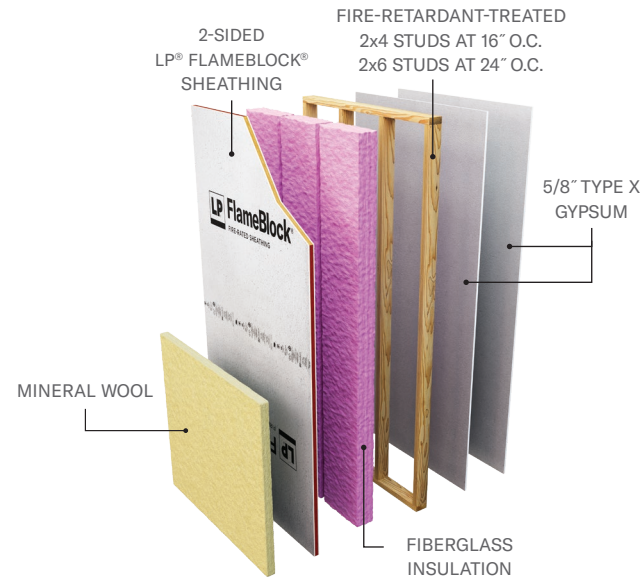

2-HOUR INTERIOR, 1-HOUR EXTERIOR

U349

2-HOUR INTERIOR/
1-HOUR EXTERIOR

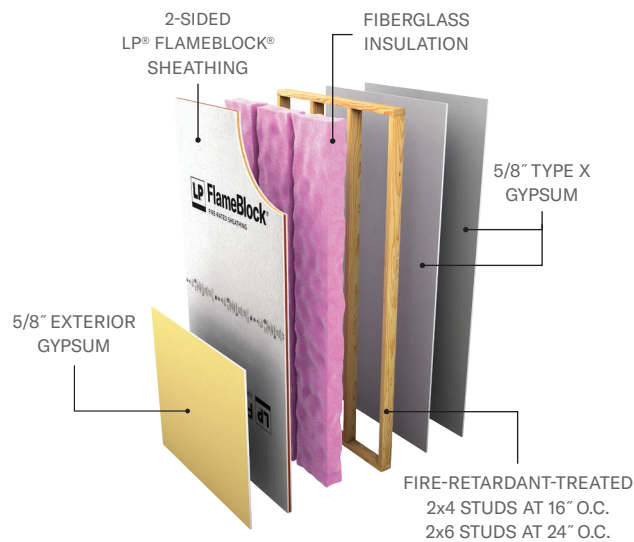
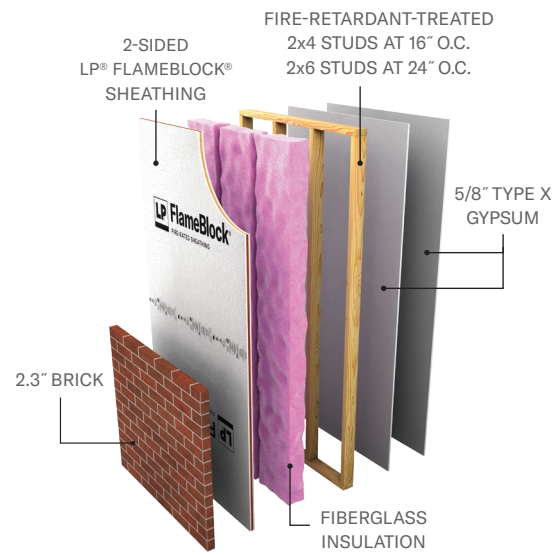
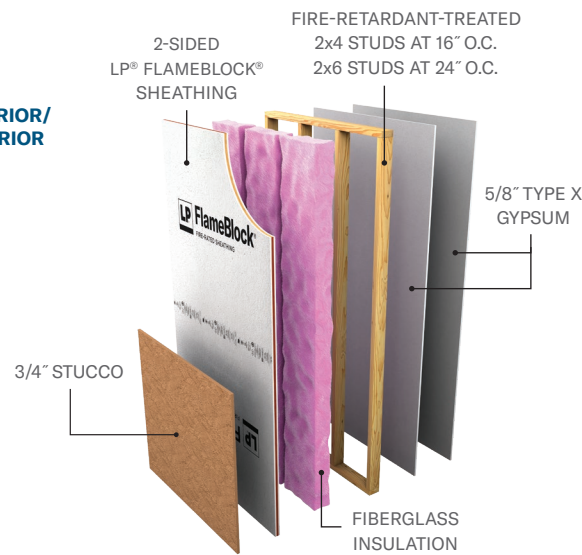

V337

2-HOUR INTERIOR
1-HOUR EXTERIOR
LOAD RESTRICTED TO
73% STUD CAPACITY

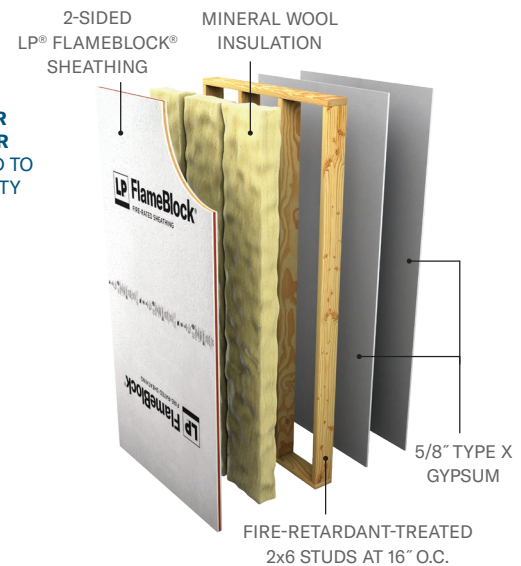

TYPE III CONSTRUCTION

2-sided LP® FlameBlock® sheathing and non-combustible or fire-retardant-treated wood (FRTW) studs are required for exterior walls in buildings of Type III construction. See pages 22-27 for other wood and metal stud assembly options not shown and assembly design listings for additional information.

1-HOUR EITHER SIDE

U348

1-HOUR EITHER SIDE

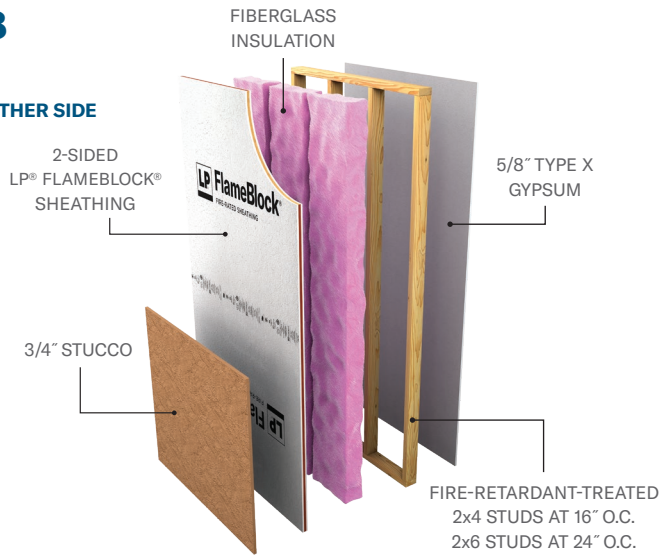

U348

1-HOUR EITHER SIDE



V337

1-HOUR EITHER SIDE
LOAD RESTRICTED TO
73% STUD CAPACITY

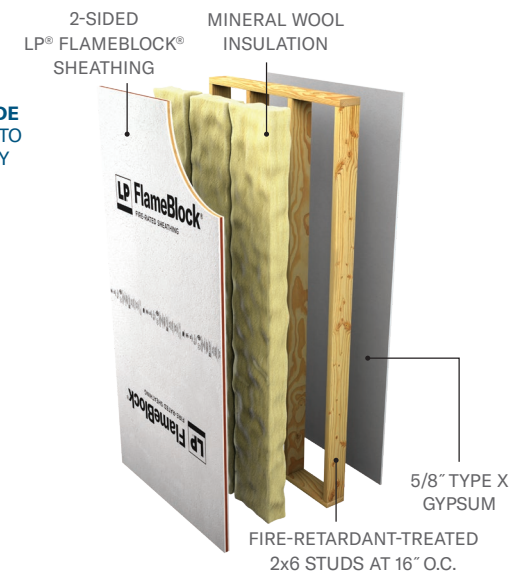

2-HOUR INTERIOR ONLY

U349

2-HOUR INTERIOR
RESISTANCE ONLY



1-HOUR INTERIOR ONLY

U348

1-HOUR INTERIOR
RESISTANCE ONLY

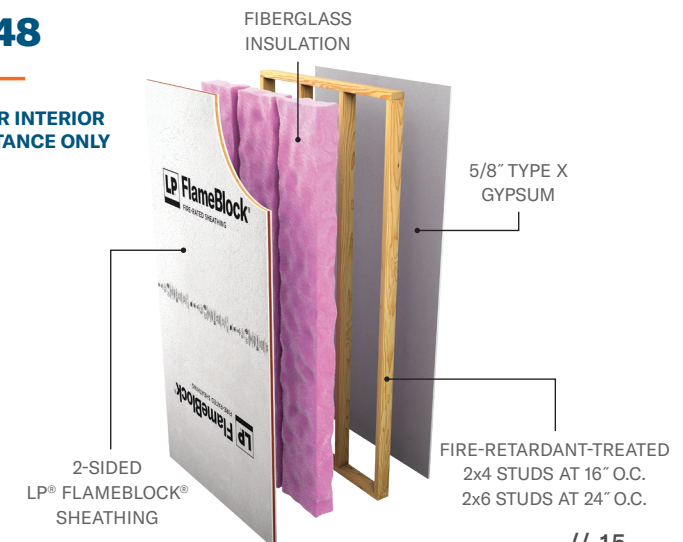

TYPE V CONSTRUCTION

See pages 22-27 for other wood and metal stud assembly options not shown and assembly design listings for additional information.

1-HOUR EITHER SIDE

V340

1-HOUR EITHER SIDE
LOAD RESTRICTED TO
40% STUD CAPACITY

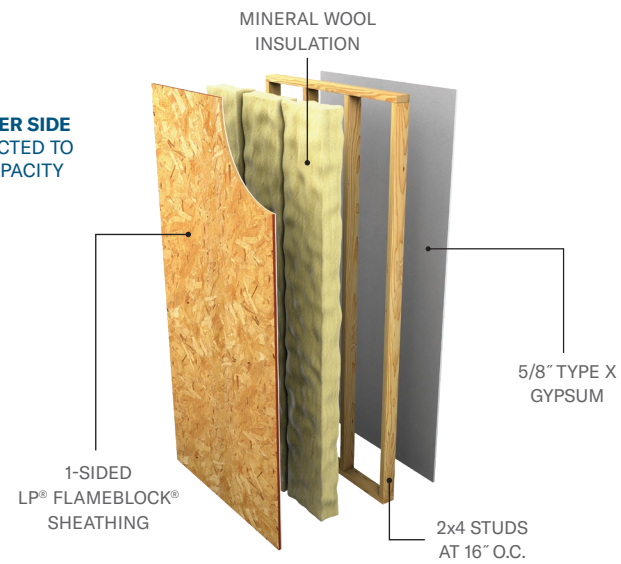

V337

1-HOUR EITHER SIDE
LOAD RESTRICTED TO
73% STUD CAPACITY

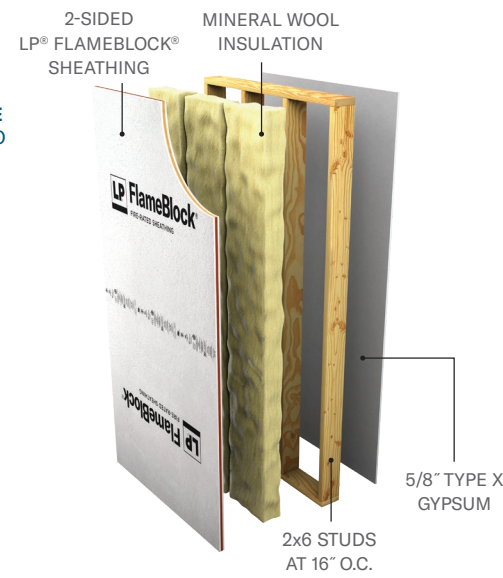

U348

1-HOUR EITHER SIDE

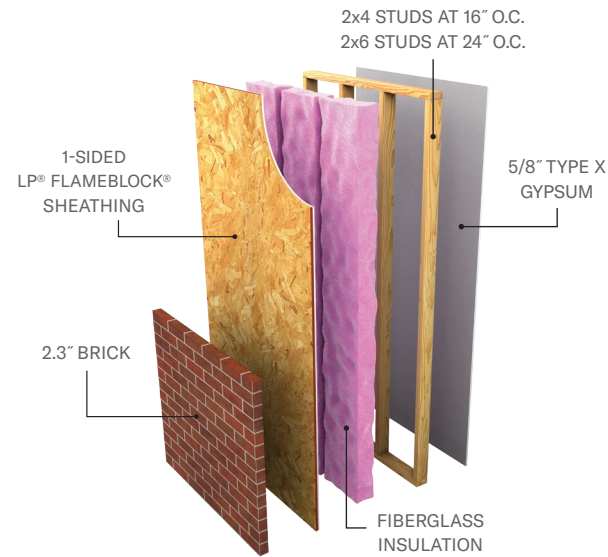
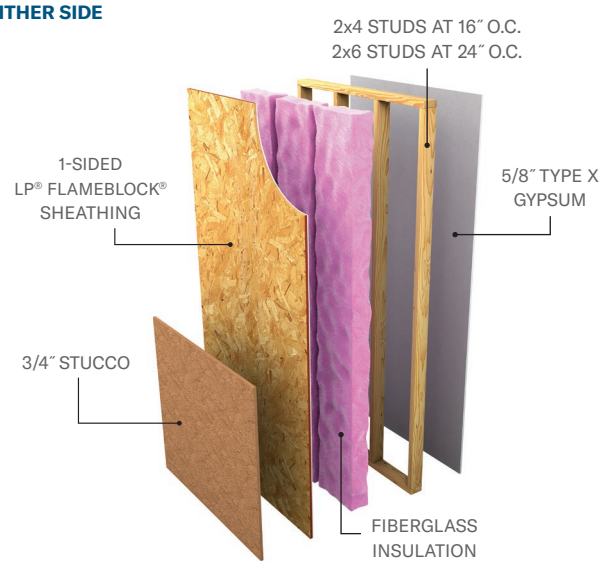

1-HOUR INTERIOR ONLY

U348

1-HOUR INTERIOR
RESISTANCE ONLY

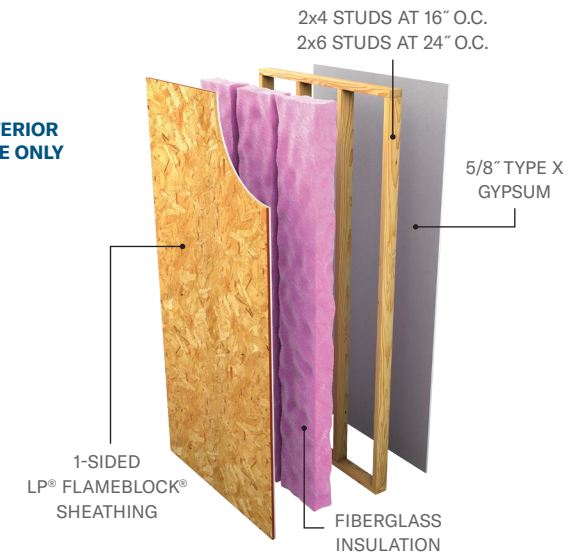

2-HOUR EITHER SIDE

V337

2-HOUR EITHER SIDE
LOAD RESTRICTED TO
73% STUD CAPACITY

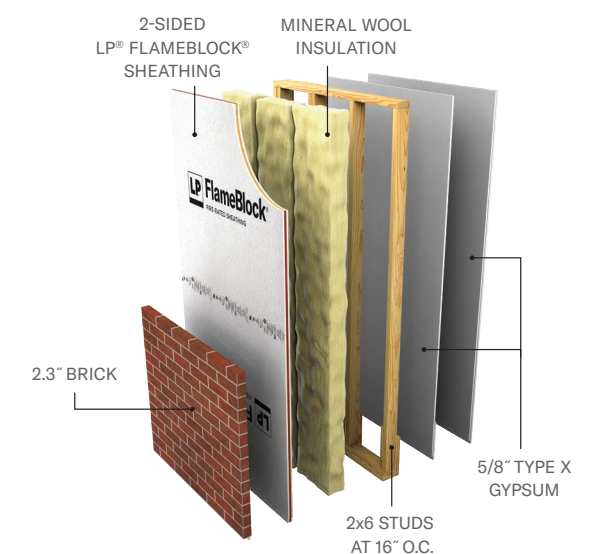
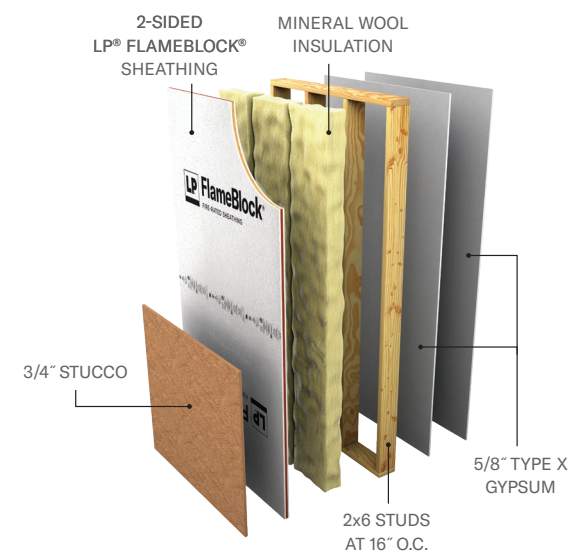
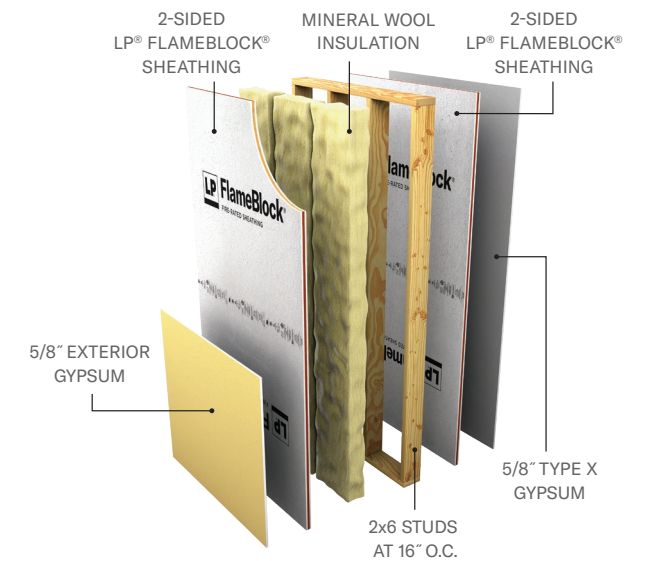
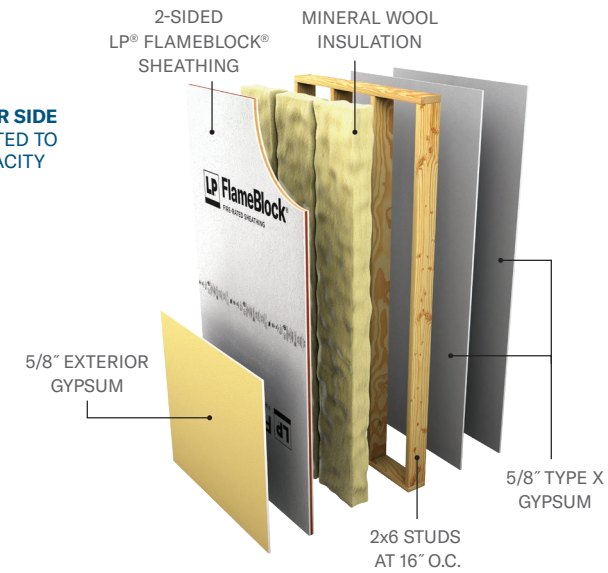

TYPE V CONSTRUCTION

See pages 22-27 for other wood and metal stud assembly options not shown and assembly design listings for additional information.

2-HOUR EITHER SIDE

U349

2-HOUR EITHER SIDE

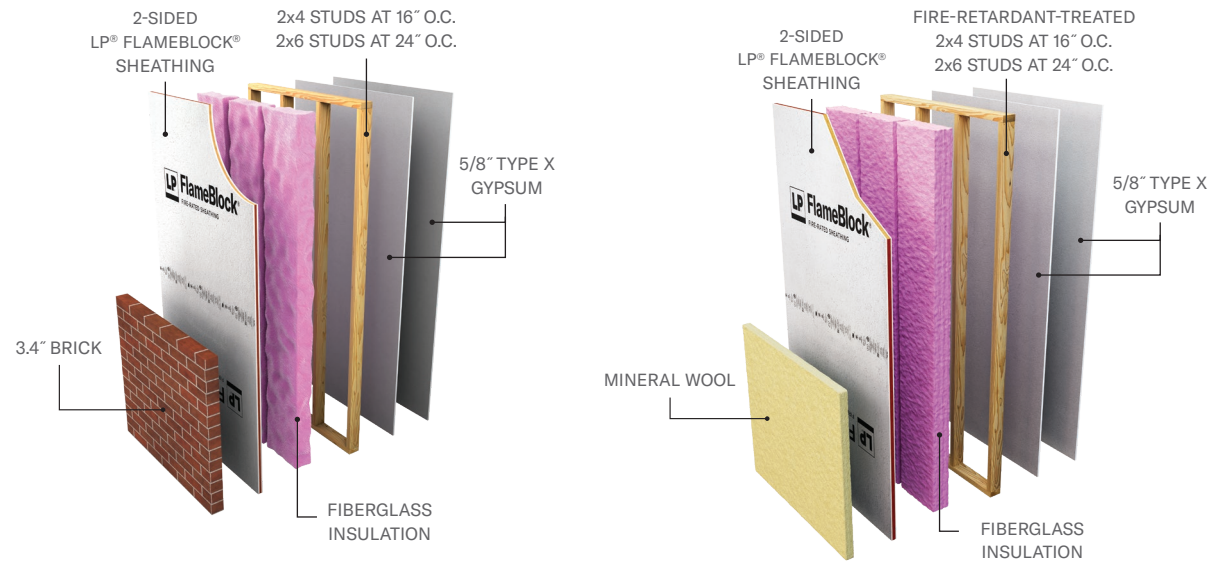

2-HOUR INTERIOR, 1-HOUR EXTERIOR

V340

2-HOUR INTERIOR
1-HOUR EXTERIOR
LOAD RESTRICTED TO
40% STUD CAPACITY

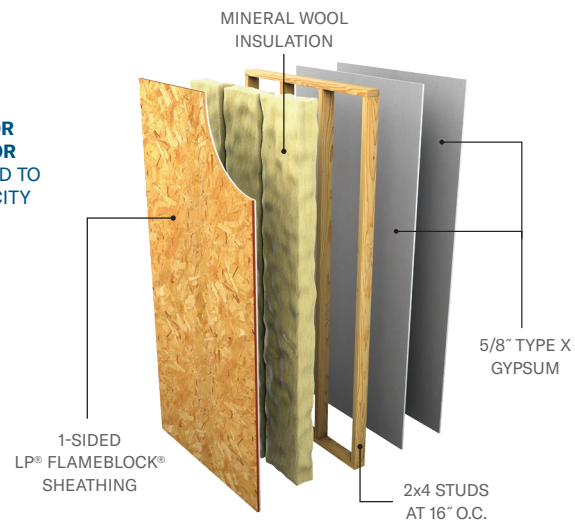

V337

2-HOUR INTERIOR
1-HOUR EXTERIOR
LOAD RESTRICTED TO
73% STUD CAPACITY

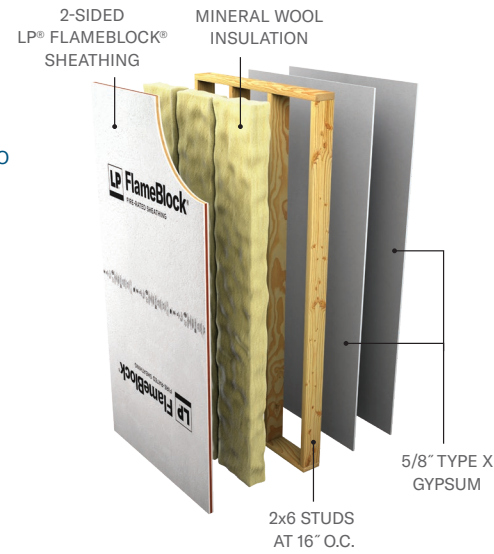

U349

2-HOUR INTERIOR
1-HOUR EXTERIOR

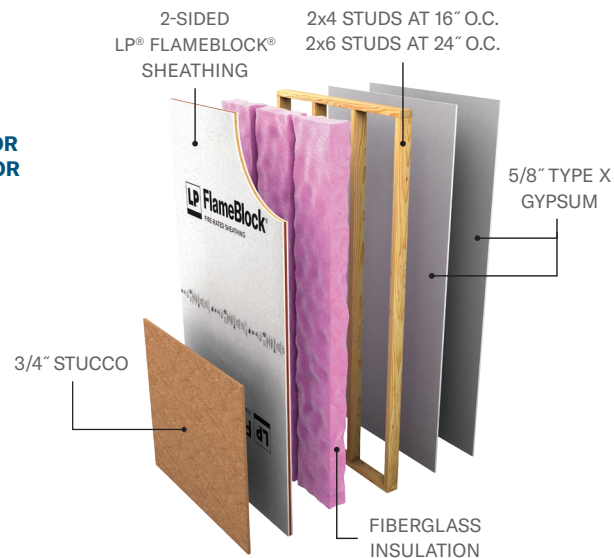

TYPE V CONSTRUCTION

See pages 22-27 for other wood and metal stud assembly options not shown and assembly design listings for additional information.

2-HOUR INTERIOR, 1-HOUR EXTERIOR

U349

2-HOUR INTERIOR
1-HOUR EXTERIOR

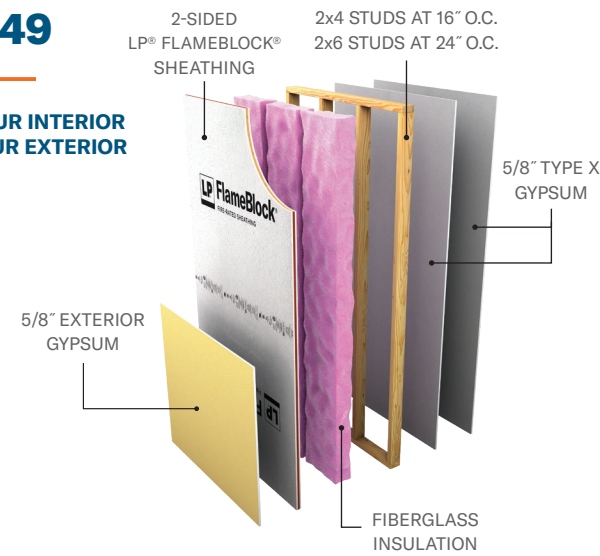

W408

2-HOUR INTERIOR
1-HOUR EXTERIOR

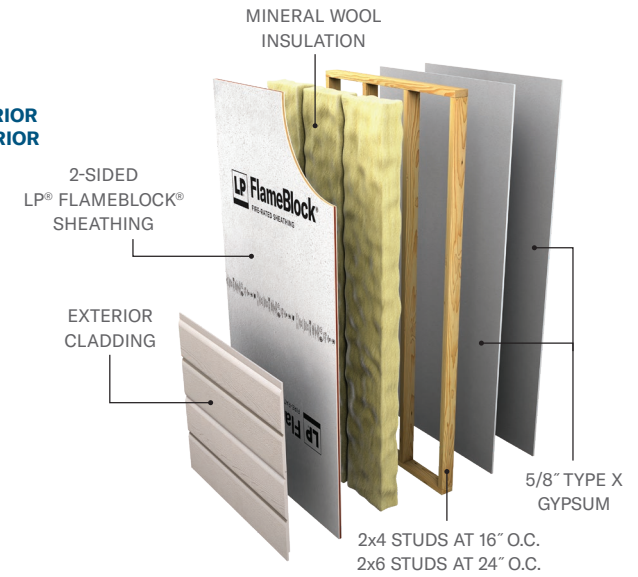

2-HOUR INTERIOR ONLY

U349

2-HOUR INTERIOR
RESISTANCE ONLY

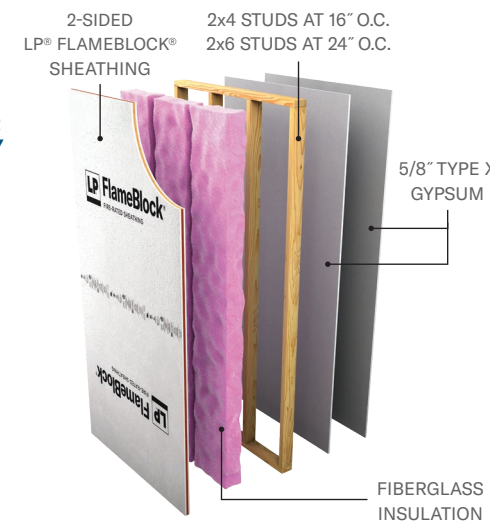

LP WEATHERLOGIC® AIR & WATER BARRIER

1-HOUR FIRE-RESISTANCE-RATED WALL ASSEMBLIES

SINGLE FAMILY & TYPE V ASSEMBLY 1-HOUR EITHER SIDE

LPC/WPPS 60-01

1-HOUR EITHER SIDE
LOAD RESTRICTED TO
41% STUD CAPACITY

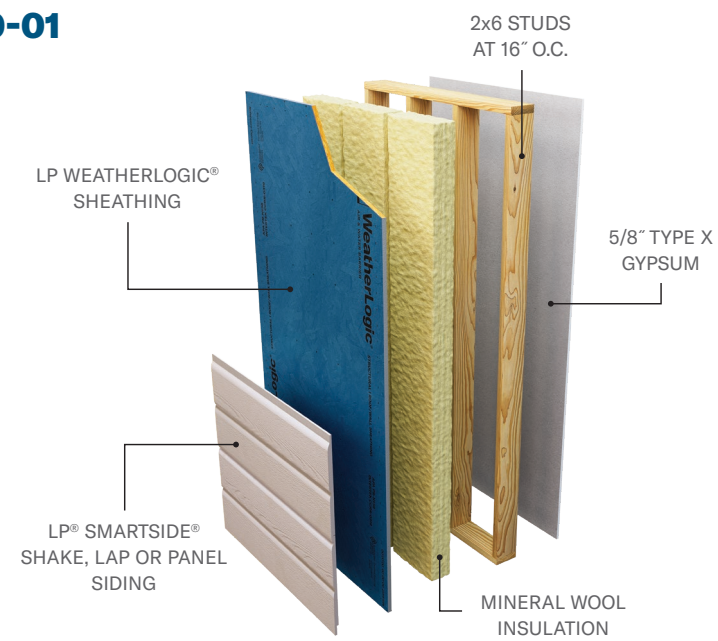

SINGLE FAMILY & TYPE V ASSEMBLY 1-HOUR EITHER SIDE

U356

1-HOUR INTERIOR
RESISTANCE ONLY

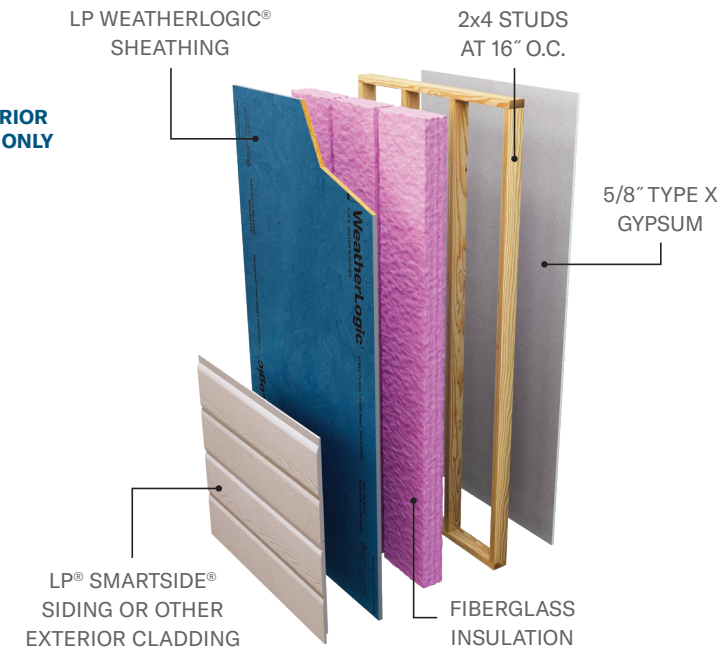

LPC/WPPS 60-02

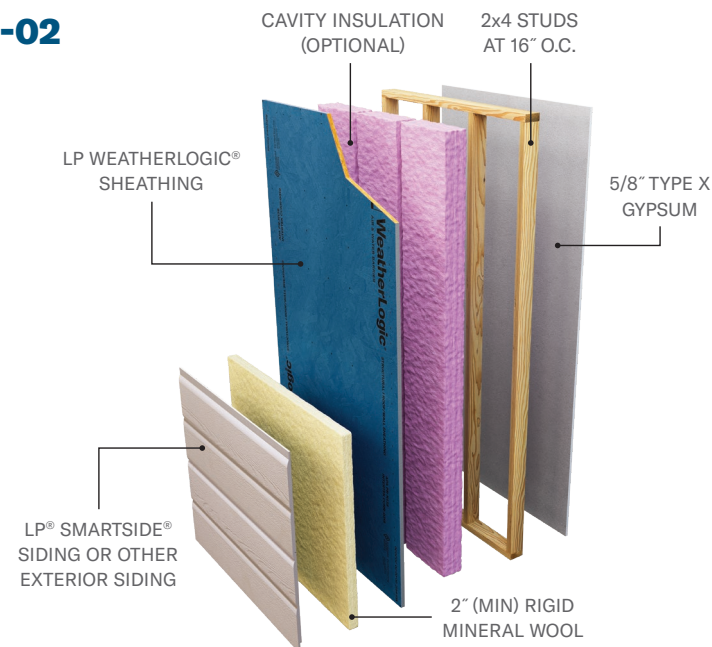

ASSEMBLIES

WOOD STUDS

- Reference the UL listings for alternate configurations and additional information.
- The use of 2-sided LP® FlameBlock® sheathing or fire-retardant-treated wood framing may be required by the building Construction Type. Reference section 4.2 in ICC-ES ESR 1365 for additional information not shown.

45-MINUTE EITHER SIDE

V338

45-MINUTE EITHER SIDE
LOAD RESTRICTED TO
51.2% STUD CAPACITY

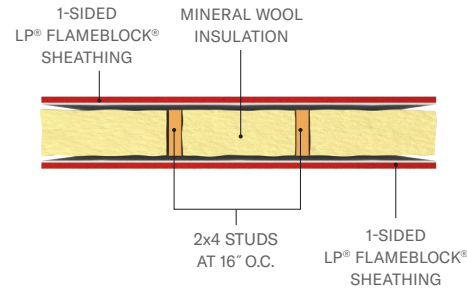

V339

45-MINUTE EITHER SIDE
LOAD RESTRICTED TO
60.6% STUD CAPACITY

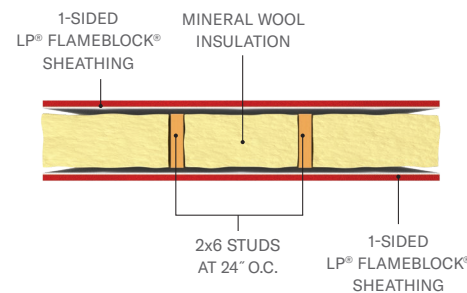

1-HOUR INTERIOR ONLY

U348

1-HOUR INTERIOR
RESISTANCE ONLY

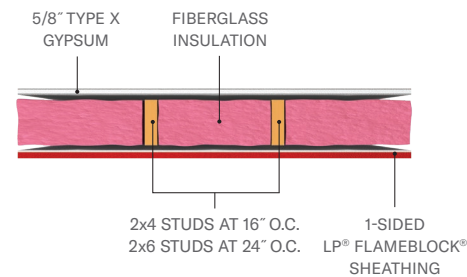

U356

1-HOUR INTERIOR
RESISTANCE ONLY

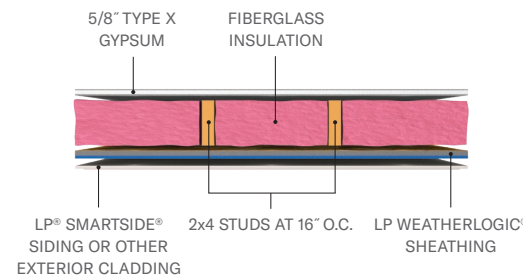

1-HOUR EITHER SIDE

V340 REPLACES PREVIOUS INTERTEK ASSEMBLY DESIGN NUMBER LPB/WPPS 60-01

V340

1-HOUR EITHER SIDE
LOAD RESTRICTED TO
40% STUD CAPACITY

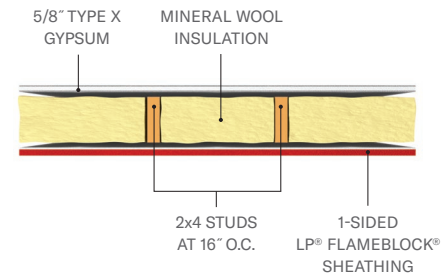

U348

1-HOUR EITHER SIDE

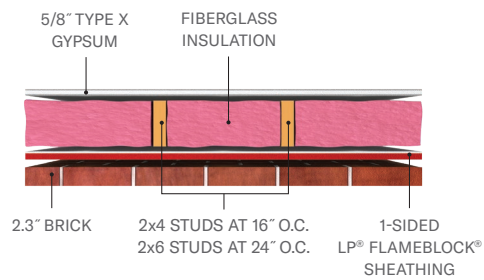

U348

1-HOUR EITHER SIDE

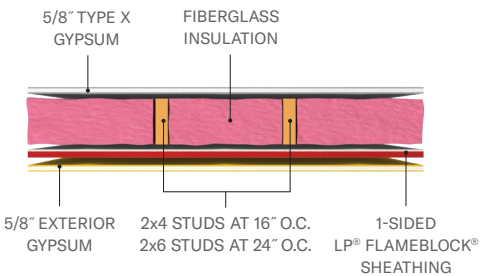

U348

1-HOUR EITHER SIDE

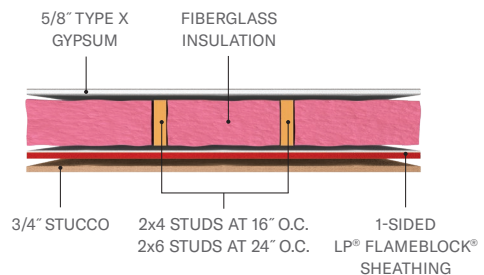

V337

1-HOUR EITHER SIDE
LOAD RESTRICTED TO
73% STUD CAPACITY

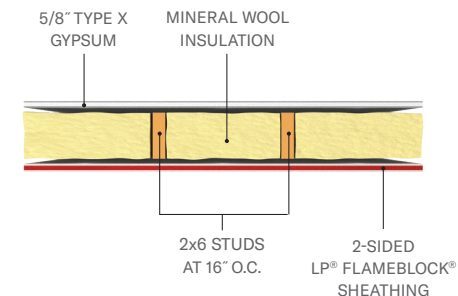

1-HOUR EITHER SIDE

LPC/ WPPS 60-01

1-HOUR EITHER SIDE
LOAD RESTRICTED TO
41% STUD CAPACITY

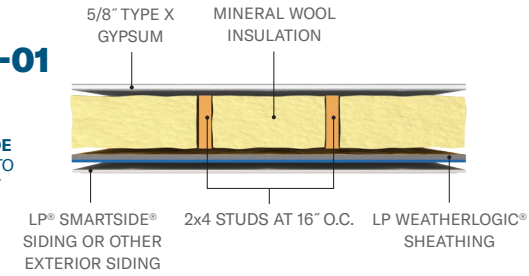

LPC/ WPPS 60-02

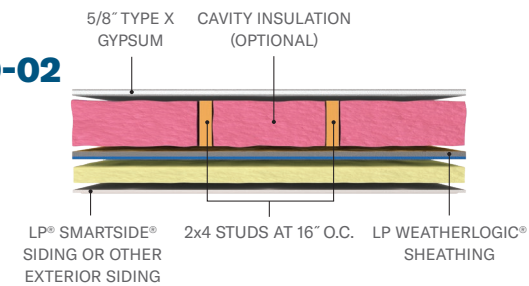

2-HOUR EITHER SIDE

U349

2-HOUR EITHER SIDE

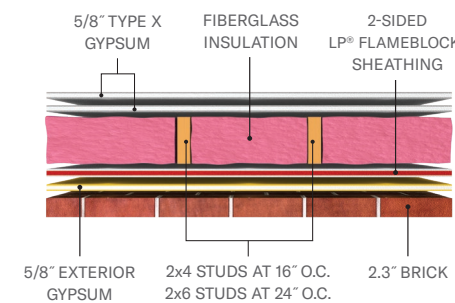

V337

2-HOUR EITHER SIDE
LOAD RESTRICTED TO
73% STUD CAPACITY

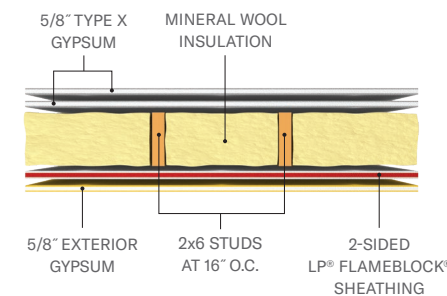

2-HOUR EITHER SIDE

V337

2-HOUR EITHER SIDE
LOAD RESTRICTED TO
73% STUD CAPACITY

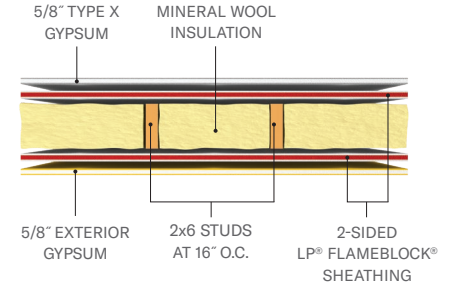

V337

2-HOUR EITHER SIDE
LOAD RESTRICTED TO
73% STUD CAPACITY

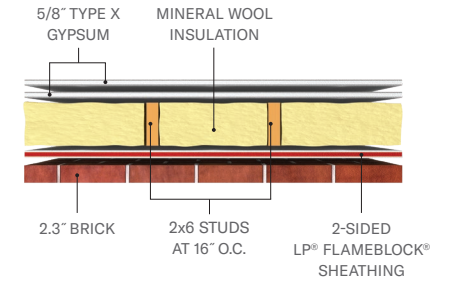

V337

2-HOUR EITHER SIDE
LOAD RESTRICTED TO
73% STUD CAPACITY

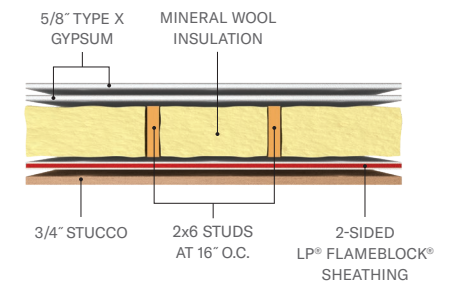

U349

2-HOUR EITHER SIDE

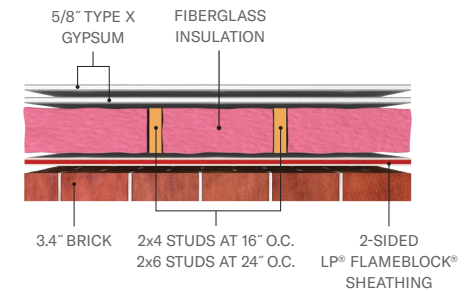

ASSEMBLIES

WOOD STUDS

- Reference the UL listings for alternate configurations and additional information.
- The use of 2-sided LP® FlameBlock® sheathing or fire-retardant-treated wood framing may be required by the building Construction Type. Reference section 4.2 in ICC-ES ESR 1365 for additional information not shown.

2-HOUR EITHER SIDE

U349

2-HOUR EITHER SIDE

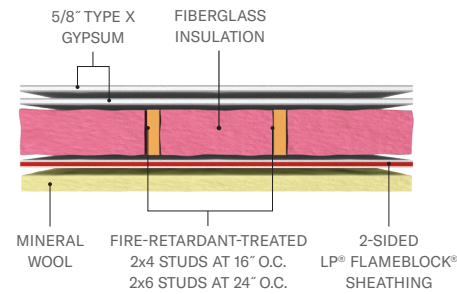

V340

2-HOUR EITHER SIDE
LOAD RESTRICTED TO
40% STUD CAPACITY

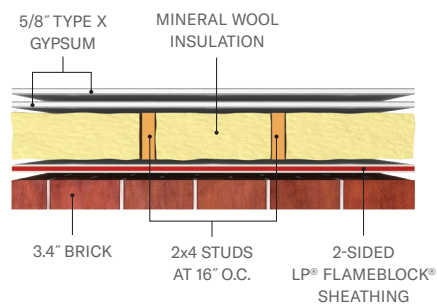

U350 A

2-HOUR EITHER SIDE
Staggered studs for STC=61,
not required for fire resistance

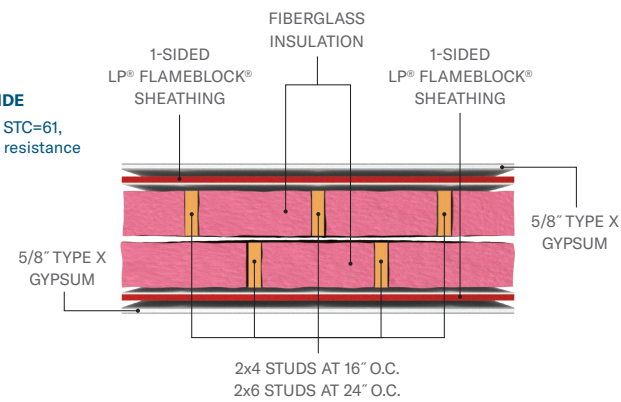

U350 B

2-HOUR EITHER SIDE
*Staggered studs and resilient
channel required for STC=61,
not required for fire resistance

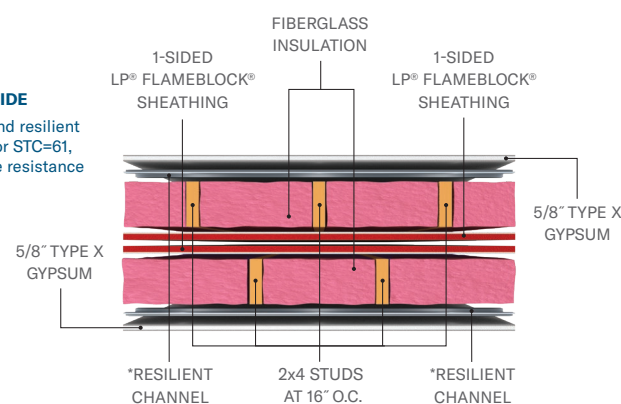

2-HOUR INTERIOR, 1-HOUR EXTERIOR

V337

2-HOUR INTERIOR
1-HOUR EXTERIOR
LOAD RESTRICTED TO
73% STUD CAPACITY

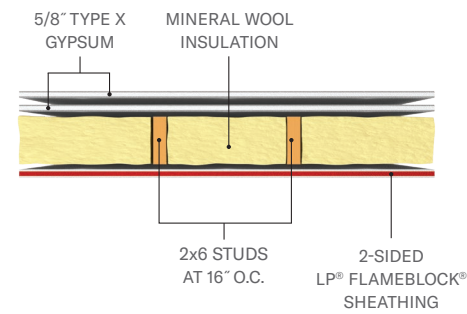

V340

2-HOUR INTERIOR
1-HOUR EXTERIOR
LOAD RESTRICTED TO
40% STUD CAPACITY

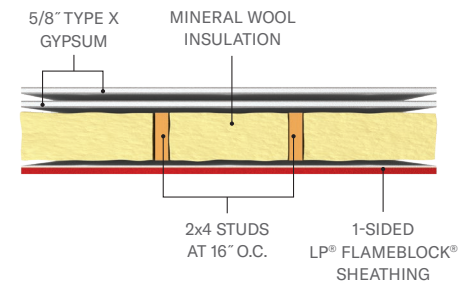

U349

2-HOUR INTERIOR
1-HOUR EXTERIOR

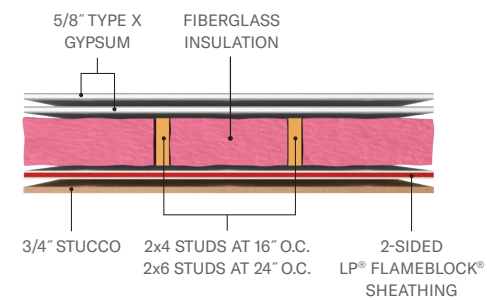

U349

2-HOUR INTERIOR
1-HOUR EXTERIOR

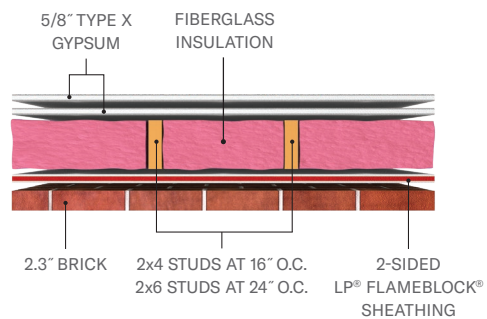

U349

2-HOUR INTERIOR
1-HOUR EXTERIOR

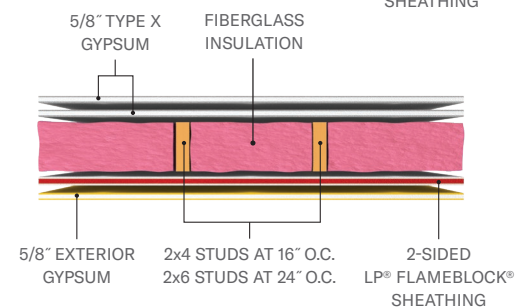

2-HOUR INTERIOR, 1-HOUR EXTERIOR

W408

2-HOUR INTERIOR
1-HOUR EXTERIOR

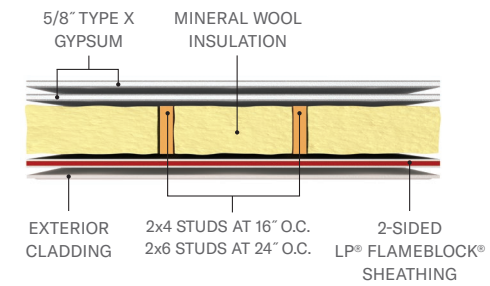

2-HOUR INTERIOR ONLY

U349

2-HOUR INTERIOR
RESISTANCE ONLY

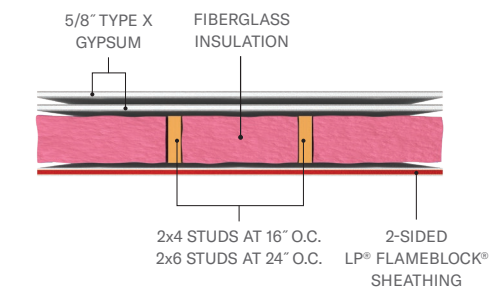

TWO 1-HOUR WALLS

V340

TWO 1-HOUR WALLS
LOAD RESTRICTED TO
40% STUD CAPACITY

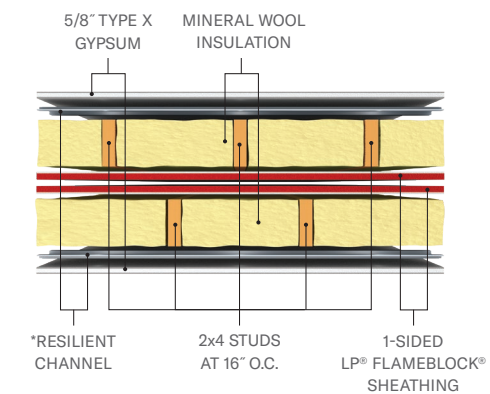

ASSEMBLIES

STEEL STUDS

- Reference the UL listings for alternate configurations and additional information.
- The use of 2-sided LP® FlameBlock® sheathing may be required by the building Construction Type. Reference section 4.2 in ICC-ES ESR 1365 for additional information not shown.

1-HOUR EITHER SIDE

U348

1-HOUR EITHER SIDE

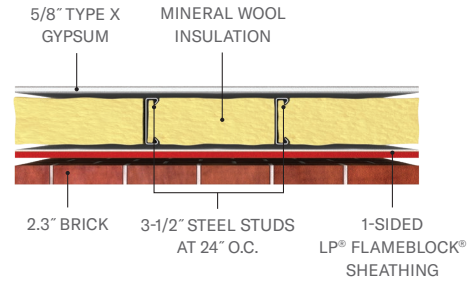

U348

1-HOUR EITHER SIDE

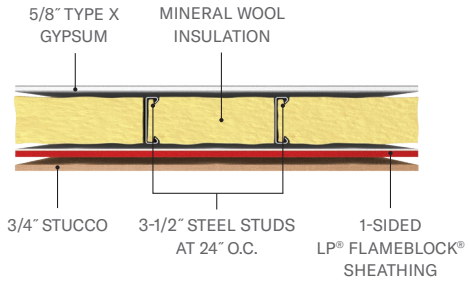

U348

1-HOUR EITHER SIDE

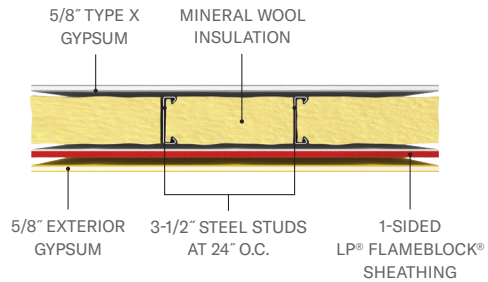

V337

1-HOUR EITHER SIDE
LOAD RESTRICTED TO
73% STUD CAPACITY

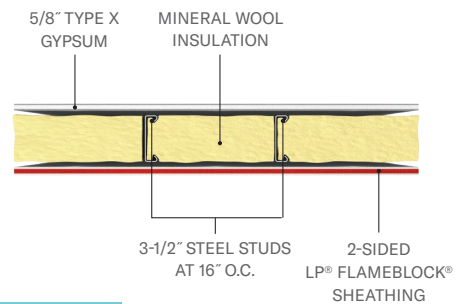

1-HOUR INTERIOR ONLY

U348

1-HOUR INTERIOR
RESISTANCE ONLY

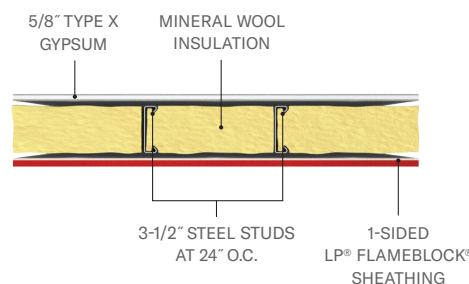

2-HOUR EITHER SIDE

V337

2-HOUR EITHER SIDE
LOAD RESTRICTED TO
73% STUD CAPACITY

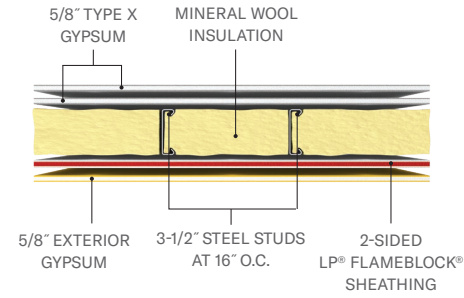

V337

2-HOUR EITHER SIDE
LOAD RESTRICTED TO
73% STUD CAPACITY

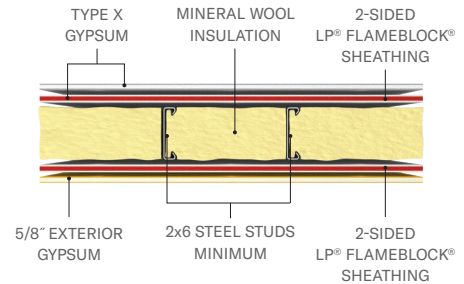

V337

2-HOUR EITHER SIDE
LOAD RESTRICTED TO
73% STUD CAPACITY

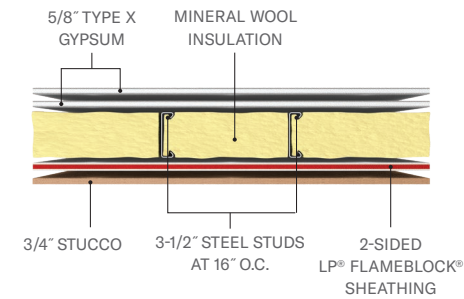

V337

2-HOUR EITHER SIDE
LOAD RESTRICTED TO
73% STUD CAPACITY

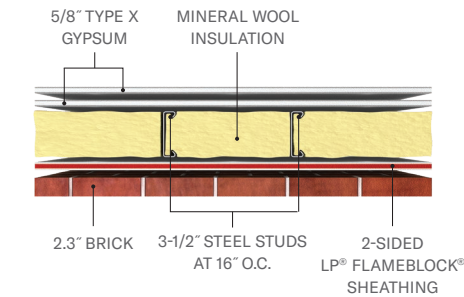

2-HOUR EITHER SIDE

U349

2-HOUR EITHER SIDE

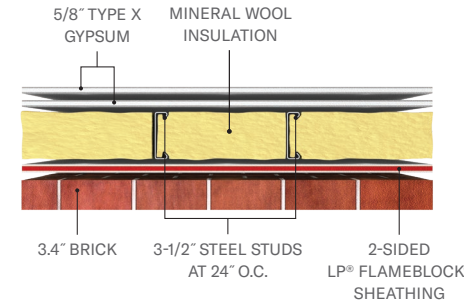

U349

2-HOUR EITHER SIDE

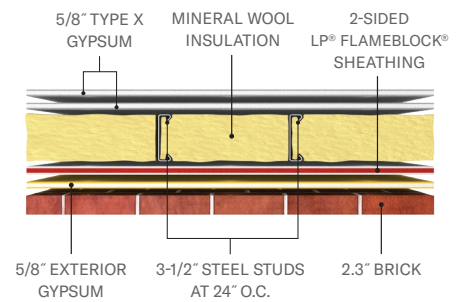

2-HOUR INTERIOR ONLY

U349

2-HOUR INTERIOR
RESISTANCE ONLY

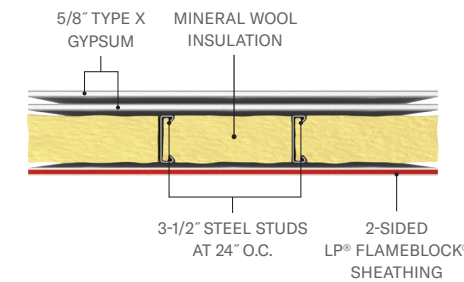

2-HOUR INTERIOR, 1-HOUR EXTERIOR

U349

2-HOUR INTERIOR
1-HOUR EXTERIOR

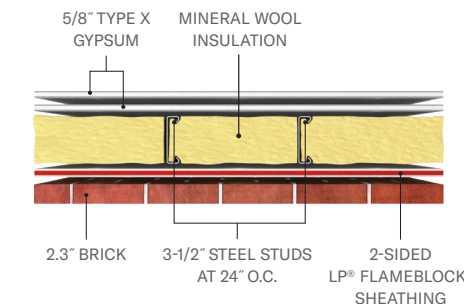

2-HOUR INTERIOR, 1-HOUR EXTERIOR

U349

2-HOUR INTERIOR
1-HOUR EXTERIOR

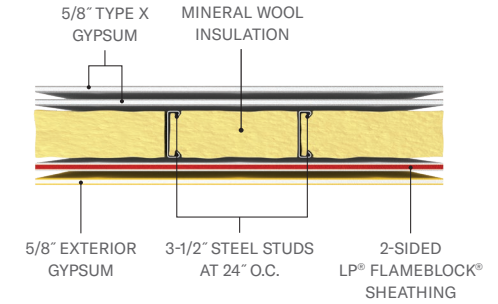

U349

2-HOUR INTERIOR
1-HOUR EXTERIOR

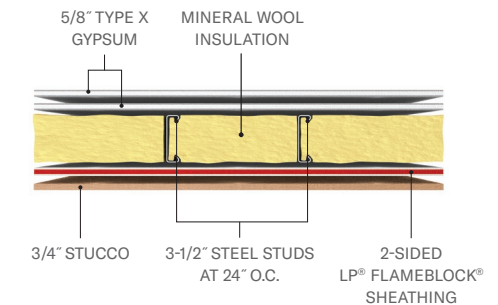

V337

2-HOUR INTERIOR
1-HOUR EXTERIOR
LOAD RESTRICTED TO
73% STUD CAPACITY

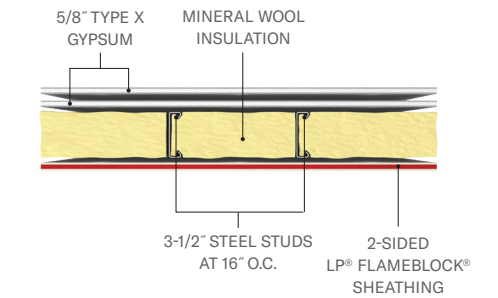

W408

2-HOUR INTERIOR
1-HOUR EXTERIOR

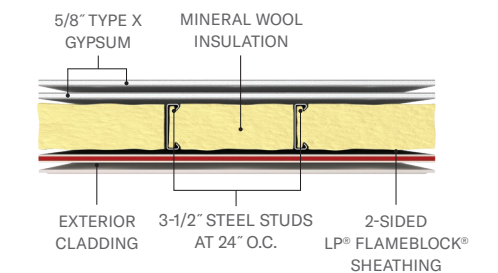



Find all LP® FlameBlock® product literature at

[LPCORP.COM/FLAMEBLOCK](https://www.lpcorp.com/flameblock)

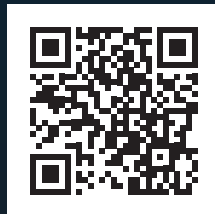

▲ WARNING: Drilling, sawing, sanding or machining wood products can expose you to wood dust, a substance known to the State of California to cause cancer. Avoid inhaling wood dust or use a dust mask or other safeguards for personal protection. For more information, go to www.P65Warnings.ca.gov/wood.

© 2025 Louisiana-Pacific Corporation. All rights reserved. APA is a registered trademark of APA – The Engineered Wood Association. Intertek is a registered trademark of Intertek Group, PLC. UL is a registered trademark of UL LLC. ICC-ES is a registered trademark of ICC Evaluation Service, LLC. All other trademarks are owned by Louisiana-Pacific Corporation. LPFB0176 7/25