

MEETING CODE IS ONLY THE BEGINNING.



LP FlameBlock®
FIRE-RATED SHEATHING

ONE PANEL. MULTIPLE APPLICATIONS.

STRUCTURAL STRENGTH AND CODE COMPLIANCE IN A SINGLE PANEL

LP® FlameBlock® Fire-Rated OSB Sheathing is evaluated to meet code requirements for fire-resistant construction and does not require reductions in strength. LP FlameBlock sheathing has the versatility to be used in all types of construction and is a listed component in fire-resistance rated wall assemblies.

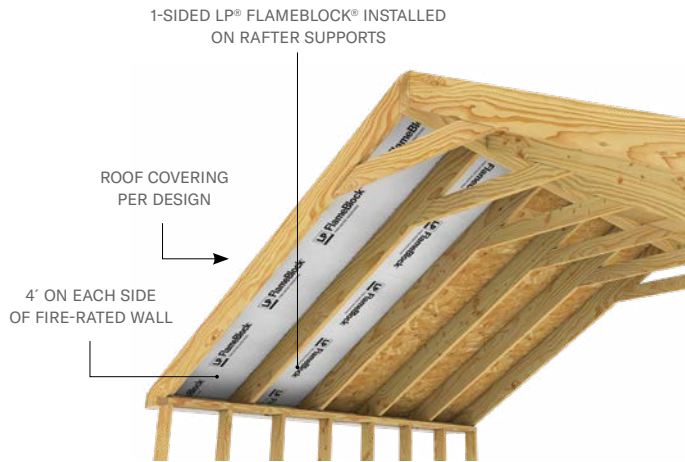

ROOF DECK APPLICATIONS

- Roof Sheathing for 4 feet on both sides of a fire wall (ESR-1365 Section 4.2a)
- 2015 IRC Section 302.2(2) Exception, 2018 IRC Section 302.2.4(2) Exception
- 2015 and 2018 IBC Section 706.6, Exception 4.3
- For construction Type III, IV, V and townhomes—1-Sided LP FlameBlock Panel with coated side facing the interior
- Available in range of thickness categories, including 7/16" to provide consistency with 7/16" standard OSB where applicable
- Roof Sheathing in roof deck applications for construction Type I and II (ESR-1365 Section 4.2b)—2-Sided LP FlameBlock panels required

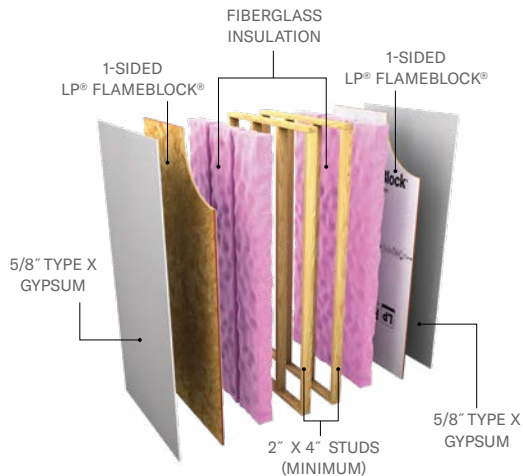

INTERIOR LOAD-BEARING WALL – UL DESIGN NO. U350 (TYPE A)

(2-Hour Partition Wall; fire-rated both sides)

- Commonly used in townhouse separation walls
- Sound Transmission Class (STC) rating of 61 with opposing wall studs staggered

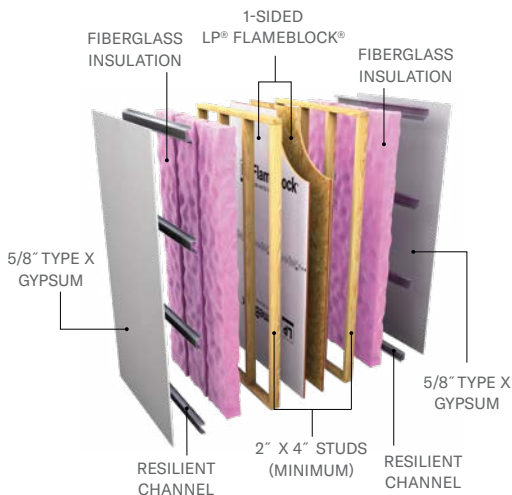

INTERIOR LOAD-BEARING WALL – UL DESIGN NO. U350 (TYPE B)

(2-Hour Partition Wall; fire-rated both sides)

- Commonly used in townhouse separation walls
- Sound Transmission Class (STC) rating of 61 with opposing wall studs staggered and resilient channel

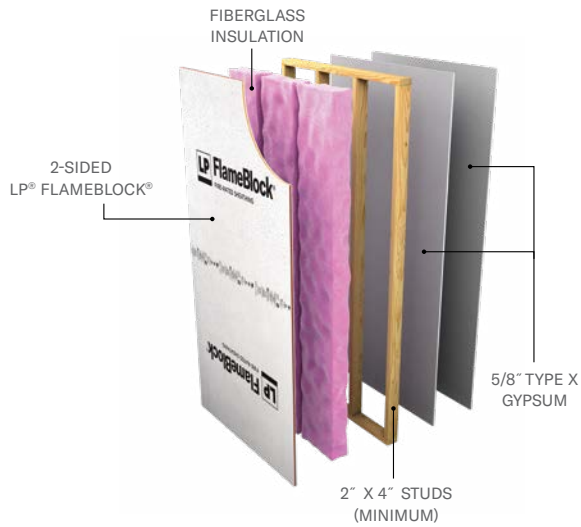

EXTERIOR LOAD-BEARING WALL – UL DESIGN NO. U349

(2-Hour Wall; fire-rated from inside)

- Commonly used in Type III load-bearing exterior walls

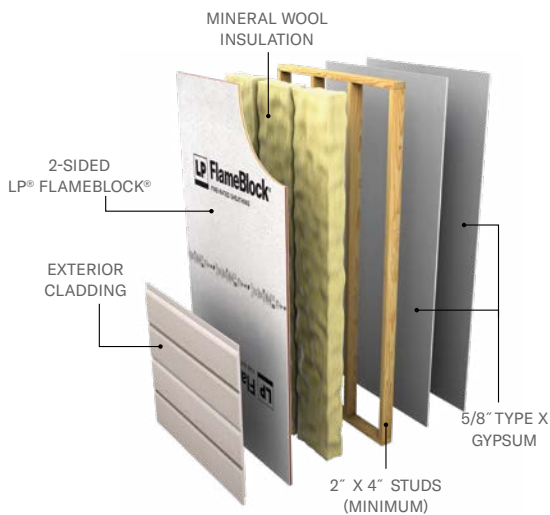

EXTERIOR LOAD-BEARING WALL – UL DESIGN NO. W408

(2-Hour Wall; fire-rated 2 hours inside, 1 hour outside)

- Commonly used in Type III and V load-bearing exterior walls
- LP FlameBlock panels provide structural performance and fire resistance in a single panel and may eliminate the need for exterior gypsum

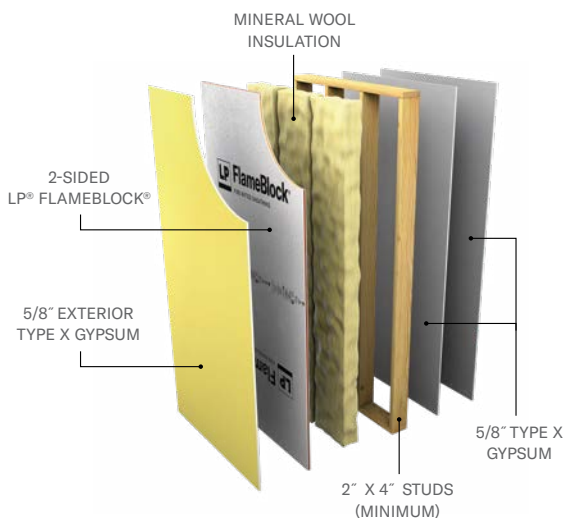

EXTERIOR LOAD-BEARING WALL – UL DESIGN NO. V337

(2-Hour Wall; fire-rated both sides)

- Commonly used in Type III and V load-bearing exterior walls
- LP FlameBlock panels provide structural performance and fire resistance in a single panel and only requires one layer of exterior gypsum

**EXTERIOR LOAD-BEARING WALL –
INTERTEK LISTING LPB/WPPS-60-01**

(1-Hour Wall; fire-rated both sides)

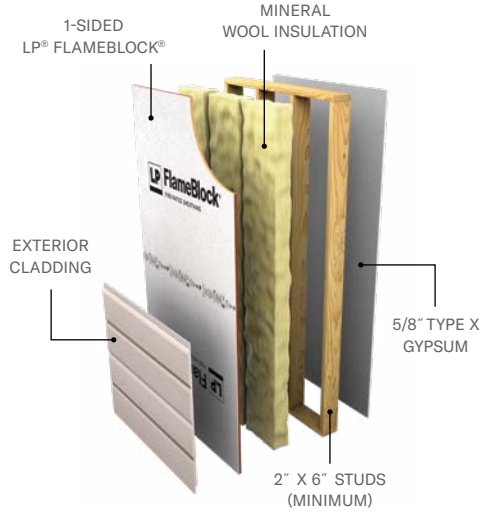

**EXTERIOR LOAD-BEARING WALL –
UL DESIGN NO. V340**

(1-Hour Wall; fire-rated both sides)

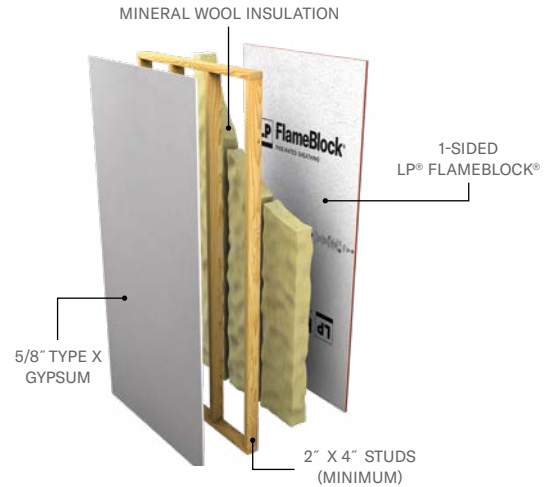

- Commonly used in 1-hour wall applications
- Single-family exterior walls along property line
- V340 allows for 2x4 wall construction
- Type V exterior walls with FSD less than 10 feet
- Type I, II, and III non-bearing exterior walls with FSD less than 10 feet—2-sided LP Flameblock panels required per ESR-1365, Section 4.2b and 4.2c
- Double 1-hour walls for townhouse construction in accordance with 2018 IRC Section R302.2.1
- Used for back-to-back Type V fire walls to achieve 2-hour fire resistance in accordance with NFPA 221, Table 4.6
- LP FlameBlock panels provide structural performance and fire resistance in a single panel and may eliminate the need for exterior gypsum
- Solid substrate for securely fastening exterior claddings

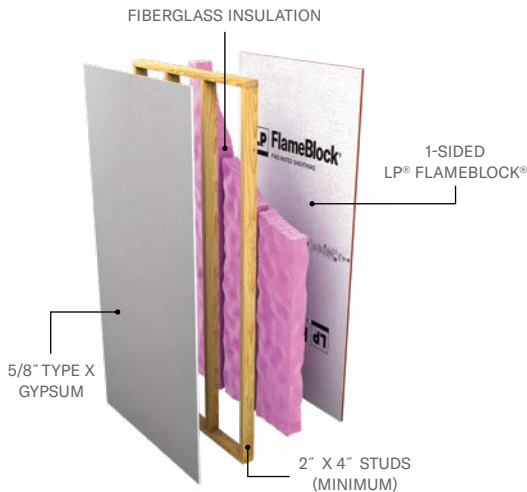

**EXTERIOR LOAD-BEARING WALL –
UL DESIGN NO. U348**

(1-Hour Wall; fire-rated from inside)

- Commonly used in 1-hour wall applications
- Type I, II, and III non-bearing exterior walls with FSD over 10 feet, 2-sided LP FlameBlock panels required per ESR-1365, Sections 4.2b and 4.2c
- Type V exterior walls with FSD over 10 feet



Image courtesy of KTG Group and Avalon Bay

MEET CODE. EXCEED EXPECTATIONS.®

LP® FlameBlock® Fire-Rated Sheathing is evaluated to meet code requirements for fire-resistant construction as a component of 1-hour and 2-hour wall assemblies and in roof deck applications. As with all of our products you'll be backed by LP, one of the biggest names in the industry serving customers nationwide since 1973. Choose LP FlameBlock Fire-Rated Sheathing for your next project.

COMBINATION OF FLAME SPREAD AND BURN-THROUGH RESISTANCE

- Evaluated by ICC-ES (ESR-1365, ESL-1002, PMG-1089)
- UL and Intertek fire-resistant rated wall assemblies tested in accordance with ASTM E119
- Thermal barrier in accordance with IBC Section 2603.4
- Class A interior wall and ceiling finish material tested in accordance with ASTM E84 (IBC Section 803)
- Evaluated to the performance requirements of IBC Section 2303.2 (Fire-retardant treated wood)

DESIGN STRENGTH AND FLEXIBILITY

LP FlameBlock panels carry load/span and shear design values equivalent to an untreated wood structural panel of the same thickness evaluated in accordance with US DOC PS 1 and PS 2. Using LP FlameBlock sheathing provides design flexibility by combining structural capacity and fire resistance in a single panel. It may eliminate a layer of gypsum to simplify and expedite the construction process.

EXPOSURE 1

Exposure 1 classification signifies that LP FlameBlock sheathing is intended to resist the effects of moisture on structural performance during active construction. The fire resistance of LP FlameBlock sheathing is not impacted by exposure to moisture during construction.

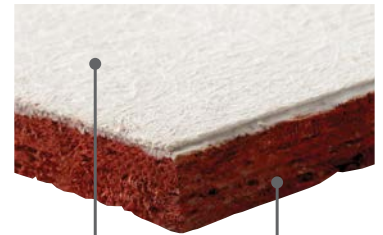

Look beneath the ignition-resistant Pyrotite® coating and you'll find the strength of LP® OSB.

LP® FlameBlock® Fire-Rated Sheathing features a proprietary non-combustible, fiberglass-reinforced Pyrotite® treatment.



MEETING CODE IS ONLY THE BEGINNING



Find all LP® FlameBlock® product literature at LPCorp.com/FlameBlock

⚠ WARNING: Drilling, sawing, sanding or machining wood products can expose you to wood dust, a substance known to the State of California to cause cancer. Avoid inhaling wood dust or use a dust mask or other safeguards for personal protection. For more information, go to www.P65Warnings.ca.gov/wood.

© 2020 Louisiana-Pacific Corporation. All rights reserved. The UL mark is a registered trademark of Underwriters Laboratories, Inc. Sustainable Forestry Initiative, SFI and associated logo are registered trademarks of Sustainable Forestry Initiative, Inc. All other trademarks are owned by Louisiana-Pacific Corporation.

LPFB0156 6/2020