



NYC Department of Buildings
280 Broadway, New York, NY 10007

Patricia J. Lancaster, FAIA, Commissioner

Siun Derkhidam
Examiner, MEA Division
212.566.3271
212.566.3840 fax
siund@buildings.nyc.gov

Mr. Fred Serpico

Marinaware

400 Metuchen Rd

South Plainfield NJ 07080

Date: July 120/2005

Dear Applicant:

Enclosed is a final official signed copy of MEA acceptance of your product(s), MEA 148-05-M & 161-05-M which you may use as proof of your product(s) acceptance in New York City.

This document together with proper labeling and installation in accordance with New York City Building Code will enable the inspector to know that the product(s) installed is (are) legal.

All shipments and deliveries of accepted materials to the job site are required to be labeled or tagged in accordance with the format below:

Accepted For Use
City of New York
Department of Buildings
MEA - -

Company Name

Very truly yours,

Siun Derkhidam

Siun Derkhidam

Assistant Mechanical Engineer

Materials and Equipment Acceptance Division

**CITY OF NEW YORK
DEPARTMENT OF BUILDINGS**

Pursuant to Administrative Code Section 27-131, the following equipment or material has been found acceptable for use in accordance with the Report of the Material and Equipment Acceptance (MEA) Division.

Patricia J. Lancaster, F.A.I.A., Commissioner

**MEA 161-05-M
Report of Material and Equipment Acceptance Division**

Manufacturer- Marinoware, 400 Metochen Road South Plainfield, New Jersey 07080.

Trade Name- Marinoware.

Product- Fire rated wall assembly for group II construction.

Pertinent Code Section(s)- 27-323 and 27-324.

Prescribed Test(s)- RS 5-2 (ASTM E119)

Laboratory- Intertek Testing Services.

Test Report- Report No. 3072596 dated May 20, 2005.

Description- Fire rated wall assembly using H stud, C runner and aluminum breakaway clip is for constructing common walls with fire resistive protection of adjacent property. The assemblies should be constructed with manufacturer instruction and following Intertek Designed No. MW/WA 120-03.

DESIGN NO. MW/WA 120-03
ASSEMBLY RATING - 2 HOURS, SYMMETRICAL AREA
SEPARATION WALL

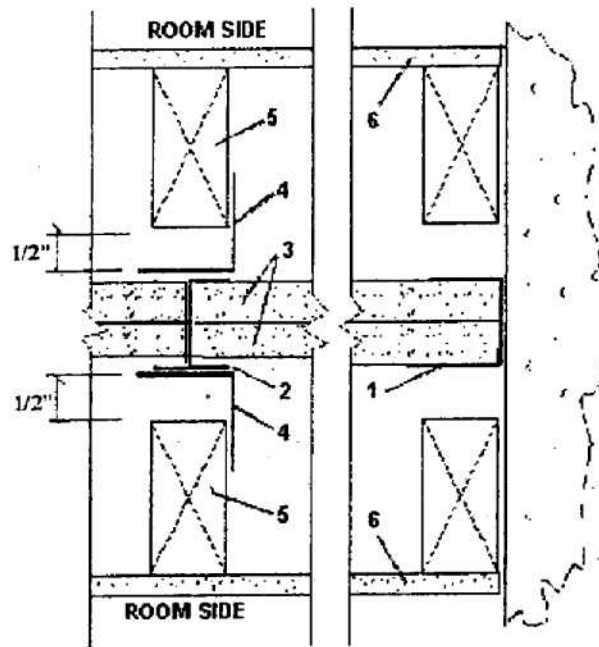

1.	Floor, Upper, Corner and Intersection Runners*: MarinoWARE 'U' shaped runner, 2-1/8 in. wide, minimum 25 gauge galvanized steel. Runners attached to floor, ceiling, or structural members with steel fasteners located at 24 in. on center maximum.
2.	Steel Studs*: MarinoWARE 2 in. wide, minimum 25 gauge galvanized steel 'H' shaped studs. Studs are cut to length 1/2 in. less than the wall height and friction fit to gypsum liner boards.
3.	Gypsum Liner Boards: 1 in. thick Listed Type X Gypsum liner boards, supplied in nominal 24 in. width. Two boards back-to-back are inserted against the web of the track and into the recess of the studs.
4.	Aluminum Clips: 2 in. long x .050 in. thick aluminium angle attached to wood framing with 1-1/4 in. Type W drywall screws and to alternate steel stud flanges staggered between exposed sides using framing screws.
5.	Wood Framing: Nominal 2 in. x 4 in. wood framing, spaced 24 in. on center maximum and spaced 1/2 in. from shaft wall surface.
6.	Gypsum Wallboard: 1/2 in. thick gypsum wallboard applied vertically or horizontally to wood framing, and fastened with 1-1/2 in. drywall screws 12 in. on center. Joints are finished with paper tape and joint compound. Exposed screw heads are finished with joint compound.

* Components bearing the Warnock Hersey Certification Mark

Recommendation – That the above described 2 hours fire rated wall assemblies, installed and secured as described, be accepted as having the fire resistance ratings listed, when members framing into the column have at least the same fire resistance rating and provided that the boards are protected from abrasion or displacements for the full height of the column for group II buildings only. The installation of the fireproofing material shall be subject to table 3-4 and to the controlled inspection requirements of Section 27-132. All shipments and deliveries of the materials comprising this assembly shall be accompanied by a certificate or label certifying that the materials shipped or delivered are equivalent to those tested and acceptable for use, as provided for in Section 27-131 of the Building Code.

Final Acceptance July/29/2005
Examined BY S Dorfludam