

ROOFING SYSTEMS

TrussRite, MarinoWARE's high-quality, versatile truss system, opens up multiple roofing possibilities for the construction professional. Complete trusses can be delivered to a job site, or individual truss components can be manufactured according to the particular needs of the structure. Created from AmKey System truss products, TrussRite provides an exceptional strength-to-weight ratio, yet requires less bracing than conventional trusses. In addition, TrussRite offers outstanding dimensional stability and features code-approved, UL fire-rated assemblies.

VOLTEC ADVANTAGE

To implement TrussRite designs, MarinoWARE utilizes Voltec modeling software. This cutting-edge three-dimensional engineering application can be used to custom tailor TrussRite products to meet exact building specifications. Now, trade professionals can be assured that TrussRite will accommodate the most complex roofing plans – even those involving substantial duct work.

TrussRite can be used to create a stand-alone roof based upon existing structures.

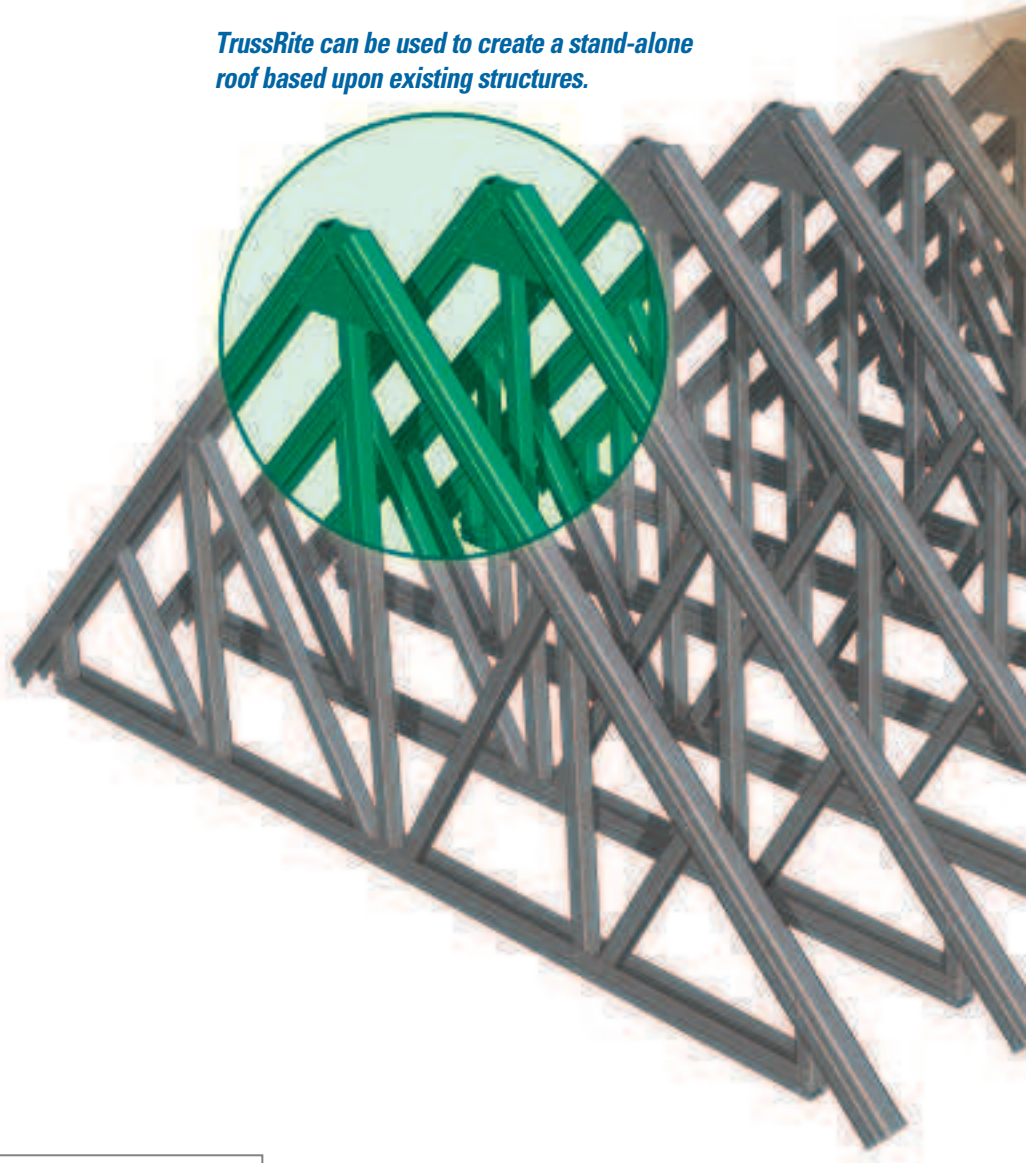

STANDARD TRUSS SHAPES AND CLEARSPANS

Common Truss	Clearspans to ~ 70 ft +	Flattop Truss	Clearspans to ~ 65 ft +	Mono Truss	Clearspans to ~ 70 ft +	Flat Truss	Clearspans to ~ 50 ft +

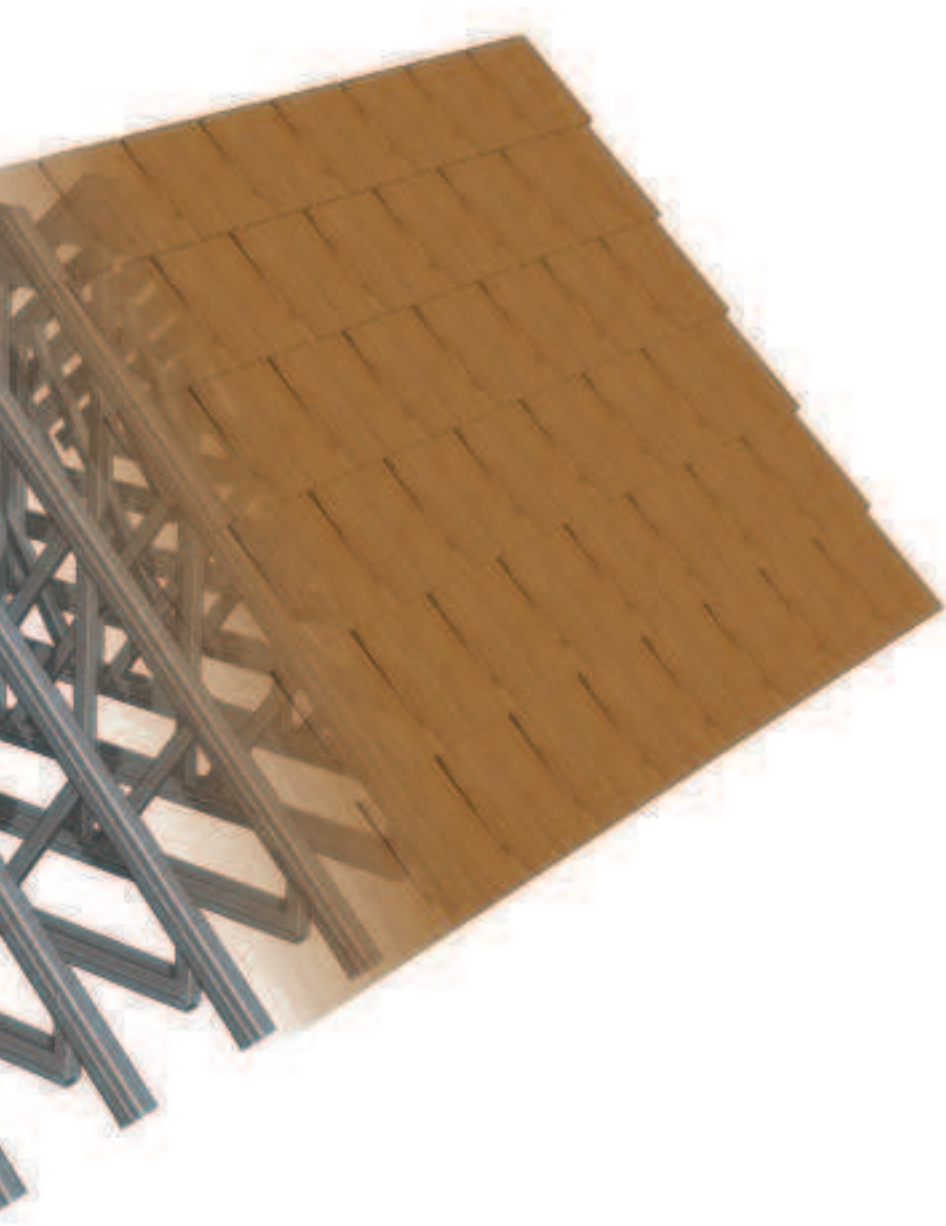

TYPICAL DETAILS

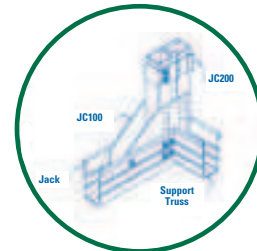

**Hook & Hang
Jack to girder**

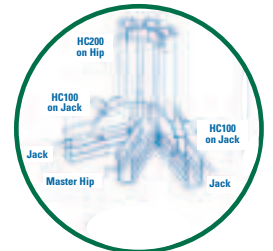

**Hook & Hang
Hip and angled jack**

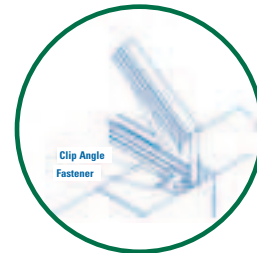

**Uplift connection on
CMU wall**

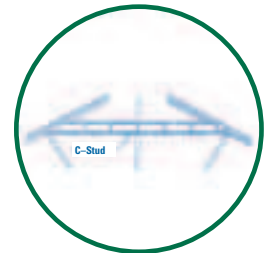

Piggyback connection

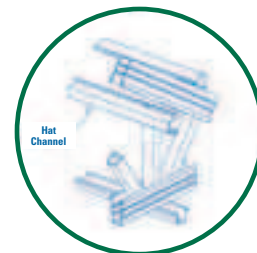

**Purlin and bracing
to truss**

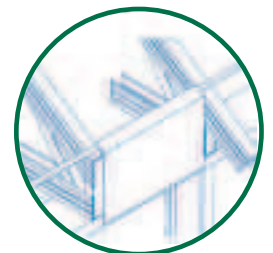

Shear transfer end panel

Sloping Truss	Clearspans to ~ 50 ft +	Scissor Truss	Clearspans to ~ 60 ft +	Studio Truss	Clearspans to ~ 60 ft +	Cathedral Truss	Clearspans to ~ 60 ft +
