

ABS DWV FITTINGS FOR PLUMBING AND MECHANICAL APPLICATIONS

Job Name	Contractor
Job Location	Wholesaler
Engineer	Streamline[®] Rep

Product Description:

Streamline[®] ABS DWV fittings for use in applications including sanitary drain, waste, and vent (DWV), sewer, and general drainage applications. Available in sizes ranging from 1-1/4" to 6" in diameter; all fittings should be manufactured in the United States.

Material:

Acrylonitrile-butadiene-styrene (ABS) DWV fittings shall conform to cell class 3-2-2-2 as defined in ASTM 3965.

Key Specifications:

Streamline[®] ABS DWV fittings shall conform to ASTM D2661 and F1498. Third-party certifications shall be in place for fittings in compliance with NSF Standard 14. Fittings shall be certified to the Uniform Plumbing Code (UPC) where applicable.

Installation:

Installation shall comply with the latest applicable building codes for the local jurisdiction. Solvent cement connections shall be made using a two-step process consisting of primer (in conformance with ASTM F656) and solvent cement (in conformance with ASTM D2564). For detailed installation instructions, consult the Plumbing Apprentice Training Manual available from PPFA (Plastic Pipe & Fitting Association) at ppfahome.org.

ABS DWV fittings are not designed for hot water systems and discharge temperatures should not exceed 140°F. Systems shall be installed to avoid contact with thread sealants or other chemical agents which are not compatible with ABS. Hydrostatic testing of the system shall be completed prior to use.

Do not test or use Streamline[®] plastic products with compressed air or compressed gases.

References:

ASTM 3965	Classification for Rigid Acrylonitrile-Butadiene-Styrene (ABS) Tube and Fittings
ASTM D2661	Standard Specification for ABS Drain, Waste, and Vent Fittings
ASME F1498	Taper Pipe Threads for Thermoplastic Fittings/Fitting Threads
ASTM F656	Standard Specification for Primers
ASTM D2564	Standard Specification for Solvent Cement

Other Applicable Standards:

NSF Standard 14	Plastic Piping System and Related Components
NSF International	IAPMO
UPC	



ABS DWV FITTINGS FOR PLUMBING AND MECHANICAL APPLICATIONS

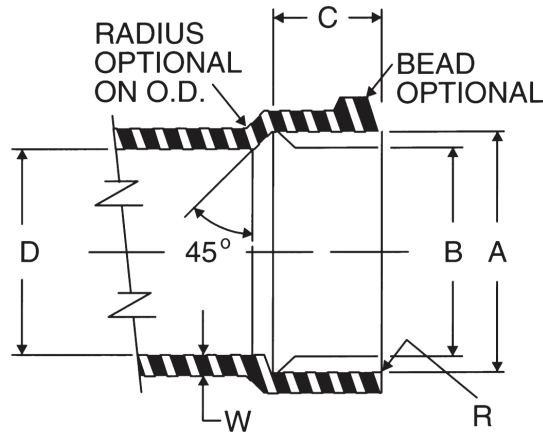

SOCKET DIMENSIONS AND TOLERANCES ABS-DWV

Trade Sizes	A		B		C	D	W	R
	Socket Entrance Diameter		Socket Bottom Diameter					
	Total Average Tol. A	Out of Round	Total Average Tol. A	Out of Round	Min Spigot & Socket Depth	Min Internal Thread Depth	Wall Thickness Min.	Radius or 45° Chamfer
1-1/4"	1.67	±.024	1.655	±.024	0.687	0.687	0.156	1/16
1-1/2"	1.91	±.024	1.895	±.024	0.687	0.687	0.156	1/16
2"	2.385	±.024	2.37	±.024	0.75	0.75	0.156	1/32
3"	3.515	±.030	3.495	±.030	1.5	1.187	0.218	1/8
4"	4.515	±.030	4.495	±.030	1.75	1.281	0.25	1/8
6"	6.647	±.060	6.614	±.060	3	1.5	0.281	1/8

SIZING NOMENCLATURE FOR DWV FITTINGS

Multi-Joint Fittings

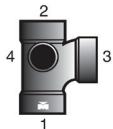

- 1 = Bottom Outlet
- 2 = Top Inlet
- 3 = Main Branch
- 4 = Branch, Side Inlet

Two Joint Fittings



- 1 = Left Side of Fitting
- 2 = Right Side of Fitting

CONNECTION DESCRIPTIONS

H	Hub
Sp	Spigot (Pipe O.D.)
SJ	Slip Joint
MPT	Male Pipe Thread
FPT	Female Pipe Thread
S/D	Sewer & Drain
NPSM	National Pipe Straight Mechanical Thread
CI	Cast Iron

All 90° Openings Pitch 1/4" Per Foot
(Exception - Vent Fittings)

PLASTIC FITTINGS - PLUMBING

ABS DWV

STYLE NO. A100 COUPLING



H x H			
Size	Part #	Ctn	Plt
1 1/4	02932	50	4,500
1 1/2	02933	100	7,200
2	02934	100	4,800
3	02935	60	1,440
4	02936	25	700
6	03143	15	180

STYLE NO. A101 FEMALE ADAPTER



H x FPT			
Size	Part #	Ctn	Plt
1 1/4	03006	50	7,200
1 1/2	02866	100	7,200
2	02867	100	4,800
3	02869	30	1,260
4	03396	10	720
6	03147	10	240

STYLE NO. A102 PIPE INCREASER / REDUCER



H x H			
Size	Part #	Ctn	Plt
2 x 1 1/2	02948	25	3,600
3 x 1 1/2	02949	50	1,350
3 x 2	02950	20	1,440
4 x 2	02951	10	720
4 x 3	02952	20	840

STYLE NO. A103P TRAP ADAPTER, MALE, W / 1 PIECE POLY NUT



SP x SJ			
Size	Part #	Ctn	Plt
1 1/4	03391	50	7,200
1 1/2	03393	50	5,400
1 1/2 x 1 1/4	03379	75	5,400

STYLE NO. A103R TRAP ADAPTER, MALE, W / PLASTIC NUT & 1 1/2 x 1 1/4 WASHER



SP x SJ			
Size	Part #	Ctn	Plt
1 1/2 x 1 1/4	03389	50	5,400
1 1/2	03389	50	5,400

STYLE NO. A103W TRAP ADAPTER, MALE, W / PLASTIC NUT & WASHER



SP x SJ			
Size	Part #	Ctn	Plt
1 1/4	03308	50	7,200
1 1/2	03410	50	5,400
2	03390	25	2,250
1 1/2 x 1 1/4	03409	50	5,400

STYLE NO. A103X TRAP ADAPTER, MALE, W / CHROME NUT & WASHER



SP x SJ			
Size	Part #	Ctn	Plt
1 1/4	03309	50	7,200
1 1/2	03392	50	5,400
1 1/2 x 1 1/4	03378	100	7,200

STYLE NO. A104P TRAP ADAPTER, FEMALE, W / 1 PIECE POLY NUT



H x SJ			
Size	Part #	Ctn	Plt
1 1/4	03381	50	7,200
1 1/2	03377	50	5,400
1 1/2 x 1 1/4	03395	50	5,400

STYLE NO. A104W TRAP ADAPTER, FEMALE, W / PLASTIC NUT & WASHER



H x SJ			
Size	Part #	Ctn	Plt
1 1/4	03380	50	7,200
1 1/2	03383	50	5,400
2	03382	25	3,600
1 1/2 x 1 1/4	03384	50	5,400

STYLE NO. A104X TRAP ADAPTER, FEMALE, W / CHROME NUT & WASHER



H x SJ			
Size	Part #	Ctn	Plt
1 1/2	03376	50	5,400
2	03397	25	3,600
1 1/2 x 1 1/4	03394	50	5,400

STYLE NO. A105 FITTING CLEANOUT ADAPTER



SP x FPT			
Size	Part #	Ctn	Plt
1 1/2	02922	50	7,200
2	02923	50	3,600
3	02924	25	1,350
4	02925	10	720
6	03148	10	240

STYLE NO. A105X FITTING CLEANOUT ADAPTER W / CLEANOUT PLUG



SP x FPT			
Size	Part #	Ctn	Plt
1 1/2	03001	50	5,400
2	03002	50	3,600
3	03003	25	1,200
4	03004	10	540
6	03005	10	180

STYLE NO. A106 CLEANOUT PLUG



MPT			
Size	Part #	Ctn	Plt
1 1/2	02938	50	7,200
2	02939	50	7,200
3	02941	25	3,600
3 1/2	02943	30	3,240
4	02942	30	2,160
6	03146	10	720

STYLE NO. A106P SLIP PLUG



SP			
Size	Part #	Ctn	Plt
1 1/2	03055	25	3,600
2	03056	50	7,200

STYLE NO. A107 FLUSH BUSHING



SP x H STYLE #3			
Size	Part #	Ctn	Plt
1 1/2 x 1 1/4	02904	100	14,400
2 x 1 1/4	02905	50	7,200
2 x 1 1/2	02906	50	7,200
3 x 1 1/2	02907	30	3,240
3 x 2	02908	30	3,240
4 x 2	02910	30	1,440
4 x 3	02909	30	1,620

STYLE NO. A107S FLANGE BUSHING W / TUBE STOP



SP x H STYLE #1			
Size	Part #	Ctn	Plt
6 x 4	03144	10	360

STYLE NO. A108 FLUSH BUSHING



SP x FPT STYLE #3			
Size	Part #	Ctn	Plt
1 1/2 x 1 1/4	02912	50	7,200
2 x 1 1/2	02913	50	7,200

STYLE NO. A109 MALE ADAPTER



H x MPT			
Size	Part #	Ctn	Plt
1 1/4	02931	50	4,500
1 1/2	02927	50	7,200
2	02928	50	3,600
3	02929	25	1,800
4	02930	10	720
REDUCING			
1 1/2 x 1 1/4	02926	25	3,600

STYLE NO. A111 MALE FITTING ADAPTER



SP x MPT			
Size	Part #	Ctn	Plt
1 1/4	03010	50	7,200
1 1/2	03386	50	5,400
2	03385	25	3,600
3	03366	25	1,350
REDUCING			
1 1/2 x 1 1/4	03387	100	7,200

STYLE NO. A113 TRAY PLUG ADAPTER



H x NPSM THREAD			
Size	Part #	Ctn	Plt
1 1/2	03014	50	3,600

STYLE NO. A113S TRAY PLUG ADAPTER, SPIGOT



SP x NPSM			
Size	Part #	Ctn	Plt
1 1/2	03419	50	2,700

STYLE NO. A114 THREADED CAP



FPT	Part #	Ctn	Plt
1 1/2	02993	100	9,000
2	02994	50	7,200
3	02995	25	1,800

STYLE NO. A116 SOCKET CAP



H	Part #	Ctn	Plt
1 1/2	02977	50	7,200
2	02978	25	3,600
3	02979	25	1,800
4	02980	5	720

STYLE NO. A117 ADAPTER COUPLING

S/D H x DWV H
(ADAPTS SEWER & DRAIN PIPE TO DWV PIPE)



Size	Part #	Ctn	Plt
3	02970	10	720
4	02963	10	480
4 x 3	02962	20	960

STYLE NO. A118 ADAPTER BUSHING

DWV SP x SD H (Adapts DWV Hub to S/D Spigot)



Size	Part #	Ctn	Plt
3	02990	25	2,700
4	02991	10	1,440

STYLE NO. A119 NO HUB ADAPTER

NO H x H (Adapts CI NO HUB TO DWV PIPE)



Size	Part #	Ctn	Plt
2	02954	25	3,600
3	02955	20	1,440
4	02956	15	810

STYLE NO. A123 HUB ADAPTER, CAST IRON

SP x H (ADAPTS CI HUB TO DWV PIPE)



Size	Part #	Ctn	Plt
2 x 2	02957	20	1,440
3 x 3	02958	10	480
4 x 4	02959	20	480

STYLE NO. A123R HUB ADAPTER, CAST IRON, INCREASER

SP x H (ADAPTS CI HUB TO DWV PIPE)



Size	Part #	Ctn	Plt
1 1/2 x 2	02961	10	1,440
1 1/2 x 3	02964	10	720
3 x 4	02960	10	480

STYLE NO. A130 REPAIR COUPLING



H x H	Part #	Ctn	Plt
1 1/2	02965	20	4,800
2	02966	20	3,200
3	02967	20	1,000
4	02968	5	540

STYLE NO. A131 TEST CAP - STYRENE

ALL HUB (NSF APPROVAL NOT AVAILABLE)



Size	Part #	Ctn	Plt
1 1/2	02411	100	14,400
2	02412	100	14,400
3	02413	50	7,200
4	02414	50	5,400

STYLE NO. A140 SLIP JOINT NUT



Size	Part #	Ctn	Plt
1 1/4	02743	400	21,600
1 1/2	02744	100	14,400
2	02741	100	10,800

STYLE NO. A141 SLIP JOINT WASHER

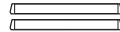

(FOR USE WITH 1 1/4 SJ NUT)

Size	Part #	Ctn	Plt
1 1/2	02747	2,000	120,000
1 1/2 x 1 1/4	02748	500	81,000

STYLE NO. P142 ONE PIECE POLY NUT



Size	Part #	Ctn	Plt
1 1/4	01036	150	21,600
1 1/2	01038	125	18,000

STYLE NO. A300 1/4 BEND



Size	Part #	Ctn	Plt
1 1/4	02875	50	3,000
1 1/2	02876	100	3,200
2	02877	50	1,800
3	02878	25	450
4	02879	10	240
6	03130	5	80

STYLE NO. A300R 1/4 BEND



Size	Part #	Ctn	Plt
2 x 1 1/2	03092	10	1,440

STYLE NO. A300S 1/4 BEND, W / SIDE INLET

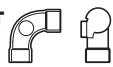

Size	Part #	Ctn	Plt
3 x 3 x 1 1/2	03069	10	360
3 x 3 x 2	03070	10	360

STYLE NO. A302 1/4 BEND, STREET



Size	Part #	Ctn	Plt
1 1/4	02894	50	3,600
1 1/2	02880	100	3,600
2	02881	50	1,800
3	02882	20	560
4	02883	10	240
6	02889	5	80

STYLE NO. A303 1/4 BEND, W / LOW HEEL INLET



Size	Part #	Ctn	Plt
3 x 3 x 1 1/2	03041	25	450
3 x 3 x 2	03042	25	450
4 x 4 x 2	03043	15	180

STYLE NO. A304 LONG SWEEP 1/4 BEND



Size	Part #	Ctn	Plt
1 1/4	02870	50	2,400
1 1/2	02871	50	1,800
2	02872	25	1,200
3	02873	10	360
4	02874	5	180

STYLE NO. A305 LONG SWEEP 1/4 BEND W / HIGH HEEL INLET



Size	Part #	Ctn	Plt
3 x 3 x 1 1/2	03028	10	360
3 x 3 x 2	03027	25	400

STYLE NO. A307 LONG SWEEP 1/4 BEND W / LOW HEEL INLET



Size	Part #	Ctn	Plt
3 x 3 x 1 1/2	03025	10	360
3 x 3 x 2	03024	25	300

STYLE NO. A309 LONG SWEEP 1/4 BEND, STREET



Size	Part #	Ctn	Plt
1 1/2	03060	50	2,400
2	03061	25	1,200
3	03063	20	360

STYLE NO. A310 1/4 BEND W / LOW HEEL INLET



Size	Part #	Ctn	Plt
3 x 3 x 2	03026	15	420

STYLE NO. A311 LONG SWEEP 1/4 BEND W / SIDE INLET

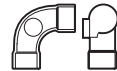

Size	Part #	Ctn	Plt
3 x 3 x 1 1/2	03051	10	360
3 x 3 x 2	03050	25	400

STYLE NO. A319 1/6 BEND



Size	Part #	Ctn	Plt
1 1/2	02895	40	2,880
2	02896	25	1,800
3	02897	20	560
4	02982	10	320

STYLE NO. A320 1/6 BEND, STREET



Size	Part #	Ctn	Plt
1 1/2	03020	40	4,320
2	03021	25	1,800
3	03022	20	720
4	03023	5	160

STYLE NO. A321 1/8 BEND

H x H				
Size	Part #	Ctn	Pit	
1 1/4	02884	50	3,600	
1 1/2	02885	100	3,600	
2	02886	50	1,800	
3	02887	20	640	
4	02888	10	280	
6	03132	3	96	



STYLE NO. A323 1/8 BEND, STREET

SP x H				
Size	Part #	Ctn	Pit	
1 1/4	03016	50	3,600	
1 1/2	02890	100	3,600	
2	02891	50	1,800	
3	02892	20	720	
4	02893	10	320	
6	03133	3	96	



STYLE NO. A324 1/16 BEND

H x H				
Size	Part #	Ctn	Pit	
1 1/2	02899	50	3,600	
2	02900	25	2,700	
3	02901	20	720	
4	02983	15	420	
6	02988	3	108	



STYLE NO. A326 1/16 BEND, STREET

SP x H				
Size	Part #	Ctn	Pit	
1 1/2	02984	50	5,400	
2	02985	25	2,700	
3	02986	20	960	
4	02987	10	360	



STYLE NO. A327 DOUBLE 1/4 BEND

H x H				
Size	Part #	Ctn	Pit	
1 1/2	03045	20	1,440	
2	03046	25	900	
3	03047	10	280	
REDUCING				
2 x 1 1/2 x 1 1/2	03049	25	900	



STYLE NO. A328 CLOSET BEND, REDUCING, SHORT RADIUS

SP x H				
Size	Part #	Ctn	Pit	
3 x 4	03105	10	360	



STYLE NO. A328X CLOSET BEND, REDUCING, SHORT RADIUS W / TEST CAP

SP x H				
Size	Part #	Ctn	Pit	
3 x 4	03104	10	360	



STYLE NO. A329 CLOSET BEND, REDUCING

H x H				
Size	Part #	Ctn	Pit	
3 x 4	03093	10	360	



STYLE NO. A330 CLOSET BEND, REDUCING

H x S				
Size	Part #	Ctn	Pit	
3 x 4	03107	10	280	



STYLE NO. A330X CLOSET BEND, REDUCING, W / TEST CAP

H x S				
Size	Part #	Ctn	Pit	
3 x 4	03108	10	280	



STYLE NO. A331 VENT ELL

H x H				
Size	Part #	Ctn	Pit	
1 1/2	03084	20	2,880	
2	03085	30	1,620	
3	03086	25	700	
4	03087	10	270	



STYLE NO. A332 VENT ELL

H x FPT				
Size	Part #	Ctn	Pit	
3	03071	20	560	



STYLE NO. A333 VENT ELL, STREET

H x SP				
Size	Part #	Ctn	Pit	
1 1/2	03088	25	3,600	
2	03089	20	1,440	
3	03090	10	540	



STYLE NO. A400 SANITARY TEE

ALL HUB				
Size	Part #	Ctn	Pit	
1 1/4	02751	50	2,000	
1 1/2	02752	100	1,800	
2	02753	35	1,120	
3	02754	30	360	
4	02755	5	140	
6	02756	5	60	



STYLE NO. A401 SANITARY TEE, REDUCING

ALL HUB				
Size	Part #	Ctn	Pit	
1 1/2 x 1 1/2 x 1 1/4	02757	20	2,160	
1 1/2 x 1 1/4 x 1 1/2	02762	20	2,160	
1 1/2 x 1 1/4 x 1 1/4	02759	20	1,440	
2 x 1 1/2 x 1 1/2	02761	25	1,350	
2 x 1 1/2 x 2	02760	25	1,200	
2 x 2 x 1 1/2	02758	50	1,200	
3 x 3 x 1 1/2	02764	20	640	
3 x 3 x 2	02763	10	480	
4 x 4 x 2	02765	10	280	
4 x 4 x 3	02766	10	180	
6 x 6 x 4	02768	6	72	



STYLE NO. A403 SANITARY TEE, STREET

SP x H x H				
Size	Part #	Ctn	Pit	
1 1/2	03112	20	2,160	
21.18	03113	25	1,200	
26.32	03114	30	360	
49.08	03120	10	180	
136.79				



STYLE NO. A404 SANITARY TEE, STREET, REDUCING

SP x H x H				
Size	Part #	Ctn	Pit	
2 x 1 1/2 x 1 1/2	03115	25	1,350	
2 x 1 1/2 x 2	03116	25	1,350	
2 x 2 x 1 1/2	03117	50	1,600	
3 x 3 x 1 1/2	03118	10	540	
3 x 3 x 2	03119	20	560	



STYLE NO. A416 SANITARY TEE W / LEFT SIDE INLET

ALL HUB				
Size	Part #	Ctn	Pit	
3 x 3 x 2 x 2	02780	10	360	
3 x 3 x 3 x 1 1/2	02781	10	280	
3 x 3 x 3 x 2	02782	10	280	

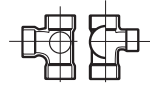

STYLE NO. A417 SANITARY TEE W / RIGHT SIDE INLET

ALL HUB				
Size	Part #	Ctn	Pit	
3 x 3 x 3 x 1 1/2	02795	10	280	
3 x 3 x 3 x 2	02796	10	280	

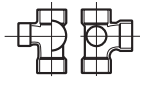

STYLE NO. A418 SANITARY TEE W / RIGHT & LEFT SIDE INLET

ALL HUB				
Size	Part #	Ctn	Pit	
3 x 3 x 3 x 1 1/2 x 1 1/2	02810	10	280	
3 x 3 x 3 x 2 x 2	02811	5	210	

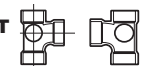

STYLE NO. A428 DOUBLE SANITARY TEE

ALL HUB				
Size	Part #	Ctn	Pit	
1 1/2	02812	25	1,350	
19.22	02813	20	720	
28.08	02814	20	240	
79.80	02815	4	112	



STYLE NO. A429 DOUBLE SANITARY TEE, REDUCING

ALL HUB				
Size	Part #	Ctn	Pit	
2 x 2 x 1 1/2 x 1 1/2	02817	20	840	
3 x 3 x 1 1/2 x 1 1/2	02818	20	480	
3 x 3 x 2 x 1 1/2	02819	10	360	
3 x 3 x 2 x 2	02820	10	360	
4 x 4 x 2 x 2	02240	5	240	
4 x 4 x 3 x 3	02821	5	160	



STYLE NO. A431 DOUBLE SANITARY TEE, STREET, REDUCING

SP x H x H x H				
Size	Part #	Ctn	Pit	
3 x 3 x 2 x 2	03310	10	360	



STYLE NO. A438 DOUBLE SANITARY TEE W / SIDE INLET

ALL HUB				
Size	Part #	Ctn	Pit	
3 x 3 x 3 x 3 x 2	02772	10	180	

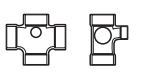

STYLE NO. A439 DOUBLE SANITARY TEE W / RIGHT & LEFT SIDE INLET

ALL HUB				
Size	Part #	Ctn	Pit	
3 x 3 x 3 x 3 x 2 x 2	02770	10	180	



STYLE NO. A441 VENT TEE

ALL HUB				
Size	Part #	Ctn	Pit	
1 1/2	03403	25	1,800	
2	03404	25	1,350	
3	03405	10	480	
4	03406	5	180	



**STYLE NO. A444X
CLEANOUT TEE WITH PLUG**



H x H x FPT			
Size	Part #	Ctn	Pit
1 1/2	02997	10	1,440
2	02998	10	1,080
3	02999	10	480
4	03000	5	180

**STYLE NO. A445
FLUSH CLEANOUT TEE**



H x H x FPT			
Size	Part #	Ctn	Pit
1 1/2	03413	20	2,160
2	03414	20	1,440
3	03415	10	540
4	03416	10	240

**STYLE NO. A448
TWO-WAY CLEANOUT**

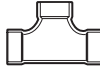

ALL HUB			
Size	Part #	Ctn	Pit
3	02237	10	240
4	02238	5	120

**STYLE NO. A450
FIXTURE TEE**



H x H x FPT			
Size	Part #	Ctn	Pit
1 1/2	03012	50	1,800
2 x 2 x 1 1/2	03402	25	1,200

**STYLE NO. A499
DOUBLE FIXTURE FITTING,
STREET**

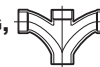

SP x H x H x H			
Size	Part #	Ctn	Pit
3	02245	5	135

**STYLE NO. A500
DOUBLE FIXTURE FITTING**



ALL HUB			
Size	Part #	Ctn	Pit
2	02246	25	500
3	02249	5	135
110.36			
REDUCING			
2 x 1 1/2 x 1 1/2 x 1 1/2	02247	20	840
2 x 1 1/2 x 2 x 2	02248	25	500
2 x 2 x 1 1/2 x 1 1/2	02244	20	720
3 x 2 x 3 x 3	02250	5	135

**STYLE NO. A501
COMBINATION WYE &
1/8 BEND - ONE PIECE**



ALL HUB			
Size	Part #	Ctn	Pit
1 1/2	02853	50	1,200
2	02858	20	560
3	02852	10	240
4	02860	10	120

**STYLE NO. A502
COMBINATION WYE &
1/8 BEND, REDUCING -
ONE PIECE**



ALL HUB			
Size	Part #	Ctn	Pit
2 x 1 1/2 x 1 1/2	02835	5	540
2 x 1 1/2 x 2	02836	5	540
2 x 2 x 1 1/2	02865	20	840
3 x 3 x 1 1/2	02837	15	480
3 x 3 x 2	02857	10	360
4 x 4 x 2	02863	5	180
4 x 4 x 3	02864	5	120

**STYLE NO. A503
COMBINATION WYE &
1/8 BEND - TWO PIECE**



ALL HUB			
Size	Part #	Ctn	Pit
6	02266	2	24

**STYLE NO. A504
COMBINATION WYE &
1/8 BEND, REDUCING -
TWO PIECE**



ALL HUB			
Size	Part #	Ctn	Pit
6 x 6 x 4	02267	4	48

**STYLE NO. A507
DOUBLE COMBINATION WYE
& 1/8 BEND, ASSEMBLED**



ALL HUB			
Size	Part #	Ctn	Pit
3	02854	5	90

**STYLE NO. A600
WYE**



ALL HUB			
Size	Part #	Ctn	Pit
1 1/4	02816	35	1,680
1 1/2	02822	50	1,400
2	02823	25	800
3	02824	25	300
4	02825	5	140
6	03135	4	48

**STYLE NO. A601
WYE, REDUCING**



ALL HUB			
Size	Part #	Ctn	Pit
2 x 1 1/2 x 1 1/2	02831	25	1,200
2 x 1 1/2 x 2	02832	10	720
2 x 2 x 1 1/2	02826	25	1,050
3 x 3 x 1 1/2	02827	15	420
3 x 3 x 2	02828	25	400
4 x 4 x 1 1/2	02833	5	210
4 x 4 x 2	02829	10	240
4 x 4 x 3	02830	10	160
6 x 6 x 4	03137	5	60

**STYLE NO. A602
WYE, STREET**



SP x H x H			
Size	Part #	Ctn	Pit
1 1/2	03367	50	1,800
2	03368	30	960
3	03369	10	360
4	03370	5	140

**STYLE NO. A603
WYE, STREET, REDUCING**



SP x H x H			
Size	Part #	Ctn	Pit
3 x 3 x 1 1/2	03372	20	480
3 x 3 x 2	03373	30	480
4 x 4 x 2	03374	10	280
4 x 4 x 3	03375	10	180

**STYLE NO. A604
CLEANOUT WYE**



H x H x H x FPT			
Size	Part #	Ctn	Pit
1 1/2	03019	20	1,440

**STYLE NO. A604X
CLEANOUT WYE
W/ CLEANOUT PLUG**



H x H x H x FPT			
Size	Part #	Ctn	Pit
1 1/2	02809	20	1,440

**STYLE NO. A611
DOUBLE WYE**



ALL HUB			
Size	Part #	Ctn	Pit
1 1/2	02838	40	1,120
2	02839	20	560
3	02840	10	180
4	02841	5	80

**STYLE NO. A612
DOUBLE WYE, REDUCING**



ALL HUB			
Size	Part #	Ctn	Pit
2 x 2 x 1 1/2 x 1 1/2	02847	10	720
3 x 3 x 1 1/2 x 1 1/2	02843	10	360
3 x 3 x 2 x 2	02844	10	280
4 x 4 x 2 x 2	02845	5	180
4 x 4 x 3 x 3	02846	5	90
6 x 6 x 4 x 4	03142	3	54

**STYLE NO. A700
RETURN BEND**



H x H			
Size	Part #	Ctn	Pit
1 1/2	03466	20	1,440
2	03467	35	840
3	03468	10	280
4	03469	5	120

**STYLE NO. A701
RETURN BEND
W / CLEANOUT**



H x H			
Size	Part #	Ctn	Pit
1 1/2	03471	20	1,440
2	03472	10	720

**STYLE NO. A704P
TAIL PIECE ADAPTER
(Plastic Nut)**

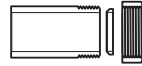

SP x SJ (FINISHED W/BOTH SIZES SJ WASHERS)			
Size	Part #	Ctn	Pit
1 1/2 x 1 1/4	02975	25	2,700
1 1/2	02975	25	2,700

**STYLE NO. A706X
P-TRAP W / SOLVENT
WELD JOINT**



H x H			
Size	Part #	Ctn	Pit
1 1/2	02214	25	1,200
2	02222	20	560
3	02230	10	180
4	02231	4	96

**STYLE NO. A707X
P-TRAP W / SOLVENT
WELD JOINT & CLEAN OUT**



H x H			
Size	Part #	Ctn	Pit
1 1/2	02223	10	1,080
2	02224	10	540

**STYLE NO. A708P
P-TRAP W / UNION**



H x H

Size	Part #	Ctn	Plt
1 1/4	02212	50	1,000
1 1/2	02215	25	900
2	02216	20	560

**STYLE NO. A710
P-TRAP LOW PROFILE**



H x H

Size	Part #	Ctn	Plt
2	02225	20	720

**STYLE NO. A711M
LA P-TRAP W / UNION
& 1 PC POLY NUT**



SJ x H

Size	Part #	Ctn	Plt
1 1/2	02221	25	900
1 1/4 x 1 1/2	02219	25	900

**STYLE NO. A711P
LA P-TRAP W / UNION &
1 1/2x1 1/4 NUT & POLY WASHER**



SJ x H

Size	Part #	Ctn	Plt
1 1/4 x 1 1/2	02220	25	900
1 1/2	02220	25	900

**STYLE NO. A720X
DRUM TRAP, W / CLEANOUT**



H x H (W/PLUG)

Size	Part #	Ctn	Plt
3 x 6 x 1 1/2	03100	10	320

**STYLE NO. A800
CLOSET FLANGE**

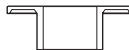

H (ONE PIECE WITH SLOTS)

Size	Part #	Ctn	Plt
4 x 4	02902	25	700

**STYLE NO. A800S
CLOSET FLANGE, W / STOP**



H (ONE PIECE WITH SLOTS)

Size	Part #	Ctn	Plt
4 x 3	02903	25	700

**STYLE NO. A800KO
CLOSET FLANGE,
KNOCK OUT**



H (ONE PIECE WITH SLOTS & KNOCK OUT TEST GAP)

Size	Part #	Ctn	Plt
4 x 3	02254	25	700
4 x 4	02253	25	700

**STYLE NO. A801
CLOSET FLANGE, SPIGOT,
REDUCING**



SP (ONE PIECE PLASTIC)

Size	Part #	Ctn	Plt
4 x 3	02919	25	800

**STYLE NO. A802
CLOSET FLANGE
W / GUSSET**



H (ONE PIECE WITH NO SLOTS)

Size	Part #	Ctn	Plt
4 x 4	02262	25	700

**STYLE NO. A807
CLOSET FLANGE – FEMALE**



FIPT
WITH SLOTS

Size	Part #	Ctn	Plt
4 x 3	02270	25	700

**STYLE NO. A808
CLOSET FLANGE – MALE**

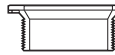

MPT

Size	Part #	Ctn	Plt
4 x 3	02260	25	700

**STYLE NO. A810
CLOSET FLANGE,
ADJUSTABLE,
W / PLASTIC RING**



H (W / SLOTS)

Size	Part #	Ctn	Plt
4 x 4	02256	25	700

**STYLE NO. A810S
CLOSET FLANGE, W / STOP,
ADJUSTABLE,
W / PLASTIC RING**



H (W / SLOTS)

Size	Part #	Ctn	Plt
4 x 3	02251	25	700

**STYLE NO. A811
CLOSET FLANGE, ADJUSTABLE,
W / METAL RING,
EPOXY COATED**

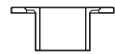

H (W / SLOTS)

Size	Part #	Ctn	Plt
4 x 3	02227	25	700
4 x 4	02226	25	700

**STYLE NO. A812
CLOSET FLANGE, SPIGOT,
ADJUSTABLE,
W / METAL RING,
EPOXY COATED**



SP

Size	Part #	Ctn	Plt
4 x 3	02228	25	700
4 x 4	02229	25	700

**STYLE NO. A812P
CLOSET FLANGE, SPIGOT,
ADJUSTABLE,
W / PLASTIC RING**

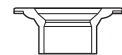

SP

Size	Part #	Ctn	Plt
4 x 3	02252	25	700
4 x 4	02264	25	700

**STYLE NO. A815
FLUSH CLOSET FLANGE**



H (FITS OVER 3" OR INSIDE 4" SCH 40 DWV PIPE)

Size	Part #	Ctn	Plt
4 x 4 / 4 x 3	02255	25	675

**STYLE NO. A820
OFFSET CLOSET FLANGE,
ADJUSTABLE,
W / METAL RING,
EPOXY COATED**



H

Size	Part #	Ctn	Plt
4 x 3	02920	15	540

**STYLE NO. A900
SWIVEL TRAY PLUG ADAPTER
W / WASHER**



SP X NPSM Thread

Size	Part #	Ctn	Plt
1 1/2	03418	50	5,400

**STYLE NO. A900X
SWIVEL TRAY PLUG ADAPTER
W / WASHER**



SP X NPSM Thread (EXTENDED)

Size	Part #	Ctn	Plt
1 1/2	03013	50	3,600
1 1/4 x 1 1/2	03420	50	5,400

**STYLE NO. A910
SWIVEL TRAY PLUG ADAPTER
W / WASHER**



H X NPSM Thread

Size	Part #	Ctn	Plt
1 1/2	03421	50	5,400
1 1/4 x 1 1/2	03417	50	5,400