

Fastener Spacing

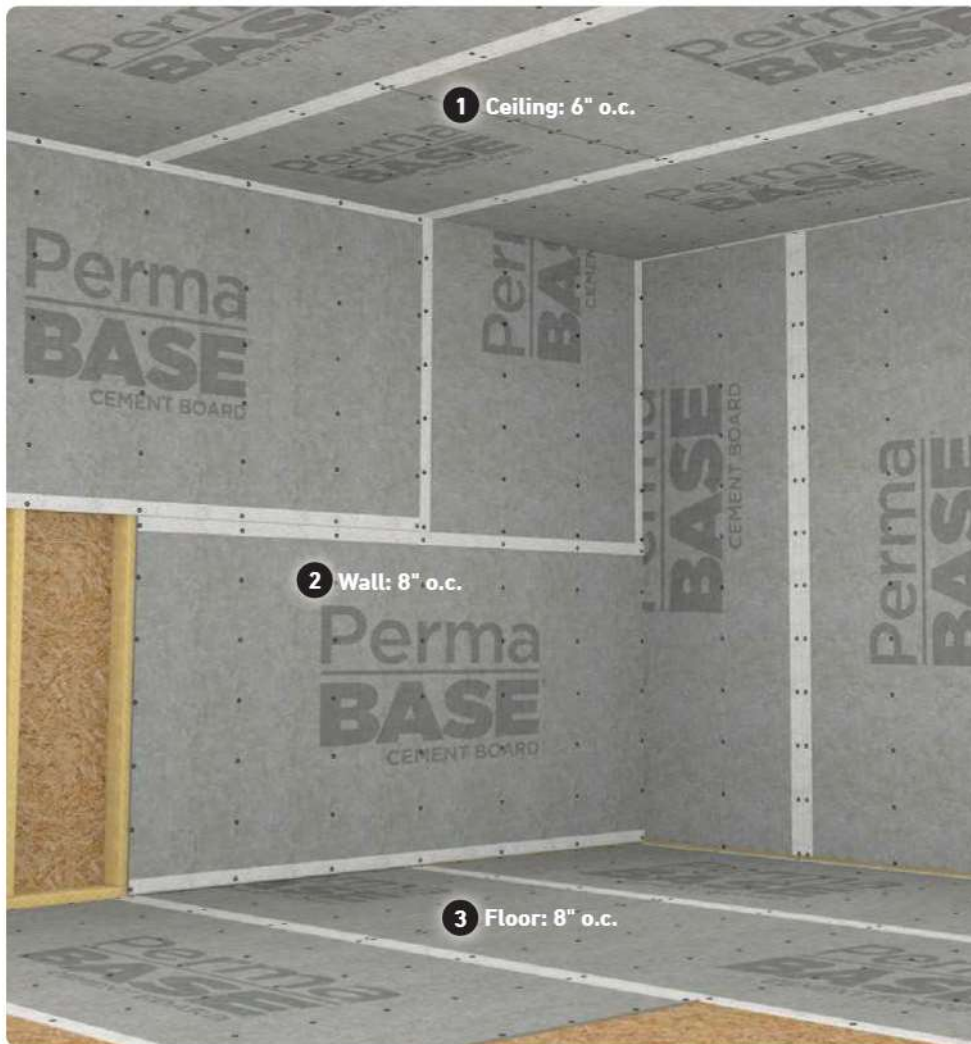

1. Ceilings - Fasten PermaBASE a maximum of every 6" o.c. into existing ceiling framing.

2. Walls - Fasten PermaBASE a maximum of every 8" o.c. into existing wall framing.

3. Floors - Fasten PermaBASE a maximum of every 8" o.c. throughout board field and around all edges.

SCREWS NEEDED

Usage	Screws per Board	Screws per Sq. Ft.
4' x 8' PermaBASE		
Wall	52	1.65
Ceiling	63	2.00
Floor	91	2.85
3' x 5' PermaBASE		
Wall	36	2.40
Ceiling	35	2.35
Floor	54	3.60

MESH TAPE NEEDED (EST.)

Tape Size	Linear Ft. per Board	Linear Ft. per Sq. Ft.
4' x 8' PermaBASE		
2" or 4"	12	0.375
3' x 5' PermaBASE		
2" or 4"	8	0.533
Tape Size	# Rolls per 1,000 Sq. Ft. of Board	# Boards per Roll of Tape
4' x 8' PermaBASE		
2" x 50'	.75	4.167
4" or 150'	2.5	12.500
3' x 5' PermaBASE		
2" x 50'	10.7	6.250
4" or 150'	3.6	18.750

Installation Accessories

For a seamless installation, we recommend PermaBASE™ Cement Board Tape and PermaBASE™ Cement Board Screws.

Fasteners: PermaBASE corrosion-resistant screws or equivalent, 1-1/4", 2" or 2-1/2" long, for use with wood framing. Type S-12 screws or equivalent, 1-1/4", 2" or 2-1/2" long, for use with 20-gauge or heavier steel framing. Galvanized roofing nails, 1-1/2" long with hot-dipped galvanized coating for use with wood framing. Nails should meet Federal Specification #FF-N105B/type 2 style 20.

Joint Reinforcement: PermaBASE Cement Board Tape must be used on all edges and cuts made to size. Use 2" wide polymer-coated (alkali-resistant) mesh tape for interior applications and 4" wide polymer-coated (alkali-resistant) mesh tape is recommended for inside and outside corners and all exterior applications.

