

Installation Guide

Interior and Exterior Applications



Interior Installation of PermaBASE® and PermaBASE PLUS®

General: All framing should comply with local building code requirements and be designed to provide support with a maximum allowable deflection of L/360 (L/720 for stone) under all intended loads. Framing members should be spaced a maximum of 16" o.c. Cut or score PermaBASE® Cement Board on printed side of panel. Use a straightedge and pencil to mark line. Use utility knife to score/cut the glass mesh. Snap the board and cut through the now visible glass mesh on the other side. Install tile and tile setting materials in accordance with current ANSI specifications and Tile Council of North America (TCNA) guidelines.

Control Joints: Consult TCNA Handbook Installation Method EJ171. Architect, builder or design professional must specify location of all control joints. For interior installations, allow a maximum of 30 lineal feet between control joints. A control joint must be installed but not limited to the following locations: where expansion joints occur in the framing or building (discontinue all cross furring members located behind joint); when boards abut dissimilar materials; where framing material changes; at changes of building shape or structural system; at each story separation. Place control joints at corners of window and door openings, or follow specifications of architect. Control joint cavity shall not be filled with coating or other materials.

WALLS AND CEILINGS

Wall Framing: Edges of PermaBASE parallel to framing should be continuously supported. Provide additional blocking when necessary to permit proper attachment. Do not install PermaBASE directly over protrusions from stud plane, such as heavy brackets and fastener heads. Studs above a shower floor should either be notched or furred to accommodate the thickness of the waterproof membrane or pan. The surround opening for a tub or precast shower receptor should not be more than 1/4" longer than unit to be installed. In mortar bed (mud bed) applications, PermaBASE Cement Boards can be embedded into the mud bed per TCNA Handbook method B415-19.

Ceiling Framing: The deflection of the complete ceiling assembly due to dead load (including insulation, PermaBASE, bonding material and facing material) should not exceed L/360. The dead load applied to the ceiling frame should not exceed 10 psf. Ceiling joist or furring channel should not exceed 16" o.c. (Edges of PermaBASE parallel to framing should be continuously supported.) Provide additional blocking when necessary to permit proper PermaBASE attachment.

PermaBASE Cement Board: Apply PermaBASE with ends and edges closely butted but not forced together. Stagger ends joints in successive courses. Drive fasteners into field of cement board first, working toward ends and edges. Space fasteners maximum 8" o.c. for walls, 6" o.c. for ceilings with perimeter fasteners at least 3/8" and less than 5/8" from ends and edges. Ensure PermaBASE is tight to framing.

Joint Reinforcement: Trowel bonding material to completely fill the tapered recessed board joints and gaps between each panel. On non-tapered joints, apply a 6" wide, approx. 1/16" thick coat of bonding material over entire joint. For all joints, immediately embed 2" alkali-resistant fiberglass mesh tape fully into applied bonding material and allow it to cure. For outside corners, 4" wide mesh tape is recommended. Same bonding material should be applied to corners, control joints, trims and other accessories. Feather bonding material over fasteners to fully conceal.

For installation accessories, see page 20.

Perma
BASE
CEMENT BOARD

PermaBASE
PLUS
CEMENT BOARD

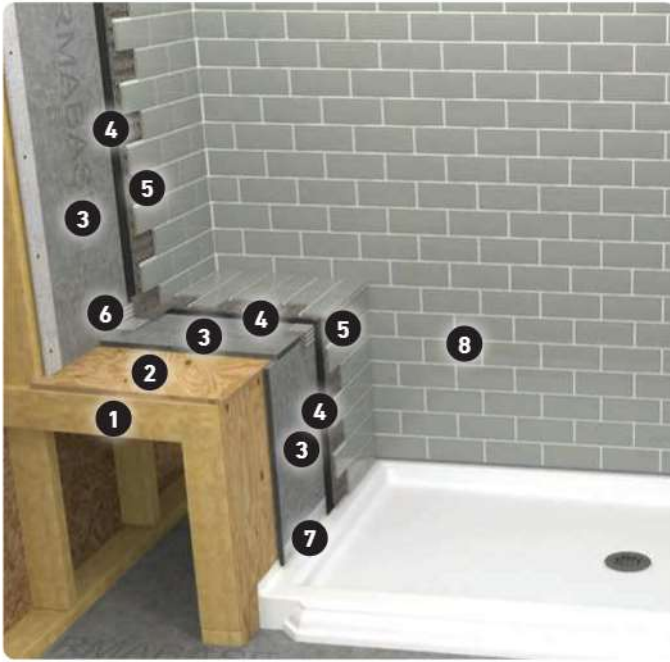

SHOWER INSTALLATION

- 1. Support Framing 1/4" / 1/2" Slope Toward Drain
- 2. Plywood, Min. 1/2"
- 3. PermaBASE® Cement Board
- 4. Membrane
- 5. Latex-Portland Cement Mortar
- 6. Alkali-Resistant Mesh Tape
- 7. Sealant
- 8. Tile and Grout



DIVIDER WALL INSTALLATION

- 1. PermaBASE® Cement Board
- 2. Membrane
- 3. Latex-Portland Cement Mortar
- 4. Alkali-Resistant Mesh Tape

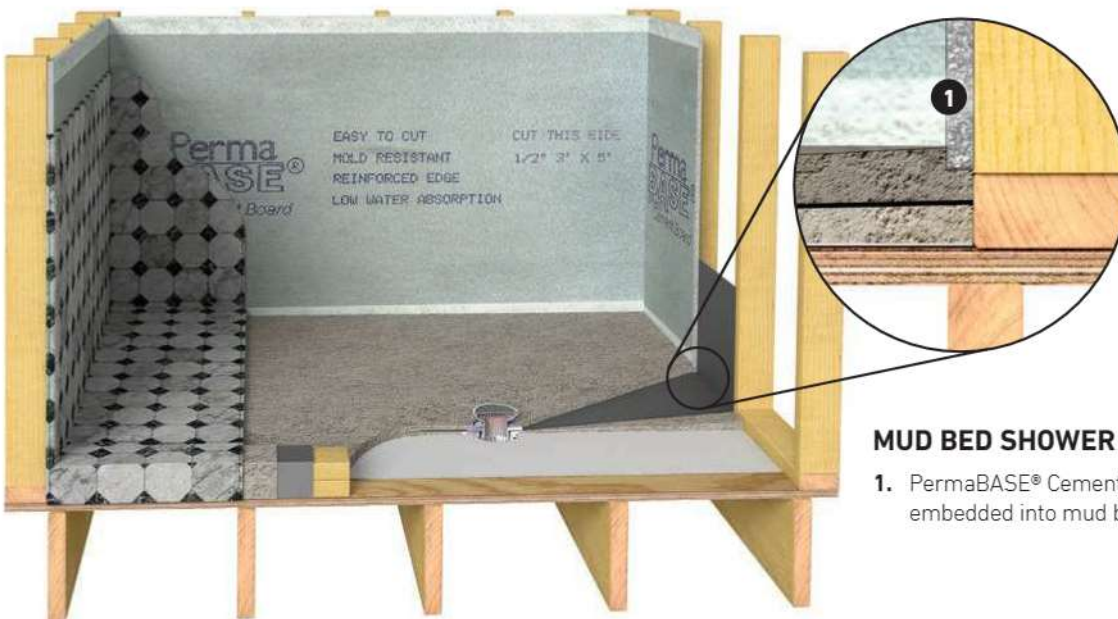

MUD BED SHOWER BASE

- 1. PermaBASE® Cement Board can be embedded into mud bed.