

The Space-Ty™

SPACE-TY™ ASSEMBLY

The Space-Ty™ combines all essential features for light concrete forming. The Space-Ty™ re-bar locating device securely locks the re-bar at a correct distance from the face of the form and eliminates the need for spacers.

Minimum end length of 120 mm (4¾"). Standard sizes stocked in 120 mm (4¾") or 211 mm (8¼") ends.

FORM TY SPECIFICATIONS

Internal form ties shall be so arranged that when the forms are removed, no metal shall be within 40 mm or 50 mm (1½" or 2") of any exposed surface as outlined in CSA-A23-3-M90 or ACI 347-95. Use Space-Tys™ or approved equal and seal the tie holes with PVC plugs. The light grey plugs complement the adjacent concrete.

To order, please specify the following information

EXAMPLE

Name Space-Ty

End 211 mm (8¼")

Wall 300 mm (8")

End 211 mm (8¼")

"C" dimensions

40 mm or 50 mm (1½" or 2") 40 mm (1½")

Quantity (pkg of 50) 200

BREAK BACK TY

To facilitate the stripping of forms, the Space-Ty™ can be broken back prior to form removal. Using a Space-Ty™ wrench or standard 13 mm (½") socket wrench, twist and remove the Ty end.

NOTE: For Ty removal and break back guidelines please see page 101 of the Appendix. Refer to Lateral Pressure Design information on page 102 and typical Light Formwork on page 107 of the Appendix.

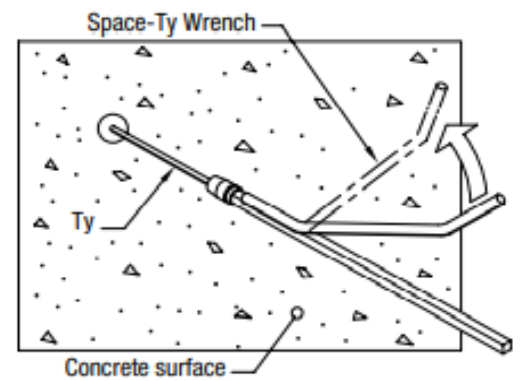
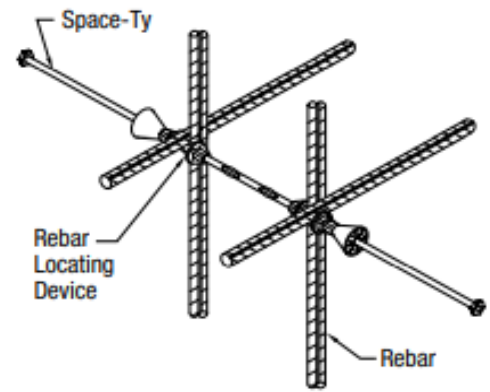

APPROXIMATE SAFE WORKING LOAD
13.5 kN (3,000 LBS)
2:1 Safety Factor

