

Design and Installation Guide - USA

4

Walls supporting one floor only

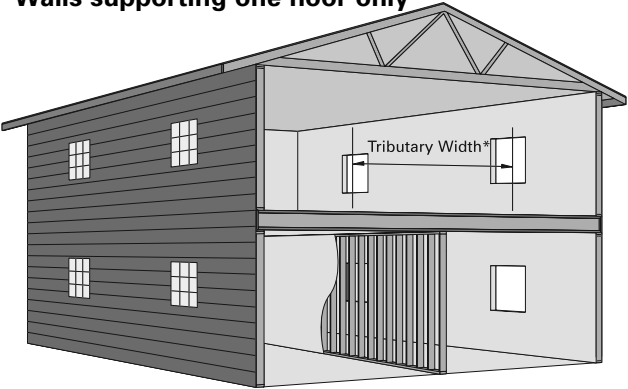

Walls supporting attic framing only

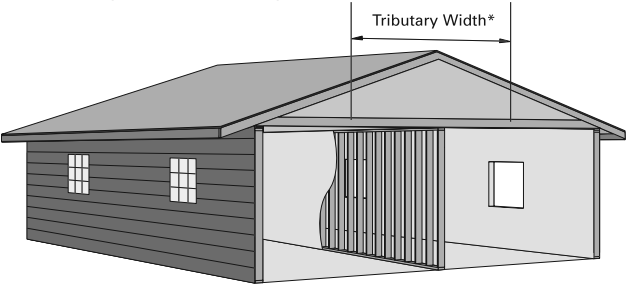

*Tributary width is calculated as a percentage of the sum of the joist spans on either side of the wall:
simple span: 0.5 ft x (left span + right span)
continuous span: 0.625 ft x (left span + right span)

GENERAL NOTES

- **QuietZone®** Acoustic Wall Framing is intended for interior walls only. Call toll free 1-866-864-5710 for information on other applications.
- 2x4 **QuietZone®** Acoustic Wall Framing has load-bearing capabilities similar to 2x3 wood framing; see design tables for details.
- 2x6 **QuietZone®** Acoustic Wall Framing has load-bearing capabilities similar to 2x4 wood framing; see design tables for details.
- Screws are recommended for fastening drywall, shelves, and fixtures to **QuietZone®** Acoustic Wall Framing. Use caution if fastening drywall to resilient member using a nailgun.
- **QuietZone®** Acoustic Batts (15" or 23" width) will be required in the cavity space between wall framing sections spaced either 16" or 24" o.c. when using 2 x 4 & 2 x 6 **QuietZone®** Acoustic Wall Framing.
- **QuietZone®** Acoustic Batts fit between wood framing members with the flanges stapled to the sides of the **QuietZone®** Acoustic Wall Framing structural members.

WARNING: LACK OF PROPER BRACING, INSUFFICIENT WALL SYSTEM DESIGN OR FAILURE TO FOLLOW THE INSTRUCTIONS SET FORTH HEREIN COULD LEAD TO PROPERTY DAMAGE AND/OR SERIOUS BODILY INJURY. NEITHER OWENS CORNING NOR TEMBEC SHALL BE RESPONSIBLE FOR ANY DAMAGE, LOSS, COSTS OR EXPENSES RELATING TO ANY MISUSE OF THE PRODUCTS DESCRIBED ABOVE, OR ANY FAILURE TO ADHERE TO THESE INSTRUCTIONS.

For more information on the **QuietZone®** Acoustic Wall Framing, call 1-866-864-5710.
For more information on other **QuietZone®** Products (**QuietZone®** Acoustic Batt & **QuietZone®** acoustic sealant) call 1-800-GET-PINK™, or visit www.owenscorning.com.

Maximum Tributary Width* (ft)
One Floor Only

Member Nominal Size	Wall Height	Member Spacing	Floor Load	
			40LL + 12DL	40LL + 25DL
2x4	8'	16" o.c.	13	10
		24" o.c.	11	9
	9'	16" o.c.	9	7
		24" o.c.	—	—
	10'	16" o.c.	—	—
		24" o.c.	—	—
2x6	8'	16" o.c.	30	30
		24" o.c.	30	30
	9'	16" o.c.	30	30
		24" o.c.	30	28
	10'	16" o.c.	30	24
		24" o.c.	26	21
	12'	16" o.c.	16	13
		24" o.c.	13	10
	14'	16" o.c.	—	—
		24" o.c.	—	—

Maximum Tributary Width* (ft)
Attic Framing Only

Member Nominal Size	Wall Height	Member Spacing	Attic Load (psf unfactored) 20LL + 10DL
2x4	8'	16" o.c.	22
		24" o.c.	19
	9'	16" o.c.	15
		24" o.c.	12
	10'	16" o.c.	10
		24" o.c.	—
2x6	8'	16" o.c.	30
		24" o.c.	30
	9'	16" o.c.	30
		24" o.c.	30
	10'	16" o.c.	30
		24" o.c.	30
	12'	16" o.c.	28
		24" o.c.	23
	14'	16" o.c.	—
		24" o.c.	—

Maximum Vertical Load (plf factored)
Interior Walls Only

Wall Height	Stud Length	2x4 Wall			2x6 Wall		
		On Center Spacing	On-Center Spacing	On-Center Spacing	On Center Spacing	On-Center Spacing	On-Center Spacing
		12"	16"	24"	12"	16"	24"
8'	92 ³ / ₈ "	1,055	965	810	3,715	3,715	3,470
9'	104 ⁵ / ₈ "	735	655	520	3,030	2,875	2,590
10'	116 ³ / ₈ "	515	450	330	2,335	2,190	1,925
12'	144"	—	—	—	1,315	1,195	980

Table is based upon:

- Type X gypsum wallboard applied to each side of the wall
- Interior lateral wall pressure of 5 psf

Design and Installation Guide - USA

I

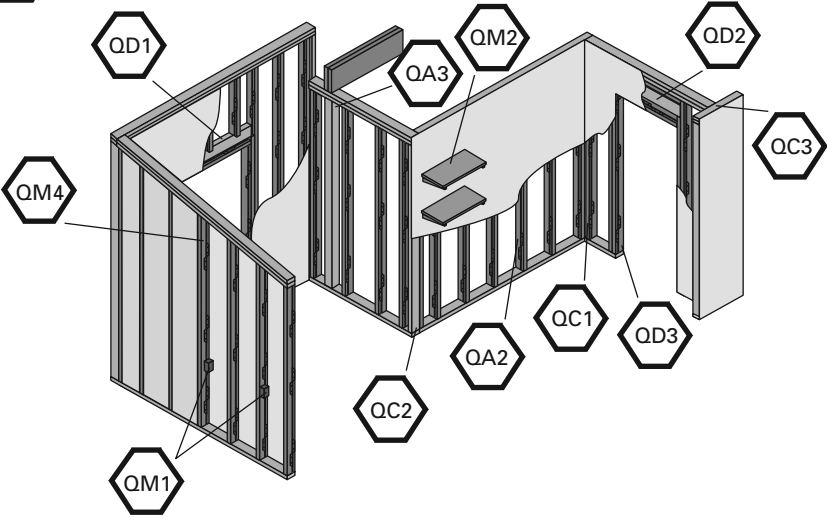

DIMENSIONS

2x4 Wall

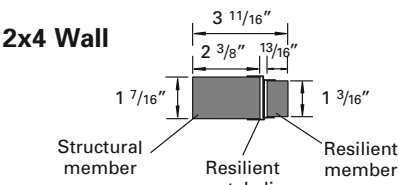

2x6 Wall

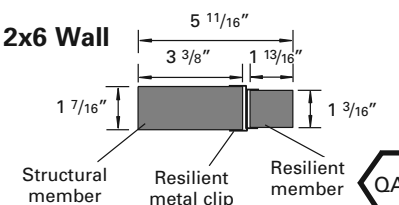

SUPPORT COLUMNS

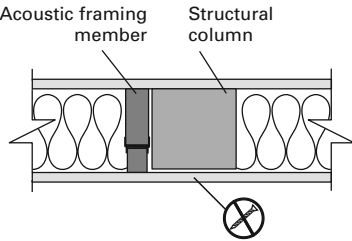

ALLOWABLE DESIGN VALUES (100% LOAD DURATION) - STRUCTURAL MEMBER

QuietZone® Acoustic Wall Framing featuring Tembec Select Engineered Lumber (Structural Member) and Selectem™ LVL (Resilient Member)

Modulus of elasticity	E	=	1.4 x 10 ⁶ psi
Bending at extreme fibre	Fb	=	875 psi
Compression parallel to grain	Fc	=	1150 psi
Compression perpendicular to grain	Fcp	=	425 psi
Shear parallel to grain	Fv	=	135 psi

Values may be increased by a repetitive member factor (Cr) if applicable
Values may be increase by a load duration factor (Cd) if applicable
Values may be increased by a size factor (Cf)

QuietZone® Acoustic Wall Framing is to be used in "dry" service conditions only
QuietZone® Acoustic Wall Framing has no Preservative or Fire Retardant Treatment
QuietZone® Acoustic Wall Framing is to be used as a vertical end-loaded member in compression

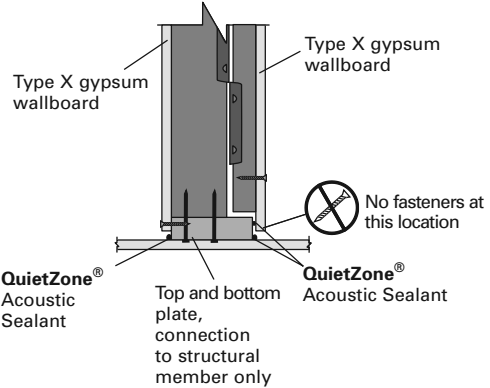
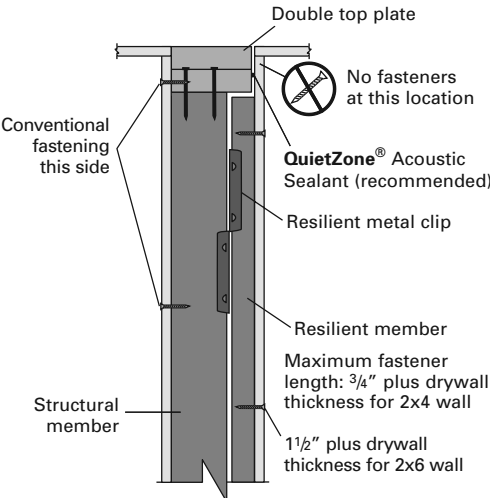

Design and Installation Guide - USA

<p>2</p> <p>INSIDE CORNER</p> <p>QC1</p>	<p>OUTSIDE CORNER</p> <p>QC2</p>	<p>QUIETZONE® TO STANDARD WALL CONNECTION</p> <p>QC3</p>
<p>QUIETZONE® WALL TO QUIETZONE® WALL CONNECTION</p> <p>QC3a</p>	<p>STANDARD WALL TO 2X4 QUIETZONE® WALL CONNECTION</p> <p>QC3b</p>	<p>STANDARD WALL TO QUIETZONE® WALL CONNECTION</p> <p>QC3c</p>
<p>LOW HEADER (Install header flush to structural side of wall only)</p> <p>QD1</p>	<p>HIGH HEADER (Install header flush to structural side of wall only)</p> <p>QD2</p>	<p>DOOR ATTACHMENT</p> <p>QD3</p>

Design and Installation Guide - USA

<p>3</p> <p>ELECTRICAL BOXES</p> <p>Resilient Side of Wall</p> <p>Structural Side of Wall</p> <p>QM1</p>	<p>SHELVES AND FIXTURES</p> <p>QM2</p>
<p>ALLOWABLE HOLES AND NOTCHES</p> <p>2x4 Walls</p> <p>2x6 Walls</p> <p>QM3</p>	<p>CUTTING NON-STANDARD LENGTHS</p> <p>QM4</p> <p>MULTIPLE LAYERS OF GYPSUM</p> <p>QM5</p>