

Product Application Sheet

DURASHEATH®

ATTIC & CRAWL SPACE APPLICATION

Durasheath® may be applied to the interior face of stud walls or roof rafters within attics and crawl spaces to provide a layer of continuous insulation (ci). Simply nail the Durasheath® to the framing members and cover with an approved ignition barrier such as 3/8" gypsum wallboard or 1/4" wood structural panel, particle board or hardboard.

Durasheath® has been tested to be left exposed in attics and crawl spaces without the code prescribed ignition barrier, provided the space is limited to servicing utilities. The maximum thickness is 1" in walls and ceilings or up to 4.5" in walls only.

Refer to Durasheath® Product Data Sheet for additional application/installation, compliances, thermal and physical properties, limitations and warnings.

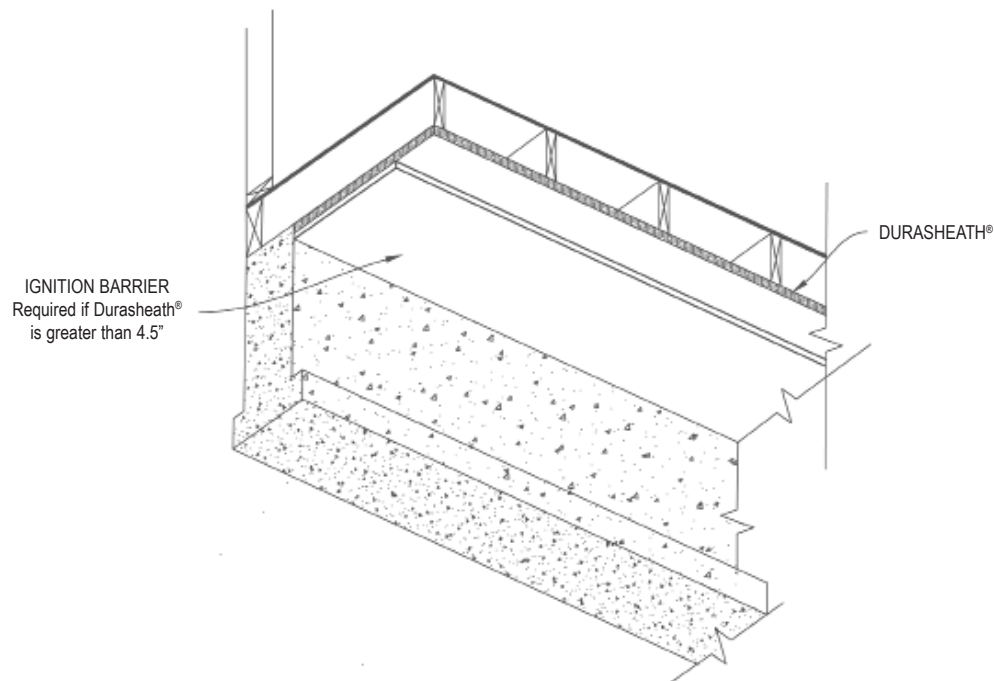

Notes:

1. Refer to local building codes for requirements on proper ventilation and bracing.

WARRANTY

See Rmax® sales policy and limited warranties for terms and conditions. Rmax® does not assume any responsibility or liability for the performance of any products other than those manufactured by Rmax®. **NOTE: Factory packaging should not be relied upon as protection at job sites or other outdoor storage locations. When short-term outdoor storage is necessary, take the following precautions: Store flat above ground on raised pallets, place bundles on finished surfaces, cover with a breathable tarpaulin and secure cover to prevent wind displacement.**