

# FLEX-TITE CLIPS

## INSULATION ATTACHMENT SYSTEM

### PRODUCT DESCRIPTION

Flex-Tite insulation clips are quick, easy, and efficient to work with. They provide a finishing touch that is attractive as well as functional. They are designed to save labor in installation, and save energy once finished. Suitable for use in metal buildings, wood framed and concrete construction.

### FEATURE AND BENEFITS

- Energy Efficient Design – unique co-extruded design, combining rigid and soft PVC to hold insulation tightly in place and create an air-tight seal
- Easy Handling – can be cut with standard power saws and two piece design allows for easy installation of the insulation
- Convenient – fastening leg for easy access with a nail gun, reducing installation time
- Impact-Resistant PVC – designed to withstand the high impact of nail guns
- Attractive Finish – manufactured to an attractive white finish. As desired, pieces can be painted or call for custom color applications.
- UL Tested – Class A material, tested by Underwriters Laboratories (UL 723 – test for surface burning characteristics of building materials). Flame spread is 0 and smoke developed equals 190.

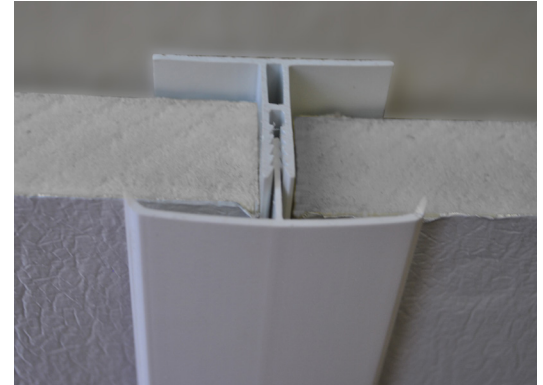

Flex-Tite Insulation Attachment System

### INSTALLATION

- Step 1 – Align the Flex-Tite J-Channel horizontally at the desired height and check for level. Nail or staple into place.
- Step 2 – Align the Flex-Tite female clip vertically at desired spacing and check for plumb. Nail or staple into place.
- Step 3 – Insert insulation into Flex-Tite J-Channel and install Flex-Tite male clips.

**NOTE:** For framed construction, do not span framing with Flex-Tite clips.

### TWO-PIECE FLEX-TITE INSULATION

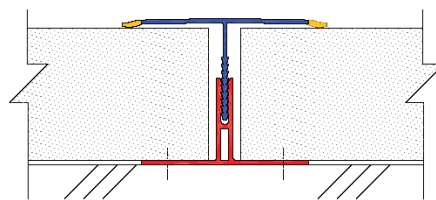
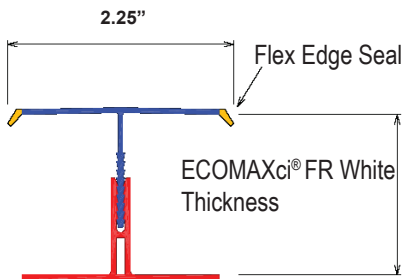

### FLEX-TITE J-CHANNEL

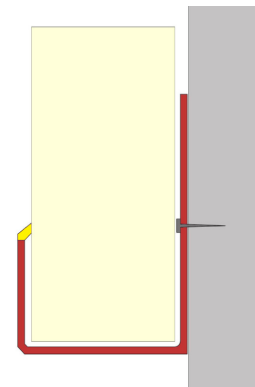

MANUFACTURED BY VICTORY BEAR, A DIVISION OF FUKUVI-USA, INC. / SOLD BY RMAX



BUILDING TRUST



**J-Channel**

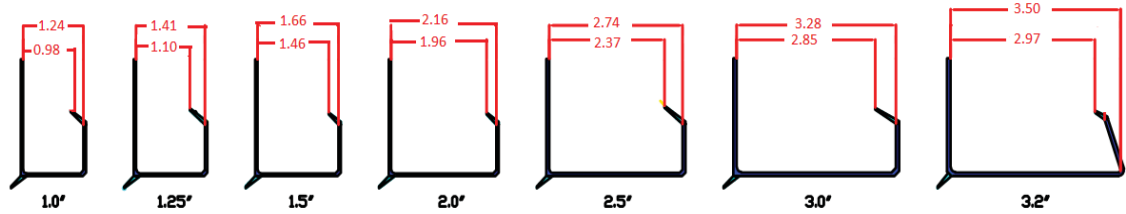

**Male Flex-Tite Clip**

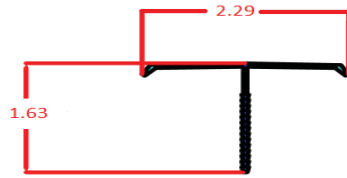

**Female Flex-Tite Clip**

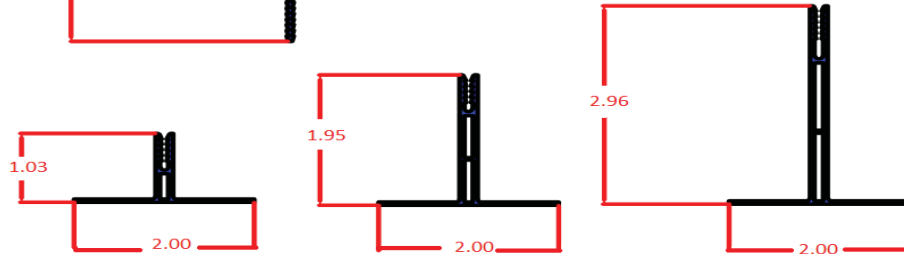

**INSULATION BOARD SIZING CHART**

ECOMAXCI® FR WHITE THICKNESS	J-CHANNEL PART #	MALE PART #	FEMALE PART #
1.0"	1540	FTM-03	FTF-1
1.25"	751	FTM-03	FTF-1
1.5"	769	FTM-06	FTF-1
1.75"	1541*	FTM-09	FTF-1
2.0"	1541	FTM-05	FTF-2
2.25"	1541	FTM-09	FTF-2
2.3"	1153*	FTM-09	FTF-2
2.5"	1153	FTM-10	FTF-2
2.75"	1547*	FTM-13	FTF-2
3.0"	1547	FTM-05	FTF-3
3.2"	1560	FTM-06	FTF-3
3.5"	NA	FTM-10	FTF-3

All Insulation Retainers are 10 ft./piece, 20 pieces/box.

Storage: material should be stored out of direct sunlight to prevent long-term deterioration or color fading. Pieces can be stacked, but should be stored fully supported to keep them from warping.

\*Contact your nearest Rmax sales office for more information.

**PROPERTIES**

Coefficient of Linear Expansion	.0132 inches per degree F
---------------------------------	---------------------------

**RMAX SALES OFFICES / PLANT**

**Central**

13524 Welch Road  
Dallas, TX 75244  
(P) 972-387-4500  
(F) 972-387-4673

**East**

1649 South Batesville Road  
Greer, SC 29650  
(P) 864-297-1382  
(F) 864-234-7548

**West**

210 Lyon Drive  
Fernley, NV 89408  
(P) 775-575-4849  
(F) 775-575-5035

[rmax@rmax.com](mailto:rmax@rmax.com) / [www.rmax.com](http://www.rmax.com)



PRODUCT DATA SHEET  
FLEX-TITE INSULATION CLIP  
Revision.03-05-2020



BUILDING TRUST

