

Multi-Max® FA-3: Insulation for Above the Deck

Modified Bitumen Application

Specify and install Multi-Max® FA-3 for use with a modified bitumen roofing system. Rmax requires a suitable overlay of mineral fiberboard, wood fiberboard or perlite be applied to the insulation prior to application of a torch-down modified bitumen system. Rmax recommends that insulations used under hot-mopped modified bitumen membranes be protected by an overlay of mineral fiberboard, wood fiberboard, gypsum board, perlite or a venting base sheet as specified in the NRCA "Technical Bulletin #9".

Insulation shall be attached to steel decks with one (1) mechanical fastener per four (4) square feet where the insulation will be overlaid with a cover board mopped in solid flood coats of hot bitumens. Where appropriate and suitable, Multi-Max® FA-3 may be adhered to properly prepared concrete roof deck surfaces in solid flood coats of hot bitumens.

Refer to Multi-Max® FA-3 data sheet for additional application/installation, compliances, thermal and physical properties, limitations and warnings.

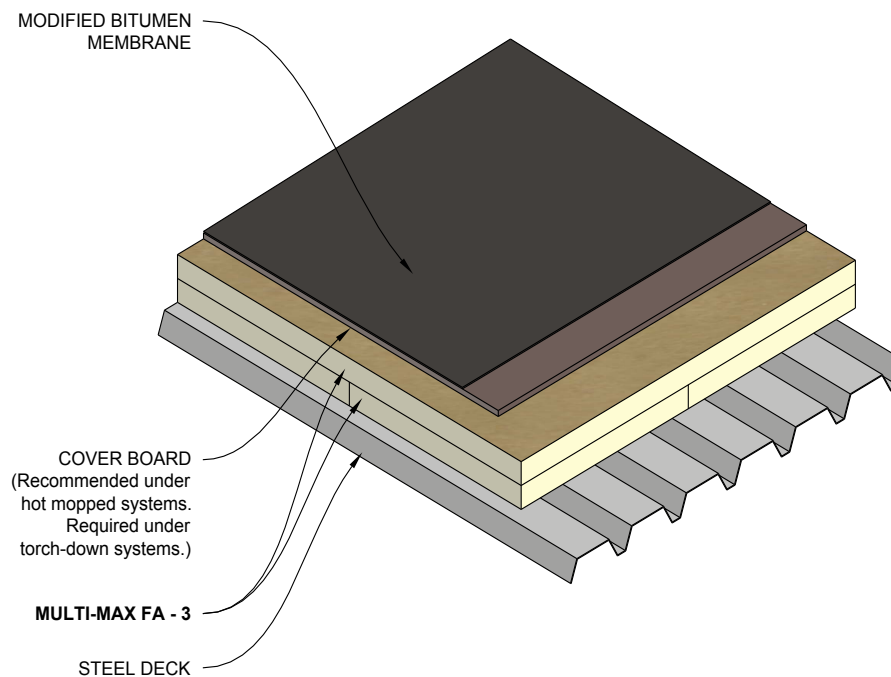

Notes:

1. Vapor retarders should be applied as required and recommended by the NRCA.

*Warranty: See Rmax "Sales Policy" and applicable warranties for terms and conditions. Rmax does not assume any responsibility or liability for the performance of any products other than those manufactured by Rmax. **NOTE: All Rmax products must be tarped, placed on skids and kept dry before and throughout construction. Requests for Certification Letters and/or special warranty considerations must be submitted to Rmax Sales prior to delivery of the products.***

2017-11