

Roofing Insulation Products

The Trusted Leader in Polyiso Roofing Insulation Solutions





Leading the Industry in Product Excellence

Since 1978, Rmax has evolved to become the respected leader in the manufacture and delivery of commercial, industrial and residential roofing insulation products. Every step of the way, we've grown as an organization by developing product solutions which embrace the challenges of our changing industry with integrity, responsiveness and a forward-thinking attitude.

As time passed, typical asphalt built-up roofing systems have often been replaced with the newer single-ply systems. Rmax has continuously introduced new products that exceeded industry demands through its cutting-edge technology. These new energy efficient polyiso roofing products developed quickly and taught end-users nationwide to depend on the quality and performance of Rmax insulation.

Rmax flat polyiso insulation offers versatile solutions for new and retrofit applications. They deliver the highest R-values per inch, do not require a thermal barrier and are available in 25psi compressive strength. Rmax insulation products will save on energy dollars.



Rmax Tapered polyiso insulation is manufactured with a standard slope of 1/8", 1/4" or 1/2" per foot slope to provide a positive roof drainage. Rmax Tapered products are available with factory engineered roof layouts for simplified installation.



Rmax polyiso Nail Base products meet nationally adopted building codes – and are ideal for new and retrofit applications. Nail Base products typically come bonded to a 7/16" OSB panels and allow for the normal expansion of wood. In addition, panels may be custom-ordered with a wide variety of plywood. Finally, Rmax Nail Base products reduce thermal loss and moisture migration. All-in- all, Rmax polyiso Nail Base products are the wise choice.



Rmax Tapered Polyiso Insulation

Rmax Tapered Thermaroom® polyiso insulation provides a very effective and economical rooftop drainage solution. Properly installed Rmax tapered polyiso insulation helps extend the life of all roof assemblies – simply by eliminating ponded water. Importantly, Rmax provides professional technical support services for the design and installation of tapered insulation systems through the Rmax Tapered Services Department.

Rmax Tapered Thermaroom® polyiso insulation contributes to positive drainage with standard slopes of 1/8", 1/4" or 1/2" per foot. Standard Rmax tapered systems utilize flat Multi-Max® FA-3 polyiso filler panels to build up thickness for the roof design. Even better, tapered systems utilizing superior mold-resistant Ultra-Max® polyiso insulation, with its coated glass facer, are readily available.

TAPERED POLYISO INSULATION DESIGN SERVICES

Rmax's experienced Tapered Services Department uses the latest technology to provide owners, architects, roof consultants, general contractors, distributors and roofing contractors accurate, efficient, and complete tapered insulation designs for any project – no matter how simple or how complex.

ARCHITECTURAL PRE-BID TAPERED POLYISO INSULATION DESIGN AND LAYOUT

The Rmax Tapered Services Department supports design professionals and roof consultants with tapered polyiso insulation design and layout assistance. The Rmax Tapered Services Department consults with the architect or roof consultant to create a professional and cost-effective tapered system design for any project prior to its bidding. Upon submittal of a detailed roof plan, in many formats, along with any pertinent design criteria, the Rmax Tapered Services Department will then create an original rendition of a complete tapered design – ready to become a component of the bid documents.

With experience in the creation of tapered polyiso insulation designs dating back to 1978, Rmax continues today to provide the very best in tapered designs which provide positive drainage.

For architectural pre-bid tapered polyiso insulation design and layout assistance or to request a tapered polyiso insulation quotation, please visit www.rmax.com/tapered-services.

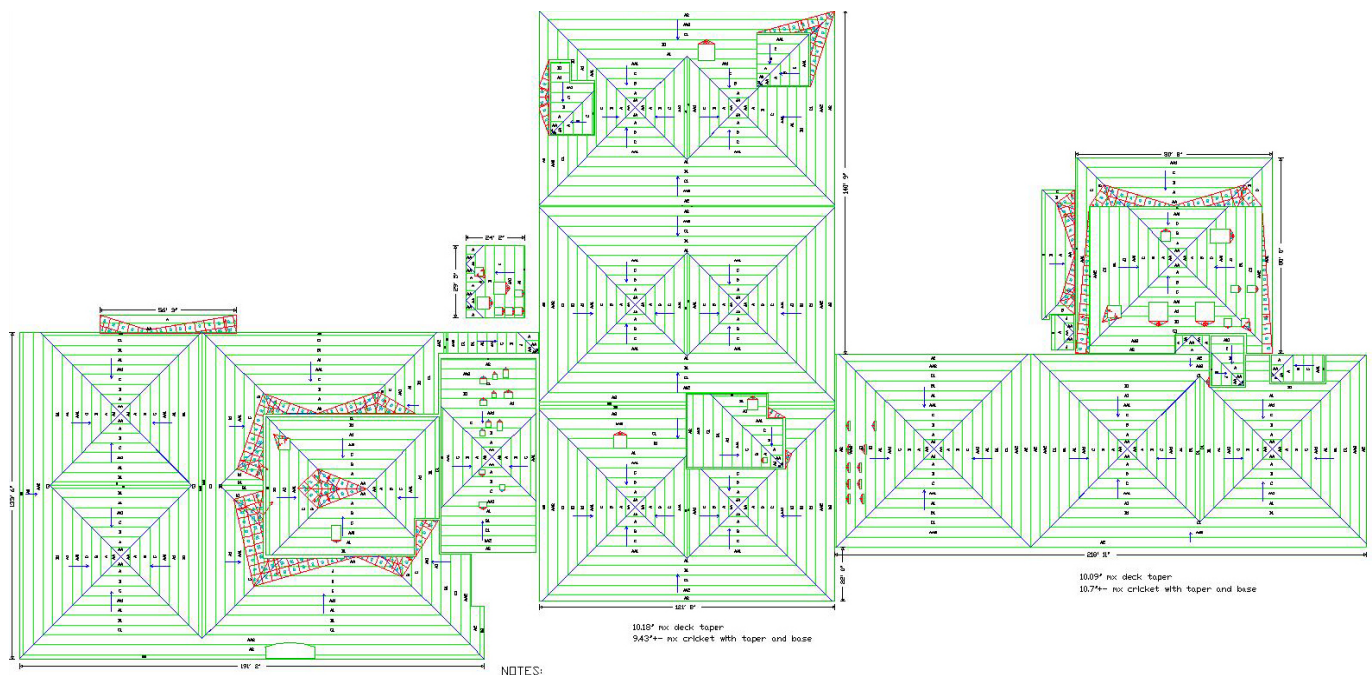



Polyiso Roof Insulation Products

Multi-Max® FA-3

- Durable glass fiber/organic mat facers
- Available in 1.5" - 4.0" thicknesses
- Ideal for built-up roof (BUR), modified bitumen or single ply membranes and metal panel roofing systems
- Delivers highest R-values - per inch
- Saves on energy dollars
- No thermal barrier required
- 25psi compressive strength available

Ultra-Max®

- Inorganic coated glass fiber facers
- Available in 1.5" - 4.0" thicknesses
- Ideal for built-up roof (BUR), modified bitumen or single ply membranes and metal panel roofing systems
- Mold resistant per ASTM D3273 (no defacement)
- Delivers highest R-values - per inch
- Saves on energy dollars
- No thermal barrier required
- 25psi compressive strength available

Thermarook® Plus-3

- Glass fiber reinforced aluminum facers
- Available in 1.0" - 4.0" thicknesses
- Ideal for single ply membranes and metal panel roofing systems
- Approved for use in new roof and limited retrofit/recover roof constructions over steel, wood, non-combustible and certain types of nailable roof decks
- Delivers highest R-values - per inch
- Saves on energy dollars
- No thermal barrier required
- 25psi compressive strength available

Re-Cover Board-3

- Glass fiber/organic mat (GRF) or coated glass fiber (CGF) facers
- Available in 1.0" - 1.4" thicknesses
- Ideal for built-up roof (BUR), modified bitumen or single ply membrane
- Approved for use in recover type applications where the existing roof system, including the deck below, is still sound and firmly attached
- Provides improved energy efficiency to many retrofit applications

Single Ply System

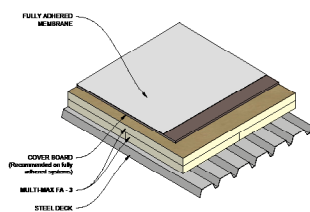

Built-Up Roof (BUR) System

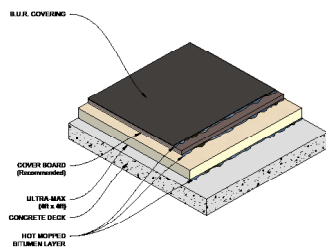

Metal Panel Roofing System

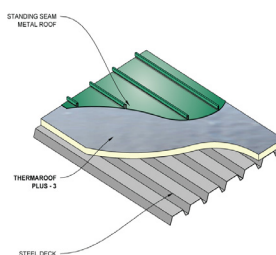

Mechanically Attached System

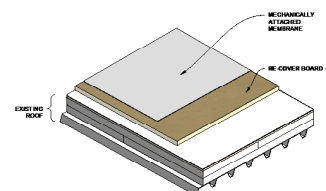

COMPLIANCES

- ASTM C1289 Type II, Class 1
- Factory Mutual (Class 1)
- UL Time Rated
- UL 790 Class A, UL 1256 Class A
- Miami Dade County
- Florida Product Approval
- IBC, IRC, IECC, ASHRAE 90.1
- City of LA
- CA Insulation Directory

COMPLIANCES

- ASTM C1289 Type II, Class 2
- Factory Mutual (Class 1)
- UL Time Rated
- UL 790 Class A, UL 1256 Class A
- Miami Dade County
- Florida Product Approval
- IBC, IRC, IECC, ASHRAE 90.1
- City of LA
- CA Insulation Directory

COMPLIANCES

- ASTM C1289 Type I, Class 1 and Class 2
- Factory Mutual (Class 1)
- IBC, IRC, IECC, ASHRAE 90.1
- City of LA
- CA Insulation Directory

COMPLIANCES

- ASTM C1289 Type II
 - Class 1 (GRF)
 - Class 2 (CGF)
- Miami Dade County
- Florida Product Approval
- IBC, IRC, IECC, ASHRAE 90.1
- City of LA
- CA Insulation Directory

At Rmax, we pride ourselves in offering the most comprehensive line of high-quality polyiso insulated roofing products, meeting virtually any application in the commercial, industrial and residential construction business.

Ultra-Max® HD

- Moisture resistant coated glass fiber facers
- 1/2" high density coverboard
- Ideal for mechanically attached single-ply membranes and fully adhered single-ply membranes
- Increased dimensional stability
- Provides greater roof system protection
- Lightweight and easy to handle

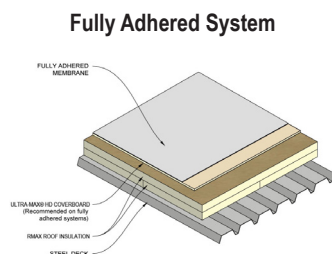

COMPLIANCES

- ASTM C1289 Type II, Class 4
- Factory Mutual (Class 1)
- UL Time Rated
- UL 790 Class A, UL 1256 Class A
- IBC, IRC, IECC, ASHRAE 90.1

Tapered Thermarook®

- Glass fiber/organic mat facers
- Manufactured with a standard 1/8, 1/4 or 1/2 inch per foot slope
- Available in 0.75" -4.0" average thickness (depends on slope)
- Ideal for built-up roof (BUR), modified bitumen or single ply membranes
- Provides positive roof drainage
- Free factory engineered takeoffs
- 25psi compressive strength available

Built-Up Roof (BUR) System

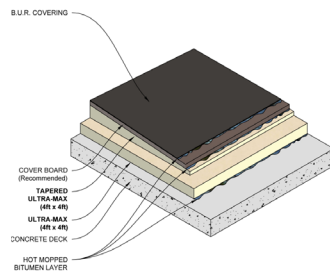

COMPLIANCES

- ASTM C1289 Type II, Class 1
- Factory Mutual (Class 1)
- UL Time Rated
- UL 790 Class A, UL 1256 Class A
- Miami Dade County
- Florida Product Approval
- IBC, IRC, IECC, ASHRAE 90.1
- City of LA

Tapered Ultra-Max®

- Inorganic, polymer coated glass fiber mat facers
- Manufactured with a standard 1/8, 1/4 or 1/2 inch per foot slope
- Available in 0.75" -4.0" average thickness (depends on slope)
- Ideal for built-up roof (BUR), modified bitumen or single ply membranes
- Provides positive roof drainage
- Free factory engineered takeoffs
- 25psi compressive strength available

Fully Adhered System

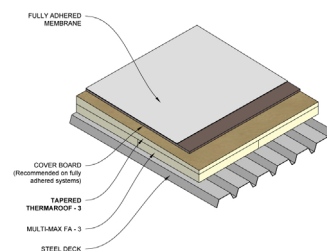

COMPLIANCES

- ASTM C1289 Type II, Class 2
- Factory Mutual (Class 1)
- UL Time Rated
- UL 790 Class A, UL 1256 Class A
- Miami Dade County
- Florida Product Approval
- IBC, IRC, IECC, ASHRAE 90.1
- City of LA

"Rmax is the easiest manufacturer I work with. They are quick with prices and customer service is wonderful"

- Victor Rodriguez,
ABC distribution



Nailable Base Polyiso Roof Insulation Products

Multi-Vent Nailable Base-3

- Foam insulation bonded to vent blocks and 7/16" OSB nailing surface
- Durable glass fiber/organic facer
- Available in 1.0" - 4.5" foam thicknesses
- Available with alternate nailing surfaces
- Available with 3/4" to 2" vent spacing
- Multi-directional vented system for use in residential or commercial steep slope roofing for maximum airflow
- Allows for normal expansion of wood
- Reduces thermal loss and moisture migration

Nailable Base-3

- Foam insulation bonded to a 7/16" OSB nailing surface
- Durable glass fiber/organic facer
- Available in 1.0" - 4.5" foam thicknesses
- Available with alternate nailing surfaces
- Roof cover attachment, e.g., concrete, slate or clay roofing tiles and standing seam metal roofing
- Allows for normal expansion of wood
- Reduces thermal loss

Shingles/Tiles/Shakes/Metal Panel System

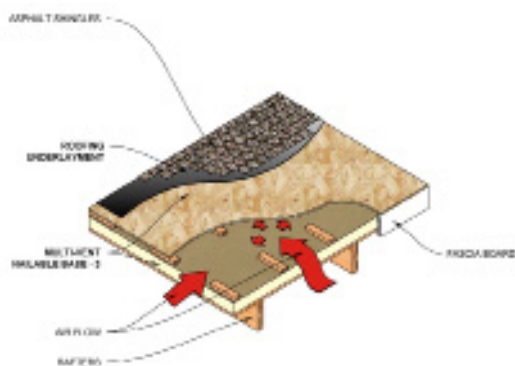

Mechanically Attached System

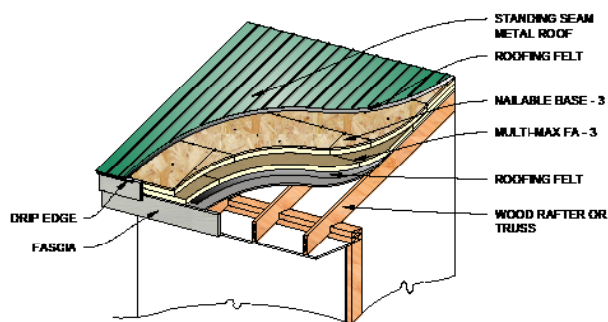

COMPLIANCES

- ASTM C1289 Type V
- IBC, IRC, IECC, ASHRAE 90.1
- CA Insulation Directory

COMPLIANCES

- ASTM C1289 Type V
- Factory Mutual (2" min)
- IBC, IRC, IECC, ASHRAE 90.1
- City of LA
- CA Insulation Directory

Long Term Thermal Resistance (LTTR) Values

"R" means resistance to heat flow. The higher the R-value, the greater the insulating power.

Nominal Thickness (Inches)	LTTR ¹	
	Ultra-Max® Ultra-Max® HD Multi-Max®FA-3 Re-Cover Board-3	Nailable Base-3 ²
0.5	2.5	----
1.0	5.7	----
1.1	6.3	----
1.2	6.8	----
1.3	7.4	----
1.4	8.0	----
1.5	8.6	6.3
1.6	9.1	6.9
1.7	9.7	7.4
1.75	10.0	7.7
1.8	10.3	8.0
1.9	10.8	8.6
2.0	11.4	9.2
2.1	12.0	9.7
2.2	12.6	10.3
2.3	13.2	10.9
2.4	13.8	11.4
2.5	14.4	12.0
2.6	15.0	12.6
2.7	15.6	13.2
2.8	16.2	13.8
2.9	16.8	14.4
3.0	17.4	15.0
3.1	18.0	15.6
3.2	18.6	16.2
3.3	19.2	16.8
3.4	19.9	17.4
3.5	20.5	18.0
3.6	21.1	18.6
3.7	21.7	19.2
3.8	22.3	19.8
3.9	23.0	20.5
4.0	23.6	21.1
4.1	24.2	21.7
4.2	24.9	22.3
4.3	25.5	22.9
4.4	26.1	23.6
4.5	26.8	24.2
4.6	----	24.8
4.7	----	25.5
4.8	----	26.1
4.9	----	26.7
5.0	----	27.4

Tapered Ultra-Max® and Tapered Thermaroof®-3

Slope (Taper Per Foot)	Panel Label	Dimensions (Inches)	LTTR ¹
1/16"	NN	0.5 to 0.75	3.6
	N	0.75 to 1.00	5.0
	OO	1.00 to 1.25	6.4
	O	1.25 to 1.50	7.8
	PP	1.50 to 1.75	9.3
	P	1.75 to 2.00	10.7
	RR	2.00 to 2.25	12.1
	R	2.25 to 2.50	13.6
1/8"	AA	0.50 to 1.00	4.3
	A	1.00 to 1.50	7.1
	B	1.50 to 2.00	10.0
	C	2.00 to 2.50	12.9
	D	2.50 to 3.00	15.9
	E	3.00 to 3.50	18.9
	F	3.50 to 4.00	22.1
3/16"	JJ	0.50 to 1.25	5.0
	J	1.00 to 1.75	7.8
	KK	1.25 to 2.00	9.3
	K	1.75 to 2.50	12.1
	LL	2.00 to 2.75	13.6
	L	2.50 to 3.25	16.6
	MM	2.75 to 3.50	18.2
	M	3.25 to 4.00	21.2
1/4"	X	0.50 to 1.50	5.7
	G	1.00 to 2.00	8.6
	Y	1.50 to 2.50	11.4
	H	2.00 to 3.00	14.4
	Z	2.50 to 3.50	17.4
	I	3.00 to 4.00	20.5
	ZZ	3.50 to 4.50	23.6
3/8"	SS	0.50 to 2.00	7.1
	S	1.00 to 2.50	10.0
	TT	2.00 to 3.50	15.9
1/2"	Q	0.50 to 2.50	8.6
	XX	1.00 to 3.00	11.4
	QQ	2.50 to 4.50	20.5

¹LTTR values are determined in accordance with CAN/ULC-S770. LTTR predicts a 15-year, time-weighted average.

²Nominal thicknesses and LTTR values include 7/16" OSB.

NOTE: LTTR values for Multi-Vent Nailable Base-3 are equivalent to corresponding foam thickness of Multi-Max® FA-3.



For warranties, limitations and conditions refer to Rmax Sales Policy and applicable warranties. All documents are located at www.rmax.com. For technical support, email technical@rmax.com. For sales support, pricing and availability, email rmax@rmax.com or call (800) 527-0890.

Proudly Made and Engineered in the U.S.A.



Rmax Sales Offices and Plant Locations

Central:

13524 Welch Road
Dallas, Texas 75244

Phone: 972-387-4500

Fax: 972-387-4673

Toll Free: 1-800-527-0890

East:

1649 South Batesville Road
Greer, South Carolina 29650

Phone: 864-297-1382

Fax: 864-234-7548

Toll Free: 1-800-845-4455

West:

210 Lyon Drive
Fernley, Nevada 89408

Phone: 775-575-4849

Fax: 775-575-5035

Toll Free: 1-800-762-9462

E-mail us at rmax@rmax.com or visit our website www.rmax.com