

Product Application Sheet

THERMASHEATH®

EXTERIOR DUCTWORK APPLICATION

Rmax Thermasheath® is suitable for use on the exterior side of existing ductwork. When the ductwork is solely on the exterior of the building, the insulation need only be protected from the outside weather conditions. As an example, this can be done with a waterproofing membrane installed per the manufacturer's recommendations.

Refer to Thermasheath® Product Data Sheet for additional application/installation, compliances, thermal and physical properties, limitations and warnings.

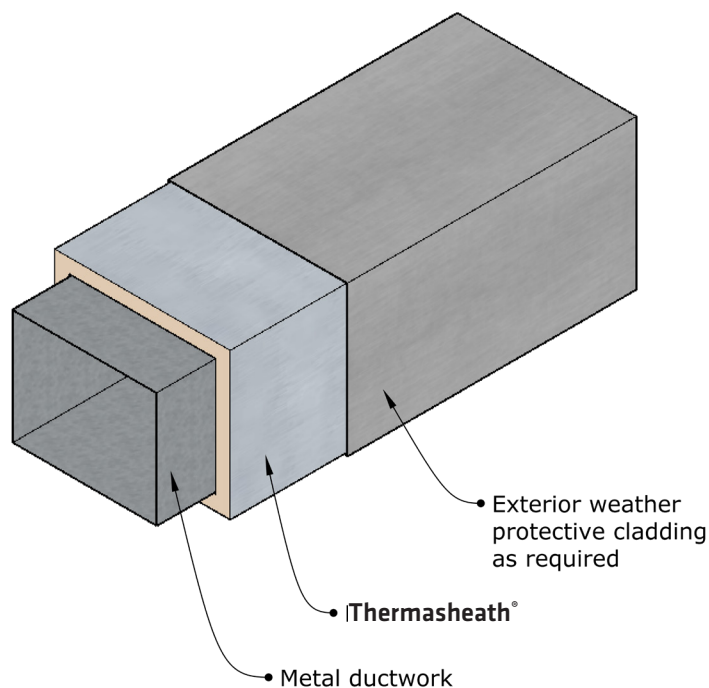
**WARRANTY**

See Rmax® sales policy and limited warranties for terms and conditions. Rmax® does not assume any responsibility or liability for the performance of any products other than those manufactured by Rmax®. **NOTE: Factory packaging should not be relied upon as protection at job sites or other outdoor storage locations. When short-term outdoor storage is necessary, take the following precautions: Store flat above ground on raised pallets, place bundles on finished surfaces, cover with a breathable tarpaulin and secure cover to prevent wind displacement.**