



# ROCKWOOL Acoustic Wall Assemblies Catalog



This Acoustics Wall Assemblies Catalog provides a comprehensive list of wall assemblies tested for their acoustic performance. This includes both STC and OITC ratings for steel and wood stud walls, considering both interior and exterior assemblies.

**Using this guide:**

All assemblies include component descriptions, STC, OITC, and R-values (if available). In addition, each assembly references a ROCKWOOL test number, as well as the ROCKWOOL products included in the tested assembly.



Acoustics		Assembly Number: ISS-00	
STC:	43	OITC:	28
Report No.	J2247-13-303-11-R0		
Assembly Components			
Finish material	5/8" Gypsum		
Size	2 1/2" Steel Stud		
Spacing	16" oc		
Product	AFB		
Thickness	1.5"		

**Insulation Included:**  
ROCKWOOL AFB



**Have questions about rated assemblies?**

Contact ROCKWOOL Technical services for more information on a particular assembly including Transmission Loss Curve data and other documentation.

Talk to us at **1-877-823-9790**, or by email at **techservice@rockwool.com**



Interior Steel Stud Assemblies  
STC Range

**40-57**

Pages 10-22

Interior Wood Stud Assemblies  
STC Range

**36-66**

Pages 23-31

Exterior Wood Stud Assemblies  
STC Range

**35-39**

Pages 32

Exterior Steel Stud Assemblies  
STC Range

**43-52**

Pages 33-37

# AFB®

## Acoustical Fire Batt Insulation

ROCKWOOL AFB® is a stone wool batt insulation for interior partitions in commercial constructions where superior fire resistance and acoustical performance are required. AFB is specifically designed to reduce sound transmission and provides exceptional acoustic comfort when installed in a wall assembly with gypsum boards and resilient channels.

- Excellent noise reduction and sound absorption to help you create quieter, more productive environments.
- Non-combustible and fire resistant, stone wool works to contain a fire and prevent its spread.
- Is available in thicknesses ranging from 1"-6" in order to fit in a variety of stud sizes
- AFB evo is also available as a no added formaldehyde product offering in order to meet the specific design standards

Visit [rockwool.com/products/afb](http://rockwool.com/products/afb) for more information



# Safe'n'Sound®

## Residential Fire and Soundproofing Insulation

ROCKWOOL Safe'n'Sound® is a stone wool batt insulation for interior partitions of wood and steel frame residential construction where superior fire resistance and acoustical performance is required. Safe'n'Sound has excellent acoustical dampening properties and provides an easy friction fit into walls, ceiling and floor applications. It is GREENGUARD Gold Certified and contributes to a healthier indoor environment.

- Excellent noise reduction and sound absorption to help you create quieter, more productive environments.
- Non-combustible and fire resistant, stone wool works to contain a fire and prevent its spread.
- Is available in thicknesses for wall, floor/ceiling and I-Joist applications to meet every design need
- Lightweight and easy to install

Visit [rockwool.com/products/safensound](https://rockwool.com/products/safensound) for more information



# Comfortbatt®

## Thermal Batt Insulation

ROCKWOOL Comfortbatt® is a semi-rigid stone wool thermal batt insulation for exterior wood and steel stud applications. It features a unique flexible edge that allows for easy installation and helps prevent over compression to maintain its R-value.

- Excellent thermal performance providing a high R-value per inch
- Non-combustible and fire resistant, stone wool works to contain a fire and prevent its spread.
- Excellent noise reduction and sound absorption to help you create quieter, more productive environments.
- Water resistant, stone wool does not rot or promote the growth of mildew, fungi or mold
- Lightweight and easy to install

Visit [rockwool.com/products/comfortbatt](http://rockwool.com/products/comfortbatt) for more information



# ROXUL Safe® 45

## Residential Party Wall Insulation

ROXUL Safe® 45 is a semi-rigid stone wool insulation board that is specifically engineered as a fire-blocking material for concealed spaces of multi-unit residential buildings. Using ROXUL Safe® 45 with our ROCKWOOL batt insulation creates a high-density “party” wall system that improves sound dampening and fire performance.

- Reduces the time, labor and material costs usually associated with adding a double layer of gypsum over the wall studs.
- ROXUL Safe® 45 complies with the fire-blocking National Building Code
- Is easy to install, and offers excellent water and moisture resistance

Visit [rockwool.com/north-america/products/roxul-safe-45](https://rockwool.com/north-america/products/roxul-safe-45) for more information



# Comfortboard® 80

## Exterior Wall Insulation: Thermal Insulated Sheathing

ROCKWOOL Comfortboard® 80 is a rigid stone wool board designed for continuous insulation applications. A non-structural sheathing product, Comfortboard 80 provides increased thermal performance to the building envelope. Vapor permeable, Comfortboard 80 has the added benefit of allowing fast outward drying. The insulation also reduces thermal loss resulting in improved long-term thermal performance.

- Fire resistant stone wool can withstand temperatures of approximately 2,150°F (1177°C).
- Vapor permeable enabling wall systems to have superior drying potential, minimizing the risk of condensation and water accumulation.
- Reduces thermal bridging through wood framing, leading to a higher-performing building envelope.
- excellent noise reduction and sound absorption to help you create quieter, more productive environments.

Visit [rockwool.com/products/Comfortboard-80](https://rockwool.com/products/Comfortboard-80) for more information





# Cavityrock®

## Exterior Wall Insulation: Rainscreens and Cavity Walls

ROCKWOOL Cavityrock® is a semi-rigid stone wool insulation board designed for exterior cavity wall and rainscreen applications. Compatible with numerous cladding attachment systems, Cavityrock is non-combustible and available with a black mat finish.

- Non-combustible and fire resistant, stone wool works to contain a fire and prevent its spread.
- Water resistant and allows for effective drainage from an exterior wall assembly.
- Available black mat finish provides masking for improved open-joint cladding system aesthetics.
- Compatible with a variety of cladding systems including Z-girts, masonry ties, and fiberglass and stainless steel clips.
- Durable inorganic material that does not rot or promote the growth of mildew, fungi or bacteria
- Vapor permeable enabling wall systems to have superior drying potential, minimizing the risk of condensation and water accumulation.

Visit [rockwool.com/products/cavityrock](https://rockwool.com/products/cavityrock) for more information



## Interior Steel Stud Assemblies

This section will outline interior assemblies using steel studs in various thicknesses, spacings, finishes, and any additional components. Assemblies will be organized by STC value ranging from an STC of 40 to an STC of 57.

STC  
**40**

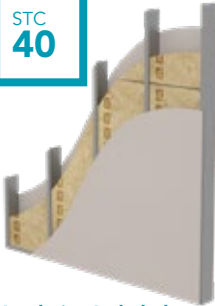

**Insulation Included:**  
ROCKWOOL AFB

Acoustics Assembly Number: ISS-01

STC: 40 OITC: 27 Report No. J2247-13-303-11-R0

### Assembly Components

Finish material	1/2" Gypsum
Size	3 5/8" Steel Stud
Spacing	16" oc
Product	AFB
Thickness	3"

STC  
**43**

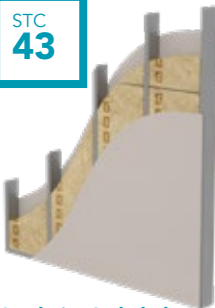

**Insulation Included:**  
ROCKWOOL AFB

Acoustics Assembly Number: ISS-02

STC: 43 OITC: 28 Report No. NWTL140828-03

### Assembly Components

Finish material	5/8" Gypsum
Size	3 5/8" Steel Stud
Spacing	16" oc
Product	AFB
Thickness	3.5"

STC  
**43**



**Insulation Included:**  
ROCKWOOL AFB

Acoustics Assembly Number: ISS-03

STC: 43 OITC: 28 Report No. J2247-14-303-11-R0

### Assembly Components

Finish material	5/8" Gypsum
Size	2 1/2" Steel Stud
Spacing	16" oc
Product	AFB
Thickness	1.5"

## Interior Steel Stud Assemblies



STC  
**43**

**Insulation Included:**  
ROCKWOOL AFB

Acoustics Assembly Number: ISS-04

STC: 43 OITC: 27 Report No. J2247-06-303-11-R0

### Assembly Components

Finish material	1/2" Gypsum
Size	6" Steel Stud
Spacing	16" oc
Product	AFB
Thickness	3"

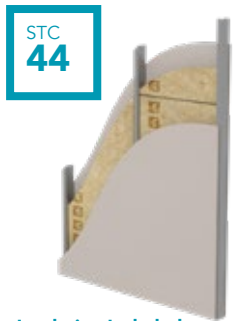

STC  
**44**

**Insulation Included:**  
ROCKWOOL AFB

Acoustics Assembly Number: ISS-05

STC: 44 Report No. RAL-TL90-197

### Assembly Components

Finish material	1/2" Gypsum
Size	2 1/2" Steel Stud
Spacing	24" oc
Product	AFB
Thickness	1"

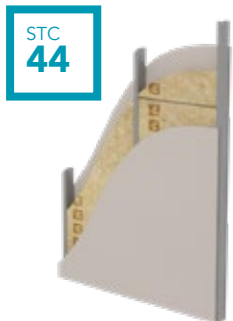

STC  
**44**

**Insulation Included:**  
ROCKWOOL AFB

Acoustics Assembly Number: ISS-06

STC: 44 Report No. RAL-TL96-285

### Assembly Components

Finish material	1/2" gypsum
Size	2 1/2" Steel Stud
Spacing	24" oc
Product	AFB
Thickness	2.5"

## Interior Steel Stud Assemblies

STC  
45

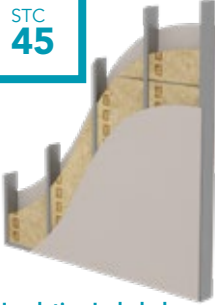

**Insulation Included:**  
ROCKWOOL AFB

Acoustics Assembly Number: ISS-07

STC: 45 OITC: 29 Report No. J2247-11-303-11-R0

### Assembly Components

Finish material	5/8" gypsum
Size	3 5/8" Steel Stud
Spacing	16" oc
Product	AFB
Thickness	3"

STC  
45

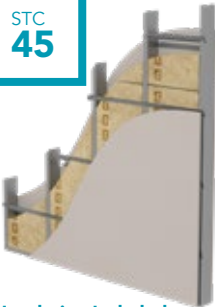

**Insulation Included:**  
ROCKWOOL AFB

Acoustics Assembly Number: ISS-08

STC: 45 OITC: 29 Report No. NWT140829-01

### Assembly Components

Finish material	5/8" gypsum
Size	3 5/8" Steel Stud
Spacing	16" oc
Product	AFB
Thickness	3.5"
Resilient Channels	RC Deluxe, 16" OC

STC  
45

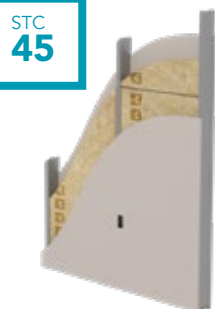

**Insulation Included:**  
ROCKWOOL AFB

Acoustics Assembly Number: ISS-09

STC: 45 Report No. RAL-TL03-303

### Assembly Components

Finish material	5/8" gypsum
Size	2 1/2" Steel Stud
Spacing	24" oc
Product	AFB
Thickness	1.5"
Penetrations	Electrical Boxes Included

## Interior Steel Stud Assemblies

STC  
45



**Insulation Included:**  
ROCKWOOL AFB

### Acoustics

Assembly Number: ISS-10

STC: 45 Report No. RAL-TL90-192

### Assembly Components

Finish material	1/2" Gypsum
Size	2 1/2" Steel Stud
Spacing	24" oc
Product	AFB
Thickness	1.5"

STC  
46



**Insulation Included:**  
ROCKWOOL AFB

### Acoustics

Assembly Number: ISS-11

STC: 46 Report No. RAL-TL90-195

### Assembly Components

Finish material	1/2" gypsum
Size	3 5/8" Steel Stud
Spacing	24" oc
Product	AFB
Thickness	1.5"

STC  
46



**Insulation Included:**  
ROCKWOOL AFB

### Acoustics

Assembly Number: ISS-12

STC: 46 Report No. RAL-TL02-212

### Assembly Components

Finish material	5/8" gypsum
Size	2 1/2" Steel Stud
Spacing	24" oc
Product	AFB
Thickness	1.5"

## Interior Steel Stud Assemblies

STC  
46



**Insulation Included:**  
ROCKWOOL AFB

Acoustics Assembly Number: ISS-13

STC: 46 Report No. RAL-TL96-270

### Assembly Components

Finish material	5/8" gypsum
Size	2 1/2" Steel Stud
Spacing	24" oc
Product	AFB
Thickness	2.5"

STC  
47

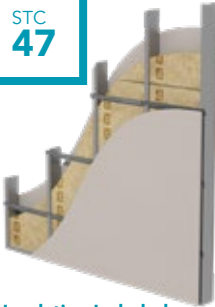

**Insulation Included:**  
ROCKWOOL AFB

Acoustics Assembly Number: ISS-14

STC: 47 OITC: 29 Report No. J2247-12-303-11-R0

### Assembly Components

Finish material	1/2" gypsum
Size	3 5/8" Steel Stud
Spacing	16" oc
Product	AFB
Thickness	3"
Resilient Channels	RC Deluxe, 16" OC

STC  
47

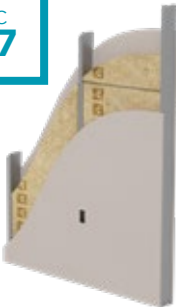

**Insulation Included:**  
ROCKWOOL AFB

Acoustics Assembly Number: ISS-15

STC: 47 Report No. RAL-TL03-306

### Assembly Components

Finish material	5/8" gypsum
Size	3 5/8" Steel Stud
Spacing	24" oc
Product	AFB
Thickness	3"
Penetrations	Electrical Boxes Included

## Interior Steel Stud Assemblies

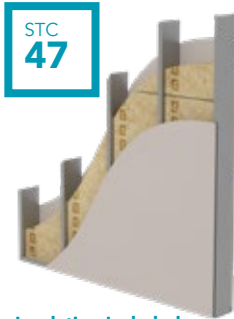

STC  
47

Acoustics Assembly Number: ISS-16

STC: 47 OITC: 29 Report No. J2247-05-303-11-R0

### Assembly Components

Finish material 1/2" Gypsum

Size 6" Steel Stud

Spacing 16" oc

Product AFB

Thickness 6"

**Insulation Included:**  
ROCKWOOL AFB

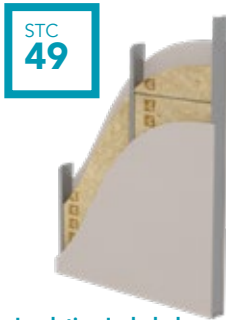

STC  
49

Acoustics Assembly Number: ISS-17

STC: 49 OITC: 30 Report No. NWTL140827-04

### Assembly Components

Finish material 5/8" gypsum

Size 3 5/8" Steel Stud

Spacing 24" oc

Product AFB

Thickness 3.5"

**Insulation Included:**  
ROCKWOOL AFB

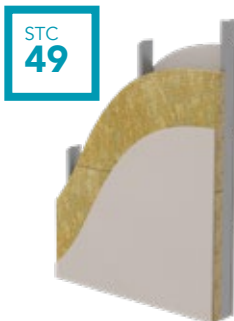

STC  
49

Acoustics Assembly Number: ISS-18

STC: 49 OITC: 32 Report No. NWTL140828-02

### Assembly Components

Finish material 5/8" gypsum

Size 3 5/8" Steel Stud

Spacing 24" oc

Product Comfortboard 80 (outboard, single side)

Thickness 3"

**Insulation Included:**  
ROCKWOOL Comfortboard 80  
(outboard, single side)

## Interior Steel Stud Assemblies

STC  
50



**Insulation Included:**  
ROCKWOOL AFB

Acoustics Assembly Number: ISS-19

STC: 50 OITC: 30 Report No. F0256.01B

### Assembly Components

Finish material	5/8" gypsum
Size	3 5/8" Steel Stud
Spacing	24" oc
Product	AFB
Thickness	3.5"

STC  
50



**Insulation Included:**  
ROCKWOOL 4 pcf mineral  
wool board insulation

Acoustics Assembly Number: ISS-20

STC: 50 OITC: 31 Report No. NWTL141118-04

### Assembly Components

Finish material	5/8" gypsum
Size	3 5/8" Steel Stud
Spacing	24" oc
Product	Minimum 4 pcf mineral wool board insulation (outboard, single side)
Thickness	3"

STC  
50

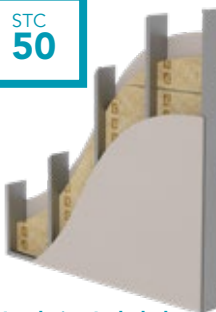

**Insulation Included:**  
ROCKWOOL AFB

Acoustics Assembly Number: ISS-21

STC: 50 OITC: 34 Report No. J2247-04-303-11-R0

### Assembly Components

Finish material	5/8" gypsum
Size	6" Steel Stud
Spacing	16" oc
Product	AFB
Thickness	3"



## Interior Steel Stud Assemblies

STC  
50



**Insulation Included:**  
ROCKWOOL AFB

### Acoustics

Assembly Number: ISS-22

STC: 50 Report No. RAL-TL90-186

### Assembly Components

Finish material	1/2" gypsum, 2x 1/2" gypsum on single side
Size	2 1/2" Steel Stud
Spacing	24" oc
Product	AFB
Thickness	1.5"

STC  
51



**Insulation Included:**  
ROCKWOOL AFB

### Acoustics

Assembly Number: ISS-23

STC: 51 Report No. RAL-TL96-269

### Assembly Components

Finish material	1/2" gypsum
Size	3 5/8" Steel Stud
Spacing	24" oc
Product	AFB
Thickness	3"

STC  
51



**Insulation Included:**  
ROCKWOOL AFB

### Acoustics

Assembly Number: ISS-24

STC: 51 OITC 31 Report No. NWTL141119-01

### Assembly Components

Finish material	5/8" gypsum
Size	3 5/8" Steel Stud
Spacing	24" oc
Product	AFB
Thickness	3"

## Interior Steel Stud Assemblies

STC  
52

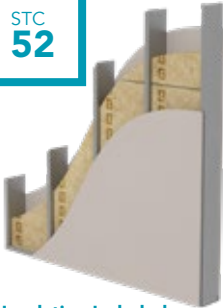

**Insulation Included:**  
ROCKWOOL AFB

Acoustics Assembly Number: ISS-25

STC: 52 OITC: 35 Report No. J2247-03-303-11-R0

### Assembly Components

Finish material 5/8" gypsum

Size 6" Steel Stud

Spacing 16" oc

Product AFB

Thickness 6"

STC  
53



**Insulation Included:**  
ROCKWOOL AFB

Acoustics Assembly Number: ISS-26

STC: 53 Report No. RAL-TL96-288

### Assembly Components

Finish material 1/2" gypsum

Size 3 5/8" Steel Stud

Spacing 24" oc

Product AFB

Thickness 3"

Resilient Channels Metal, 24" OC

STC  
53

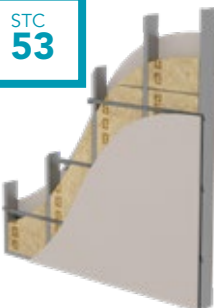

**Insulation Included:**  
ROCKWOOL AFB

Acoustics Assembly Number: ISS-27

STC: 53 OITC: 34 Report No. J2247.10-303-11-R0

### Assembly Components

Finish material 5/8" gypsum

Size 3 5/8" Steel Stud

Spacing 16" oc

Product AFB

Thickness 3"

Resilient Channels RC Deluxe, 16" OC

## Interior Steel Stud Assemblies

STC  
53



**Insulation Included:**  
ROCKWOOL AFB

### Acoustics

Assembly Number: ISS-28

STC: 53 Report No. RAL-TL90-185

### Assembly Components

Finish material	2x 1/2" gypsum
Size	2 1/2" Steel Stud
Spacing	24" oc
Product	AFB
Thickness	1.5"

STC  
54



**Insulation Included:**  
ROCKWOOL AFB

### Acoustics

Assembly Number: ISS-29

STC: 54 OITC 37 Report No. J2247.08-303-11-R0

### Assembly Components

Finish material	5/8" gypsum
Size	6" Steel Stud
Spacing	24" oc
Product	AFB
Thickness	3"
Resilient Channels	RC Deluxe, 16" OC

STC  
54

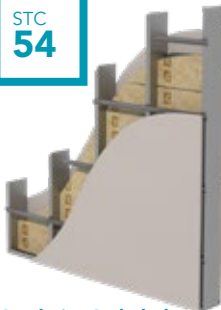

**Insulation Included:**  
ROCKWOOL AFB

### Acoustics

Assembly Number: ISS-30

STC: 54 OITC 35 Report No. J2247.02-303-11-R0

### Assembly Components

Finish material	5/8" gypsum
Size	6" Steel Stud
Spacing	16" oc
Product	AFB
Thickness	3"
Resilient Channels	RC Deluxe, 16" OC

## Interior Steel Stud Assemblies

STC  
55

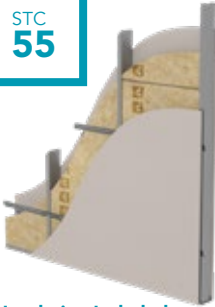

**Insulation Included:**  
ROCKWOOL AFB

Acoustics Assembly Number: ISS-31

STC: 55 Report No. RAL-TL96-289

### Assembly Components

Finish material	5/8" gypsum
Size	3 5/8" Steel Stud
Spacing	24" oc
Product	AFB
Thickness	3"
Resilient Channels	Metal, 24" OC

STC  
55



**Insulation Included:**  
ROCKWOOL AFB

Acoustics Assembly Number: ISS-32

STC: 55 OITC: 35 Report No. NWTL140827-03

### Assembly Components

Finish material	5/8" gypsum, 2x 5/8" gypsum on single side
Size	3 5/8" Steel Stud
Spacing	24" oc
Product	AFB
Thickness	3.5"

STC  
55



**Insulation Included:**  
ROCKWOOL AFB

Acoustics Assembly Number: ISS-33

STC: 55 Report No. RAL-TL02-296

### Assembly Components

Finish material	5/8" gypsum
Size	6" Steel Stud
Spacing	24" oc
Product	AFB
Thickness	6"

## Interior Steel Stud Assemblies



STC  
**56**

**Insulation Included:**  
ROCKWOOL AFB

Acoustics Assembly Number: ISS-34

STC: 56 Report No. RAL-TL96-264

### Assembly Components

Finish material	5/8" gypsum, 2x 5/8" gypsum on single side
Size	3 5/8" Steel Stud
Spacing	24" oc
Product	AFB
Thickness	3.5"



STC  
**56**

**Insulation Included:**  
ROCKWOOL AFB

Acoustics Assembly Number: ISS-35

STC: 56 Report No. RAL-TL90-196

### Assembly Components

Finish material	2x 1/2" gypsum
Size	3 5/8" Steel Stud
Spacing	24" oc
Product	AFB
Thickness	1.5"

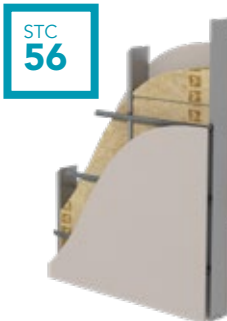

STC  
**56**

**Insulation Included:**  
ROCKWOOL AFB

Acoustics Assembly Number: ISS-36

STC: 56 OITC 39 Report No. J2247.07-303-11-R0

### Assembly Components

Finish material	5/8" gypsum
Size	6" Steel Stud
Spacing	24" oc
Product	AFB
Thickness	6"
Resilient Channels	RC Deluxe, 16" OC

## Interior Steel Stud Assemblies

STC  
**56**

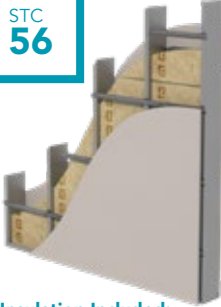

**Insulation Included:**  
ROCKWOOL AFB

Acoustics Assembly Number: ISS-37

STC: 56 OITC: 39 Report No. J2247.01-303-11-R0

### Assembly Components

Finish material	5/8" gypsum
Size	6" Steel Stud
Spacing	16" oc
Product	AFB
Thickness	6"
Resilient Channels	RC Deluxe, 16" OC

STC  
**56**



**Insulation Included:**  
ROCKWOOL AFB

Acoustics Assembly Number: ISS-38

STC: 56 Report No. RAL-TL90-193

### Assembly Components

Finish material	2x 5/8" gypsum
Size	2 1/2" Steel Stud
Spacing	24" oc
Product	AFB
Thickness	1.5"

STC  
**57**



**Insulation Included:**  
ROCKWOOL AFB

Acoustics Assembly Number: ISS-39

STC: 57 Report No. RAL-TL96-268

### Assembly Components

Finish material	2x 5/8" gypsum
Size	3 5/8" Steel Stud
Spacing	24" oc
Product	AFB
Thickness	3"

## Interior Wood Stud Assemblies

This section will outline interior assemblies using wood studs in various thicknesses, spacings, finishes, and any additional components. Assemblies will be organized by STC value ranging from an STC of 36 to an STC of 66.



**Insulation Included:**  
ROCKWOOL  
Safe'n'Sound/AFB

Acoustics		Assembly Number: IWS-15	
STC:	36	OITC:	27
Report No.	TL21-355		

Assembly Components	
Finish material	5/8" type X gypsum
Size	2x6 Wood Stud
Spacing	16" oc
Product	Safe'n'Sound/AFB
Thickness	3"
Wall Configuration	Single Stud



**Insulation Included:**  
ROCKWOOL Comfortbatt

Acoustics		Assembly Number: IWS-01	
STC:	37	Report No.	NGC 2011011

Assembly Components	
Finish material	5/8" type X gypsum
Size	2 x 4 Wood Stud
Spacing	16" oc
Product	Comfortbatt
Thickness	3.5"
Wall Configuration	Single Stud



**Insulation Included:**  
ROCKWOOL  
Safe'n'Sound/AFB

Acoustics		Assembly Number: IWS-16	
STC:	38	OITC:	28
Report No.	TL21-356		

Assembly Components	
Finish material	5/8" Type X gypsum
Size	2 x 6 Wood Stud
Spacing	16" oc
Product	Safe'n'Sound/AFB
Thickness	5.5"
Wall Configuration	Single Stud

## Interior Wood Stud Assemblies

STC  
**38**



**Insulation Included:**  
ROCKWOOL AFB

Acoustics Assembly Number: IWS-02

STC: 38 Report No. RAL-TL96-265

### Assembly Components

Finish material	5/8" gypsum
Size	2 x 4 Wood Stud
Spacing	16" oc
Product	AFB
Thickness	3"
Wall Configuration	Single Stud

STC  
**38**



**Insulation Included:**  
ROCKWOOL AFB

Acoustics Assembly Number: IWS-03

STC: 38 Report No. RAL-TL96-266

### Assembly Components

Finish material	1/2" gypsum
Size	2 x 4 Wood Stud
Spacing	16" oc
Product	AFB
Thickness	3"
Wall Configuration	Single Stud

STC  
**40**



**Insulation Included:**  
ROCKWOOL AFB

Acoustics Assembly Number: IWS-04

STC: 40 OITC: 32 Report No.

### Assembly Components

Finish material	2 x 5/8" gypsum
Size	2 x 4 Wood Stud
Spacing	16" oc
Product	AFB
Thickness	3"
Wall Configuration	Single Stud



## Interior Wood Stud Assemblies



**STC**  
**40**

**Insulation Included:**  
ROCKWOOL Comfortbatt

**Acoustics** Assembly Number: IWS-05

STC: 40 Report No. NGC 2011013

### Assembly Components

Finish material	1/2" gypsum
Size	2 x 4 Wood Stud
Spacing	16" oc
Product	Comfortbatt
Thickness	3.5"
Wall Configuration	Single Stud



**STC**  
**45**

**Insulation Included:**  
ROCKWOOL AFB

**Acoustics** Assembly Number: IWS-06

STC: 45 Report No. RAL-TL02-300

### Assembly Components

Finish material	5/8" gypsum
Size	2 x 6 Wood Stud
Spacing	24" oc
Product	AFB
Thickness	5.5"
Wall Configuration	Single Stud



**STC**  
**47**

**Insulation Included:**  
ROCKWOOL AFB

**Acoustics** Assembly Number: IWS-07

STC: 47 OITC: 33 Report No. K2356.06-303-11-R0

### Assembly Components

Finish material	5/8" gypsum
Size	2 x 4 Wood Stud
Spacing	16" oc
Product	AFB
Thickness	3"
Resilient Channels	RC Deluxe, 16" oc, Single Stud

## Interior Wood Stud Assemblies

STC  
**48**



**Insulation Included:**  
ROCKWOOL  
Safe'n'Sound/AFB

Acoustics Assembly Number: IWS-17

STC: 48 OITC: 31 Report No. TL21-358

### Assembly Components

Finish material 2x 5/8" Type X gypsum

Size 2 x 6 Wood Stud

Spacing 24" oc

Product Safe'n'Sound/AFB

Thickness 3"

Wall Configuration Single Stud

STC  
**48**



**Insulation Included:**  
ROCKWOOL  
Safe'n'Sound/AFB

Acoustics Assembly Number: IWS-18

STC: 48 OITC: 32 Report No. TL21-359

### Assembly Components

Finish material 2x 5/8" Type X gypsum

Size 2 x 6 Wood Stud

Spacing 24" oc

Product Safe'n'Sound/AFB

Thickness 5.5"

Wall Configuration Single Stud

STC  
**49**

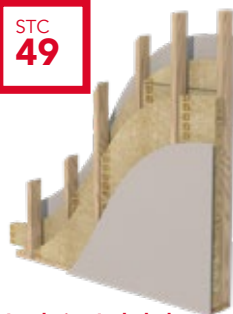

**Insulation Included:**  
ROCKWOOL Comfortbatt

Acoustics Assembly Number: IWS-08

STC: 49 Report No. NGC 2011015

### Assembly Components

Finish material 1/2" gypsum

Size 2 x 4 Wood Stud

Spacing 24" oc

Product Comfortbatt

Thickness 2.5" per row

Wall Configuration Staggered Studs

## Interior Wood Stud Assemblies



**Insulation Included:**  
ROCKWOOL  
Safe'n'Sound/AFB

Acoustics Assembly Number: IWS-19

STC: 50 OITC: 35 Report No. TL21-351

### Assembly Components

Finish material	5/8" Type X gypsum
Size	2 x 4 Wood Stud
Spacing	16" oc
Product	Safe'n'Sound/AFB
Thickness	3" per row, notched at opposing stud
Wall Configuration	Staggered Studs

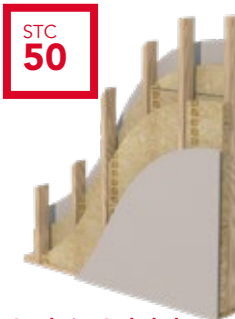

**Insulation Included:**  
ROCKWOOL Comfortbatt

Acoustics Assembly Number: IWS-09

STC: 50 Report No. NGC 2011014

### Assembly Components

Finish material	5/8" type X gypsum
Size	2 x 4 Wood Stud
Spacing	24" oc
Product	Comfortbatt
Thickness	2.5" per row
Wall Configuration	Staggered Studs



**Insulation Included:**  
ROCKWOOL AFB

Acoustics Assembly Number: IWS-10

STC: 51 Report No. NGC 2011016

### Assembly Components

Finish material	5/8" type X gypsum
Size	2 x 4 Wood Stud
Spacing	24" oc
Product	AFB
Thickness	2" per row
Wall Configuration	Staggered Studs

## Interior Wood Stud Assemblies

**STC**  
**52**



**Insulation Included:**  
ROCKWOOL Comfortbatt

**Acoustics** Assembly Number: IWS-11

STC: 52 Report No. NGC 2010072

### Assembly Components

Finish material	1/2" gypsum
Size	2 x 4 Wood Stud
Spacing	16" oc
Product	Comfortbatt
Thickness	3.5" per row
Wall Configuration	Double Stud with 1" Air Gap

**STC**  
**53**



**Insulation Included:**  
ROCKWOOL  
Safe'n'Sound/AFB

**Acoustics** Assembly Number: IWS-20

STC: 53 OITC: 37 Report No. TL21-357

### Assembly Components

Finish material	5/8" Type X gypsum
Size	2 x 6 Wood Stud
Spacing	16" oc
Product	Safe'n'Sound/AFB
Thickness	5.5"
Wall Configuration	Single Stud
Resilient Channels	24" oc

**STC**  
**54**



**Insulation Included:**  
ROCKWOOL  
Safe'n'Sound/AFB

**Acoustics** Assembly Number: IWS-21

STC: 54 OITC: 48 Report No. TL21-353

### Assembly Components

Finish material	2x 5/8" Type X gypsum
Size	2 x 4 Wood Stud
Spacing	24" oc
Product	Safe'n'Sound/AFB
Thickness	3" per row, notched at opposing stud
Wall Configuration	Staggered Studs

## Interior Wood Stud Assemblies



STC  
**56**

**Insulation Included:**  
ROCKWOOL Safe'n'Sound

**Acoustics** **Assembly Number: IWS-12**

STC: 56 Report No. NGC 2010071

### Assembly Components

Finish material 5/8" type X gypsum

Size 2 x 4 Wood Stud

Spacing 16" oc

Product Safe'n'Sound

Thickness 3" per row

Wall Configuration Double Stud with 1" Air Gap



STC  
**57**

**Insulation Included:**  
ROCKWOOL  
Safe'n'Sound/AFB

**Acoustics** **Assembly Number: IWS-22**

STC: 57 OITC: 38 Report No. TL21-352

### Assembly Components

Finish material 5/8" Type X gypsum

Size 2 x 4 Wood Stud

Spacing 16" oc

Product Safe'n'Sound/AFB

Thickness 3" per row, notched at opposing stud

Wall Configuration Staggered Studs

Resilient Channels 24" oc



STC  
**58**

**Insulation Included:**  
ROCKWOOL Comfortbatt  
ROXUL Safe 45

**Acoustics** **Assembly Number: IWS-13**

STC: 58 OITC: 33 Report No. NGC 2010070

### Assembly Components

Finish material 5/8" type X gypsum

Size 2 x 4 Wood Stud

Spacing 16" oc

Product Comfortbatt

Thickness 3.5" per row

Wall Configuration Double Stud with 1" ROXUL Safe 45

## Interior Wood Stud Assemblies

**STC**  
**60**



**Insulation Included:**  
ROCKWOOL Comfortbatt

**Acoustics** Assembly Number: IWS-14

STC: 60 Report No. NGC 2010069

### Assembly Components

Finish material 5/8" type X gypsum

Size 2 x 4 Wood Stud

Spacing 16" oc

Product Comfortbatt

Thickness 3.5" per row

Wall Configuration Double Stud with 1" Air Gap

**STC**  
**61**



**Insulation Included:**  
ROCKWOOL  
Safe'n'Sound/AFB

**Acoustics** Assembly Number: IWS-23

STC: 61 OITC: 46 Report No. TL21-360

### Assembly Components

Finish material 2x 5/8" Type X gypsum

Size 2 x 6 Wood Stud

Spacing 24" oc

Product Safe'n'Sound/AFB

Thickness 5.5"

Wall Configuration Single Stud

Resilient Channels 24" oc

**STC**  
**66**



**Insulation Included:**  
ROCKWOOL  
Safe'n'Sound/AFB

**Acoustics** Assembly Number: IWS-24

STC: 66 OITC: 50 Report No. TL21-349

### Assembly Components

Finish material 2x 5/8" Type X gypsum

Size 2 x 4 Wood Stud

Spacing 16" oc

Product Safe'n'Sound/AFB

Thickness 3" per row

Wall Configuration Double Stud with 1" Air Gap

## Interior Wood Stud Assemblies



STC  
**66**

**Insulation Included:**  
ROCKWOOL  
Safe'n'Sound/AFB

**Acoustics** Assembly Number: IWS-25

STC: 66 OITC: 52 Report No. TL21-350

### Assembly Components

Finish material 2x 5/8" Type X gypsum

Size 2 x 4 Wood Stud

Spacing 24" oc

Product Safe'n'Sound/AFB

Thickness 3" per row

Wall Configuration Double Stud with 1" Air Gap



STC  
**66**

**Insulation Included:**  
ROCKWOOL  
Safe'n'Sound/AFB

**Acoustics** Assembly Number: IWS-26

STC: 66 OITC: 51 Report No. TL21-354

### Assembly Components

Finish material 2x 5/8" Type X gypsum

Size 2 x 4 Wood Stud

Spacing 24" oc

Product Safe'n'Sound/AFB

Thickness 3" per row, notched at opposing stud

Wall Configuration Staggered Studs, on 2x6 plates

Resilient Channels 16" oc

### Looking for building science support?

ROCKWOOL is here to help with a full range of building modeling to help with your project.

Visit: [rockwool.com/buildingscience](https://rockwool.com/buildingscience) for more information



## Exterior Wood Stud Assemblies

This section will outline exterior assemblies using wood studs in various thicknesses, spacings, finishes, and any additional components. Assemblies will be organized by STC value ranging from an STC of 35 to an STC of 39.

STC  
**35**



**Insulation Included:**  
ROCKWOOL Comfortbatt

Acoustics Assembly Number: EWS-01

STC: 35 OITC: 27 Report No. H5383.01-113-11-R0

### Assembly Components

Finish material	5/8" gypsum
Size	2 x 6 Wood Stud
Spacing	16" oc
Product	Comfortbatt
Thickness	6"
Sheathing	1/2 plywood with Air Barrier
Continuous Insulation	.
Insulation Thickness	.
Insulation Fastening	.

STC  
**39**



**Insulation Included:**  
ROCKWOOL Comfortbatt  
ROCKWOOL Comfortboard 80

Acoustics Assembly Number: EWS-02

STC: 39 OITC: 29 Report No. H5383.02-113-11-R0

### Assembly Components

Finish material	5/8" gypsum
Size	2 x 6 Wood Stud
Spacing	16" oc
Product	Comfortbatt
Thickness	6"
Sheathing	1/2 plywood with Air Barrier
Continuous Insulation	Comfortboard 80
Insulation Thickness	1.5
Insulation Fastening	Furring Strips



## Exterior Steel Stud Assemblies

This section will outline exterior assemblies using steel studs in various thicknesses, spacings, finishes, and any additional components. Assemblies will be organized by STC value ranging from an STC of 43 to an STC of 52.

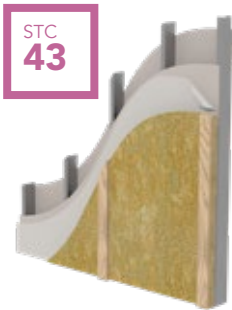

**Insulation Included:**  
ROCKWOOL  
Comfortboard 110

Acoustics		Assembly Number: ESS-01	
STC:	43	OITC:	30
Report No.	H5383.06-113-11-R0		
Assembly Components			
Finish material	5/8" gypsum		
Size	3 5/8" Steel Stud		
Spacing	16" oc		
Batt Product	.		
Thickness	.		
Sheathing	1/2" gypsum with Air Barrier		
Continuous Insulation	Comfortboard 110		
Insulation Thickness	1"		
Insulation Fastening	Furring Strips		
Cladding	None		



**Insulation Included:**  
ROCKWOOL Cavityrock

Acoustics		Assembly Number: ESS-02	
STC:	44	OITC:	29
Report No.	96973.01-113-11		
Assembly Components			
Finish material	1/2" gypsum		
Size	6" Steel Stud		
Spacing	16" oc		
Batt Product	.		
Thickness	.		
Sheathing	5/8" gypsum with Air Barrier		
Continuous Insulation	Cavityrock		
Insulation Thickness	3"		
Insulation Fastening	Z-girts		
Cladding	5/16" Cement Board		

## Exterior Steel Stud Assemblies

STC  
47

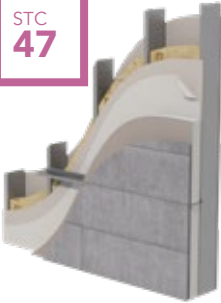

**Insulation Included:**  
ROCKWOOL Comfortbatt  
Polyiso Insulation

Acoustics Assembly Number: ESS-03

STC: 47 OITC: 30 Report No. 96641.01-113-11

### Assembly Components

Finish material	1/2" gypsum
Size	6" Steel Stud
Spacing	16" oc
Batt Product	Comfortbatt
Thickness	6"
Sheathing	5/8" gypsum with Air Barrier
Continuous Insulation	Polyiso
Insulation Thickness	3"
Insulation Fastening	Z-girts
Cladding	5/16" Cement Board

STC  
48



**Insulation Included:**  
ROCKWOOL Comfortbatt

Acoustics Assembly Number: ESS-04

STC: 48 OITC: 30 Report No. 96642.01-113-11

### Assembly Components

Finish material	1/2" gypsum
Size	6" Steel Stud
Spacing	16" oc
Batt Product	Comfortbatt
Thickness	6"
Sheathing	5/8" gypsum with Air Barrier
Continuous Insulation	Air Gap
Insulation Thickness	
Insulation Fastening	Z-girts
Cladding	5/16" Cement Board

## Exterior Steel Stud Assemblies

STC  
49



**Insulation Included:**  
ROCKWOOL Comfortbatt  
ROCKWOOL Cavityrock

### Acoustics

Assembly Number: ESS-05

STC: 49 OITC: 32 Report No. H5383.03-113-11-R0

### Assembly Components

Finish material	5/8" gypsum
Size	3 5/8" Steel Stud
Spacing	16" oc
Batt Product	Comfortbatt
Thickness	3.5"
Sheathing	5/8" gypsum with Air Barrier
Continuous Insulation	Cavityrock
Insulation Thickness	2"
Insulation Fastening	Z-girts
Cladding	None

STC  
49

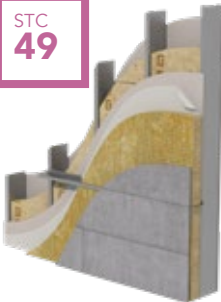

**Insulation Included:**  
ROCKWOOL Comfortbatt  
ROCKWOOL Cavityrock

### Acoustics

Assembly Number: ESS-06

STC: 49 OITC: 32 Report No. 97175.01-113-11

### Assembly Components

Finish material	5/8" gypsum
Size	6" Steel Stud
Spacing	16" oc
Batt Product	Comfortbatt
Thickness	6"
Sheathing	5/8" gypsum with Air Barrier
Continuous Insulation	Cavityrock
Insulation Thickness	3"
Insulation Fastening	Z-girts
Cladding	5/16" Cement Board

## Exterior Steel Stud Assemblies

STC  
50



**Insulation Included:**  
ROCKWOOL Comfortbatt  
ROCKWOOL Cavityrock

### Acoustics

Assembly Number: ESS-07

STC: 50 OITC: 31 Report No. 96644.01-113-11

### Assembly Components

Finish material	1/2" gypsum
Size	6" Steel Stud
Spacing	16" oc
Batt Product	Comfortbatt
Thickness	6"
Sheathing	5/8" gypsum with Air Barrier
Continuous Insulation	Cavityrock
Insulation Thickness	3"
Insulation Fastening	Z-girts
Cladding	5/16" Cement Board

STC  
51

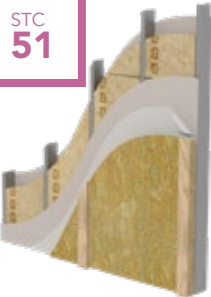

**Insulation Included:**  
ROCKWOOL Comfortbatt  
ROCKWOOL  
Comfortboard 110

### Acoustics

Assembly Number: ESS-08

STC: 51 OITC: 32 Report No. H5383.05-113-11-R0

### Assembly Components

Finish material	5/8" gypsum
Size	3 5/8" Steel Stud
Spacing	16" oc
Batt Product	Comfortbatt
Thickness	3.5"
Sheathing	1/2" gypsum with Air Barrier
Continuous Insulation	Comfortboard 110
Insulation Thickness	1"
Insulation Fastening	Furring Strips
Cladding	None

## Exterior Steel Stud Assemblies

STC  
51



**Insulation Included:**  
ROCKWOOL Comfortbatt  
ROCKWOOL Cavityrock

### Acoustics

Assembly Number: ESS-09

STC: 51 OITC: 35 Report No. 97176.01-113-11

### Assembly Components

Finish material	2x 5/8" gypsum
Size	6" Steel Stud
Spacing	16" oc
Batt Product	Comfortbatt
Thickness	6"
Sheathing	5/8" gypsum with Air Barrier
Continuous Insulation	Cavityrock
Insulation Thickness	3"
Insulation Fastening	Z-girts
Cladding	5/16" Cement Board

STC  
52



**Insulation Included:**  
ROCKWOOL Comfortbatt  
ROCKWOOL  
Comfortboard 110

### Acoustics

Assembly Number: ESS-10

STC: 52 OITC: 33 Report No. H5383.04-113-11-R0

### Assembly Components

Finish material	5/8" gypsum
Size	3 5/8" Steel Stud
Spacing	16" oc
Batt Product	Comfortbatt
Thickness	3.5"
Sheathing	5/8" gypsum with Air Barrier
Continuous Insulation	Comfortboard 110
Insulation Thickness	2"
Insulation Fastening	Furring Strips
Cladding	None





At the ROCKWOOL Group, we are committed to enriching the lives of everyone who comes into contact with our solutions. Our expertise is perfectly suited to tackle many of today's biggest sustainability and development challenges, from energy consumption and noise pollution to fire resilience, water scarcity and flooding. Our range of products reflects the diversity of the world's needs, while supporting our stakeholders in reducing their own carbon footprint.

Stone wool is a versatile material and forms the basis of all our businesses. With more than 11,000 employees in 39 countries, we are the world leader in stone wool solutions, from building insulation to acoustic ceilings, external cladding systems to horticultural solutions, engineered fibres for industrial use to insulation for the process industry and marine and offshore.

AFB®, Cavityrock®, Comfortbatt®, Comfortboard®, Conrock®, Curtainrock®, ROXUL Safe®, Rockboard®, Toprock®, Monoboard®, ROXUL® are registered trademarks of the ROCKWOOL Group in USA and ROXUL Inc. in Canada.

ROCKWOOL™, Fabrock™ are trademarks of the ROCKWOOL Group in USA and ROXUL Inc. in Canada.

SAFE'n'SOUND® is a registered trademark used under license by Masonite Inc.

05-2022



**ROCKWOOL**  
8024 Esquesing Line  
Milton, ON L9T 6W3  
Tel: 1 800 265 6878  
rockwool.com