

Sole/Top Plate-to-Rim Fastening

Strong-Drive® SDWV SOLE-TO-RIM Screw

Sole-to-Rim Attachment

The Simpson Strong-Tie SDWV Sole-to-Rim structural wood screws may be used to attach a sole plate to a rim board according to the following table. The SDWV Sole-to-Rim screw coating is intended for dry service, low-corrosion applications and is suitable for use with FRT in dry-service conditions.

Features:

- Large 0.400"-diameter head for increased holding power
- Fast start point with helical ridge for fast, easy, low-torque installation
- Variable thread design, optimized for 2x nominal dimension lumber

Code/Standards: IAPMO UES ER-192 (including City of LA Supplement), State of Florida FL13975

For more information, see p. 107, C-F-2023 Fastening Systems catalog

SDWV Sole-to-Rim Screw — Allowable Shear Loads for Sole-to-Rim Connection



Length (in.)	Model No.	Nominal Sole Plate Thickness (in.)	Minimum Penetration into Rim Board (in.)	Reference Allowable Loads (lb.) per Screw							
				2x Min. DFL/SP Rim Board		2x Min. SPF/HF Rim Board		1 1/4" Min. LVL Rim Board		1 1/4" Min. LSL Rim Board	
				DFL/SP Sole Plate	SPF/HF Sole Plate	DFL/SP Sole Plate	SPF/HF Sole Plate	DFL/SP Sole Plate	SPF/HF Sole Plate	DFL/SP Sole Plate	SPF/HF Sole Plate
4	SDWV13400	2x	1.75	220	175	165	160	185	165	185	175

1. Allowable loads are based on testing per ICC-ES AC233 and are limited to parallel-to-grain loading. The equivalent specific gravity for the LVL and LSL having a minimum 0.8E designation for edge fastening is 0.50.
2. Allowable loads are shown at the wood load duration factor of $C_D = 1.00$. Loads may be increased for load duration a permitted by the building code up to a $C_D = 1.60$.
3. Minimum spacing of the SDWV is 6" o.c., minimum end distance is 6", and minimum edge distance is 5/8".
4. Wood structural panel up to 3/4" thick is permitted between the sole plate and rim board provided it is fastened to the rim board per code and the minimum penetration of the screw into the rim board is met.
5. Minimum rim board height shall be 9 1/4" when fastening a sole plate and a single top plate to the rim board with SDWV screws.
6. Sole-to-rim loads can be achieved without a wall below.

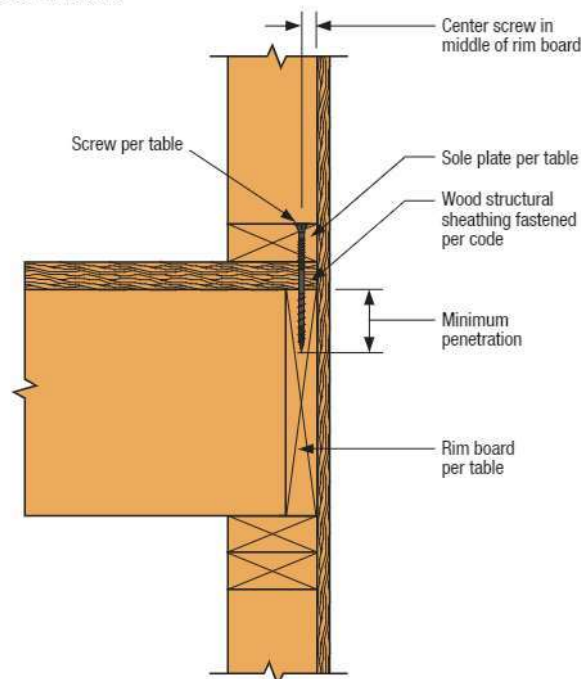

Sole-to-Rim Board Assembly
(other fasteners not shown for clarity)