

Steel Strong-Wall® Anchor Bolt Templates

Simpson Strong-Tie has developed a reusable anchor bolt template for common foundation types for the Steel Strong-Wall. The templates help to accurately locate the SSWAB preassembled anchor bolts, which simplifies installation and greatly reduces the chances of voids in the concrete. In addition, Simpson Strong-Tie offers anchor bolt stabilizers that enable the Steel Strong-Wall anchorage to be installed without being tied to the footing rebar cage by helping to eliminate movement of the anchor bolts during concrete placement. Two bolt stabilizers are used for each SSW anchor assembly: one at the embedded plate washer and the other above the template. Half-inch diameter dowels (not supplied) are then driven down through the bolt stabilizers and into the ground to ensure plumb installation of the anchors and prevent movement during concrete placement. Immediately following concrete placement, the dowels are removed and reused in other locations.

Anchor Bolt Templates

Steel Strong-Wall Model No.	Width (in.)	Anchor Bolt Stabilizer Model No.	Steel Strong-Wall Template Model			
			Reversible	Panel Form	Brick Ledge	Extended Leg
SSW12	12	SSWBS12	SSWT12	SSWTPF12	SSWTBL12	SSWTEL12
SSW15	15	SSWBS15	SSWT15	SSWTPF15	SSWTBL15	SSWTEL15
SSW18	18	SSWBS18	SSWT18	SSWTPF18	SSWTBL18	SSWTEL18
SSW21	21	SSWBS21	SSWT21	SSWTPF21	SSWTBL21	SSWTEL21
SSW24	24	SSWBS24	SSWT24	SSWTPF24	SSWTBL24	SSWTEL24

1. The height of the garage curb above the garage slab is critical for rough header opening at garage return wall.
2. See Garage Header Rough Opening Height table on p. 47.
3. Templates are recommended and are required in some jurisdictions.
4. Foundation design by designer.
5. Reversible, panel form and brick ledge templates are the same for 4" or 6"-thick walls.

An additional nut for template installation is provided with each SSWAB. It may also be used for SSW installation.

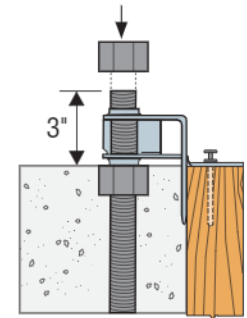

Anchor Bolt Height (Exterior)

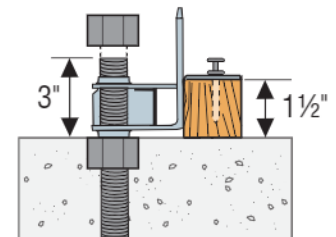

Anchor Bolt Height (Interior)

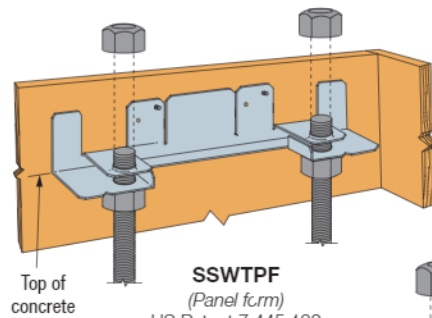

SSWTPF
(Panel form)
US Patent 7,445,192

*SSWTXX templates are reversible.
Use the same template for interior or exterior applications

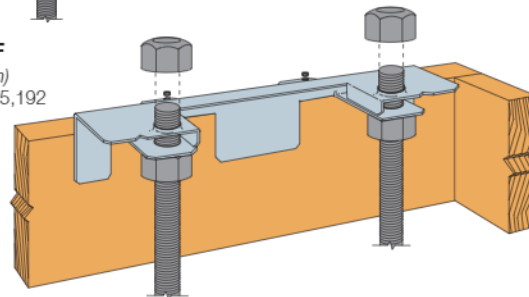

SSWT Exterior Installation*
(May be used for steel form systems)
US Patent 7,445,192

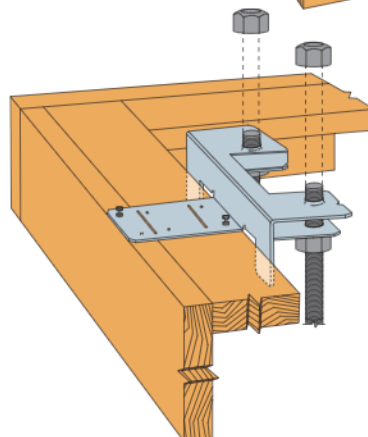

SSWTBL
(Brick ledge)
US Patent 7,445,192

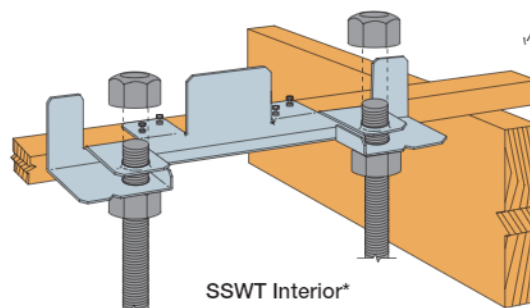

SSWT Interior*
Installation
US Patent 7,445,192

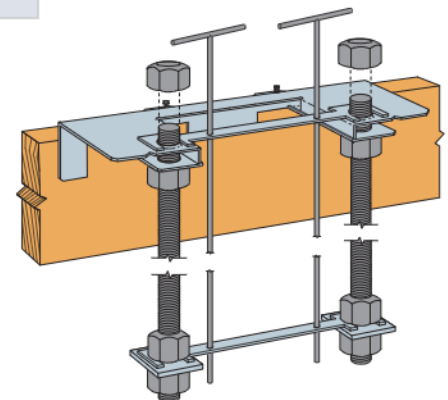

SSWTEL with Anchor Bolt Stabilizers
(Extended Leg)

Allows for placement of Steel Strong-Wall flush with inside face of 2x6 framed exterior wall
US Patent 7,445,192

(Anchor bolt stabilizers are sold separately.
Optional T-shape dowel by others.)