

Back-to-Back Installations on Concrete Foundations

The Strong-Wall® high-strength wood shearwall may be installed in a back-to-back orientation in residential, multi-family and light-commercial applications or cases where maximum allowable loads are required and a special moment frame might otherwise be specified. The allowable ASD shear loads for back-to-back installations may be taken as twice those listed for standard applications in the table on pp. 14–15. Double 2x8 top plates are required for standard applications and a minimum 7" x 11¼" header is required for single- or double-portal applications depending upon loading and span requirements. Back-to-back anchorage solutions for spread footings and reinforced grade beam foundations are provided in detail sheets WSWH1.2 and WSWH1.3, and may be downloaded in PDF, DWG or DXF format at strongtie.com.

Codes ICC-ES ESR-2652, City of LA Building Code Supplement and State of Florida FL5113

For product data and naming scheme, see pp. 12–13.

Installation

- Portal-frame connection kit is required for portal frame applications (one WSWH-PK kit required for both panels; straps installed on outside panel faces only).
- Allowable out-of-plane loads listed on p. 16 for single-story walls on concrete foundations shall apply and may not be increased.
- See garage header rough opening height table on p. 17.
- All panels may be field trimmed to a minimum of 74½". Trim height from top of panel only, do not trim from sides or bottom. Drilling holes in the Strong-Wall high-strength wood shearwall is not permitted except as shown on p. 36.
- Anchor bolt nuts should be finger tight plus ½ turn.
- Maximum shim thickness between the shearwall and top plates or header is 7⁄8". For additional thicknesses, see detail 9/WSWH2 on p. 35.
- Top connection installs with a combination of ¼" x 6" SDS Heavy-Duty Connector screws and SWS16150 Strong-Wall screws. See details 7/WSWH2 and 3/WSWH4 on pp. 33 and 38 for standard and portal applications, respectively.

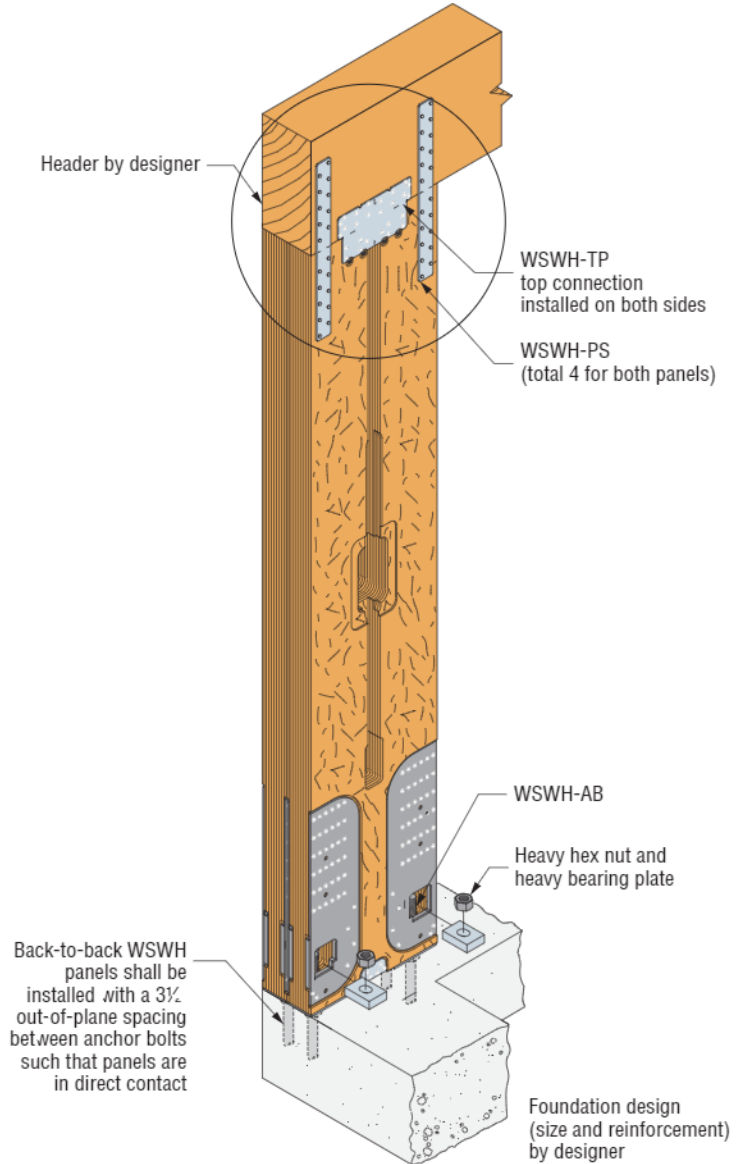

Back-to-Back Portal Installation (Standard Installation Similar)

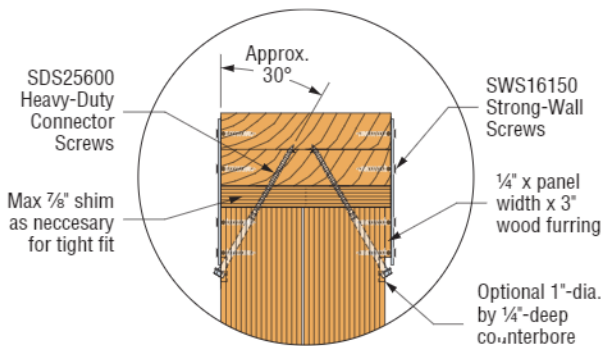
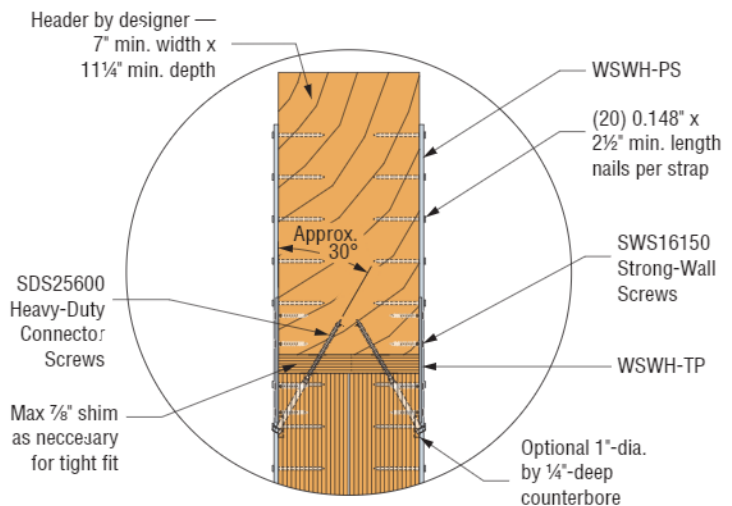

Top Connection for Back-to-Back Standard Installation

Top Connection for Back-to-Back Portal Installation