

SOUDAL

BUILD THE FUTURE

The Soudal Group is the largest independent European manufacturer of sealants, adhesives and polyurethane foams for professional and private users. This Belgian family business, based in Turnhout and founded by Vic Swerts in 1966, has developed into an international player and expert in chemical construction specialities.

The group has 23 production branches on 5 continents, sales offices in 45 different countries and employs around 3,654 people worldwide. A long-term vision for innovation – with substantial investment in R&D – and adaptations to local market requirements have resulted in the success of the Soudal Group.

The research in and development of new products, product technologies and production methods is in our genes. A team of highly qualified researchers, engineers and technicians is continuously working on the development of new products and applications adapted to the specific requirements of customers in various countries. This has resulted in a number of pioneering innovative products, which have helped to strengthen the market position of Soudal. Innovation is, therefore, the driver for organic growth at the Soudal Group.

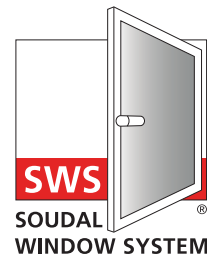

YOUR AIRTIGHT SOLUTION FOR INSULATING PROBLEMS



SOUDAL WINDOW SYSTEM YOUR AIRTIGHT SOLUTION



VAPOR TIGHT AND AIRTIGHT
SUSTAINABLE THERMAL AND ACOUSTIC INSULATION
WEATHERPROOF

SOUDAL

SOUDAL

Soudal Accumetric
350 Ring Road • Elizabethtown - KY 42701 • USA
Tel.: +1-877-873-8739 • info@soudalusa.com • www.soudalusa.com

SOUDAL

SWS / 111121

SOUDAL WINDOW SYSTEM

With heating and cooling costs skyrocketing, leaky buildings can be a big drain on a homeowner's budget. Air leakages (in- and exfiltration) are a big waste of energy and money, as are uninsulated or under insulated windows. Installing energy-efficient windows and doors can greatly reduce this energy loss, but the area around the window and door frames is often overlooked, still resulting in air leakages and thermal bridges. Your new windows will never perform well without proper installation!

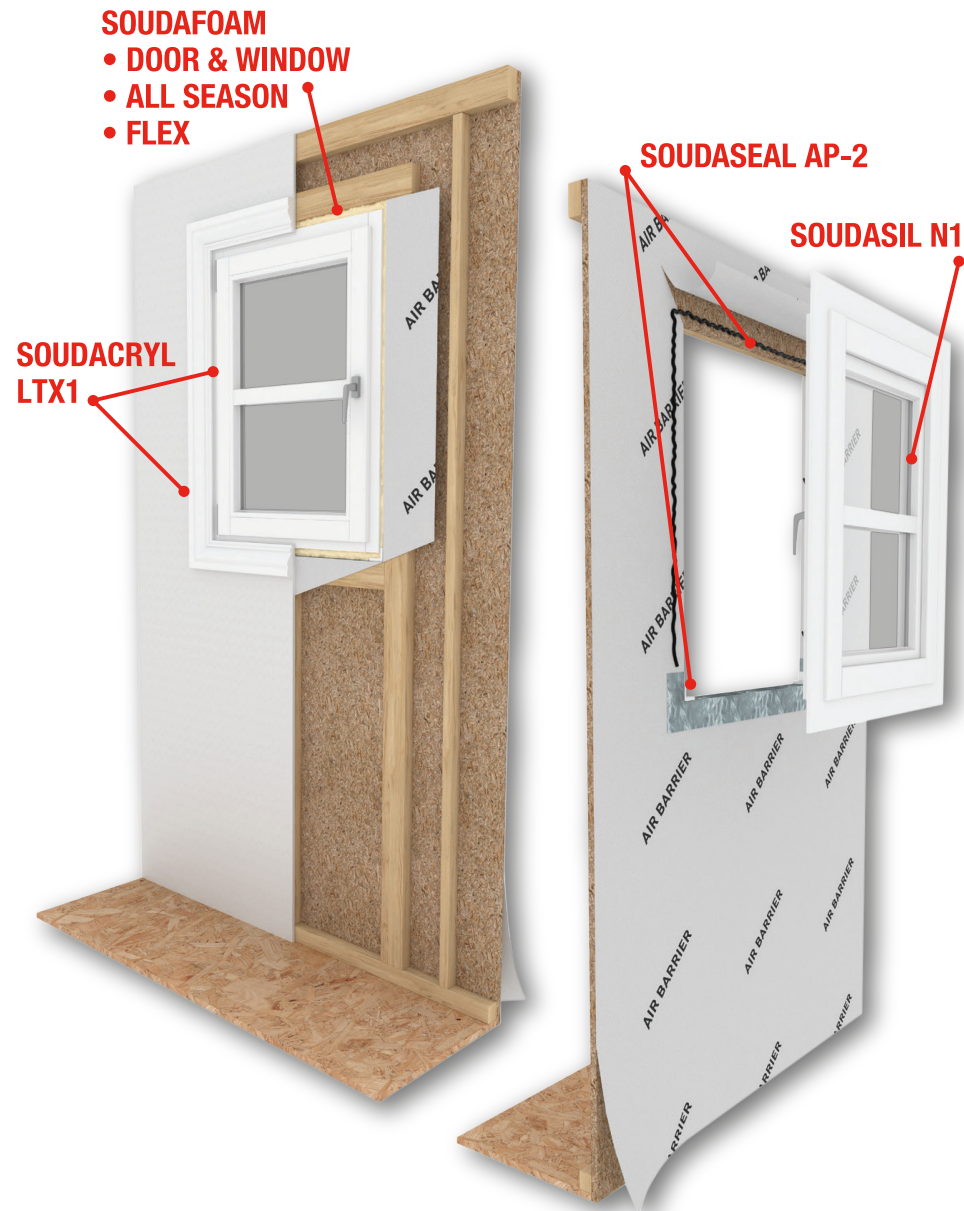

Our products can be used separately, but are best used combined as the Soudal Window System.

The low expansion foam formulations of Soudal's foams differentiates it from other polyurethane foams. Closing the gap with the Soudal Window System not only helps to reduce energy costs, it also helps with the thermal and acoustic insulation, vapor diffusion and the watertightness of the window. It also enhances comfort and helps with the esthetic beauty of the window frame. SWS is active on three levels. When installed properly, SWS offers include: seal and vapor isolation on the inside, optimal thermal and acoustic insulation in the middle of the wall and, wind and weather protection on the outside of the wall.

GET THE COLOR YOU NEED WITH SOUDAL'S COLOR-MATCHING PROGRAM

SOUDASEAL AP-2
 ALL PURPOSE SMX®-POLYMER HYBRID SEALANT & ADHESIVE

Ideal for sealing of windows & doors, both interior and exterior

- Next Generation Sealant: Features Superior Performance Characteristics
- Both Interior and Exterior
- Superior Weather Resistance: Waterproof. Can be Applied to Damp Surfaces
- Paintable (Water Base Paint). Prior Testing Required
- Permanent Flexibility and Elasticity: +/-35% Movement
- Excellent Adherence to Porous and Non Porous Substrates: PVC-Vinyl, Wood, Glass, Metal, Concrete, Stone and Flashing Tape. No Need for Primers
- No Shrink, No Smell, No Bubbling, Easy to Tool and Finish
- Environmentally Friendly: No Isocyanates/No Solvents
- Low Temperature Workability. Will Not Freeze and Easy to Extrude
- VOC Compliant: Low VOC Level: <3% VOC
- Plastic Cartridge
- AAMA certified

AVAILABLE IN:
 10.1 FL. OZ. CARTRIDGE
 AND 20 FL. OZ. SAUSAGE

Minimum Order Quantity:
 Cartridge - 1800, Sausage - 900

SOUDASIL N1
 ONE PART, NEUTRAL CURE SILICONE SEALANT

Ideal for sealing of interior and exterior windows & doors

- Excellent Adherence to PVC-Vinyl, Glass, Metals and Wood
- Permanent Flexibility and Excellent Recovery: +/- 25% movement
- Excellent UV Resistance, Color Stability and Weatherability
- Low Odor / VOC Compliant: Low VOC <3%
- AAMA certified

AVAILABLE IN:
 10.1 FL. OZ. CARTRIDGE
 AND 20 FL. OZ. SAUSAGE

Minimum Order Quantity:
 Cartridge - 1800, Sausage - 900

Please allow 2 - 3 weeks for color-match, and 6 - 8 weeks for production after color-match approval.

When ordering please include a color sample along with the following information:

Customer Name	Project Name	Product Application	Color Name
---------------	--------------	---------------------	------------

Submit to:
 Soudal
 ATTN: Technical Department
 350 Ring Road, Elizabethtown, KY 42701



ACCESSORIES

SODAL SWIPEX SUPER CLEANING WIPES

Swipex are solvent based cleaning wipes for uncured sealants & adhesives.

- Non woven wipes impregnated with a mixture of solvents, biodegradable non-ionic surfactants and skin emollients
- Suitable for all non-porous surfaces
- For hands and tools
- Cleans uncured sealant
- Removes oil, adhesive, etc.

COMES IN TUB 100 CT.



SODAL GUN & FOAM CLEANER SPRAY

Sodal Gun & Foam Cleaner is a ready to use solvent cleaner specifically designed for cleaning of uncured PU foam.

- Cleans the Sodal guns
- Cleans the valves of the Soudafoam cans
- Cleans hands and other tools
- Removal of uncured foam
- Application temperature: +41° F to +86° F
- Can be used with normal can due to the attachable spray nozzle

COMES IN AEROSOL CAN 12 OZ.



SODAL WINDOW SYSTEM PRODUCT LINE - MANUFACTURING

SODASEAL 50LM SMX® HYBRID SEALANT

Ideal for high movement joints, window & door perimeter, and mullions

- UV Stable
- Paintable
- Low Modulus
- Excellent adhesion to most common building materials
- No shrinkage
- AAMA approved
- Meets ASTM C-920, Type S, Grade NS, Class 50

COMES IN 10.1 FL. OZ. CARTRIDGE



GUNS



■ Sodal Contractor Grade Heavy Duty Caulking Gun, 10 oz Cartridge

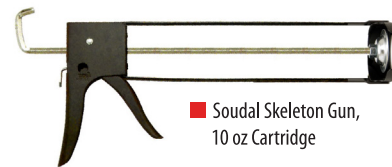

■ Sodal Skeleton Gun, 10 oz Cartridge



■ Sodal Designer Gun 22" is a 22" long top of the line metal gun foam applicator

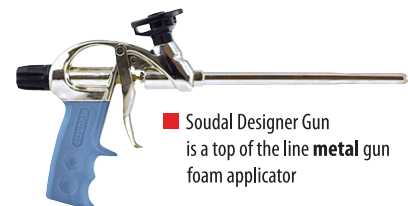

■ Sodal Designer Gun is a top of the line metal gun foam applicator



■ Sodal Compact Gun is a plastic gun foam applicator

SODASIL NFC ONE PART FAST CURE NEUTRAL SILICONE

Ideal for backbedding windows & doors

- Fast Setting
- Excellent Adherence to PVC-Vinyl, Glass, Metals and Wood
- Permanent Flexibility and Excellent Recovery: +/- 25% movement
- Excellent UV Resistance, Color Stability and Weatherability
- Low Odor / VOC Compliant: Low VOC <3%
- AAMA certified

COMES IN 10.1 FL. OZ. CARTRIDGE, 4.5 GALLON PAILS & 52 GALLON DRUMS



SODASIL N1 ONE PART, NEUTRAL CURE SILICONE SEALANT

COLOR-MATCHING PROGRAM



Ideal for window glazing as well as window and door installations

- Excellent Adherence to PVC-Vinyl, Glass, Metals and Wood
- Permanent Flexibility and Excellent Recovery: +/- 25% movement
- Excellent UV Resistance, Color Stability and Weatherability
- Low Odor / VOC Compliant: Low VOC <3%
- AAMA Certified

COMES IN 10.1 FL. OZ. CARTRIDGE, 4.5 GALLON PAILS & 52 GALLON DRUMS



SOUDAL WINDOW SYSTEM PRODUCT LINE - INSTALLATION

SOUDASEAL AP-2 ALL PURPOSE SMX®-POLYMER HYBRID SEALANT & ADHESIVE

COLOR-MATCHING PROGRAM



Ideal for sealing of windows & doors, both interior and exterior

- Next Generation Sealant: Features Superior Performance Characteristics
- Both Interior and Exterior
- Superior Weather Resistance: Waterproof. Can be Applied to Damp Surfaces
- Paintable (Water Base Paint). Prior Testing Required
- Permanent Flexibility and Elasticity: +/-35% Movement
- Excellent Adherence to Porous and Non Porous Substrates: PVC-Vinyl, Wood, Glass, Metal, Concrete, Stone and Flashing Tape. No Need for Primers
- No Shrink, No Smell, No Bubbling, Easy to Tool and Finish
- Environmentally Friendly: No Isocyanates/No Solvents
- Low Temperature Workability. Will Not Freeze and Easy to Extrude
- VOC Compliant: Low VOC Level: <3% VOC
- Plastic Cartridge
- AAMA Certified

COMES IN 10.1 FL. OZ. CARTRIDGE



SOUDASIL N1 ONE PART, NEUTRAL CURE SILICONE SEALANT

COLOR-MATCHING PROGRAM



Ideal for window glazing as well as window and door installations

- Excellent Adherence to PVC-Vinyl, Glass, Metals and Wood
- Permanent Flexibility and Excellent Recovery: +/- 25% movement
- Excellent UV Resistance, Color Stability and Weatherability
- Low Odor / VOC Compliant: Low VOC <3%
- AAMA Certified

COMES IN 10.1 FL. OZ. CARTRIDGE



SOUDACRYL LTX1 SILICONIZED LATEX ACRYLIC

Ideal for interior sealing of windows & doors

- High Quality Siliconized Acrylic Sealant
- Plasto-Elastic
- Paintable
- Colors: White, Almond, Bronze, Brown, Grey, Cedar & Clear
- Odorless
- UV and Weather Resistant
- Used for Sealing of Low Stressed Joints and Cracks
- Meets or Exceeds ASTM C-834

COMES IN 10.1 FL. OZ. CARTRIDGE



SOUDACRYL C920 FLEX PREMIUM GRADE FLEXIBLE ELASTOMERIC SEALANT

Ideal for building, construction, window and door joints, as well as sealing baseboards and trim

- Permanent Color
- Paintable
- Mildew Resistant
- UV Resistant
- Very Smooth Formula
- Easy Clean-Up with Water
- Non-Yellowing
- Very Easy Application
- Low Odor
- Voc Compliant
- Meets ASTM C-920, Type S, Grade NS, Class 25
- Excellent Adhesion to Wood, Masonry, Brick, Concrete, Drywall, Metal, Glass & Many More

COMES IN 10.1 FL. OZ. CARTRIDGE



SOUDAFOAM DOOR & WINDOW POLYURETHANE FOAM INSULATION

Ideal for eliminating thermal bridges between window frame and construction

- Minimal Expansion Foam
- Professional Gun Grade
- Excellent Thermal and Acoustic Insulation Properties
- Closed Cell Foam: Airtight and Weather-tight Seal
- Installs 5x Faster Than Fiberglass
- Has an R-value per Inch of R-6.5 Compared to R-3.14 for Traditional Fiberglass
- AAMA Certified

COMES IN AEROSOL CAN 24 OZ., GENIUS GUN 20 OZ. & STRAW 12 OZ.



SOUDAFOAM ALL SEASON POLYURETHANE EXTREME WEATHER FOAM

Top of the line, minimal expansion foam for use in extreme climates

- Minimal Expansion Foam
- Extreme Weather Formulation
- Extra High Yield
- Gunable in All Seasons (-13°F to 120°F With a Can Temperature of 40°F to 95°F)
- Excellent Thermal and Acoustical Insulation
- Closed Cell Foam: Airtight and Weather-tight Seal
- Installs 5x Faster Than Fiberglass
- Has an R-value per Inch of R-6.5 Compared to R-3.14 for Traditional Fiberglass
- No Shrinkage
- AAMA Certified

COMES IN AEROSOL CAN 24 OZ.



SOUDAFOAM FLEX POLYURETHANE EXTREME FLEXIBLE FOAM INSULATION

Ideal where a foam with extreme elasticity is needed

- Minimal Expansion Foam
- Very High Elastic Recovery
- Extreme Weather Formulation
- Gunable in All Seasons (-13°F to 120°F with a Can Temperature of 40°F to 95°F)
- 2 Year Shelf Life
- Storage in All Positions
- Excellent Thermal and Acoustical Insulation
- Closed Cell Foam: Airtight and Weather-tight Seal
- Installs 5x Faster Than Fiberglass
- Has an R-value per Inch of R-6.5 Compared to R-3.14 for Traditional Fiberglass
- No Shrinkage
- AAMA Certified

COMES IN AEROSOL CAN 24 OZ.



Soudafoam Gun Applied Versions of Door & Window, All Season and Flex all meet:

- ASTM C1620: Standard Specification for Aerosol Polyurethane and Aerosol Latex Foam Sealants
- ASTM E84: Standard Test Method for Surface Burning Characteristics of Building Materials
- AAMA 812-16: Standard Practice for Assessment of Single Component Aerosol Expanding Foams for Sealing Rough Openings of Fenestration Installations
- UL 723: Surface Burning Characteristics of Building Materials
- UL 1715: Fire Test of Interior Finish Material

Soudaseal AP-2 meets:

- ASTM C920, Class 35: Standard Specification for Elastomeric Joint Sealants
- AAMA 803.3-10 Type I, Validated AAMA Component as Narrow Joint Seam Sealer per Specification
- AAMA 808.3-10 EXTERIOR PERIMETER SEALING COMPOUND