



BUCKLEBRIDGE®

BRIDGING/BRACING MEMBER

Proven, field tested and a valuable component in the future of light steel framing construction!



Saving Benefits

- Fewer Screws Needed!!
- Reduces Install Cost for Walls!
- No Twisting with GWB Installation!
- Added Strength!
- Suitable for 6" & 8" Walls at 16" o.c.!
- Meets All Code Requirements!
- Automatically Aligns Studs!

Insert



1

Click



2

*Done!**

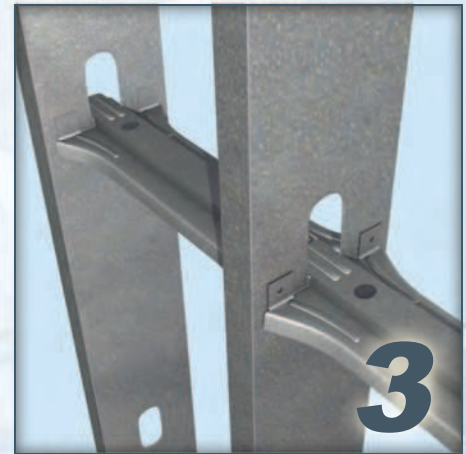

3

US Patents #7,596,921, #7,836,657, & #8,205,402

Order Information

Designation	Qty/Box	Qty/Skid
BuckleBridge®	50	2000

* Use (1) #10 screw on alternate sides of the BuckleBridge at 3rd stud (48" o.c.) Use (2) #10 screws at end of wall run.



1.888.474.4876
www.steelnetwork.com



BUCKLE UP SPEED UP

Quality Light Steel Framing Connections and Members

Example Details

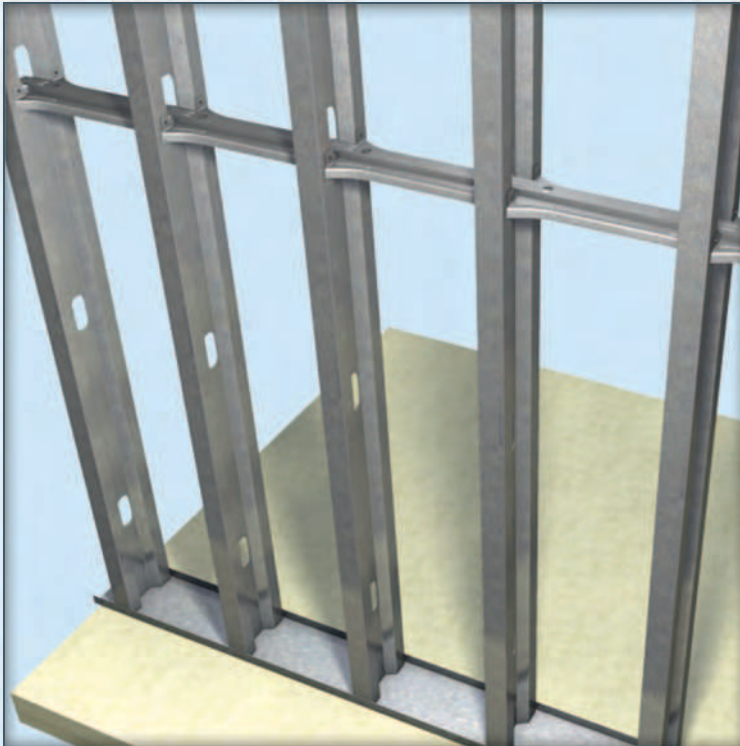

BuckleBridge® used in load bearing walls with TSN's SigmaStud®

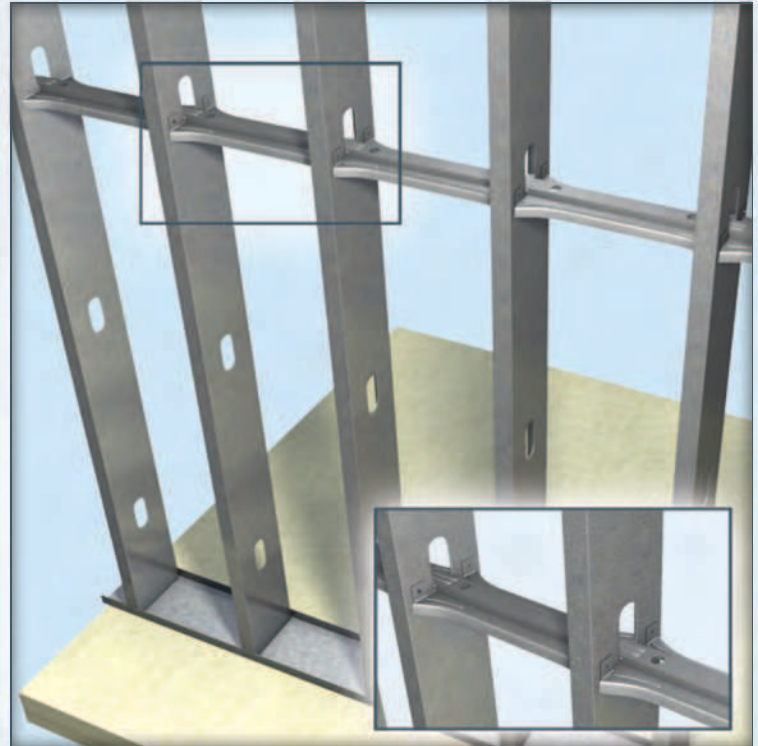

When using BuckleBridge® in curtain walls with standard "cee" studs, one screw is only needed every 3rd stud.

Allowable Loads

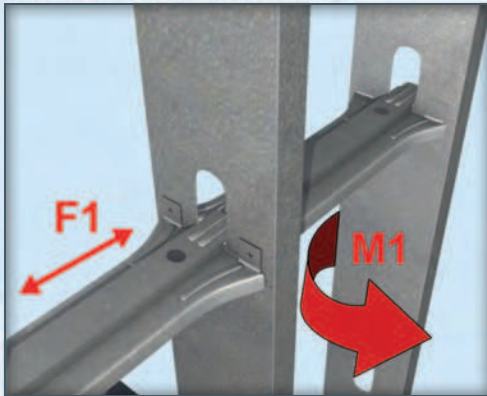

BuckleBridge Allowable Loads				
Axially Loaded Studs				
Compression Brace		Tension Brace		
F1 (lbs)	Stiffness (lbs/in)	F1 (lbs)	Stiffness (lbs/in)	
2,400	31,000	400	2,560	
Laterally Loaded Studs				
6" Studs		8" Studs		
M1 (in-lb)		M1 (in-lb)		
1,290		967		



The Steel Network provides solutions for all standard light steel framing applications! Visit our website to see more of our great products!



1.888.474.4876
www.steelnetwork.com



BUCKLE UP FOR SAFETY

Quality Light Steel Framing Connections and Members