

Step 1

Mix Pango Bond per instructions and apply at least a 2" swath, at least 60 mils thick, along the foundation wall, the top edge of the Pango Bond at the elevation of the slab.

Determine the height of the slab and crease Pango Wrap along each edge, offset by this height. Fold diagonally from the corner of the wrap to the intersections of these offset creases.

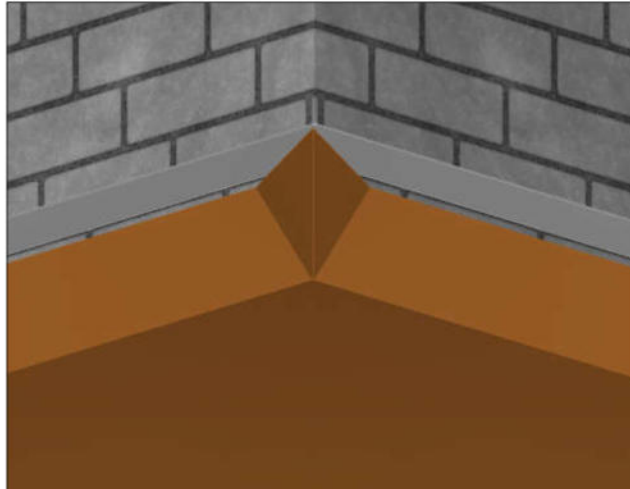

Step 2

Fold Pango Wrap up along the crease while pulling the wrap toward the wall. The diagonal crease should fold inward as the edges of the wrap are extended upware perpendicular to the base course and parallel with the wall.



Step 2

[Alternate angle]



PANGO® WRAP

WALL CORNER DETAIL WITH PANGO® BOND AND PANGO® TAPE

CONCEPTUAL FIELD ILLUSTRATION

PAGE 1 OF 2

NOT TO SCALE

9 MARCH 2022

Conceptual Field Illustrations are drawings prepared by Stego Industries, LLC and intended to illustrate potential installation or repair details. These illustrations are not design documents and must be reviewed and approved by the appropriate design professional prior to utilization. Likewise, in no way do these illustrations waive the requirements of the Contract Documents or supersede local code requirements. A Conceptual Field Illustration that does not comply with the applicable version of ASTM E1643 and the installation instructions of the products under consideration, by definition, is not a Stego recommendation; rather, it is merely an example of a potential way to complete the work.

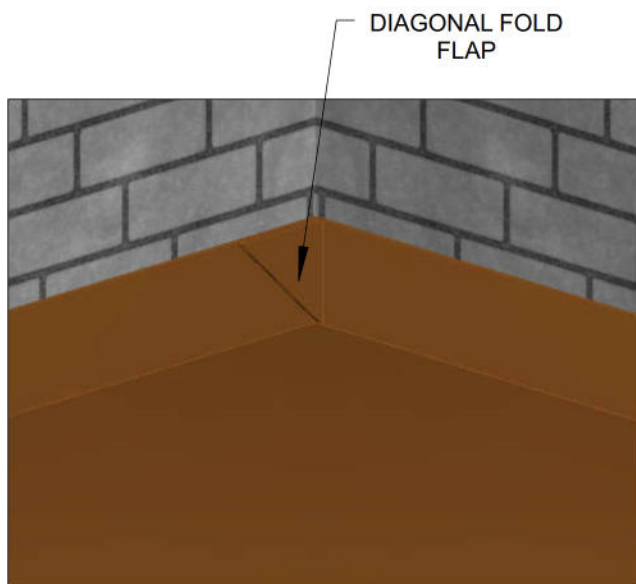

Step 3

Press the edges of the Pango Wrap against Pango Bond in order to create a consistent, continuous seal between the wrap and the Pango Bond

Fold the protruding section (flap) created by the diagonal crease to one side.

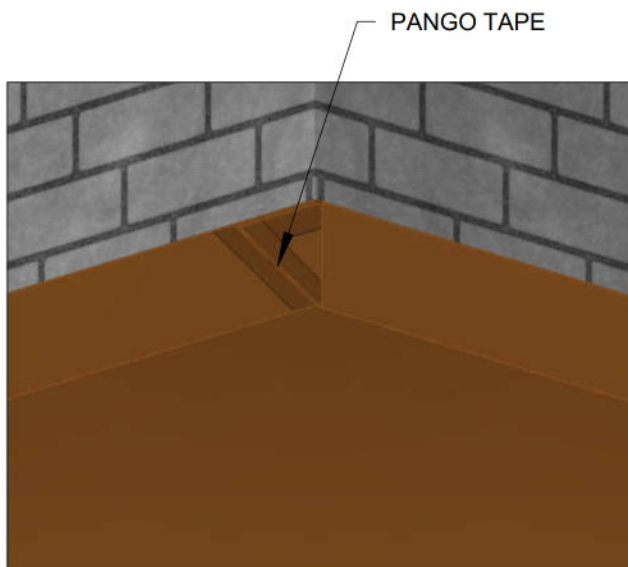

Step 4

Apply Pango Tape both over the top of the flap and along the diagonal crease to seal it to the foundation wall.

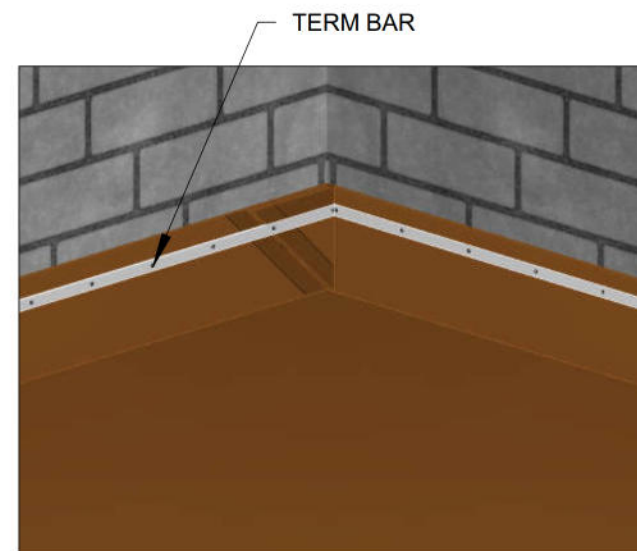

Step 4

Apply Pango Term Bar with fasteners, through the Pango Wrap and Pango Bond



DRAGO® WRAP

WALL CORNER DETAIL WITH PANGO® BOND AND PANGO® TAPE

CONCEPTUAL FIELD ILLUSTRATION

PAGE 1 OF 1

NOT TO SCALE

9 MARCH 2022

Conceptual Field Illustrations are drawings prepared by Stego Industries, LLC and intended to illustrate potential installation or repair details. These illustrations are not design documents and must be reviewed and approved by the appropriate design professional prior to utilization. Likewise, in no way do these illustrations waive the requirements of the Contract Documents or supersede local code requirements. A Conceptual Field Illustration that does not comply with the applicable version of ASTM E1643 and the installation instructions of the products under consideration, by definition, is not a Stego recommendation; rather, it is merely an example of a potential way to complete the work.