



STEGO™ WRAP VAPOUR BARRIER/RETARDER INSTALLATION INSTRUCTIONS

IMPORTANT: Please read these installation instructions completely, prior to beginning any Stego Wrap installation. The following installation instructions are based on ASTM E1643 - *Standard Practice for Selection, Design, Installation, and Inspection of Water Vapour Retarders Used in Contact with Earth or Granular Fill Under Concrete Slabs*. If project specifications call for compliance with ASTM E1643, then be sure to review the specific installation sections outlined in the standard along with the techniques referenced in these instructions.

UNDER-SLAB INSTRUCTIONS:

FIGURE 1: UNDER-SLAB INSTALLATION

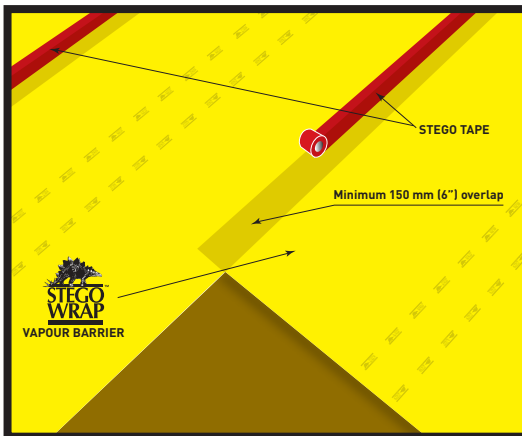

FIGURE 2a: SEAL TO SLAB AT PERIMETER

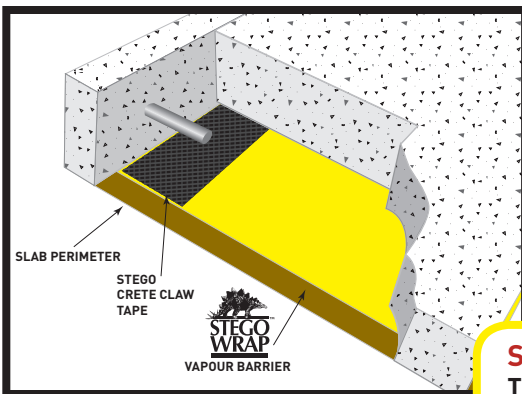
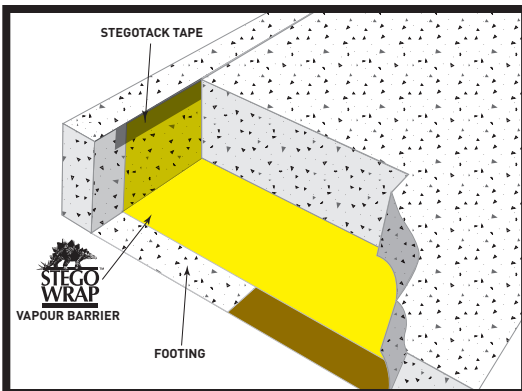

FIGURE 2b: SEAL TO PERIMETER WALL



1. Stego Wrap can be installed over an aggregate, sand, or tamped earth base. It is not necessary to have a cushion layer or sand base, as Stego Wrap is tough enough to withstand rugged construction environments.
2. Unroll Stego Wrap over the area where the slab is to be placed. Stego Wrap should completely cover the concrete placement area. All joints/seams both lateral and butt should be overlapped a minimum of 6" and taped using Stego™ Tape.

NOTE: The area of adhesion should be free from dust, dirt, moisture, and frost to allow maximum adhesion of the pressure-sensitive tape.
3. ASTM E1643 requires sealing the perimeter of the slab. *Extend vapour retarder over footings and seal to foundation wall, grade beam, or slab at an elevation consistent with the top of the slab or terminate at impediments such as waterstops or dowels.* Consult the structural engineer of record before proceeding.

SEAL TO SLAB AT PERIMETER:*

NOTE: Clean the surface of Stego Wrap to ensure that the area of adhesion is free from dust, dirt, moisture, and frost to allow maximum adhesion of the pressure-sensitive adhesive.

- a. Install Stego™ Crete Claw™ Tape on the entire perimeter edge of Stego Wrap.
- b. Prior to the placement of concrete, ensure that the top of Stego Crete Claw Tape is free of dirt, debris, or mud to maximise the bond to the concrete.

STEGO LABOUR SAVER!

This method not only complies with ASTM E1643, but it also:

- reduces labour compared to other perimeter sealing techniques.
- can be used even without an existing wall or footing, unlike alternatives.

OR SEAL TO PERIMETER WALL WITH STEGOTACK™ TAPE:*

- a. Make sure area of adhesion is free of dust, dirt, debris, moisture, and frost to allow maximum adhesion.
- b. Remove release liner on one side and stick to desired surface.
- c. When ready to apply Stego Wrap, remove the exposed release liner and press Stego Wrap firmly against StegoTack Tape to secure.

* If ASTM E1643 is specified, consult with project architect and structural engineer to determine which perimeter seal technique should be employed for the project.

4. In the event that Stego Wrap is damaged during or after installation, repairs must be made. For holes, cut a piece of Stego Wrap to a size and shape that covers any damage by a minimum overlap of 150 mm (6") in all directions. Clean all adhesion areas of dust, dirt, moisture, and frost. Tape down all edges using Stego Tape (see figure 3, Sealing Damaged Areas).

FIGURE 3: SEALING DAMAGED AREAS

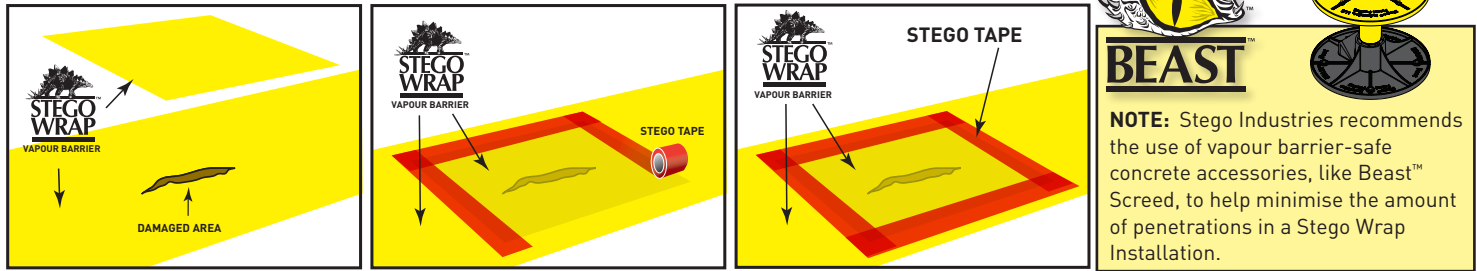

5. **IMPORTANT: ALL PENETRATIONS MUST BE SEALED.** All pipe, ducting, rebar, wire penetrations and block outs should be sealed using Stego Wrap, Stego Tape and/or Stego Mastic (see figure 4a, Pipe Penetration Sealing).

FIGURE 4a: PIPE PENETRATION SEALING

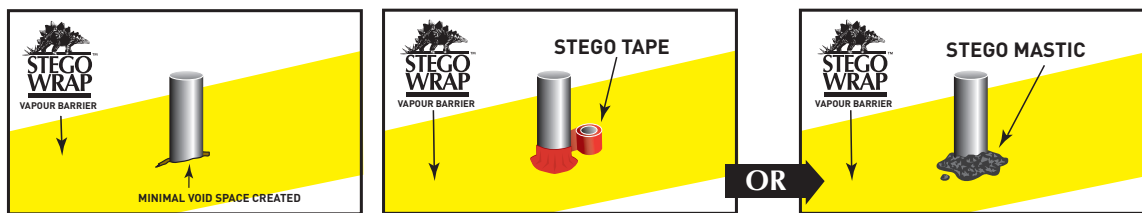

STEGO WRAP PIPE PENETRATION REPAIR DETAIL:

- 1: Install Stego Wrap around pipe penetrations by slitting/cutting material as needed. Try to minimise the void space created.
- 2: If Stego Wrap is close to pipe and void space is minimised then seal around pipe penetration with Stego Tape and/or Stego Mastic. [See Figure 4a]
- 3: If detail patch is needed to minimise void space around penetration, then cut a detail patch to a size and shape that creates a 150 mm (6") overlap on all edges around the void space at the base of the pipe. Stego Pre-Cut Pipe Boots are also available to speed up the installation.
- 4: Cut an "X" the size of the pipe diameter in the centre of the pipe boot and slide tightly over pipe.
- 5: Tape down all sides of the pipe boot with Stego Tape.
- 6: Seal around the base of the pipe using Stego Tape and/or Stego Mastic. [See Figure 4b]

FIGURE 4b: DETAIL PATCH FOR PIPE PENETRATION SEALING

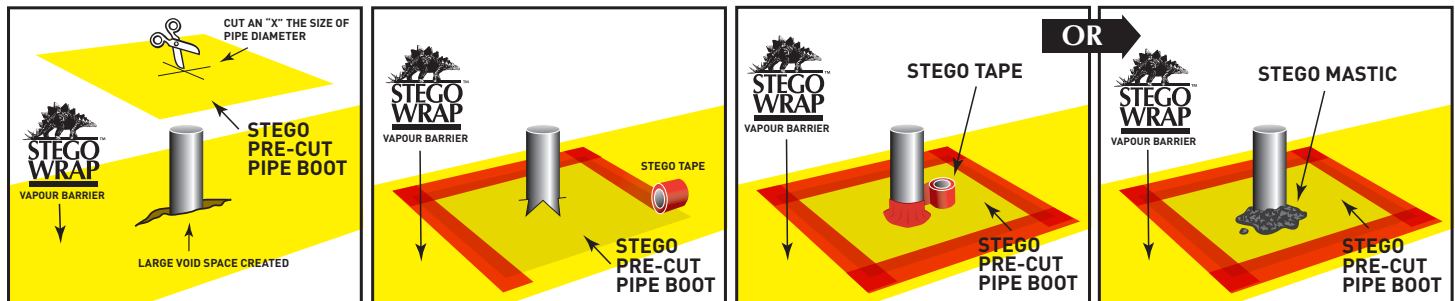
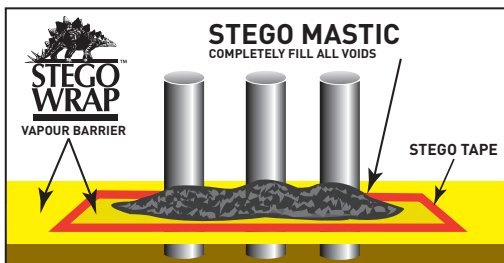

FIGURE 5: MULTIPLE PIPE PENETRATION SEALING



MULTIPLE PIPE PENETRATION SEALING:

Multiple pipe penetrations in close proximity and very small pipes may be sealed using Stego Wrap and Stego Mastic for ease of installation (see figure 5, Multiple Pipe Penetration Sealing).

NOTE: Stego Industries, LLC's ("Stego") installation instructions are based on ASTM E1643 - *Standard Practice for Selection, Design, Installation, and Inspection of Water Vapour Retarders Used in Contact with Earth or Granular Fill Under Concrete Slabs*. These instructions are meant to be used as a guide, and do not take into account specific job site situations. Consult local building codes and regulations along with the building owner or owner's representative before proceeding. If you have any questions regarding the above mentioned installation instructions or Stego products, please call us at +1 877-464-7834 for technical assistance. While Stego employees and representatives may provide technical assistance regarding the utility of a specific installation practice or Stego product, they are not authorised to make final design decisions.