

# StoEnergy Guard™

## Frame Construction: Portland Cement Stucco with Continuous Insulation Outbound of Sheathing

Detail No.: 61w.01  
Date: May 2012

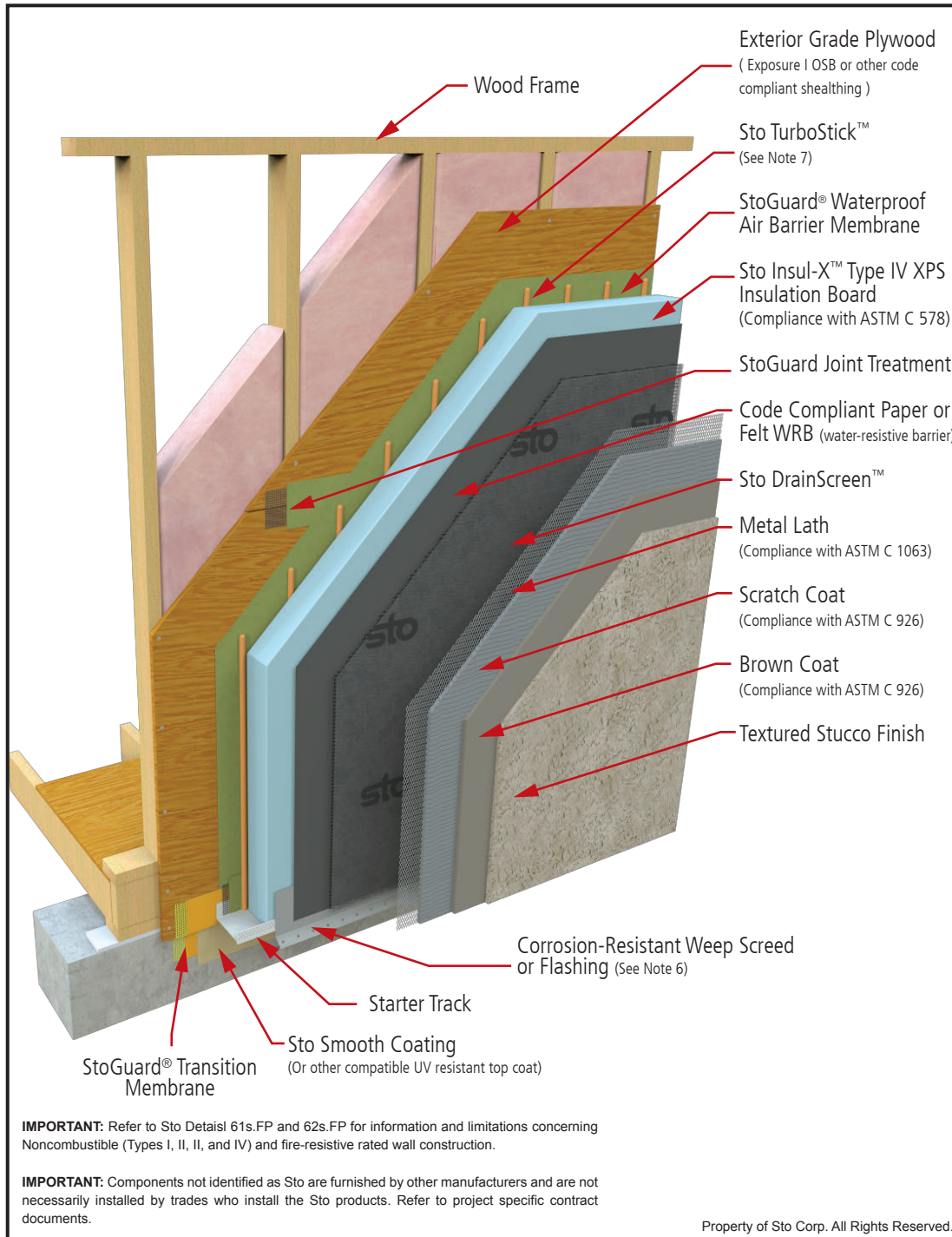

- Notes:**
- StoGuard® joint treatment options:
    - StoGuard® RapidSeal® with StoGuard® Mesh (joints ≤ 1/4 inch [6 mm])
    - Sto Gold Fill® with StoGuard® Mesh (joints ≤ 1/8 inch [3 mm])
    - StoGuard® Fabric with StoGuard® waterproof air barrier membrane (joints ≤ 1/8 inch [3 mm])
  - StoGuard® Transition Membrane Options:
    - StoGuard® RaidSeal® with StoGuard® Mesh
    - Sto Gold Fill with StoGuard® Mesh
  - StoGuard® waterproof air barrier membrane options:
    - Sto Gold Coat® (vapor permeable)
    - Sto EmeraldCoat® (high perm)
    - Sto VaporSeal™ (vapor impermeable)
    - Sto AirSeal™ (high perm) (Not for use with Sto Guard Fabric)
  - Water-Resistive Barrier: Minimum #15 grade D building paper.
  - Refer to product bulletins and Sto Specification S 507 for complete information on Sto products. Refer to StoGuard® Waterproof Air Barrier detail series 20.XX for information on detailing with StoGuard®.
  - Cladding termination minimum 4" (101 mm) above finish grade, minimum 2" (51mm) above paved surfaces.
  - Sto TurboStick serves as temporary attachment of Sto Insul-X. Sufficient cap or disc fasteners may also be used. Permanent attachment is achieved with mechanical attachment of cladding in compliance with the applicable code.
  - IMPORTANT!** Cladding weight and loads imposed on fasteners is a consideration when attaching through thick insulation. Consult local codes, FSC, [www.foamseathing.org](http://www.foamseathing.org), and/or cladding manufacturer for guidance. In some cases special analysis may be required to determine adequate attachment.

**IMPORTANT:** Refer to Sto Details 61s.FP and 62s.FP for information and limitations concerning Noncombustible (Types I, II, III, and IV) and fire-resistive rated wall construction.

**IMPORTANT:** Components not identified as Sto are furnished by other manufacturers and are not necessarily installed by trades who install the Sto products. Refer to project specific contract documents.

Property of Sto Corp. All Rights Reserved.

### ATTENTION

Sto products are intended for use by qualified professional contractors, not consumers, as a component of a larger construction assembly as specified by a qualified design professional, general contractor or builder. They should be installed in accordance with those specifications and Sto's instructions. Sto Corp. disclaims all, and assumes no, liability for on-site inspections, for its products applied improperly, or by unqualified persons or entities, or as part of an improperly designed or constructed building, for the nonperformance of adjacent building components or assemblies, or for other construction activities beyond Sto's control. Improper use of Sto products or use as part of an improperly designed or constructed larger assembly or building may result in serious damage to Sto products, and to the structure of the building or its components.

STO CORP. DISCLAIMS ALL WARRANTIES EXPRESSED OR IMPLIED EXCEPT FOR EXPLICIT LIMITED WRITTEN WARRANTIES ISSUED TO AND ACCEPTED BY BUILDING OWNERS IN ACCORDANCE WITH STO'S WARRANTY PROGRAMS WHICH ARE SUBJECT TO CHANGE FROM TIME TO TIME. For the fullest, most current information on proper application, clean-up, mixing and other specifications and warranties, cautions and disclaimers, please refer to the Sto Corp. website, [www.stocorp.com](http://www.stocorp.com).

[www.stocorp.com](http://www.stocorp.com)

# StoEnergy Guard™

## Frame Construction: Acrylic Finish over Cement Board with Continuous Insulation Outbound of Sheathing

Detail No.: 61w.02  
Date: May 2012

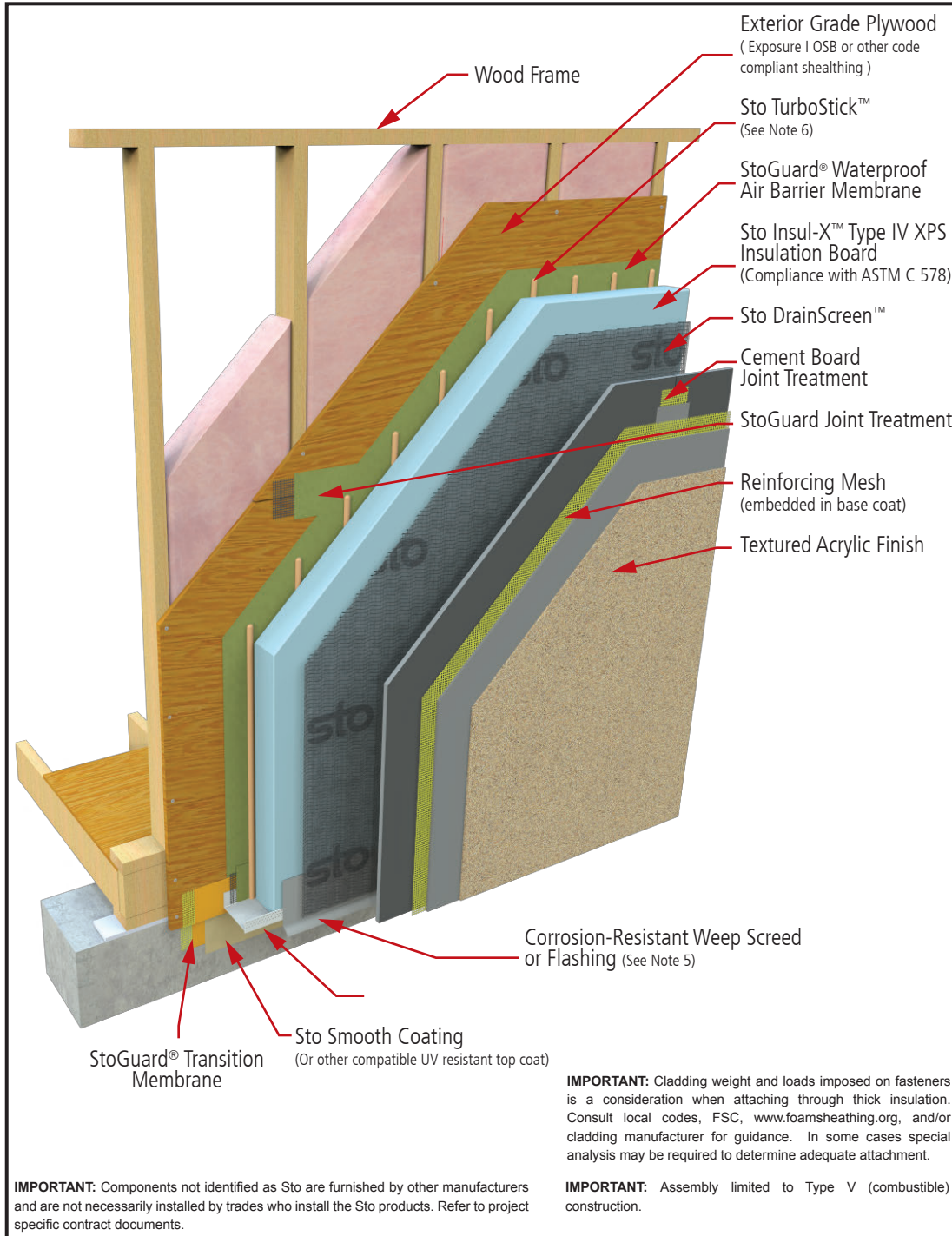

- Notes:**
- StoGuard® joint treatment options:
    - StoGuard® RapidSeal® with StoGuard® Mesh (joints ≤ 1/4 inch [6 mm])
    - Sto Gold Fill® with StoGuard® Mesh (joints ≤ 1/8 inch [3 mm])
    - StoGuard® Fabric with StoGuard® waterproof air barrier membrane (joints ≤ 1/8 inch [3 mm])
  - StoGuard® Transition Membrane Options:
    - StoGuard® RaidSeal® with StoGuard® Mesh
    - Sto Gold Fill with StoGuard® Mesh
  - StoGuard® waterproof air barrier membrane options:
    - Sto Gold Coat® (vapor permeable)
    - Sto EmeraldCoat® (high perm)
    - Sto VaporSeal™ (vapor impermeable)
    - Sto AirSeal™ (high perm) (Not for use with Sto Guard Fabric)
  - Refer to product bulletins and Sto Specification S 507 for complete information on Sto products. Refer to StoGuard® Waterproof Air Barrier detail series 20.XX for information on detailing with StoGuard®.
  - Cladding termination minimum 4" (101 mm) above finish grade, minimum 2" (51mm) above paved surfaces.
  - Sto TurboStick serves as temporary attachment of Sto Insul-X. Sufficient cap or disc fasteners may also be used. Permanent attachment is achieved with mechanical attachment of cladding in compliance with the applicable code.
  - Refer to manufacturer's instructions and ICC ES Report for code compliant materials and installation of cement board finish system.
- Property of Sto Corp. All Rights Reserved.

**ATTENTION**

Sto products are intended for use by qualified professional contractors, not consumers, as a component of a larger construction assembly as specified by a qualified design professional, general contractor or builder. They should be installed in accordance with those specifications and Sto's instructions. Sto Corp. disclaims all, and assumes no, liability for on-site inspections, for its products applied improperly, or by unqualified persons or entities, or as part of an improperly designed or constructed building, for the nonperformance of adjacent building components or assemblies, or for other construction activities beyond Sto's control. Improper use of Sto products or use as part of an improperly designed or constructed larger assembly or building may result in serious damage to Sto products, and to the structure of the building or its components.

STO CORP. DISCLAIMS ALL WARRANTIES EXPRESSED OR IMPLIED EXCEPT FOR EXPLICIT LIMITED WRITTEN WARRANTIES ISSUED TO AND ACCEPTED BY BUILDING OWNERS IN ACCORDANCE WITH STO'S WARRANTY PROGRAMS WHICH ARE SUBJECT TO CHANGE FROM TIME TO TIME. For the fullest, most current information on proper application, clean-up, mixing and other specifications and warranties, cautions and disclaimers, please refer to the Sto Corp. website, [www.stocorp.com](http://www.stocorp.com).

[www.stocorp.com](http://www.stocorp.com)

# StoEnergy Guard™

## Frame Construction: Adhered Masonry Veneer - Thin Set Brick with Continuous Insulation Outbound of Sheathing

Detail No.: 61w.03  
Date: May 2012

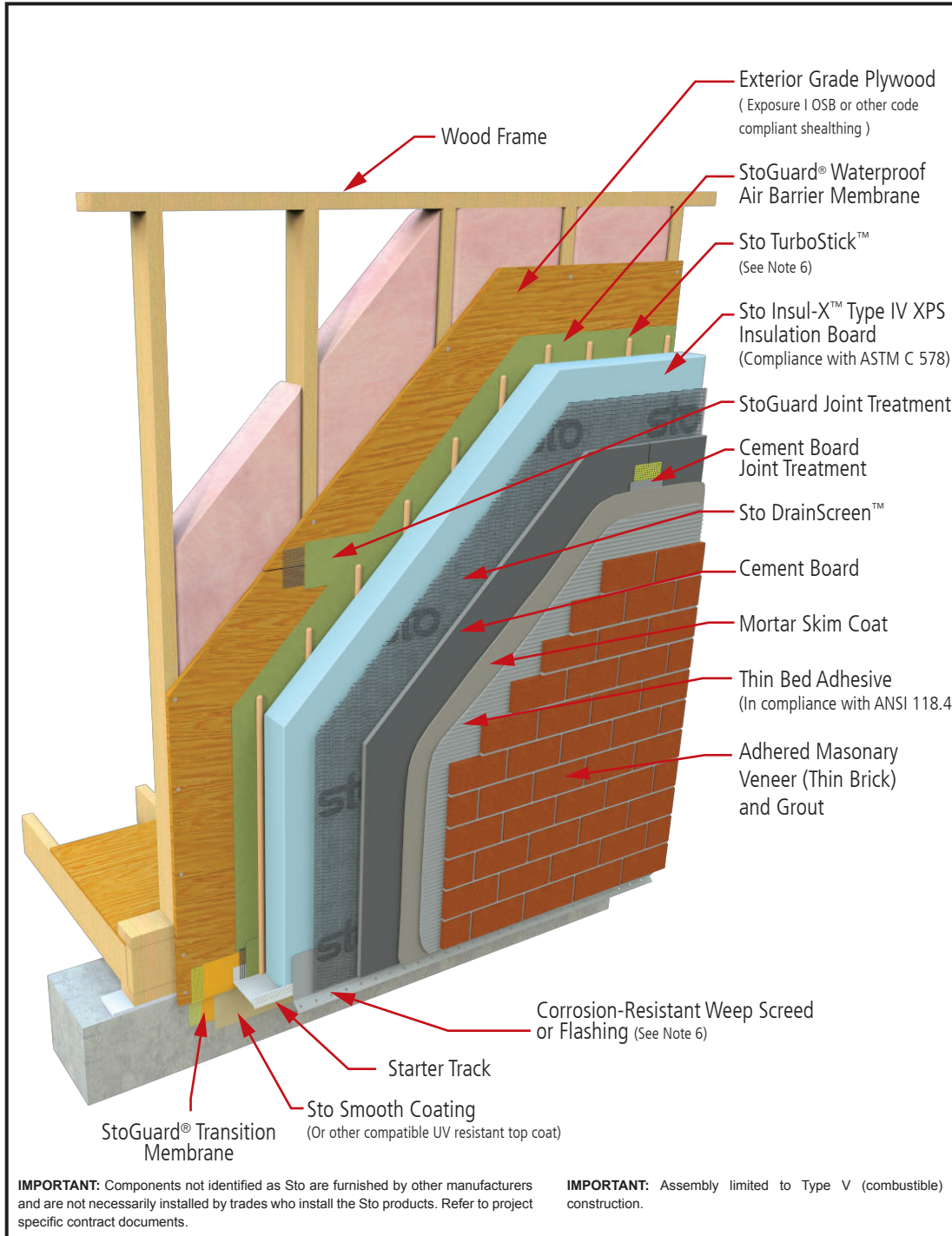

- Notes:**
- StoGuard® joint treatment options:
    - StoGuard® RapidSeal® with StoGuard® Mesh (joints ≤ 1/4 inch [6 mm])
    - Sto Gold Fill® with StoGuard® Mesh (joints ≤ 1/8 inch [3 mm])
    - StoGuard® Fabric with StoGuard® waterproof air barrier membrane (joints ≤ 1/8 inch [3 mm])
  - StoGuard® Transition Membrane Options:
    - StoGuard® RaidSeal® with StoGuard® Mesh
    - Sto Gold Fill with StoGuard® Mesh
  - StoGuard® waterproof air barrier membrane options:
    - Sto Gold Coat® (vapor permeable)
    - Sto EmeraldCoat® (high perm)
    - Sto VaporSeal™ (vapor impermeable)
    - Sto AirSeal™ (high perm) (Not for use with Sto Guard Fabric)
  - Refer to product bulletins and Sto Specification S 507 for complete information on Sto products. Refer to StoGuard® Waterproof Air Barrier detail series 20.XX for information on detailing with StoGuard®.
  - Cladding termination minimum 4" (101 mm) above finish grade, minimum 2" (51mm) above paved surfaces.
  - Sto TurboStick serves as temporary attachment of Sto Insul-X. Sufficient cap or disc fasteners may also be used. Permanent attachment is achieved with mechanical attachment of cladding in compliance with the applicable code.
  - Refer to cement board and adhered masonry veneer manufacturer's instructions and sections 6.1 and 6.3 of TMS 402 ACI 530/ASCE 5 for code compliant materials and installation of adhered masonry veneer
- Property of Sto Corp. All Rights Reserved.

**IMPORTANT:** Components not identified as Sto are furnished by other manufacturers and are not necessarily installed by trades who install the Sto products. Refer to project specific contract documents.

**IMPORTANT:** Assembly limited to Type V (combustible) construction.

**ATTENTION**

Sto products are intended for use by qualified professional contractors, not consumers, as a component of a larger construction assembly as specified by a qualified design professional, general contractor or builder. They should be installed in accordance with those specifications and Sto's instructions. Sto Corp. disclaims all, and assumes no, liability for on-site inspections, for its products applied improperly, or by unqualified persons or entities, or as part of an improperly designed or constructed building, for the nonperformance of adjacent building components or assemblies, or for other construction activities beyond Sto's control. Improper use of Sto products or use as part of an improperly designed or constructed larger assembly or building may result in serious damage to Sto products, and to the structure of the building or its components.

STO CORP. DISCLAIMS ALL WARRANTIES EXPRESSED OR IMPLIED EXCEPT FOR EXPLICIT LIMITED WRITTEN WARRANTIES ISSUED TO AND ACCEPTED BY BUILDING OWNERS IN ACCORDANCE WITH STO'S WARRANTY PROGRAMS WHICH ARE SUBJECT TO CHANGE FROM TIME TO TIME. For the fullest, most current information on proper application, clean-up, mixing and other specifications and warranties, cautions and disclaimers, please refer to the Sto Corp. website, [www.stocorp.com](http://www.stocorp.com).

# StoEnergy Guard™

## Frame Construction: Thick Adhered Masonry Veneer with Continuous Insulation Outbound of Sheathing

Detail No.: 61w.04  
Date: May 2012

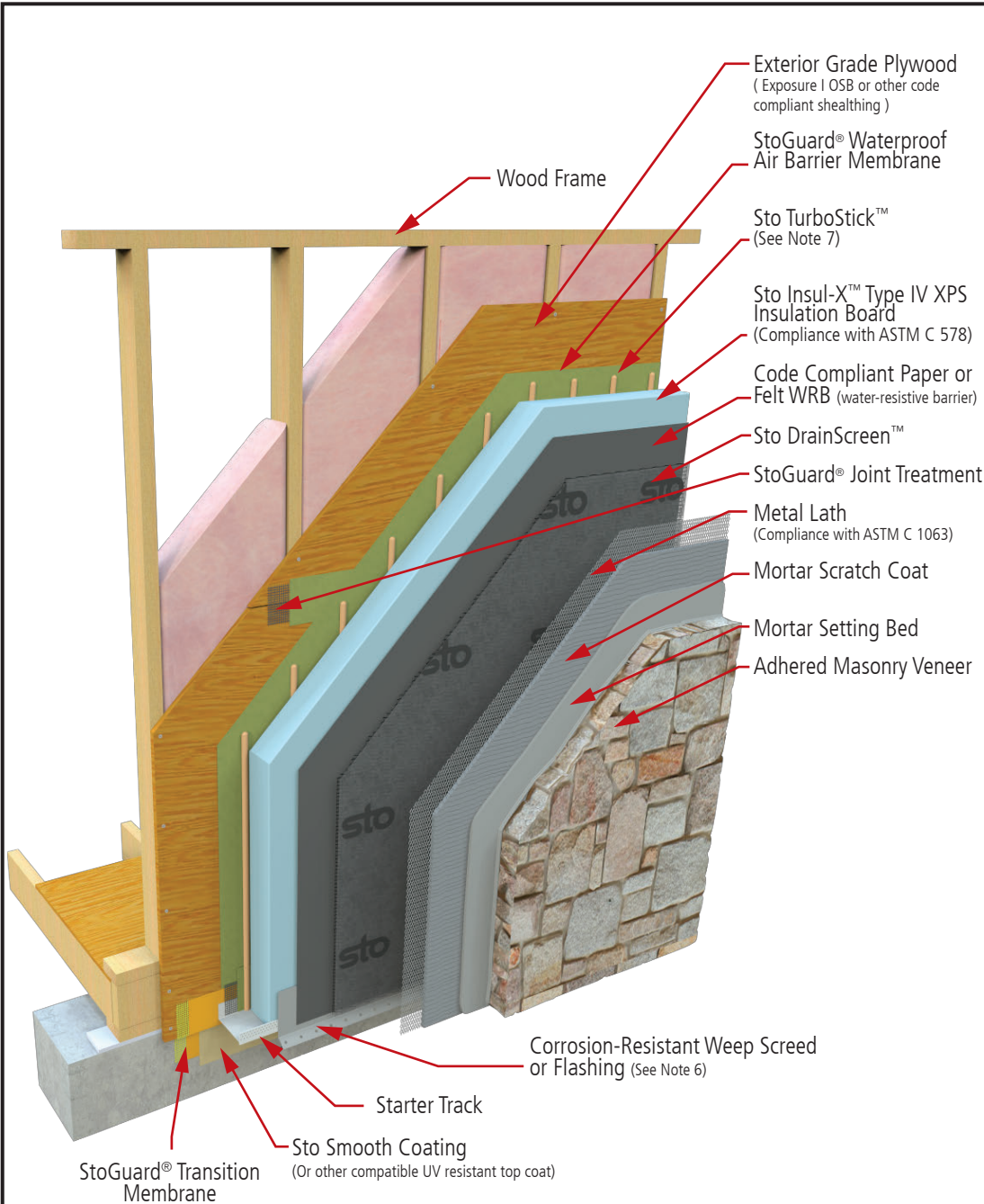

### Notes:

- StoGuard® joint treatment options:
  - StoGuard® RapidSeal® with StoGuard® Mesh ( joints ≤ 1/4 inch [6 mm] )
  - Sto Gold Fill® with StoGuard® Mesh ( joints ≤ 1/8 inch [3 mm] )
  - StoGuard® Fabric with StoGuard® waterproof air barrier membrane ( joints ≤ 1/8 inch [3 mm] )
- StoGuard® Transition Membrane Options:
  - StoGuard® RaidSeal® with StoGuard® Mesh
  - Sto Gold Fill with StoGuard® Mesh
- StoGuard® waterproof air barrier membrane options:
  - Sto Gold Coat® (vapor permeable)
  - Sto EmeraldCoat® (high perm)
  - Sto VaporSeal™ (vapor impermeable)
  - Sto AirSeal™ (high perm) (Not for use with Sto Guard Fabric)
- Water-Resistive Barrier: Minimum #15 grade D building paper.
- Refer to product bulletins and Sto Specification S 507 for complete information on Sto products. Refer to StoGuard® Waterproof Air Barrier detail series 20.XX for information on detailing with StoGuard®.
- Cladding termination minimum 4" (101 mm) above finish grade, minimum 2" (51mm) above paved surfaces.
- Sto TurboStick serves as temporary attachment of Sto Insul-X. Sufficient cap or disc fasteners may also be used. Permanent attachment is achieved with mechanical attachment of cladding in compliance with the applicable code.
- IMPORTANT!** Cladding weight and loads imposed on fasteners is a consideration when attaching through thick insulation. Consult local codes, FSC, [www.foamsheathing.org](http://www.foamsheathing.org), and/or cladding manufacturer for guidance. In some cases special analysis may be required to determine adequate attachment.

**IMPORTANT:** Components not identified as Sto are furnished by other manufacturers and are not necessarily installed by trades who install the Sto products. Refer to project specific contract documents.

**IMPORTANT:** Refer to Sto Details 61s.FP and 62s.FP for information and limitations concerning Noncombustible (Types I, II, III, and IV) and fire-resistive rated wall construction.

### ATTENTION

Sto products are intended for use by qualified professional contractors, not consumers, as a component of a larger construction assembly as specified by a qualified design professional, general contractor or builder. They should be installed in accordance with those specifications and Sto's instructions. Sto Corp. disclaims all, and assumes no, liability for on-site inspections, for its products applied improperly, or by unqualified persons or entities, or as part of an improperly designed or constructed building, for the nonperformance of adjacent building components or assemblies, or for other construction activities beyond Sto's control. Improper use of Sto products or use as part of an improperly designed or constructed larger assembly or building may result in serious damage to Sto products, and to the structure of the building or its components.

STO CORP. DISCLAIMS ALL WARRANTIES EXPRESSED OR IMPLIED EXCEPT FOR EXPLICIT LIMITED WRITTEN WARRANTIES ISSUED TO AND ACCEPTED BY BUILDING OWNERS IN ACCORDANCE WITH STO'S WARRANTY PROGRAMS WHICH ARE SUBJECT TO CHANGE FROM TIME TO TIME. For the fullest, most current information on proper application, clean-up, mixing and other specifications and warranties, cautions and disclaimers, please refer to the Sto Corp. website, [www.stocorp.com](http://www.stocorp.com).

Property of Sto Corp. All Rights Reserved.

[www.stocorp.com](http://www.stocorp.com)