

NOTE: SECURE METAL ROOF EDGE WITH TWO FASTENERS AT CENTER OF EACH SECTION AND AT COVER PLATE. ELASTOMERIC SEALANT AT ALL FASTENERS.

TAMKO MODIFIED ASPHALT FLASHING MEMBRANE EXTENDS 6" MIN. ON TO FIELD OF ROOF

FIELD OF ROOF

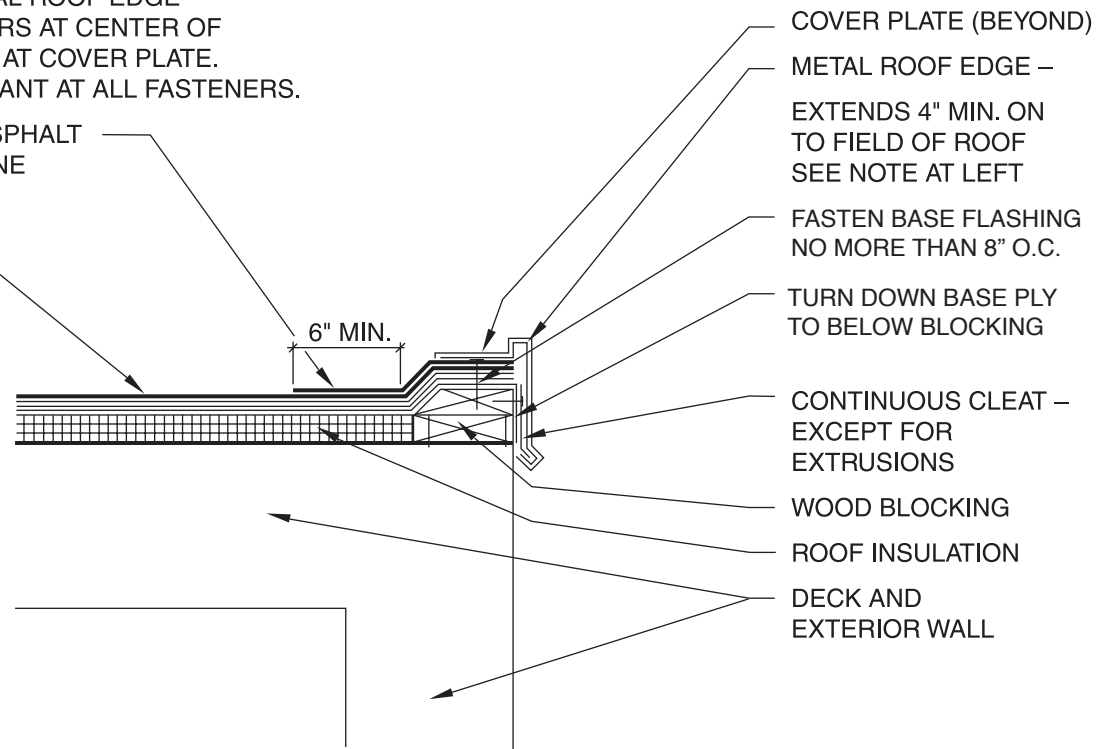

COVER PLATE (BEYOND)

METAL ROOF EDGE –

EXTENDS 4" MIN. ON TO FIELD OF ROOF SEE NOTE AT LEFT

FASTEN BASE FLASHING NO MORE THAN 8" O.C.

TURN DOWN BASE PLY TO BELOW BLOCKING

CONTINUOUS CLEAT – EXCEPT FOR EXTRUSIONS

WOOD BLOCKING

ROOF INSULATION

DECK AND EXTERIOR WALL

NOTE: THIS DETAIL SHOULD BE USED ONLY WHERE THE DECK IS SUPPORTED BY THE OUTSIDE WALL. METALS OF 22 ga. STEEL, 0.050 in. ALUMINUM, 24 ga. STAINLESS STEEL OR HEAVIER ARE APPROPRIATE FOR THIS DETAIL. METALS OF THIS WEIGHT ARE VERY RIGID WHEN FORMED, AND FASTENING AT THE CENTERLINE AND JOINT COVER WILL ALLOW EXPANSION AND CONTRACTION WITHOUT DAMAGING THE AWAPLAN PREMIUM MATERIAL. THE NAILER SHOULD BE ATTACHED TO THE MASONRY WALL. FACTORY MUTUAL DATA SHEET 1- 49 SHOULD BE CONSULTED FOR FURTHER INFORMATION. THE WOOD BLOCKING MAY BE SLOTTED FOR VENTING WHERE REQUIRED.

HEAVY METAL ROOF EDGE DETAIL

AWP-10

TAMKO[®]
BUILDING PRODUCTS