

INSTALLATION MANUAL

TREMCO[®]

VR MOD

**EXTENSIVE
PRE-VEGETATED HYBRID MODULAR SYSTEM**

1- VR RootBloc 10 or VR RootBloc 40

(NOTE: For both conventional & inverted roof assemblies.)

- a. Install VR RootBloc 10 or VR RootBloc 40 over the roofing membrane. Lap all joints by a minimum 4" (100 mm).

For VR RootBloc 10, seal all seams continuously with VR TecTape 2.

For VR RootBloc 40, seal all seams continuously with VR TecTape 4 or with heat welding.

- b. Bring the VR RootBloc 10 or VR RootBloc 40 up all projections and parapets within the designated green roof area, at least 1" (25 mm) above the finished soil level. Secure with VR TecTape 2 or VR TecTape 4 respectively, creating an uninterrupted seal between the root barrier and the projections or parapets within the designated green roof area.

When installing VR RootBloc 40, DO NOT pull too tightly at corners, to allow the material room to expand and contract with temperature.

VR RootBloc 40 must be secured to parapets with VR TecTape 4 or termination bars.

- c. In the case of roof drains, remove the drain grate and ensure the VR RootBloc 10 or VR RootBloc 40 extends beyond the edge of the clamping flange. Cut a hole in the VR RootBloc 10 or VR RootBloc 40 sufficient in size to allow for uninterrupted drainage. Clamp the grate back onto the clamping flange.

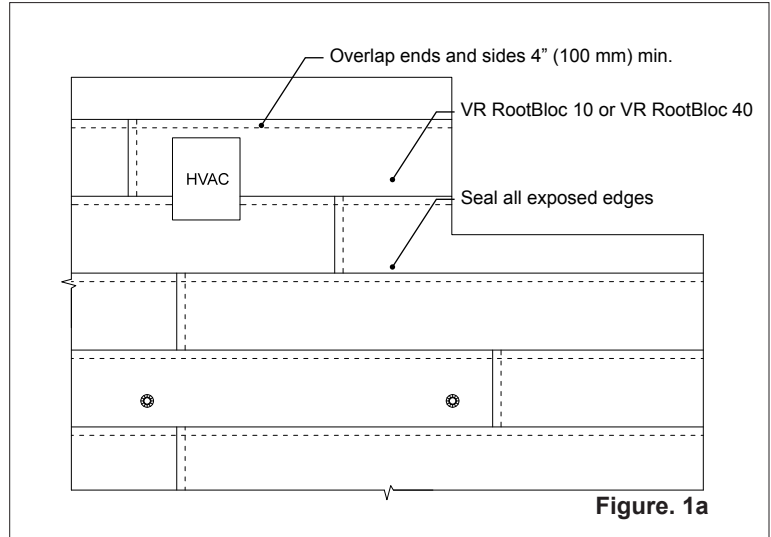

Figure. 1a

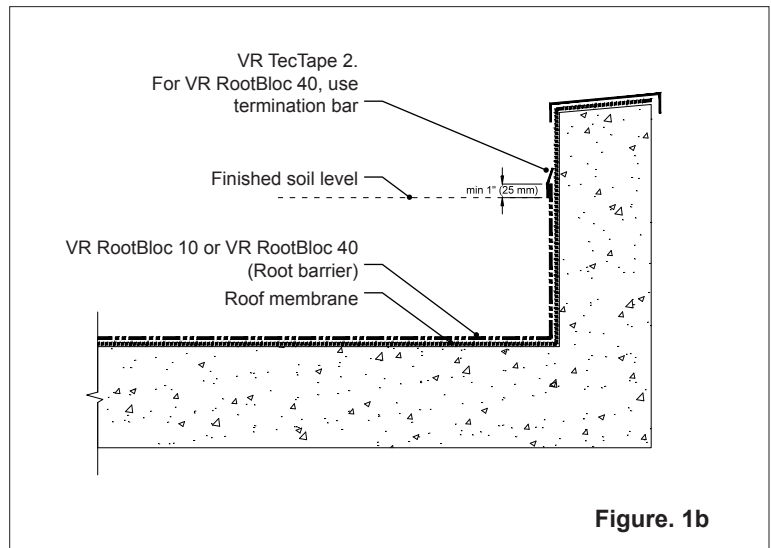

Figure. 1b

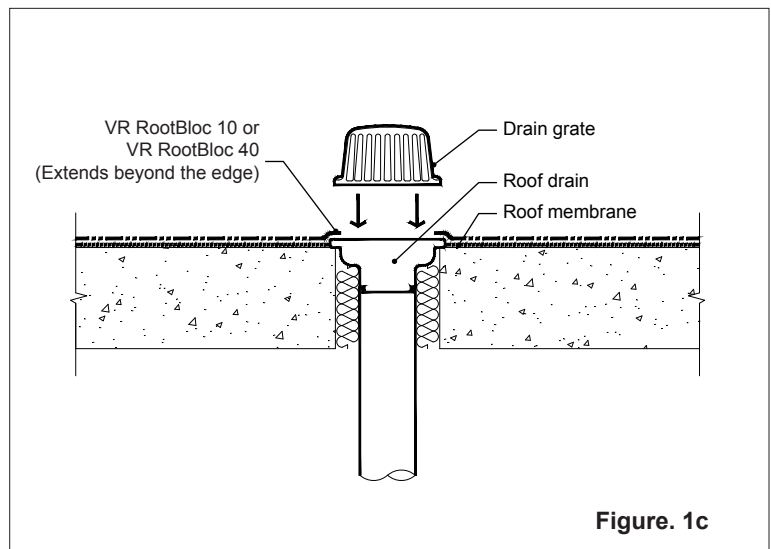

Figure. 1c

2- Insulation (Option 1)

(NOTE: This step is required if an inverted roof system is used. Otherwise proceed to Option 2.)

- a. Lay insulation in parallel courses, staggering end laps and side laps. Do not force into place.

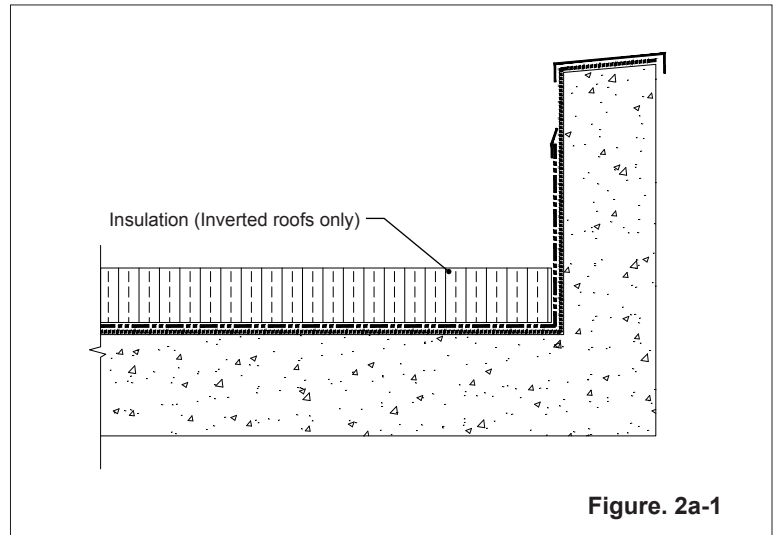

Figure. 2a-1

- b. Cut insulation to fit neatly at projections and terminations with less than 1" (25 mm) tolerance.

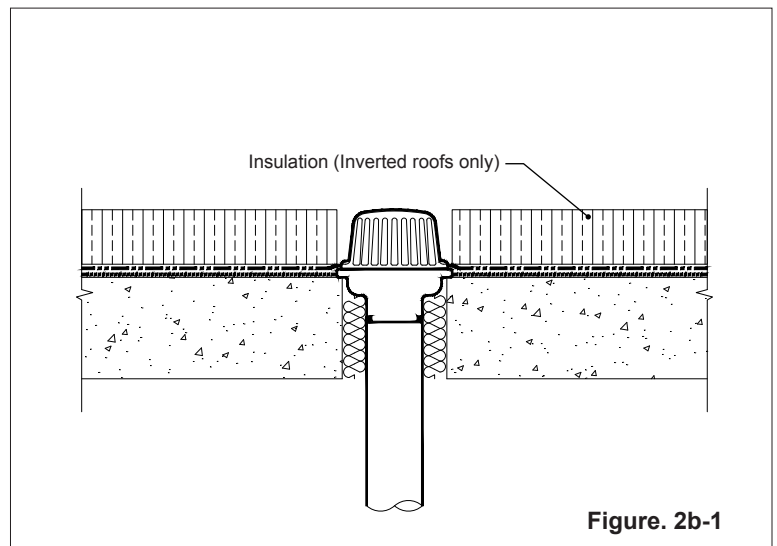

Figure. 2b-1

2- VR PolyMat (Option 2)

(NOTE: This step is required if a conventional roof system is used.)

- a. Lay VR PolyMat over the VR RootBloc 10 or VR RootBloc 40 and cut it to fit neatly at projections and terminations with less than 1" (25 mm) tolerance.

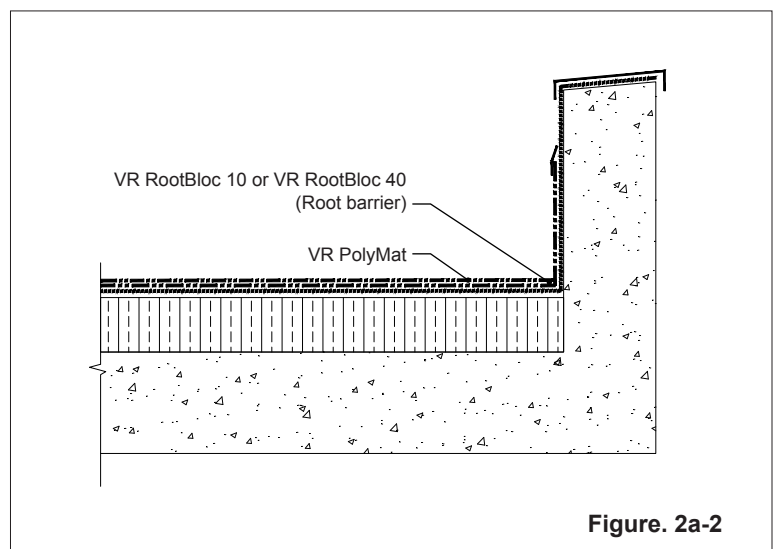
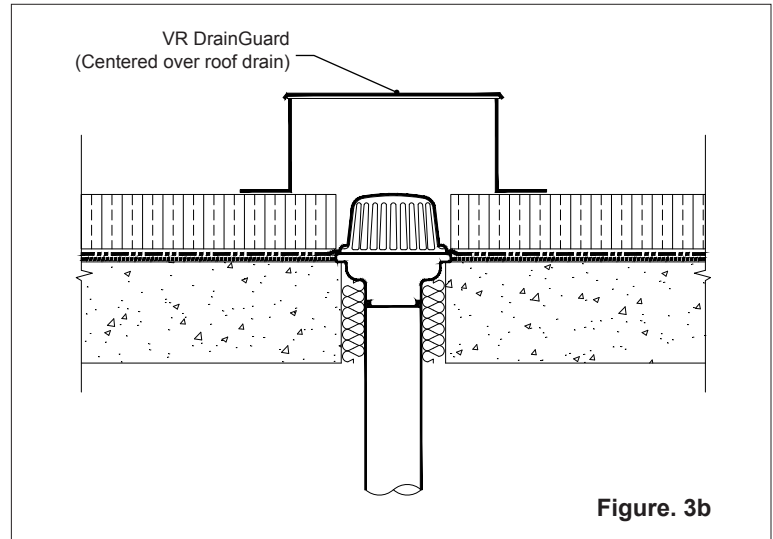

Figure. 2a-2

3- VR DrainGuard 4

- a. Install VR DrainGuard 4 centered over roof drains, either on top the insulation (for inverted roof system) or the VR PolyMat (for conventional roof system).
- b. Place lid over tabs, apply lock-out tags, ensuring they show the current date.



4- VR MOD

- a. To install VR Mod Pre-vegetated Modules, start at the upper left corner of the bordered area as per plans and drawings.

Orient modules so that the receiving ends of locking-clips face out to directions of installation (rightwards and downwards).

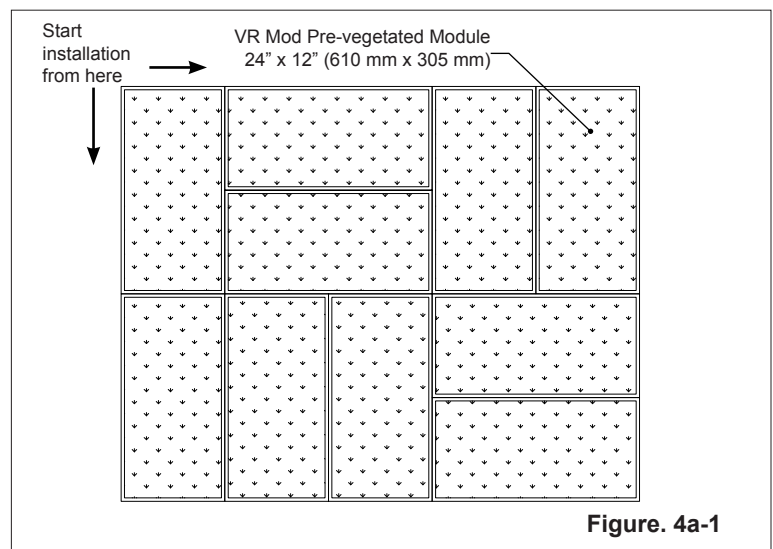
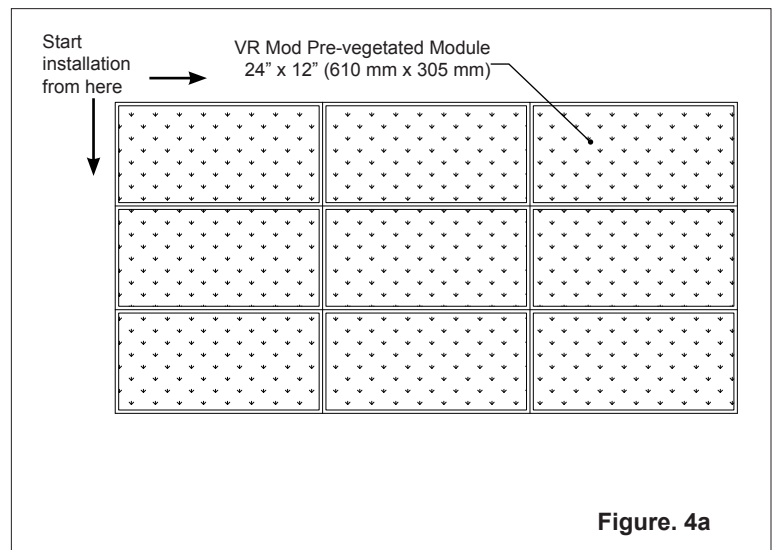

- b. If placing VR Mod Pre-vegetated Module immediately against a parapet wall or curb wall ensure outside wall of VR Mod Pre-vegetated Module is sealed with VR TecTape 4 to prevent growth media from eroding through the sidewalls.

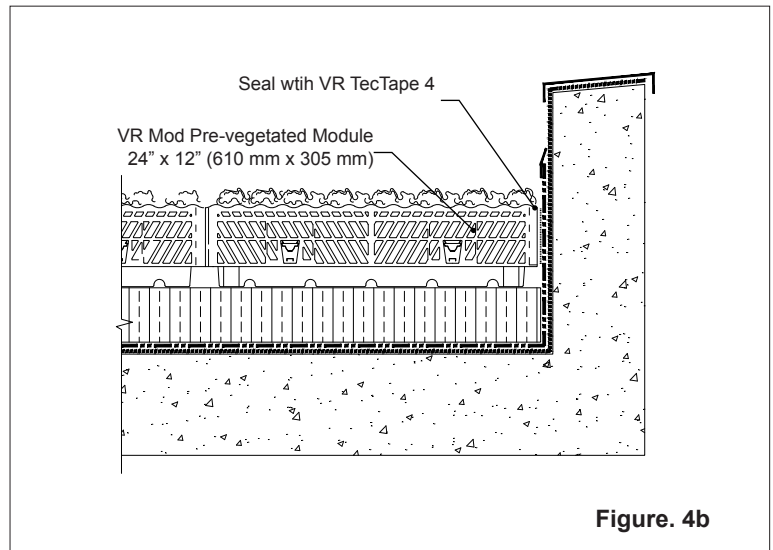

Figure. 4b

- c. Attach subsequent modules from left to right, by sliding VR Mod Pre-vegetated Module wall down beside placed VR Mod Pre-vegetated Module. Ensure both locking clips fully engage the receivers in the wall of the previous module before moving to next module.

Optional - Integrated Irrigation

(NOTE: If the option of integrated irrigation is not used proceed to Item 4e. Take note of marked, pre-plumbed VR Mod Pre-vegetated Modules and place as per plans and drawings.)

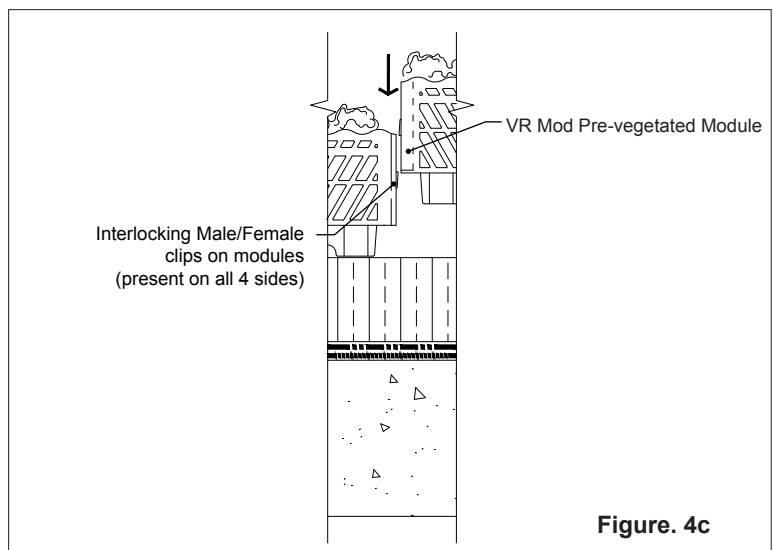

Figure. 4c

- d. Run lateral irrigation lines as per plans and drawings and connect to sprinkler head fittings accessible on the underside of the pre-plumbed VR Mod Pre-vegetated Modules. Ensure irrigation piping is laid in the void space along the edge of the VR Mod Pre-vegetated Module prior to connecting the next VR Mod Pre-vegetated Module.

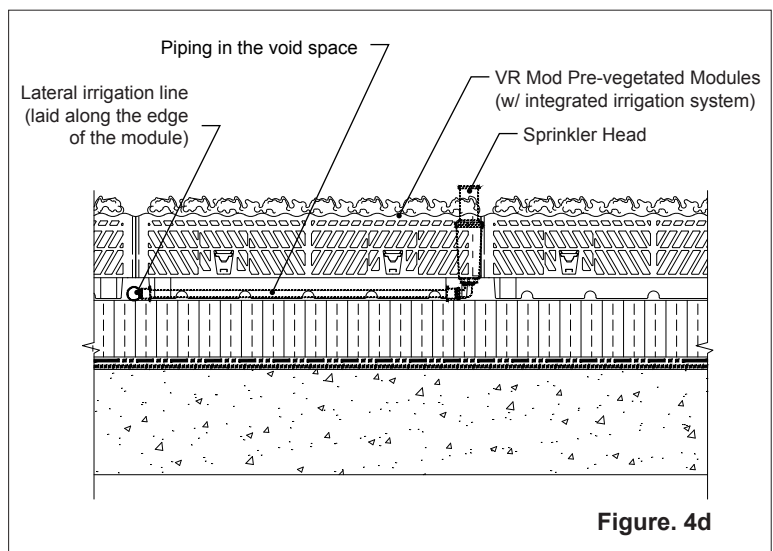
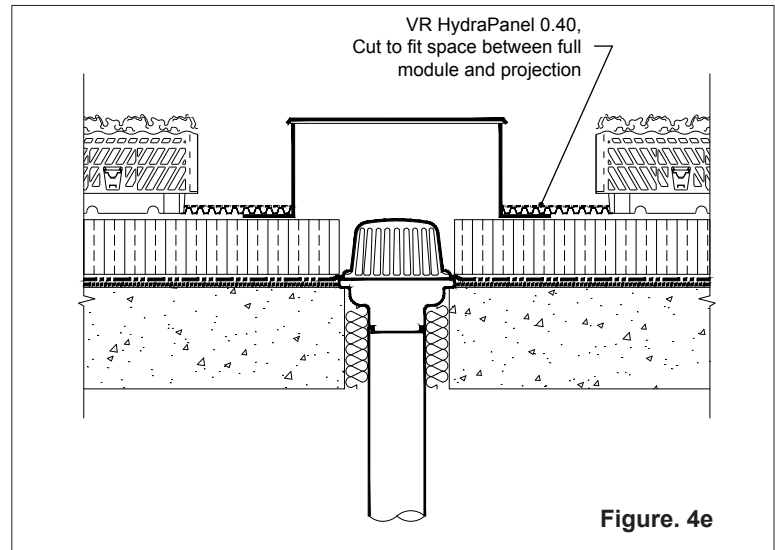
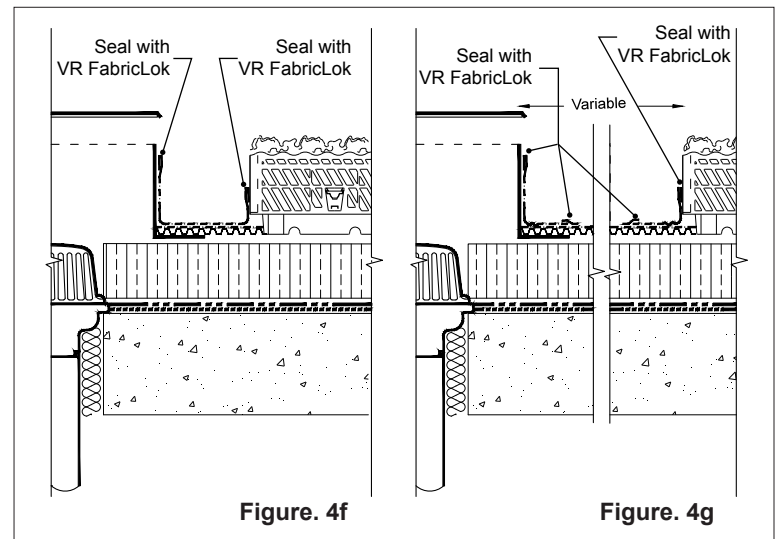

Figure. 4d

- e. At areas where full module cannot be installed, lay VR HydraPanel 0.40 sheets, fabric side up, over the base layer of insulation (for inverted roof system) or the VR PolyMat (for conventional roof system). Cut around roof projections, drain chambers, or edging restraint, etc for a tight fit.



- f. Bring VR Filter Fabric up 2" (50 mm) of VR Mod sidewall. Secure to bottom 2" of VR Mod sidewall with VR FabricLok. Bring other side of VR Filter Fabric all the way up wall of roof projection, drain chamber, or edging restraint, etc, and secure with VR FabricLok. See Figure 4f-2.



- g. If distance between roof projection, drain chamber, or edging restraint is wider than width of VR Filter Fabric piece, use two separate pieces of filter fabric. Seal VR Filter Fabric to VR HydraPanel 0.40 as needed, ensuring sufficient slack at corners. See Figure 4f-3.

- h. Fill with growing media and vegetation types to match adjacent full VR Mod pre-vegetated modules. See Figure 4f-4.

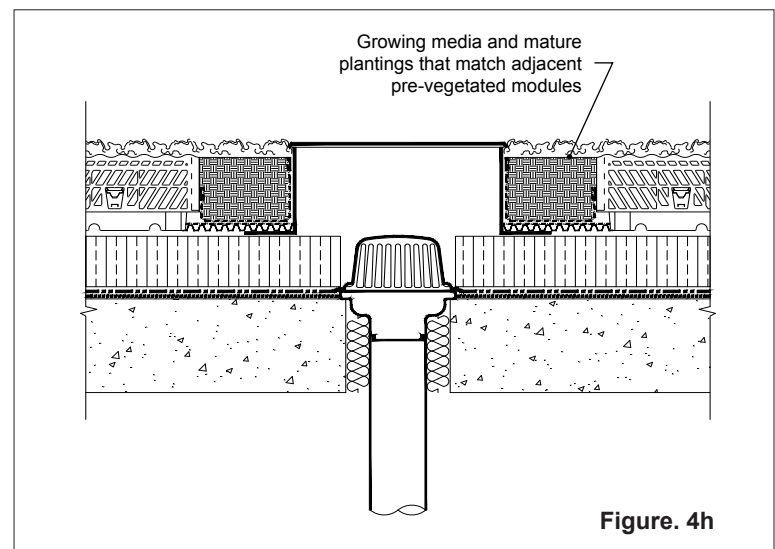

5- VR EdgeGuard 4

- a. Install VR EdgeGuard 4 as per plans and drawings.

(NOTE: On the VR MOD, press male locking clips inward and cut off female locking clip receivers to ensure a tight fit for the Edging restraint.)

(NOTE: Prior to application of VR TecTape 4 ensure sidewalls are clean and dry.)

(NOTE: Seal VR MOD pre-vegetated module wall with VR TecTape 4 as required.)

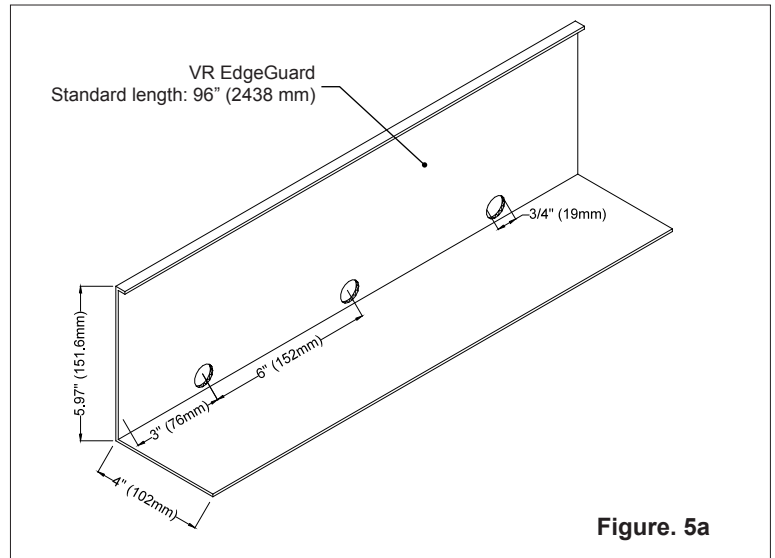

Figure 5a

- b. Ensure flange of edging restraint is facing the vegetation.

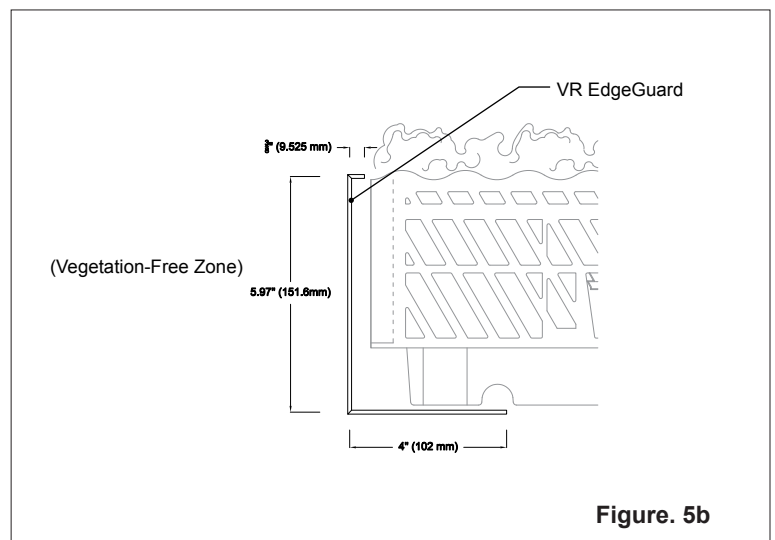

Figure 5b

- c. When joining two sections together, ensure a tight fit at all joints. Place edge connector piece on vegetation-free side of edging restraint, making sure to overlap evenly with both ends of joints. Secure with self-tapping screws as per diagram. See Figure 5c.

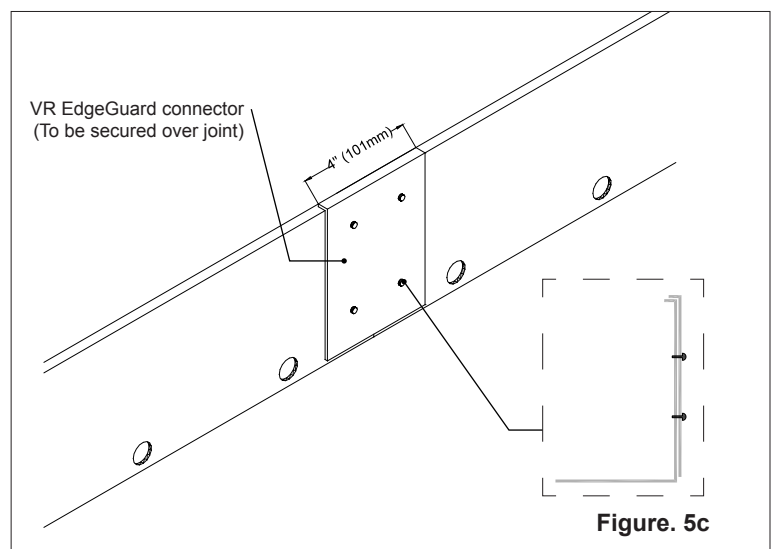

Figure 5c

- d. Install corners after long sections. Miter flange and lip of edging restraints at corners. Place edge corner connector on vegetation-free side of edging restraint, at the corners. Secure corner piece with self-tapping screws as per diagrams. See Figure 5d-1 for outside corners and Figure 5d-2 for inside corners.

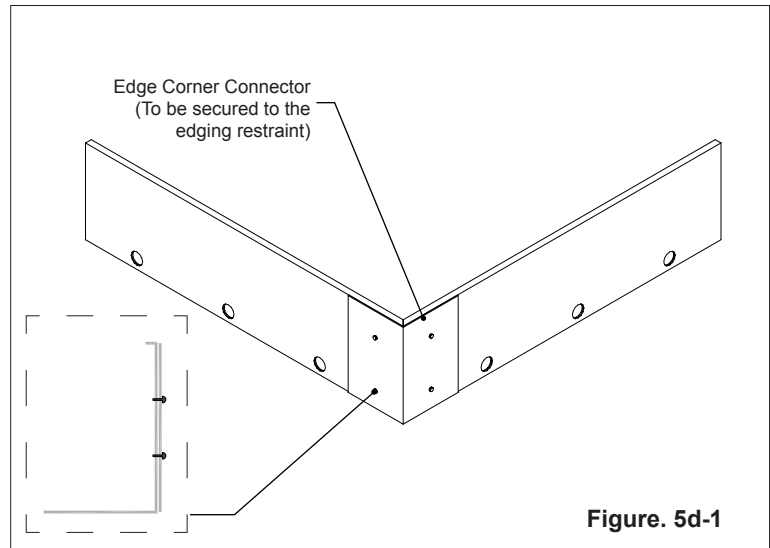

Figure. 5d-1

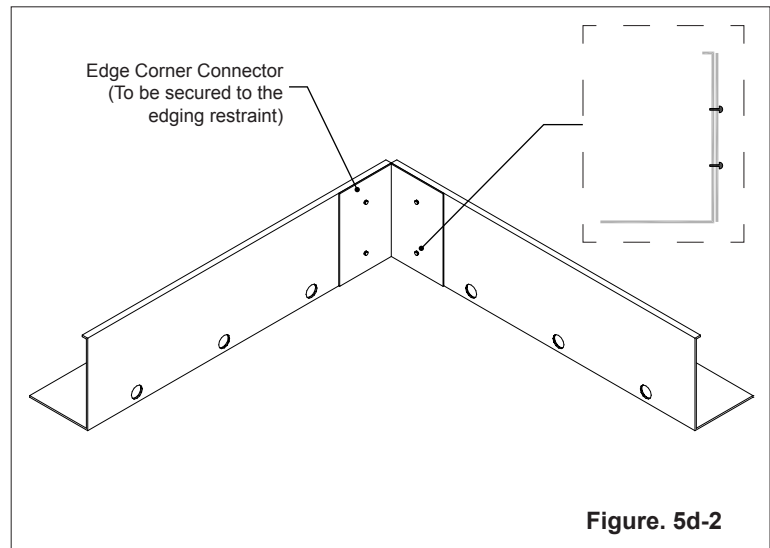

Figure. 5d-2

6- Vegetation Free Zone Pavers (Option 1)

(NOTE: With built-in pedestal.)

- a. Place pavers tight against the VR EdgeGuard 4 onto the Insulation/Roofing System.
- b. Cut to fit as per plans and drawings.

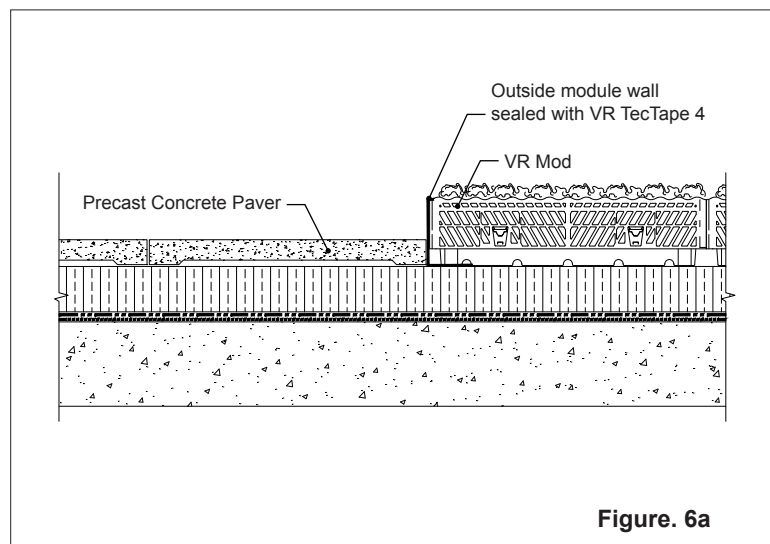

Figure. 6a

6- Vegetation Free Zone Pavers (Option 2)

(NOTE: With separate pedestal.)

- a. Place pavers on pedestals directly on top of Insulation/Roofing System. Ensure tight fit against the VR EdgeGuard.
- b. Make sure top of paver is flush with top of edging restraint.
- c. Cut to fit as per plans and drawings.

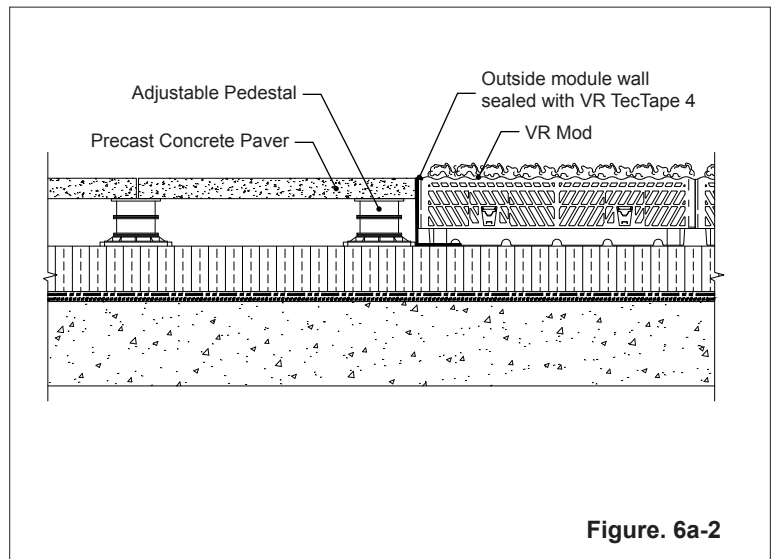

Figure. 6a-2