

TRIM-TEX^{INC.}

DRYWALL PRODUCTS

Installation Instructions

Ceiling Mounted Deflection Bead

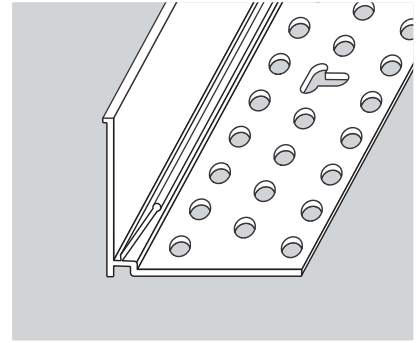

Please read entire instruction before proceeding.

Improper installation will void any applicable warranty.

STOCK NUMBER	LENGTH	PCS PER BOX
9240	10'	40
9242	12'	40

Installation

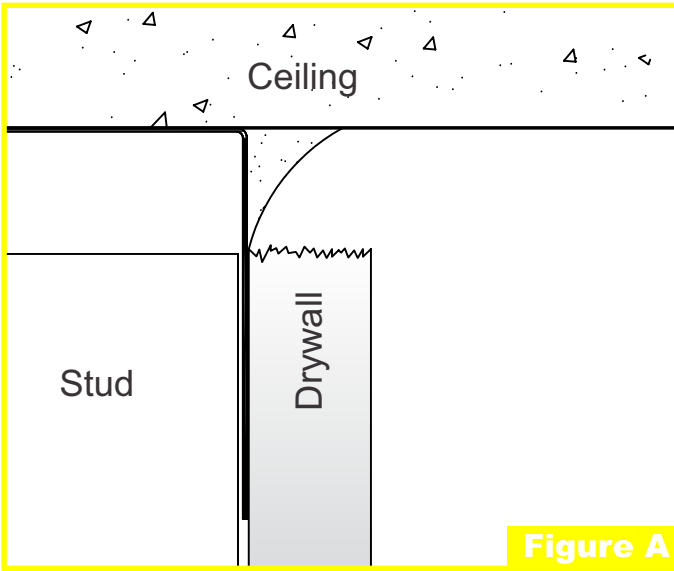
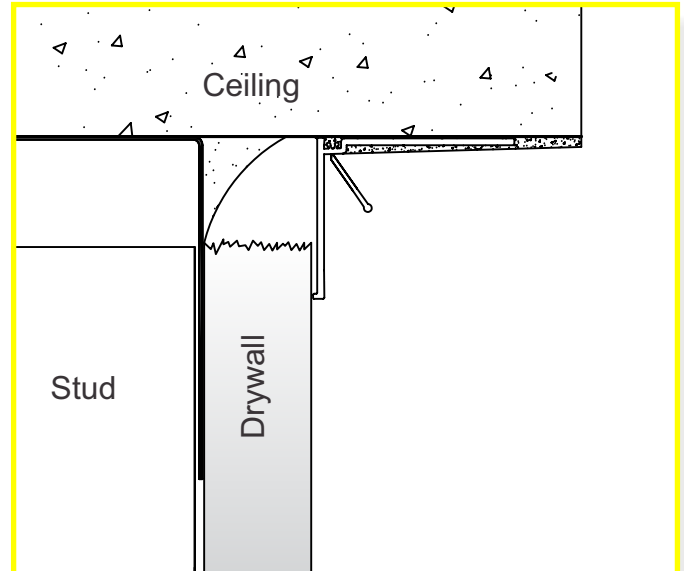

Figure A

Hang your drywall with no more than 7/8" from the ceiling or as specified by your architect.

Fill the void shown in **Figure A** with fire caulk or materials specified by the architect.



Snip your bead to length and dry fit to the ceiling for accurate installation.

Apply a narrow layer of *Taping Joint Compound* to the ceiling. Be sure to add Trim-Tex Mud-Max (#855) to the setting and base coat of compound. Embed the deflection bead into the compound and press into place with a taping knife. Coat the bead as needed.

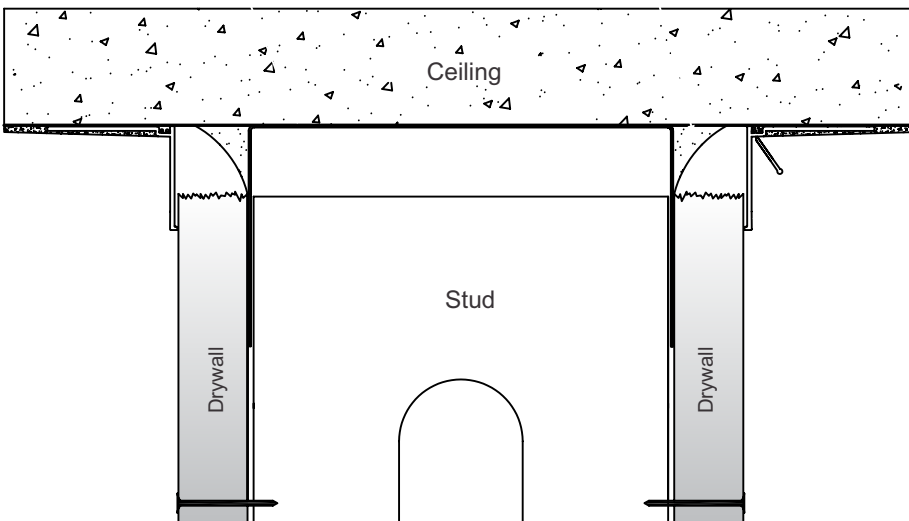

Prior to the final sanding remove the tear away strip for a clean and crisp finish.

DO NOT USE SETTING TYPE JOINT COMPOUNDS (HOT MUD)



Trim-Tex Mud Max boosts the performance and strength of any drywall compound.